

Attachment Chain

Renold Jeffrey offers a wide array of attachment chains suitable for nearly any application. Our base chains feature the quality that you know and trust. Combine that with the speed and reliability of delivery and you have high-quality, maximum-value attachment chain.

Our National Service Center in Hebron, Kentucky, is designed to meet your attachment chain needs quickly and efficiently. We maintain substantial inventories of components to craft attachment chains in carbon steel as well as in our special Hydro-Service® coating. We also have a wide variety of stainless steel products available.

Whether you need an item from stock or made to order, we'll get you the information and the product you need.

Attachment Chain available in:

- Carbon Steel
- Hydro-Service®
- Stainless Steel
- Nickel-Plated
- Syno®
- and more

The choice is yours...



Quality
Reliability
Performance
Value

How to order Renold Jeffrey Attachment Chains

1. Specify chain number.
2. Determine type of attachment. (A-1, SK-1, etc.)
3. Specify attachment spacing. (every pitch, every 2nd, etc. Evenly spaced attachments are placed on pin links unless specified otherwise.)
4. Specify length of each strand. (number of pitches per strand)
5. Specify how many strands.

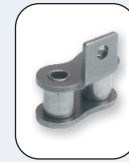

A-1



K-1

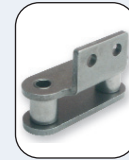

A-2



K-2

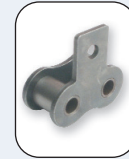

SA-1



SK-1



SA-2



SK-2

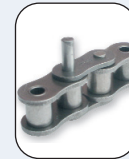

D-1



D-3



WA-1



WK-1



WA-2



WK-2

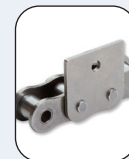

WSA-1



WSK-1



WSA-2



WSK-2

Bent Lug Attachments



A-1

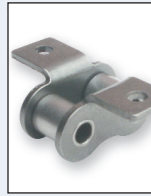

K-1

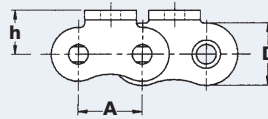
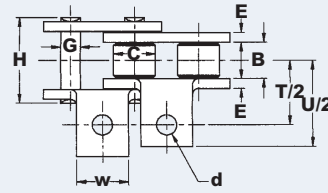

A-1 (Bent Lug 1 Side -1 Hole)

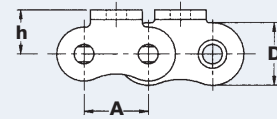
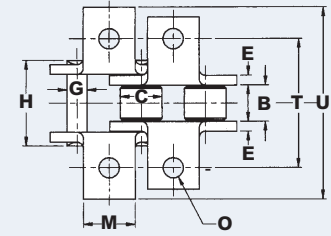

K-1 (Bent Lug 2 Sides -1 Hole)

A-1 & K-1 Attachment Dimensions

Dimensions are in inches unless otherwise indicated.

Chain No.	K-1 Across Attach Holes	A-1 C/L to Attach Hole	K-1 Overall Width	A-1 C/L to Attach End	Hole Diameter	Attachment Height	Tab Width	A-1 Additional Wgt/Att	K-1 Additional Wgt/Att
	T	T/2	U	U/2	d	h	w	Lbs/Pc	Lbs/Pc
35	0.750	0.375	1.110	0.555	0.110	0.250	0.315	0.002	0.004
40	1.000	0.500	1.358	0.679	0.142	0.311	0.374	0.003	0.006
50	1.253	0.626	1.835	0.918	0.209	0.406	0.500	0.009	0.018
60	1.500	0.750	2.228	1.114	0.209	0.469	0.626	0.014	0.028
80	2.002	1.001	2.761	1.381	0.265	0.625	0.751	0.030	0.060
100	2.500	1.250	3.412	1.706	0.329	0.781	1.000	0.059	0.118
120	3.000	1.500	4.405	2.203	0.408	0.906	1.133	0.105	0.210
140	3.500	1.750	4.970	2.485	0.469	1.125	1.375	0.157	0.314
160	4.000	2.000	5.656	2.828	0.547	1.250	1.500	0.214	0.428

Base Chain Dimensions

Chain No.	Pitch	Inside Width Min	Roller Diameter Max	Plate Height Max	Plate Thickness Max	Pin Diameter Max	Pin Length Max	Weight
	A	B	C	D	E/F	G	H	Lbs/Ft
35	0.375	0.184	0.200	0.356	0.049	0.141	0.472	0.24
40	0.500	0.309	0.312	0.475	0.061	0.157	0.646	0.40
50	0.625	0.370	0.400	0.594	0.080	0.200	0.803	0.67
60	0.750	0.495	0.469	0.713	0.094	0.235	0.996	0.99
80	1.000	0.620	0.625	0.950	0.128	0.313	1.287	1.88
100	1.250	0.744	0.750	1.188	0.160	0.376	1.563	2.82
120	1.500	0.993	0.875	1.425	0.189	0.437	1.941	3.83
140	1.750	0.993	1.000	1.663	0.221	0.500	2.083	5.24
160	2.000	1.242	1.125	1.900	0.250	0.563	2.484	6.99

Standard Attachment Chain

Straight Lug Attachments

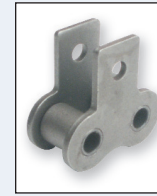
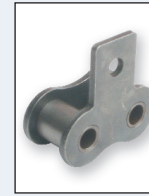
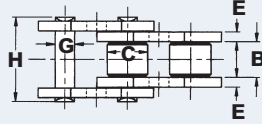
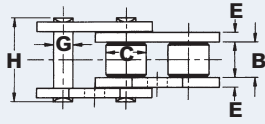

SA-1

SK-1

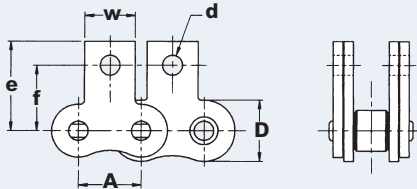
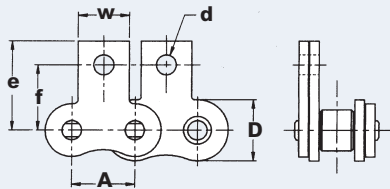

SA-1 (Straight Lug 1 Side -1 Hole)

SK-1 (Straight Lug 2 Side -1 Hole)

SA-1 & SK-1 Attachment Dimensions

Dimensions are in inches unless otherwise indicated.

Chain No.	Hole Diameter	SA-1 / SK-1 C/L to Attach Top	SA-1 / SK-1 C/L to Attach Hole	Tab Width	SA-1 Additional Wgt/Att	SK-1 Additional Wgt/Att
	d	e	f	w	Lbs/Pc	Lbs/Pc
35	0.111	0.571	0.375	0.315	0.002	0.004
40	0.142	0.732	0.500	0.374	0.003	0.006
50	0.209	0.902	0.626	0.500	0.009	0.018
60	0.209	1.063	0.720	0.626	0.014	0.028
80	0.265	1.351	0.969	0.751	0.030	0.060
100	0.329	1.700	1.250	1.000	0.059	0.118
120	0.408	2.089	1.437	1.133	0.105	0.210
140	0.469	2.484	1.750	1.375	0.157	0.314
160	0.547	2.734	2.000	1.500	0.214	0.428

Base Chain Dimensions

Chain No.	Pitch	Inside Width Min	Roller Diameter Max	Plate Height Max	Plate Thickness Max	Pin Diameter Max	Pin Length Max	Weight
	A	B	C	D	E/F	G	H	Lbs/Ft
35	0.375	0.184	0.200	0.356	0.049	0.141	0.472	0.24
40	0.500	0.309	0.312	0.475	0.061	0.157	0.646	0.40
50	0.625	0.370	0.400	0.594	0.080	0.200	0.803	0.67
60	0.750	0.495	0.469	0.713	0.094	0.235	0.996	0.99
80	1.000	0.620	0.625	0.950	0.128	0.313	1.287	1.88
100	1.250	0.744	0.750	1.188	0.160	0.376	1.563	2.82
120	1.500	0.993	0.875	1.425	0.189	0.437	1.941	3.83
140	1.750	0.993	1.000	1.663	0.221	0.500	2.083	5.24
160	2.000	1.242	1.125	1.900	0.250	0.563	2.484	6.99

Extended Pin Attachments



D-1

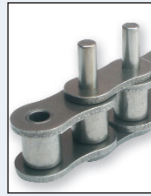

D-3

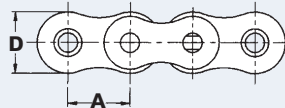
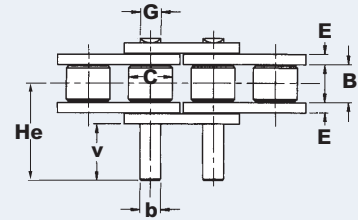
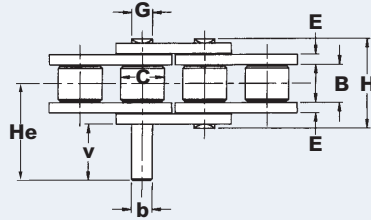

D-1 (1 Pin Extended Per Pin Link)

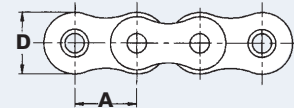

D-3 (2 Pins Extended Per Pin Link)

D-1 & D-3 Attachment Dimensions

Dimensions are in inches unless otherwise indicated.

Chain No.	C/L to End of Ext Pin	Ext Pin Diameter	Ext Pin Projection	D-1 Additional Wgt/Att	D-3 Additional Wgt/Att
	He	b	v	Lbs/Pc	Lbs/Pc
35	0.576	0.141	0.375	0.002	0.004
40	0.674	0.157	0.383	0.003	0.006
50	0.828	0.200	0.468	0.004	0.008
60	1.013	0.235	0.562	0.007	0.014
80	1.328	0.313	0.751	0.015	0.030
100	1.645	0.376	0.938	0.026	0.052
120	2.015	0.437	1.125	0.044	0.088
140	2.271	0.500	1.312	0.066	0.132
160	2.652	0.563	1.500	0.099	0.198

Base Chain Dimensions

Chain No.	Pitch	Inside Width Min	Roller Diameter Max	Plate Height Max	Plate Thickness Max	Pin Diameter Max	Pin Length Max	Weight
	A	B	C	D	E/F	G	H	Lbs/Ft
35	0.375	0.184	0.200	0.356	0.049	0.141	0.472	0.24
40	0.500	0.309	0.312	0.475	0.061	0.157	0.646	0.40
50	0.625	0.370	0.400	0.594	0.080	0.200	0.803	0.67
60	0.750	0.495	0.469	0.713	0.094	0.235	0.996	0.99
80	1.000	0.620	0.625	0.950	0.128	0.313	1.287	1.88
100	1.250	0.744	0.750	1.188	0.160	0.376	1.563	2.82
120	1.500	0.993	0.875	1.425	0.189	0.437	1.941	3.83
140	1.750	0.993	1.000	1.663	0.221	0.500	2.083	5.24
160	2.000	1.242	1.125	1.900	0.250	0.563	2.484	6.99

Standard Attachment Chain

Bent Lug Wide Contour Attachments

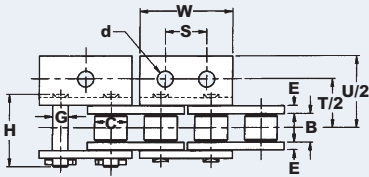

WA-1 (Bent Lug 1 Side - 1 Hole)
WA-2 (Bent Lug 1 Side - 2 Holes)

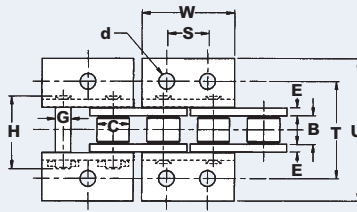

WK-1 (Bent Lug 2 Sides - 1 Hole)
WK-2 (Bent Lug 2 Sides - 2 Holes)



WA-1



WK-1

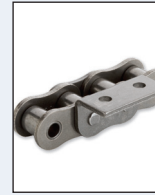

WA-2

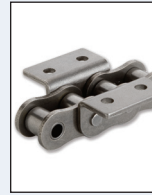

WK-2

WA-1, WA-2 & WK-1, WK-2 Attachment Dimensions

Dimensions are in inches unless otherwise indicated.

Chain No.	WK-1 / WK-2 Across Attach Holes	WA-1 / WA-2 C/L to Attach Hole	WK-1 / WK-2 Overall Width	WA-1 / WA-2 C/L to Attach End	Hole Diameter	Attachment Height	Attachment Hole Pitch	Tab Width	WA-1 / WA-2 Additional Wgt/Att	WK-1 / WK-2 Additional Wgt/Att
	T	T/2	U	U/2	d	h	s	w	Lbs/Pc	Lbs/Pc
40	1.000	0.500	1.358	0.679	0.142	0.311	0.500	0.945	0.003	0.006
50	1.253	0.626	1.835	0.918	0.209	0.406	0.622	1.193	0.007	0.014
60	1.500	0.750	2.228	1.114	0.209	0.469	0.748	1.402	0.012	0.024
80	2.002	1.001	2.761	1.381	0.260	0.625	1.001	1.820	0.028	0.056
100	2.500	1.250	3.412	1.706	0.343	0.781	1.250	2.404	0.055	0.110

Base Chain Dimensions

Chain No.	Pitch	Inside Width Min	Roller Diameter Max	Plate Height Max	Plate Thickness Max	Pin Diameter Max	Pin Length Max	Weight
	A	B	C	D	E/F	G	H	Lbs/Ft
40	0.500	0.309	0.312	0.475	0.061	0.157	0.646	0.40
50	0.625	0.370	0.400	0.594	0.080	0.200	0.803	0.67
60	0.750	0.495	0.469	0.713	0.094	0.235	0.996	0.99
80	1.000	0.620	0.625	0.950	0.128	0.313	1.287	1.88
100	1.250	0.744	0.750	1.188	0.160	0.376	1.563	2.82

Straight Lug Wide Contour Attachments

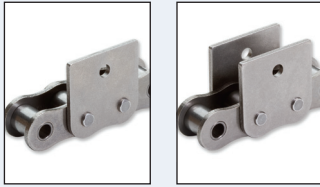

WSA-1

WSK-1

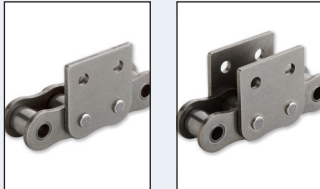

WSA-2

WSK-2

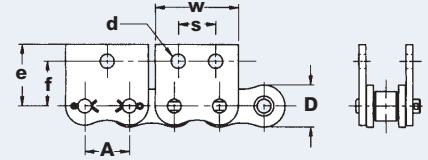
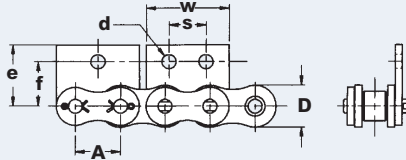
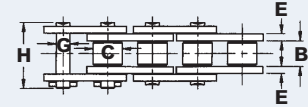
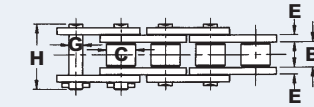

WSA-1 (Straight Lug 1 Side - 1 Hole)
WSA-2 (Straight Lug 1 Side - 2 Holes)

WSK-1 (Straight Lug 2 Sides - 1 Hole)
WSK-2 (Straight Lug 2 Sides - 2 Holes)

WSA-1, WSA-2 & WSK-1, WSK-2 Attachment Dimensions

Dimensions are in inches unless otherwise indicated.

Chain No.	Hole Diameter	WSA-1 / WSA-2 WSK-1 / WSK-2 C/L to Attach Top	WSA-1 / WSA-2 WSK-1 / WSK-2 C/L to Attach Hole	Attachment Hole Pitch	Tab Width	WSA-1 / WSA-2 Additional Wgt/Att	WSK-1 / WSK-2 Additional Wgt/Att
	d	e	f	s	w	Lbs/Pc	Lbs/Pc
40	0.142	0.732	0.500	0.500	0.945	0.003	0.006
50	0.209	0.902	0.626	0.622	1.193	0.007	0.014
60	0.209	1.063	0.721	0.748	1.402	0.012	0.024
80	0.260	1.564	0.969	1.001	1.820	0.028	0.056
100	0.343	1.703	1.250	1.250	2.404	0.055	0.110

Base Chain Dimensions

Chain No.	Pitch	Inside Width Min	Roller Diameter Max	Plate Height Max	Plate Thickness Max	Pin Diameter Max	Pin Length Max	Weight
	A	B	C	D	E/F	G	H	Lbs/Ft
40	0.500	0.309	0.312	0.475	0.061	0.157	0.646	0.40
50	0.625	0.370	0.400	0.594	0.080	0.200	0.803	0.67
60	0.750	0.495	0.469	0.713	0.094	0.235	0.996	0.99
80	1.000	0.620	0.625	0.950	0.128	0.313	1.287	1.88
100	1.250	0.744	0.750	1.188	0.160	0.376	1.563	2.82

Double Pitch Attachment Chain

Bent Lug Attachments

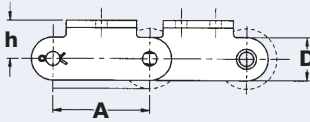
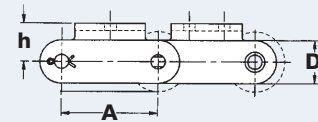
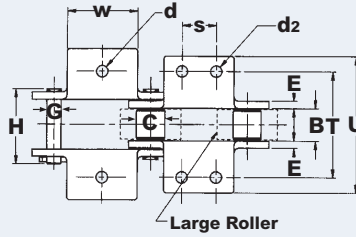
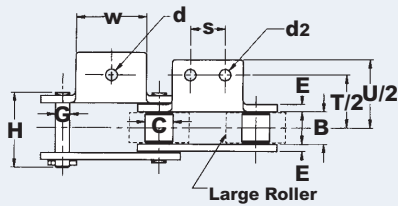

A-1 (Bent Lug 1 Side - 1 Hole)
A-2 (Bent Lug 1 Side - 2 Holes)

K-1 (Bent Lug 2 Sides - 1 Hole)
K-2 (Bent Lug 2 Sides - 2 Holes)



A-1

K-1

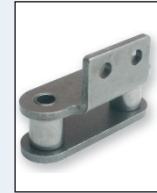

A-2

K-2

A-1, A-2 & K-1, K-2 Double Pitch Attachment Dimensions

Dimensions are in inches unless otherwise indicated.

Chain No.	A-1 / K-1 Across Attach Holes	C/L to Attach Hole	A-1 / K-1 Overall Width	C/L to Attach End	A-1 / K-1 Hole Diameter	A-2 / K-2 Hole Diameter	C/L to Top of Attach	Attachment Hole Pitch	Tab Width	A-1 / A-2 Additional Wgt/Att	K-1 / K-2 Additional Wgt/Att
	T	T/2	U	U/2	d	d ₂	h	s	w	Lbs/Pc	Lbs/Pc
C2040 & C2042	1.000	0.500	1.520	0.760	0.138	0.138	0.358	0.375	0.750	0.007	0.014
C2050 & C2052	1.250	0.625	1.900	0.950	0.209	0.209	0.437	0.468	0.937	0.014	0.028
C2060H & C2062H	1.686	0.843	2.430	1.215	0.209	0.209	0.579	0.562	1.130	0.033	0.066
C2080H & C2082H	2.190	1.095	3.190	1.595	0.280	0.280	0.752	0.750	1.500	0.070	0.140
C2100H & C2102H	2.626	1.313	3.938	1.969	0.344	0.344	0.922	0.937	1.875	0.142	0.284
C2120H & C2122H	3.126	1.563	4.876	2.438	0.406	0.406	1.094	1.125	2.250	0.226	0.452
C2160H & C2162H	4.126	2.063	5.968	2.984	0.547	0.547	1.438	1.500	3.000	0.583	1.166

Base Chain Dimensions

Chain No.	Pitch	Inside Width Min	Roller Diameter Max	Plate Height Max	Plate Thickness Max	Pin Diameter Max	Pin Length Max	Weight
	A	B	C	D	E/F	G	H	Lbs/Ft
Standard Roller								
C2040	1.000	0.309	0.312	0.465	0.059	0.157	0.701	0.34
C2050	1.250	0.370	0.400	0.591	0.079	0.200	0.858	0.56
C2060H	1.500	0.495	0.469	0.701	0.128	0.235	1.126	0.97
C2080H	2.000	0.620	0.625	0.949	0.160	0.313	1.409	1.63
C2100H	2.500	0.748	0.750	1.134	0.189	0.376	1.669	2.33
C2120H	3.000	1.000	0.875	1.382	0.221	0.437	2.063	3.31
C2160H	4.000	1.240	1.125	1.886	0.287	0.563	2.583	5.38
Large Roller								
C2042	1.000	0.309	0.625	0.465	0.059	0.157	0.701	0.55
C2052	1.250	0.370	0.750	0.591	0.079	0.200	0.858	0.85
C2062H	1.500	0.495	0.875	0.701	0.128	0.235	1.126	1.36
C2082H	2.000	0.620	1.125	0.949	0.160	0.313	1.409	2.26
C2102H	2.500	0.748	1.562	1.134	0.189	0.376	1.669	3.80
C2122H	3.000	1.000	1.750	1.382	0.221	0.437	2.063	5.31
C2162H	4.000	1.240	2.250	1.886	0.287	0.563	2.583	8.60

Straight Lug Double Pitch Attachments

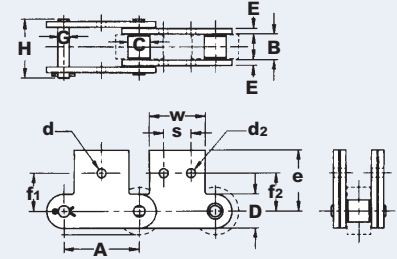
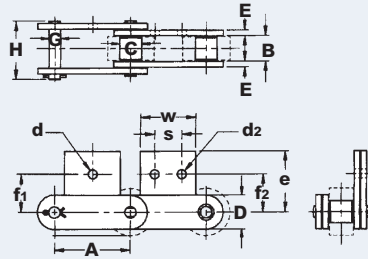

SA-1 (Straight Lug 1 Side - 1 Hole)
SA-2 (Straight Lug 1 Side - 2 Holes)

SK-1 (Straight Lug 2 Sides - 1 Hole)
SK-2 (Straight Lug 2 Sides - 2 Holes)

SA-1, SA-2 & SK-1, SK-2 Double Pitch Attachment Dimensions

Dimensions are in inches unless otherwise indicated.

Chain No.	SA-1 / SK-1 Hole Diameter	SA-2 / SK-2 Hole Diameter	C/L to Attach End	SA-1 / SK-1 C/L to Attach Hole	SA-2 / SK-2 C/L to Attach Hole	Attachment Hole Pitch	Tab Width	SA-1 / SA-2 Additional Wgt/Att	SK-1 / SK-2 Additional Wgt/Att
	d	d ₂	e	f ₁	f ₂	s	w	Lbs/Pc	Lbs/Pc
C2040 & C2042	0.209	0.138	0.783	0.437	0.531	0.375	0.750	0.007	0.014
C2050 & C2052	0.280	0.209	0.969	0.563	0.626	0.468	0.937	0.014	0.028
C2060H & C2062H	0.331	0.209	1.189	0.689	0.748	0.562	1.130	0.033	0.066
C2080H & C2082H	0.409	0.280	1.594	0.874	1.000	0.750	1.500	0.070	0.140
C2100H & C2102H	0.547	0.344	1.984	1.125	1.250	0.937	1.875	0.142	0.284
C2120H & C2122H	0.625	0.406	2.156	1.312	1.469	1.125	2.250	0.226	0.452
C2160H & C2162H	0.828	0.547	3.000	1.750	2.000	1.500	3.000	0.583	1.166

Base Chain Dimensions

Chain No.	Pitch	Inside Width Min	Roller Diameter Max	Plate Height Max	Plate Thickness Max	Pin Diameter Max	Pin Length Max	Weight
	A	B	C	D	E/F	G	H	Lbs/Ft
Standard Roller								
C2040	1.000	0.309	0.312	0.465	0.059	0.157	0.701	0.34
C2050	1.250	0.370	0.400	0.591	0.079	0.200	0.858	0.56
C2060H	1.500	0.495	0.469	0.701	0.128	0.235	1.126	0.97
C2080H	2.000	0.620	0.625	0.949	0.160	0.313	1.409	1.63
C2100H	2.500	0.748	0.750	1.134	0.189	0.376	1.669	2.33
C2120H	3.000	1.000	0.875	1.382	0.221	0.437	2.063	3.31
C2160H	4.000	1.240	1.125	1.886	0.287	0.563	2.583	5.38
Large Roller								
C2042	1.000	0.309	0.625	0.465	0.059	0.157	0.701	0.55
C2052	1.250	0.370	0.750	0.591	0.079	0.200	0.858	0.85
C2062H	1.500	0.495	0.875	0.701	0.128	0.235	1.126	1.36
C2082H	2.000	0.620	1.125	0.949	0.160	0.313	1.409	2.26
C2102H	2.500	0.748	1.562	1.134	0.189	0.376	1.669	3.80
C2122H	3.000	1.000	1.750	1.382	0.221	0.437	2.063	5.31
C2162H	4.000	1.240	2.250	1.886	0.287	0.563	2.583	8.60

Double Pitch Attachment Chain

Extended Pin Attachments

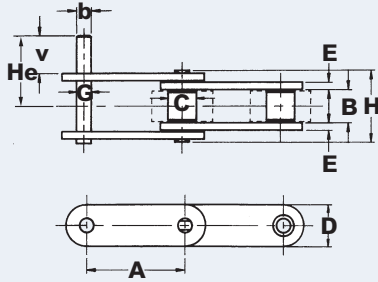

D-1 (1 Pin Extended Per Pin Link)

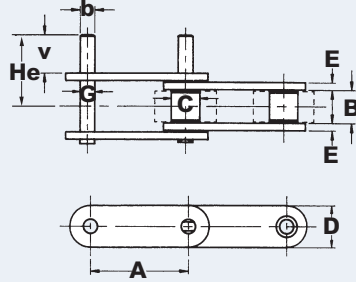

D-3 (2 Pins Extended Per Pin Link)

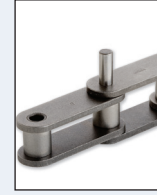

D-1

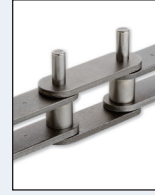

D-3

D-1 & D-3 Double Pitch Attachment Dimensions

Dimensions are in inches unless otherwise indicated.

Chain No.	C/L to End of Ext Pin	Ext Pin Diameter	Ext Pin Projection	D-1 Additional Wgt/Att	D-3 Additional Wgt/Att
	He	b	v	Lbs/Pc	Lbs/Pc
C2040 & C2042	0.988	0.156	0.374	0.003	0.006
C2050 & C2052	1.228	0.200	0.469	0.004	0.008
C2060H & C2062H	1.642	0.235	0.563	0.007	0.014
C2080H & C2082H	2.100	0.313	0.752	0.015	0.030
C2100H & C2102H	2.616	0.375	0.937	0.026	0.052
C2120H & C2122H	3.140	0.437	1.125	0.044	0.088
C2160H & C2162H	3.960	0.563	1.500	0.099	0.198

Base Chain Dimensions

Chain No.	Pitch	Inside Width Min	Roller Diameter Max	Plate Height Max	Plate Thickness Max	Pin Diameter Max	Pin Length Max	Weight
	A	B	C	D	E/F	G	H	Lbs/Ft
Standard Roller								
C2040	1.000	0.309	0.312	0.465	0.059	0.157	0.701	0.34
C2050	1.250	0.370	0.400	0.591	0.079	0.200	0.858	0.56
C2060H	1.500	0.495	0.469	0.701	0.128	0.235	1.126	0.97
C2080H	2.000	0.620	0.625	0.949	0.160	0.313	1.409	1.63
C2100H	2.500	0.748	0.750	1.134	0.189	0.376	1.669	2.33
C2120H	3.000	1.000	0.875	1.382	0.221	0.437	2.063	3.31
C2160H	4.000	1.240	1.125	1.886	0.287	0.563	2.583	5.38
Large Roller								
C2042	1.000	0.309	0.625	0.465	0.059	0.157	0.701	0.55
C2052	1.250	0.370	0.750	0.591	0.079	0.200	0.858	0.85
C2062H	1.500	0.495	0.875	0.701	0.128	0.235	1.126	1.36
C2082H	2.000	0.620	1.125	0.949	0.160	0.313	1.409	2.26
C2102H	2.500	0.748	1.562	1.134	0.189	0.376	1.669	3.80
C2122H	3.000	1.000	1.750	1.382	0.221	0.437	2.063	5.31
C2162H	4.000	1.240	2.250	1.886	0.287	0.563	2.583	8.60

Bent Lug Attachments



A-1



K-1

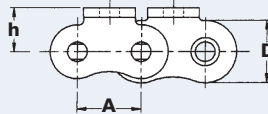
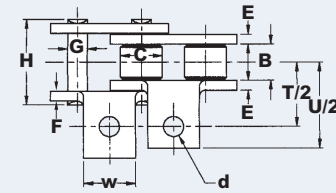

A-1 (Bent Lug 1 Side -1 Hole)

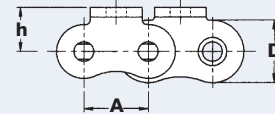
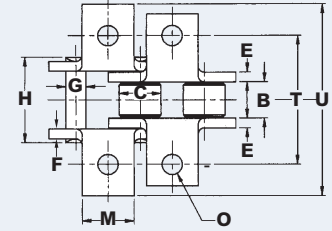

K-1 (Bent Lug 2 Sides -1 Hole)

Syno® A-1 & K-1 Attachment Dimensions

Dimensions are in inches unless otherwise indicated.

Chain No.	K-1 Across Attach Holes	A-1 C/L to Attach Hole	K-1 Overall Width	A-1 C/L to Attach End	Hole Diameter	Attachment Height	Tab Width	A-1 Additional Wgt/Att	K-1 Additional Wgt/Att
	T	T/2	U	U/2	d	h	w	Lbs/Pc	Lbs/Pc
40	1.024	0.512	1.433	0.717	0.142	0.311	0.374	0.003	0.006
50	1.291	0.646	2.000	1.000	0.209	0.406	0.500	0.009	0.018
60	1.567	0.783	2.350	1.175	0.209	0.469	0.626	0.014	0.028
80	2.067	1.033	3.319	1.659	0.265	0.626	0.751	0.030	0.060
100	2.500	1.250	3.412	1.706	0.329	0.781	1.000	0.059	0.118
120	3.000	1.500	4.405	2.203	0.408	0.906	1.133	0.105	0.210
140	3.500	1.750	4.970	2.485	0.469	1.125	1.375	0.157	0.314
160	4.000	2.000	5.656	2.828	0.547	1.250	1.500	0.214	0.428

Base Chain Dimensions

Chain No.	Pitch	Inside Width Min	Roller Diameter Max	Plate Height Max	Inner Plate Thickness Max	Outer Plate Thickness Max	Pin Diameter Max	Pin Length Max	Weight
	A	B	C	D	E	F	G	H	Lbs/Ft
40	0.500	0.309	0.312	0.461	0.071	0.059	0.157	0.665	0.45
50	0.625	0.370	0.400	0.575	0.095	0.079	0.200	0.831	0.75
60	0.750	0.495	0.469	0.689	0.127	0.094	0.235	1.063	1.16
80	1.000	0.620	0.625	0.906	0.160	0.118	0.313	1.327	1.94
100	1.250	0.744	0.750	0.996	0.173	0.157	0.376	1.598	2.45
120	1.500	0.993	0.875	1.408	0.189	0.189	0.437	1.941	3.35
140	1.750	0.993	1.000	1.641	0.221	0.221	0.500	2.083	4.63
160	2.000	1.242	1.125	1.874	0.250	0.250	0.563	2.484	6.17

Syno® Attachment Chain

Straight Lug Attachments

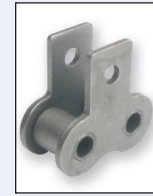
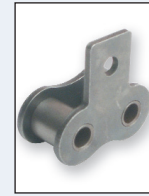
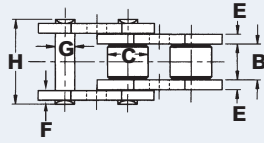
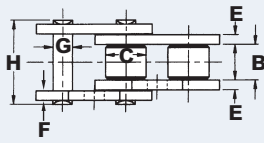

SA-1

SK-1

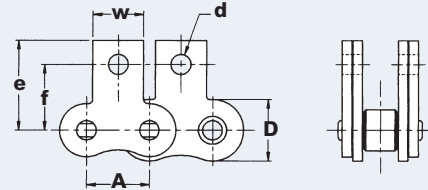
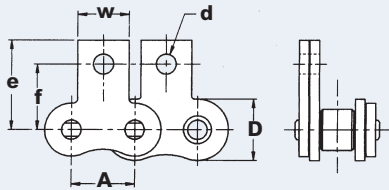

SA-1 (Straight Lug 1 Side -1 Hole)

SK-1 (Straight Lug 2 Side -1 Hole)

Syno® SA-1 & SK-1 Attachment Dimensions

Dimensions are in inches unless otherwise indicated.

Chain No.	Hole Diameter	SA-1 / SK-1 C/L to Attach Top	SA-1 / SK-1 C/L to Attach Hole	Tab Width	SA-1 Additional Wgt/Att	SK-1 Additional Wgt/Att
	d	e	f	w	Lbs/Pc	Lbs/Pc
40	0.142	0.732	0.500	0.374	0.003	0.006
50	0.209	0.902	0.626	0.500	0.009	0.018
60	0.209	1.063	0.720	0.626	0.014	0.028
80	0.265	1.351	0.969	0.751	0.030	0.060
100	0.329	1.700	1.250	1.000	0.059	0.118
120	0.408	2.089	1.437	1.133	0.105	0.210
140	0.469	2.484	1.750	1.375	0.157	0.314
160	0.547	2.734	2.000	1.500	0.214	0.428

Base Chain Dimensions

Chain No.	Pitch	Inside Width Min	Roller Diameter Max	Plate Height Max	Inner Plate Thickness Max	Outer Plate Thickness Max	Pin Diameter Max	Pin Length Max	Weight
	A	B	C	D	E	F	G	H	Lbs/Ft
40	0.500	0.309	0.312	0.461	0.071	0.059	0.157	0.665	0.45
50	0.625	0.370	0.400	0.575	0.095	0.079	0.200	0.831	0.75
60	0.750	0.495	0.469	0.689	0.127	0.094	0.235	1.063	1.16
80	1.000	0.620	0.625	0.906	0.160	0.118	0.313	1.327	1.94
100	1.250	0.744	0.750	0.996	0.173	0.157	0.376	1.598	2.45
120	1.500	0.993	0.875	1.408	0.189	0.189	0.437	1.941	3.35
140	1.750	0.993	1.000	1.641	0.221	0.221	0.500	2.083	4.63
160	2.000	1.242	1.125	1.874	0.250	0.250	0.563	2.484	6.17

Extended Pin Attachments



D-1

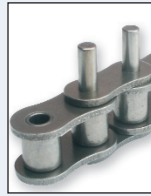

D-3

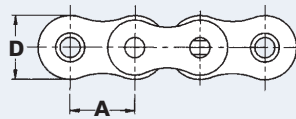
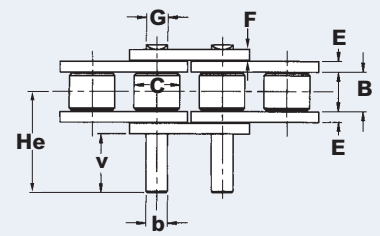
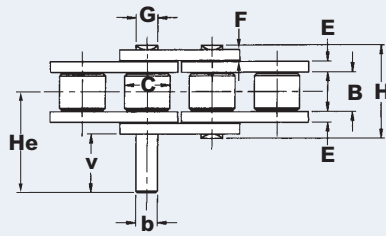

D-1 (1 Pin Extended Per Pin Link)

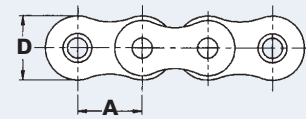

D-3 (2 Pins Extended Per Pin Link)

Syno® D-1 & D-3 Attachment Dimensions

Dimensions are in inches unless otherwise indicated.

Chain No.	C/L to End of Ext Pin	Ext Pin Diameter	Ext Pin Projection	D-1 Additional Wgt/Att	D-3 Additional Wgt/Att
	He	b	v	Lbs/Pc	Lbs/Pc
40	0.678	0.156	0.383	0.003	0.006
50	0.842	0.200	0.468	0.004	0.008
60	1.046	0.235	0.562	0.007	0.014
80	1.354	0.313	0.751	0.015	0.030
100	1.670	0.375	0.938	0.026	0.052
120	2.015	0.437	1.125	0.044	0.088
140	2.271	0.500	1.312	0.066	0.132
160	2.652	0.563	1.500	0.099	0.198

Base Chain Dimensions

Chain No.	Pitch	Inside Width Min	Roller Diameter Max	Plate Height Max	Inner Plate Thickness Max	Outer Plate Thickness Max	Pin Diameter Max	Pin Length Max	Weight
	A	B	C	D	E	F	G	H	Lbs/Ft
40	0.500	0.309	0.312	0.461	0.071	0.059	0.157	0.665	0.45
50	0.625	0.370	0.400	0.575	0.095	0.079	0.200	0.831	0.75
60	0.750	0.495	0.469	0.689	0.127	0.094	0.235	1.063	1.16
80	1.000	0.620	0.625	0.906	0.160	0.118	0.313	1.327	1.94
100	1.250	0.744	0.750	0.996	0.173	0.157	0.376	1.598	2.45
120	1.500	0.993	0.875	1.408	0.189	0.189	0.437	1.941	3.35
140	1.750	0.993	1.000	1.641	0.221	0.221	0.500	2.083	4.63
160	2.000	1.242	1.125	1.874	0.250	0.250	0.563	2.484	6.17

Syno® Attachment Chain

Bent Lug Wide Contour Attachments

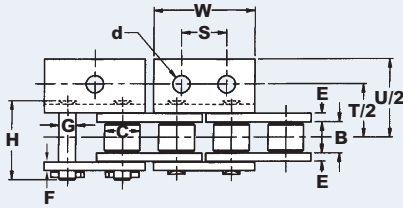

WA-1 (Bent Lug 1 Side - 1 Hole)
WA-2 (Bent Lug 1 Side - 2 Holes)

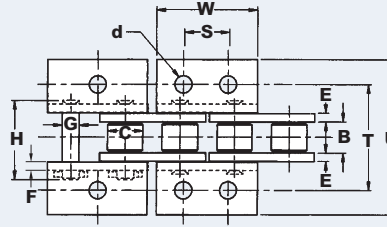

WK-1 (Bent Lug 2 Sides - 1 Hole)
WK-2 (Bent Lug 2 Sides - 2 Holes)



WA-1



WK-1



WA-2

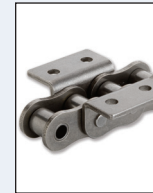

WK-2

Syno® WA-1, WA-2 & WK-1, WK-2 Attachment Dimensions

Dimensions are in inches unless otherwise indicated.

Chain No.	WK-1 / WK-2 Across Attach Holes	WA-1 / WA-2 C/L to Attach Hole	WK-1 / WK-2 Overall Width	WA-1 / WA-2 C/L to Attach End	Hole Diameter	Attachment Height	Attachment Hole Pitch	Tab Width	WA-1 / WA-2 Additional Wgt/Att	WK-1 / WK-2 Additional Wgt/Att
	T	T/2	U	U/2	d	h	s	w	Lbs/Pc	Lbs/Pc
40	1.024	0.512	1.433	0.717	0.142	0.311	0.500	0.945	0.003	0.006
50	1.291	0.646	2.000	1.000	0.209	0.406	0.625	1.193	0.007	0.014
60	1.567	0.783	2.350	1.175	0.209	0.469	0.750	1.402	0.012	0.024
80	2.067	1.033	3.319	1.659	0.260	0.625	1.000	1.564	0.028	0.056
100	2.500	1.250	3.484	1.742	0.343	0.781	1.250	2.404	0.055	0.110

Base Chain Dimensions

Chain No.	Pitch	Inside Width Min	Roller Diameter Max	Plate Height Max	Inner Plate Thickness Max	Outer Plate Thickness Max	Pin Diameter Max	Pin Length Max	Weight
	A	B	C	D	E	F	G	H	Lbs/Ft
40	0.500	0.309	0.312	0.461	0.071	0.059	0.157	0.665	0.45
50	0.625	0.370	0.400	0.575	0.095	0.079	0.200	0.831	0.75
60	0.750	0.495	0.469	0.689	0.127	0.094	0.235	1.063	1.16
80	1.000	0.620	0.625	0.906	0.160	0.118	0.313	1.327	1.94
100	1.250	0.744	0.750	0.996	0.173	0.157	0.376	1.598	2.45

Straight Lug Wide Contour Attachments



WSA-1



WSK-1



WSA-2



WSK-2

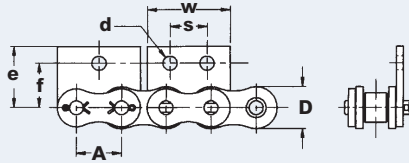
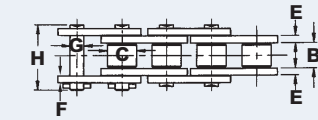

WSA-1 (Straight Lug 1 Side - 1 Hole)
WSA-2 (Straight Lug 1 Side - 2 Holes)

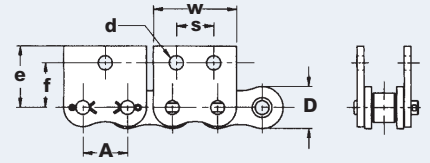
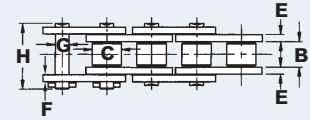

WSK-1 (Straight Lug 2 Sides - 1 Hole)
WSK-2 (Straight Lug 2 Sides - 2 Holes)

Syno® WSA-1, WSA-2 & WSK-1, WSK-2 Attachment Dimensions

Dimensions are in inches unless otherwise indicated.

Chain	Hole Diameter	WSA-1 / WSA-2 WSK-1 / WSK-2 C/L to Attach Top	WSA-1 / WSA-2 WSK-2 / WSK-2 C/L to Attach Hole	Attachment Hole Pitch	Tab Width	WSA-1 / WSA-2 Additional Wgt/Att	WSK-1 / WSK-2 Additional Wgt/Att
	d	e	f	s	w	Lbs/Pc	Lbs/Pc
40	0.142	0.732	0.500	0.500	0.945	0.003	0.006
50	0.209	0.902	0.626	0.622	1.192	0.007	0.014
60	0.209	1.063	0.721	0.748	1.402	0.012	0.024
80	0.260	1.564	0.969	1.001	1.820	0.028	0.056
100	0.343	1.703	1.250	1.250	2.404	0.055	0.110

Base Chain Dimensions

Chain No.	Pitch	Inside Width Min	Roller Diameter Max	Plate Height Max	Inner Plate Thickness Max	Outer Plate Thickness Max	Pin Diameter Max	Pin Length Max	Weight
	A	B	C	D	E	F	G	H	Lbs/Ft
40	0.500	0.309	0.312	0.461	0.071	0.059	0.157	0.665	0.45
50	0.625	0.370	0.400	0.575	0.095	0.079	0.200	0.831	0.75
60	0.750	0.495	0.469	0.689	0.127	0.094	0.235	1.063	1.16
80	1.000	0.620	0.625	0.906	0.160	0.118	0.313	1.327	1.94
100	1.250	0.744	0.750	0.996	0.173	0.157	0.376	1.598	2.45

Syno® Attachment Chain

Bent Lug Attachments

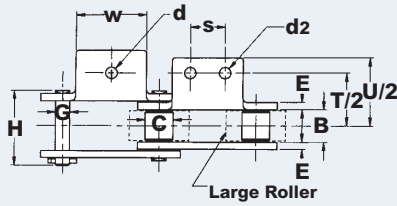

A-1 (Bent Lug 1 Side - 1 Hole)
A-2 (Bent Lug 1 Side - 2 Holes)

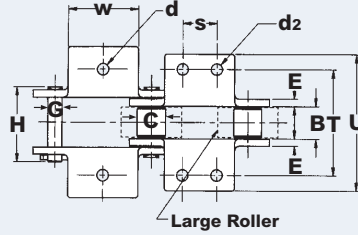

K-1 (Bent Lug 2 Sides - 1 Hole)
K-2 (Bent Lug 2 Sides - 2 Holes)



A-1



K-1

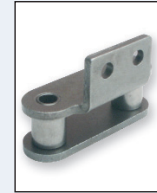

A-2

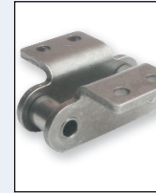

K-2

Syno® A-1, A-2 & K-1, K-2 Double Pitch Attachment Dimensions

Dimensions are in inches unless otherwise indicated.

Chain No.	A-1 / K-1 Across Attach Holes	C/L to Attach Hole	A-1 / K-1 Overall Width	C/L to Attach End	A-1 / K-1 Hole Diameter	A-2 / K-2 Hole Diameter	C/L to Top of Attach	Attachment Hole Pitch	Tab Width	A-1 / A-2 Additional Wgt/Att	K-1 / K-2 Additional Wgt/Att
	T	T/2	U	U/2	d	d ₂	h	s	w	Lbs/Pc	Lbs/Pc
C2040	1.000	0.500	1.520	0.760	0.138	0.138	0.358	0.375	0.750	0.007	0.014
C2050	1.250	0.625	1.900	0.950	0.209	0.209	0.437	0.468	0.937	0.014	0.028
C2060	1.686	0.843	2.430	1.215	0.209	0.209	0.579	0.562	1.130	0.033	0.066
C2080	2.190	1.095	3.190	1.595	0.280	0.280	0.752	0.750	1.500	0.070	0.140

Base Chain Dimensions

Chain No.	Pitch	Inside Width Min	Roller Diameter Max	Plate Height Max	Plate Thickness Max	Pin Diameter Max	Pin Length Max	Weight
	A	B	C	D	E/F	G	H	Lbs/Ft
C2040	1.000	0.309	0.312	0.465	0.061	0.157	0.646	0.34
C2050	1.250	0.370	0.400	0.591	0.080	0.200	0.803	0.56
C2060	1.500	0.495	0.469	0.701	0.127	0.235	1.126	0.96
C2080	2.000	0.620	0.625	0.949	0.159	0.313	1.409	1.62

Straight Lug Attachments

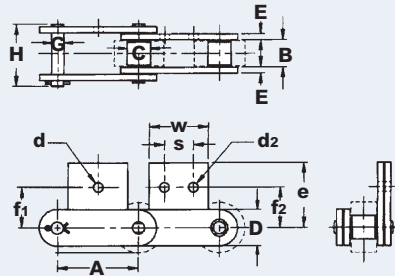

SA-1 (Straight Lug 1 Side - 1 Hole)
SA-2 (Straight Lug 1 Side - 2 Holes)

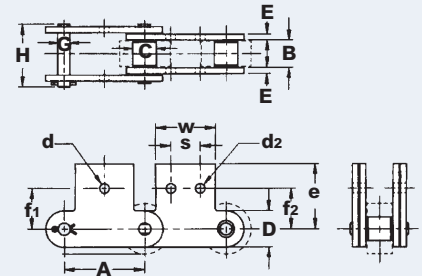

SK-1 (Straight Lug 2 Sides - 1 Hole)
SK-2 (Straight Lug 2 Sides - 2 Holes)

Syno® SA-1, SA-2 & SK-1, SK-2 Double Pitch Attachment Dimensions

Chain	SA-1 / SK-1 Hole Diameter	SA-2 / SK-2 Hole Diameter	C/L to Attach End	SA-1 / SK-1 C/L to Attach Hole	SA-2 / SK-2 C/L to Attach Hole	Attachment Hole Pitch	Tab Width	SA-1 / SA-2 Additional Wgt/Att	SK-1 / SK-2 Additional Wgt/Att
	d	d ₂	e	f ₁	f ₂	s	w	Lbs/Pc	Lbs/Pc
C2040	0.209	0.138	0.783	0.437	0.531	0.375	0.750	0.007	0.014
C2050	0.280	0.209	0.969	0.563	0.626	0.468	0.937	0.014	0.028
C2060	0.331	0.209	1.189	0.689	0.748	0.562	1.130	0.033	0.066
C2080	0.409	0.280	1.594	0.874	1.000	0.750	1.500	0.070	0.140

Base Chain Dimensions

Chain No.	Pitch	Inside Width Min	Roller Diameter Max	Plate Height Max	Plate Thickness Max	Pin Diameter Max	Pin Length Max	Weight
	A	B	C	D	E/F	G	H	Lbs/Ft
C2040	1.000	0.309	0.312	0.465	0.061	0.157	0.646	0.34
C2050	1.250	0.370	0.400	0.591	0.080	0.200	0.803	0.56
C2060	1.500	0.495	0.469	0.701	0.127	0.235	1.126	0.96
C2080	2.000	0.620	0.625	0.949	0.159	0.313	1.409	1.62

Syno® Attachment Chain

Extended Pin Attachments

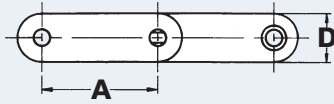
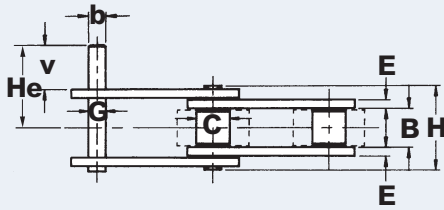

D-1 (1 Pin Extended Per Pin Link)

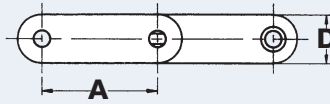
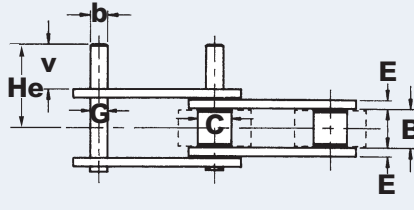

D-3 (2 Pins Extended Per Pin Link)

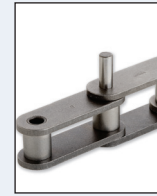

D-1

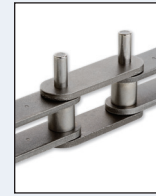

D-3

Syno® D-1 & D-3 Double Pitch Attachment Dimensions

Dimensions are in inches unless otherwise indicated.

Chain No.	C/L to End of Ext Pin	Ext Pin Diameter	Ext Pin Projection	D-1 Additional Wgt/Att	D-3 Additional Wgt/Att
	He	b	v	Lbs/Pc	Lbs/Pc
C2040	0.988	0.156	0.374	0.003	0.006
C2050	1.228	0.200	0.469	0.004	0.008
C2060	1.642	0.235	0.563	0.007	0.014
C2080	2.100	0.313	0.752	0.015	0.030

Base Chain Dimensions

Chain No.	Pitch	Inside Width Min	Roller Diameter Max	Plate Height Max	Plate Thickness Max	Pin Diameter Max	Pin Length Max	Weight
	A	B	C	D	E/F	G	H	Lbs/Ft
C2040	1.000	0.309	0.312	0.465	0.061	0.157	0.646	0.34
C2050	1.250	0.370	0.400	0.591	0.080	0.200	0.803	0.56
C2060	1.500	0.495	0.469	0.701	0.127	0.235	1.126	0.96
C2080	2.000	0.620	0.625	0.949	0.159	0.313	1.409	1.62