

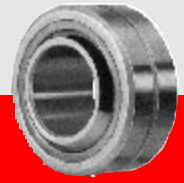

# Rod Ends and Spherical Bearings



## Interchange Tables



### 4-Piece Precision Rod Ends

#### Male

Heim	Spherco	Sealmaster	Aurora
HM3	TRE3	TRE-3	MM-3
HM4	TRE4	TRE-4	MM-4
HM5	TRE5	TRE-5	MM-5
HM6	TRE6	TRE-6	MM-6
HM7	TRE7	TRE-7	MM-7
HM8	TRE8	TRE-8	MM-8
HM10	TRE10	TRE-10	MM-10
HM12	TRE12	TRE-12	MM-12
HM16	TRE16	TRE-16	MM-16

#### Female

Heim	Spherco	Sealmaster	Aurora
HF3	TR3	TR-3	MW-3
HF4	TR4	TR-4	MW-4
HF5	TR5	TR-5	MW-5
HF6	TR6	TR-6	MW-6
HF7	TR7	TR-7	MW-7
HF8	TR8	TR-8	MW-8
HF10	TR10	TR-10	MW-10
HF12	TR12	TR-12	MW-12
HF16	TR16	TR-16	MW-16

#### Male with Lubricator

HM4G	TRE4N	TRE-4N	MM-4Z
HM5G	TRE5N	TRE-5N	MM-5Z
HM6G	TRE6N	TRE-6N	MM-6Z
HM7G	TRE7N	TRE-7N	MM-7Z
HM8G	TRE8N	TRE-8N	MM-8Z
HM10G	TRE10N	TRE-10N	MM-10Z
HM12G	TRE12N	TRE-12N	MM-12Z
HM16G	TRE16N	TRE-16N	MM-16Z

#### Female with Lubricator

HF4G	TR4N	TR-4N	MW-4Z
HF5G	TR5N	TR-5N	MW-5Z
HF6G	TR6N	TR-6N	MW-6Z
HF7G	TR7N	TR-7N	MW-7Z
HF8G	TR8N	TR-8N	MW-8Z
HF10G	TR10N	TR-10N	MW-10Z
HF12G	TR12N	TR-12N	MW-12Z
HF16G	TR16N	TR-16N	MW-16Z

#### Male with Left-Hand Thread

HML3	TREL3	TREL-3	MB-3
HML4	TREL4	TREL-4	MB-4
HML5	TREL5	TREL-5	MB-5
HML6	TREL6	TREL-6	MB-6
HML7	TREL7	TREL-7	MB-7
HML8	TREL8	TREL-8	MB-8
HML10	TREL10	TREL-10	MB-10
HML12	TREL12	TREL-12	MB-12
HML16	TREL16	TREL-16	MB-16

#### Female with Left-Hand Thread

HFL3	TRL3	TRL-3	MG-3
HFL4	TRL4	TRL-4	MG-4
HFL5	TRL5	TRL-5	MG-5
HFL6	TRL6	TRL-6	MG-6
HFL7	TRL7	TRL-7	MG-7
HFL8	TRL8	TRL-8	MG-8
HFL10	TRL10	TRL-10	MG-10
HFL12	TRL12	TRL-12	MG-12
HFL16	TRL16	TRL-16	MG-16

#### Male with Lubricator & Left-Hand Thread

HML4G	TREL4N	TREL-4N	MB-4Z
HML5G	TREL5N	TREL-5N	MB-5Z
HML6G	TREL6N	TREL-6N	MB-6Z
HML7G	TREL7N	TREL-7N	MB-7Z
HML8G	TREL8N	TREL-8N	MB-8Z
HML10G	TREL10N	TREL-10N	MB-10Z
HML12G	TREL12N	TREL-12N	MB-12Z
HML16G	TREL16N	TREL-16N	MB-16Z

#### Female with Lubricator & Left-Hand Thread

HFL4G	TRL4N	TRL-4N	MG-4Z
HFL5G	TRL5N	TRL-5N	MG-5Z
HFL6G	TRL6N	TRL-6N	MG-6Z
HFL7G	TRL7N	TRL-7N	MG-7Z
HFL8G	TRL8N	TRL-8N	MG-8Z
HFL10G	TRL10N	TRL-10N	MG-10Z
HFL12G	TRL12N	TRL-12N	MG-12Z
HFL16G	TRL16N	TRL-16N	MG-16Z

# Interchange Tables

## 4-Piece Commercial Rod Ends

### Male

Heim	Spherco	Sealmaster	Alinabal
HM3C	TM3	TM-3	VM-3-G
HM4C	TM4	TM-4	VM-4-G
HM5C	TM5	TM-5	VM-5-G
HM6C	TM6	TM-6	VM-6-G
HM7C	TM7	TM-7	VM-7-G
HM8C	TM8	TM-8	VM-8-G
HM10C	TM10	TM-10	VM-10-G
HM12C	TM12	TM-12	VM-12-G

### Female

Heim	Spherco	Sealmaster	Alinabal
HF3C	TF3	TF-3	VF-3-G
HF4C	TF4	TF-4	VF-4-G
HF5C	TF5	TF-5	VF-5-G
HF6C	TF6	TF-6	VF-6-G
HF7C	TF7	TF-7	VF-7-G
HF8C	TF8	TF-8	VF-8-G
HF10C	TF10	TF-10	VF-10-G
HF12C	TF12	TF-12	VF-12-G

### Male with Lubricator

HM4CG	TM4N	TM-4N	VM-4-G-8
HM5CG	TM5N	TM-5N	VM-5-G-8
HM6CG	TM6N	TM-6N	VM-6-G-8
HM7CG	TM7N	TM-7N	VM-7-G-8
HM8CG	TM8N	TM-8N	VM-8-G-8
HM10CG	TM10N	TM-10N	VM-10-G-8
HM12CG	TM12N	TM-12N	VM-12-G-8

### Female with Lubricator

HF4CG	TF4N	TF-4N	VF-4-G-8
HF5CG	TF5N	TF-5N	VF-5-G-8
HF6CG	TF6N	TF-6N	VF-6-G-8
HF7CG	TF7N	TF-7N	VF-7-G-8
HF8CG	TF8N	TF-8N	VF-8-G-8
HF10CG	TF10N	TF-10N	VF-10-G-8
HF12CG	TF12N	TF-12N	VF-12-G-8

### Male with Left-Hand Thread

HML3C	TML3	TML-3	VML-3-G
HML4C	TML4	TML-4	VML-4-G
HML5C	TML5	TML-5	VML-5-G
HML6C	TML6	TML-6	VML-6-G
HML7C	TML7	TML-7	VML-7-G
HML8C	TML8	TML-8	VML-8-G
HML10C	TML10	TML-10	VML-10-G
HML12C	TML12	TML-12	VML-12-G

### Female with Left-Hand Thread

HFL3C	TFL3	TFL-3	VFL-3-G
HFL4C	TFL4	TFL-4	VFL-4-G
HFL5C	TFL5	TFL-5	VFL-5-G
HFL6C	TFL6	TFL-6	VFL-6-G
HFL7C	TFL7	TFL-7	VFL-7-G
HFL8C	TFL8	TFL-8	VFL-8-G
HFL10C	TFL10	TFL-10	VFL-10-G
HFL12C	TFL12	TFL-12	VFL-12-G

### Male with Lubricator & Left-Hand Thread

HML4CG	TML4N	TML-4N	VML-4-G-8
HML5CG	TML5N	TML-5N	VML-5-G-8
HML6CG	TML6N	TML-6N	VML-6-G-8
HML7CG	TML7N	TML-7N	VML-7-G-8
HML8CG	TML8N	TML-8N	VML-8-G-8
HML10CG	TML10N	TML-10N	VML-10-G-8
HML12CG	TML12N	TML-12N	VML-12-G-8

### Female with Lubricator & Left-Hand Thread

HFL4CG	TFL4N	TFL-4N	VFL-4-G-8
HFL5CG	TFL5N	TFL-5N	VFL-5-G-8
HFL6CG	TFL6N	TFL-6N	VFL-6-G-8
HFL7CG	TFL7N	TFL-7N	VFL-7-G-8
HFL8CG	TFL8N	TFL-8N	VFL-8-G-8
HFL10CG	TFL10N	TFL-10N	VFL-10-G-8
HFL12CG	TFL12N	TFL-12N	VFL-12-G-8

## Studs

Manufacturer	Stud Designation	Sample Base Part Number	Sample Base Part Number with Stud
Heim	Y	HM4	HM4Y
Spherco	Y	TRE4	TRE4Y
Alinabal	S	AM-4-GP	AMS-4-GP
Aurora	S	MM-4	MM-4S
Sealmaster	Y	TRE-4	TRE-4Y
Superior	S	SPM-4	SPM-4S

Studs are available on the following Heim Rod End series:

HM	HF
HM C	HF C
M CR	F CR
CMHD	CFHD





## Precision Extra Capacity Rod Ends

### Male

Heim	Spherco	Sealmaster	Aurora
BHM4	ARE4	ARE-4	AM-4
BHM5	ARE5	ARE-5	AM-5
BHM6	ARE6	ARE-6	AM-6
BHM7	ARE7	ARE-7	AM-7
BHM8	ARE8	ARE-8	AM-8
BHM10	ARE10	ARE-10	AM-10
BHM12	ARE12	ARE-12	AM-12

### Female

Heim	Spherco	Sealmaster	Aurora
HFX4	AR4	AR-4	AW-4
HFX5	AR5	AR-5	AW-5
HFX6	AR6	AR-6	AW-6
HFX7	AR7	AR-7	AW-7
HFX8	AR8	AR-8	AW-8
HFX10	AR10	AR-10	AW-10
HFX12	AR12	AR-12	AW-12

### Male with Lubricator

BHM4G	ARE4N	ARE-4N	AM-4Z
BHM5G	ARE5N	ARE-5N	AM-5Z
BHM6G	ARE6N	ARE-6N	AM-6Z
BHM7G	ARE7N	ARE-7N	AM-7Z
BHM8G	ARE8N	ARE-8N	AM-8Z
BHM10G	ARE10N	ARE-10N	AM-10Z
BHM12G	ARE12N	ARE-12N	AM-12Z

### Female with Lubricator

HFX4G	AR4N	AR-4N	AW-4Z
HFX5G	AR5N	AR-5N	AW-5Z
HFX6G	AR6N	AR-6N	AW-6Z
HFX7G	AR7N	AR-7N	AW-7Z
HFX8G	AR8N	AR-8N	AW-8Z
HFX10G	AR10N	AR-10N	AW-10Z
HFX12G	AR12N	AR-12N	AW-12Z

### Male with Left-Hand Thread

BHML4	AREL4	AREL-4	AB-4
BHML5	AREL5	AREL-5	AB-5
BHML6	AREL6	AREL-6	AB-6
BHML7	AREL7	AREL-7	AB-7
BHML8	AREL8	AREL-8	AB-8
BHML10	AREL10	AREL-10	AB-10
BHML12	AREL12	AREL-12	AB-12

### Female with Left-Hand Thread

HFXL4	ARL4	ARL-4	AG-4
HFXL5	ARL5	ARL-5	AG-5
HFXL6	ARL6	ARL-6	AG-6
HFXL7	ARL7	ARL-7	AG-7
HFXL8	ARL8	ARL-8	AG-8
HFXL10	ARL10	ARL-10	AG-10
HFXL12	ARL12	ARL-12	AG-12

### Male with Lubricator & Left-Hand Thread

BHML4G	AREL4N	AREL-4N	AB-4Z
BHML5G	AREL5N	AREL-5N	AB-5Z
BHML6G	AREL6N	AREL-6N	AB-6Z
BHML7G	AREL7N	AREL-7N	AB-7Z
BHML8G	AREL8N	AREL-8N	AB-8Z
BHML10G	AREL10N	AREL-10N	AB-10Z
BHML12G	AREL12N	AREL-12N	AB-12Z

### Female with Lubricator & Left-Hand Thread

HFXL4G	ARL4N	ARL-4N	AG-4Z
HFXL5G	ARL5N	ARL-5N	AG-5Z
HFXL6G	ARL6N	ARL-6N	AG-6Z
HFXL7G	ARL7N	ARL-7N	AG-7Z
HFXL8G	ARL8N	ARL-8N	AG-8Z
HFXL10G	ARL10N	ARL-10N	AG-10Z
HFXL12G	ARL12N	ARL-12N	AG-12Z

## Precision Extra Capacity Heavy Duty Shank Rod Ends

### Male

Heim	Spherco	Sealmaster
HMX4	ARE420	ARE-4-20
HMX5	ARE520	ARE-5-20
HMX6	ARE620	ARE-6-20
HMX7	ARE720	ARE-7-20
HMX8	ARE820	ARE-8-20
HMX10	ARE1020	ARE-10-20
HMX12	ARE1220	ARE-12-20

### Male with Left-Hand Thread

Heim	Spherco	Sealmaster
HMXL4	AREL420	AREL-4-20
HMXL5	AREL520	AREL-5-20
HMXL6	AREL620	AREL-6-20
HMXL7	AREL720	AREL-7-20
HMXL8	AREL820	AREL-8-20
HMXL10	AREL1020	AREL-10-20
HMXL12	AREL1220	AREL-12-20

### Male with Lubricator

HMX4G	ARE420N	ARE-4-20N
HMX5G	ARE520N	ARE-5-20N
HMX6G	ARE620N	ARE-6-20N
HMX7G	ARE720N	ARE-7-20N
HMX8G	ARE820N	ARE-8-20N
HMX10G	ARE1020N	ARE-10-20N
HMX12G	ARE1220N	ARE-12-20N

### Male with Lubricator & Left-Hand Thread

HMXL4G	AREL420N	AREL-4-20N
HMXL5G	AREL520N	AREL-5-20N
HMXL6G	AREL620N	AREL-6-20N
HMXL7G	AREL720N	AREL-7-20N
HMXL8G	AREL820N	AREL-8-20N
HMXL10G	AREL1020N	AREL-10-20N
HMXL12G	AREL1220N	AREL-12-20N

## 2-Piece Commercial Rod Ends

### Male

Heim	Spherco	Sealmaster	Aurora	Alinabal
M3CR	CFM3	CFM-3	CM-3	AM-3-GP
M4CR	CFM4	CFM-4	CM-4	AM-4-GP
M5CR	CFM5	CFM-5	CM-5	AM-5-GP
M6CR	CFM6	CFM-6	CM-6	AM-6-GP
M7CR	CFM7	CFM-7	CM-7	AM-7-GP
M8CR	CFM8	CFM-8	CM-8	AM-8-GP
M10CR	CFM10	CFM-10	CM-10	AM-10-GP
M12CR	CFM12	CFM-12	CM-12	AM-12-GP

### Female

Heim	Spherco	Sealmaster	Aurora	Alinabal
F3CR	CFF3	CFF-3	CW-3	AF-3-GP
F4CR	CFF4	CFF-4	CW-4	AF-4-GP
F5CR	CFF5	CFF-5	CW-5	AF-5-GP
F6CR	CFF6	CFF-6	CW-6	AF-6-GP
F7CR	CFF7	CFF-7	CW-7	AF-7-GP
F8CR	CFF8	CFF-8	CW-8	AF-8-GP
F10CR	CFF10	CFF-10	CW-10	AF-10-GP
F12CR	CFF12	CFF-12	CW-12	AF-12-GP

### Male with Lubricator

Heim	Spherco	Sealmaster	Aurora	Alinabal
M4CRG	CFM4N	CFM-4N	-	AM-4-GP-8
M5CRG	CFM5N	CFM-5N	-	AM-5-GP-8
M6CRG	CFM6N	CFM-6N	CM-6Z	AM-6-GP-8
M7CRG	CFM7N	CFM-7N	CM-7Z	AM-7-GP-8
M8CRG	CFM8N	CFM-8N	CM-8Z	AM-8-GP-8
M10CRG	CFM10N	CFM-10N	CM-10Z	AM-10-GP-8
M12CRG	CFM12N	CFM-12N	CM-12Z	AM-12-GP-8

### Female with Lubricator

Heim	Spherco	Sealmaster	Aurora	Alinabal
F4CRG	CFF4N	CFF-4N	CW-4Z	AF-4-GP-8
F5CRG	CFF5N	CFF-5N	CW-5Z	AF-5-GP-8
F6CRG	CFF6N	CFF-6N	CW-6Z	AF-6-GP-8
F7CRG	CFF7N	CFF-7N	CW-7Z	AF-7-GP-8
F8CRG	CFF8N	CFF-8N	CW-8Z	AF-8-GP-8
F10CRG	CFF10N	CFF-10N	CW-10Z	AF-10-GP-8
F12CRG	CFF12N	CFF-12N	CW-12Z	AF-12-GP-8

### Male with Left-Hand Thread

Heim	Spherco	Sealmaster	Aurora	Alinabal
ML3CR	CFML3	CFML-3	CB-3	AML-3-GP
ML4CR	CFML4	CFML-4	CB-4	AML-4-GP
ML5CR	CFML5	CFML-5	CB-5	AML-5-GP
ML6CR	CFML6	CFML-6	CB-6	AML-6-GP
ML7CR	CFML7	CFML-7	CB-7	AML-7-GP
ML8CR	CFML8	CFML-8	CB-8	AML-8-GP
ML10CR	CFML10	CFML-10	CB-10	AML10-GP
ML12CR	CFML12	CFML-12	CB-12	AML-12-GP

### Female with Left-Hand Thread

Heim	Spherco	Sealmaster	Aurora	Alinabal
FL3CR	CFFL3	CFFL-3	CG-3	AFL-3-GP
FL4CR	CFFL4	CFFL-4	CG-4	AFL-4-GP
FL5CR	CFFL5	CFFL-5	CG-5	AFL-5-GP
FL6CR	CFFL6	CFFL-6	CG-6	AFL-6-GP
FL7CR	CFFL7	CFFL-7	CG-7	AFL-7-GP
FL8CR	CFFL8	CFFL-8	CG-8	AFL-8-GP
FL10CR	CFFL10	CFFL-10	CG-10	AFL10-GP
FL12CR	CFFL12	CFFL-12	CG-12	AFL-12-GP

### Male with Lubricator & Left-Hand Thread

Heim	Spherco	Sealmaster	Aurora	Alinabal
ML4CRG	CFML4N	CFML-4N	-	AML-4-GP-8
ML5CRG	CFML5N	CFML-5N	-	AML-5-GP-8
ML6CRG	CFML6N	CFML-6N	CB-6Z	AML-6-GP-8
ML7CRG	CFML7N	CFML-7N	CB-7Z	AML-7-GP-8
ML8CRG	CFML8N	CFML-8N	CB-8Z	AML-8-GP-8
ML10CRG	CFML10N	CFML-10N	CB-10Z	AML10-GP-8
ML12CRG	CFML12N	CFML-12N	CB-12Z	AML-12-GP-8

### Female with Lubricator & Left-Hand Thread

Heim	Spherco	Sealmaster	Aurora	Alinabal
FL4CRG	CFFL4N	CFFL-4N	CG-4Z	AFL-4-GP-8
FL5CRG	CFFL5N	CFFL-5N	CG-5Z	AFL-5-GP-8
FL6CRG	CFFL6N	CFFL-6N	CG-6Z	AFL-6-GP-8
FL7CRG	CFFL7N	CFFL-7N	CG-7Z	AFL-7-GP-8
FL8CRG	CFFL8N	CFFL-8N	CG-8Z	AFL-8-GP-8
FL10CRG	CFFL10N	CFFL-10N	CG-10Z	AFL10-GP-8
FL12CRG	CFFL12N	CFFL-12N	CG-12Z	AFL-12-GP-8

## Commercial Self-Lubricating Rod Ends

### Male

Heim	Spherco	Sealmaster	Alinabal	Superior
CMHD3	CTMD3	CTMD-3	PM-3-G	SPM-3
CMHD4	CTMD4	CTMD-4	PM-4-G	SPM-4
CMHD5	CTMD5	CTMD-5	PM-5-G	SPM-5
CMHD6	CTMD6	CTMD-6	PM-6-G	SPM-6
CMHD7	CTMD7	CTMD-7	PM-7-G	SPM-7
CMHD8	CTMD8	CTMD-8	PM-8-G	SPM-8
CMHD10	CTMD10	CTMD-10	PM-10-G	SPM-10
CMHD12	CTMD12	CTMD-12	PM-12-G	SPM-12

### Female

Heim	Spherco	Sealmaster	Alinabal	Superior
CFHD3	CTFD3	CTFD-3	PF-3-G	SPF-3
CFHD4	CTFD4	CTFD-4	PF-4-G	SPF-4
CFHD5	CTFD5	CTFD-5	PF-5-G	SPF-5
CFHD6	CTFD6	CTFD-6	PF-6-G	SPF-6
CFHD7	CTFD7	CTFD-7	PF-7-G	SPF-7
CFHD8	CTFD8	CTFD-8	PF-8-G	SPF-8
CFHD10	CTFD10	CTFD-10	PF-10-G	SPF-10
CFHD12	CTFD12	CTFD-12	PF-12-G	SPF-12

### Male Left-Hand Thread

Heim	Spherco	Sealmaster	Alinabal	Superior
CMHDL3	CTMDL3	CTMDL-3	PML-3-G	SPML-3
CMHDL4	CTMDL4	CTMDL-4	PML-4-G	SPML-4
CMHDL5	CTMDL5	CTMDL-5	PML-5-G	SPML-5
CMHDL6	CTMDL6	CTMDL-6	PML-6-G	SPML-6
CMHDL7	CTMDL7	CTMDL-7	PML-7-G	SPML-7
CMHDL8	CTMDL8	CTMDL-8	PML-8-G	SPML-8
CMHDL10	CTMDL10	CTMDL-10	PML-10-G	SPML-10
CMHDL12	CTMDL12	CTMDL-12	PML-12-G	SPML-12

### Female Left-Hand Thread

Heim	Spherco	Sealmaster	Alinabal	Superior
CFHDL3	CTFDL3	CTFDL-3	PFL-3-G	SPFL-3
CFHDL4	CTFDL4	CTFDL-4	PFL-4-G	SPFL-4
CFHDL5	CTFDL5	CTFDL-5	PFL-5-G	SPFL-5
CFHDL6	CTFDL6	CTFDL-6	PFL-6-G	SPFL-6
CFHDL7	CTFDL7	CTFDL-7	PFL-7-G	SPFL-7
CFHDL8	CTFDL8	CTFDL-8	PFL-8-G	SPFL-8
CFHDL10	CTFDL10	CTFDL-10	PFL-10-G	SPFL-10
CFHDL12	CTFDL12	CTFDL-12	PFL-12-G	SPFL-12

## 2-Piece Precision Spherical Bearings

### Alloy Steel Ball and Race

Heim	Spherco	Sealmaster	Alinabal
LHA3	SBG3S	SBG-3S	CBA-3-B2
LHA4	SBG4S	SBG-4S	CBA-4-B2
LHA5	SBG5S	SBG-5S	CBA-5-B2
LHA6	SBG6S	SBG-6S	CBA-6-B2
LHA7	SBG7S	SBG-7S	CBA-7-B2
LHA8	SBG8S	SBG-8S	CBA-8-B2
LHA9	SBG9S	SBG-9S	CBA-9-B2
LHA10	SBG10S	SBG-10S	CBA-10-B2
LHA12	SBG12S	SBG-12S	CBA-12-B2
LHA14	SBG14S	SBG-14S	CBA-14-B2
LHA16	SBG16S	SBG-16S	CBA-16-B2

### Alloy Steel Ball, Aluminum Bronze Race

Heim	Spherco	Sealmaster
LHB2	SBG2	
LHB3	SBG3	SBG-3
LHB4	SBG4	SBG-4
LHB5	SBG5	SBG-5
LHB6	SBG6	SBG-6
LHB7	SBG7	SBG-7
LHB8	SBG8	SBG-8
LHB9	SBG9	SBG-9
LHB10	SBG10	SBG-10
LHB12	SBG12	SBG-12
LHB14	SBG14	SBG-14
LHB16	SBG16	SBG-16

### 440C Ball, 300 Series Stainless Steel Race

Heim	Spherco	Sealmaster
LHSS2	SBG2SS	-
LHSS3	SBG3SS	SBG-3SS
LHSS4	SBG4SS	SBG-4SS
LHSS5	SBG5SS	SBG-5SS
LHSS6	SBG6SS	SBG-6SS
LHSS7	SBG7SS	SBG-7SS
LHSS8	SBG8SS	SBG-8SS
LHSS9	SBG9SS	SBG-9SS
LHSS10	SBG10SS	SBG-10SS
LHSS12	SBG12SS	SBG-12SS
LHSS14	SBG14SS	SBG-14SS
LHSS16	SBG16SS	SBG-16SS

### 440C Ball, 17-4 PH Stainless Steel Race

Heim	Spherco	Sealmaster
COS3	COR3	COR-3
COS4	COR4	COR-4
COS5	COR5	COR-5
COS6	COR6	COR-6
COS7	COR7	COR-7
COS8	COR8	COR-8
COS9	COR9	COR-9
COS10	COR10	COR-10
COS12	COR12	COR-12
COS14	COR14	COR-14
COS16	COR16	COR-16

## 2-Piece Commercial Spherical Bearings

### Standard Series

Heim	Spherco	Sealmaster	Alinabal	Superior
COM3	COM3	COM-3	COM-3-E	COM-3
COM4	COM4	COM-4	COM-4-E	COM-4
COM5	COM5	COM-5	COM-5-E	COM-5
COM6	COM6	COM-6	COM-6-E	COM-6
COM7	COM7	COM-7	COM-7-E	COM-7
COM8	COM8	COM-8	COM-8-E	COM-8
COM10	COM10	COM-10	COM-10-E	COM-10
COM12	COM12	COM-12	COM-12-E	COM-12
COM14	COM14	COM-14	COM-14-E	COM-14
COM16	COM16	COM-16	COM-16-E	COM-16

## 4-Piece Precision Spherical Bearings

### Alloy Steel Ball and Race

Heim	Spherco
LSS3	FSBG3
LSS4	FSBG4
LSS5	FSBG5
LSS6	FSBG6
LSS7	FSBG7
LSS8	FSBG8
LSS10	FSBG10
LSS12	FSBG12
LSS14	FSBG14
LSS16	FSBG16

### Large Bore Series

Heim	Spherco	Aurora	Sealmaster
LH16D	BH16LS	HCOM-16	BH-16LS
LH19D	BH19LS	HCOM-19	BH-19LS
LH20D	BH20LS	HCOM-20	BH-20LS
LH24D	BH24LS	HCOM-24	BH-24LS
LH28D	BH28LS	HCOM-28	BH-28LS
LH32D	BH32LS	HCOM-32	BH-32LS

### Alloy Steel Ball, Carbon Steel Race

Heim	Spherco	Sealmaster
LS3	FLBG3	FLBG-3
LS4	FLBG4	FLBG-4
LS5	FLBG5	FLBG-5
LS6	FLBG6	FLBG-6
LS7	FLBG7	FLBG-7
LS8	FLBG8	FLBG-8
LS10	FLBG10	FLBG-10
LS12	FLBG12	FLBG-12
LS14	FLBG14	FLBG-14
LS16	FLBG16	FLBG-16

### Sealed

Heim	Spherco	Sealmaster
LH12PP	BTS12LS	BTS-12LS
LH16PP	BTS16LS	BTS-16LS
LH20PP	BTS20LS	BTS-20LS
LH24PP	BTS24LS	BTS-24LS

# Unground Ball Bearings

## Commercial Series Ball Bearings

### Plain Ball Bearings

Part Number	Bore (in.)	O.D. (in.)	Width (in.)	Capacity* (lbf)
R81812	1/2	1 1/8	3/8	390
R82214	1/2	1 3/8	7/16	560
R82414	1/2	1 1/2	7/16	800
R102214	5/8	1 3/8	7/16	560
R102414	5/8	1 1/2	7/16	800
R102612	5/8	1 5/8	3/8	880
R122214	3/4	1 3/8	7/16	600
R122612	3/4	1 5/8	3/8	880
R122818	3/4	1 3/4	9/16	900
R163216	1	2	1/2	1050

\*Capacity at 50 revolutions per minute

### Flanged Ball Bearings

Part Number	Bore (in.)	O.D. (in.)	Flange Diam (in.)	Width** (in.)	Capacity* (lbf)
RF81812	1/2	1 1/8	1 1/4	3/8	390
RF82214	1/2	1 3/8	1 1/2	7/16	560
RF82414	1/2	1 1/2	1 5/8	7/16	800
RF102214	5/8	1 3/8	1 1/2	7/16	560
RF102414	5/8	1 1/2	1 5/8	7/16	800
RF102616	5/8	1 5/8	1 3/4	1/2	880
RF122214	3/4	1 3/8	1 1/2	7/16	600
RF122414	3/4	1 1/2	1 5/8	7/16	720
RF122616	3/4	1 5/8	1 3/4	1/2	900
RF163216	1	2	2 1/8	1/2	1050

\*Capacity at 50 revolutions per minute

\*\*Width dimension is overall width, please consult diagram.

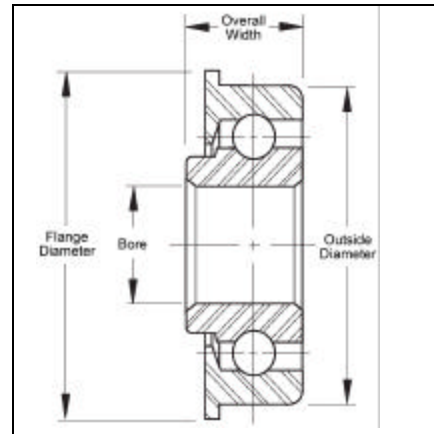
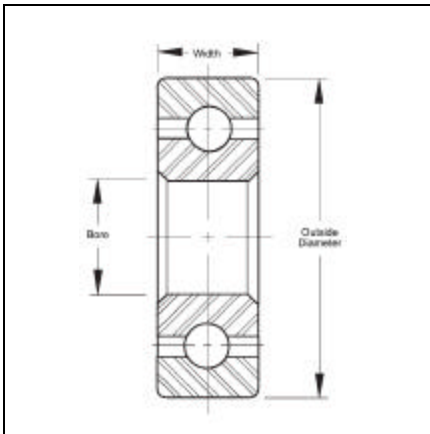

R 10 22 14 PP

- Seal Designation:**
- Add "P" to suffix to indicate one synthetic rubber seal
  - Add "PP" to suffix to indicate two synthetic rubber seals
  - Add "MP" to suffix to indicate mechanical shield
  - Leave blank to indicate no seals or shields
- Width:**
- 1/32 inch increments
- O.D.:**
- 1/16 inch increments
- Bore:**
- 1/16 inch increments
- Series Designation:**
- R (or RF if flanged) series commercial ball bearing
  - Outer Ring: carbon steel, case hardened
  - Inner Ring: carbon steel, case hardened
  - Balls: carbon steel, case hardened



**Note:**

This interchange guide is for reference only. It has been developed around basic dimensional and material information. **A listing in this interchange guide does not guarantee an exact duplicate product.** Specific applications may require you to contact Heim Engineering.



**Heim Bearings**  
ISO 9002  
AS 9000

[www.rbcbearings.com](http://www.rbcbearings.com)  
800.356.6584