

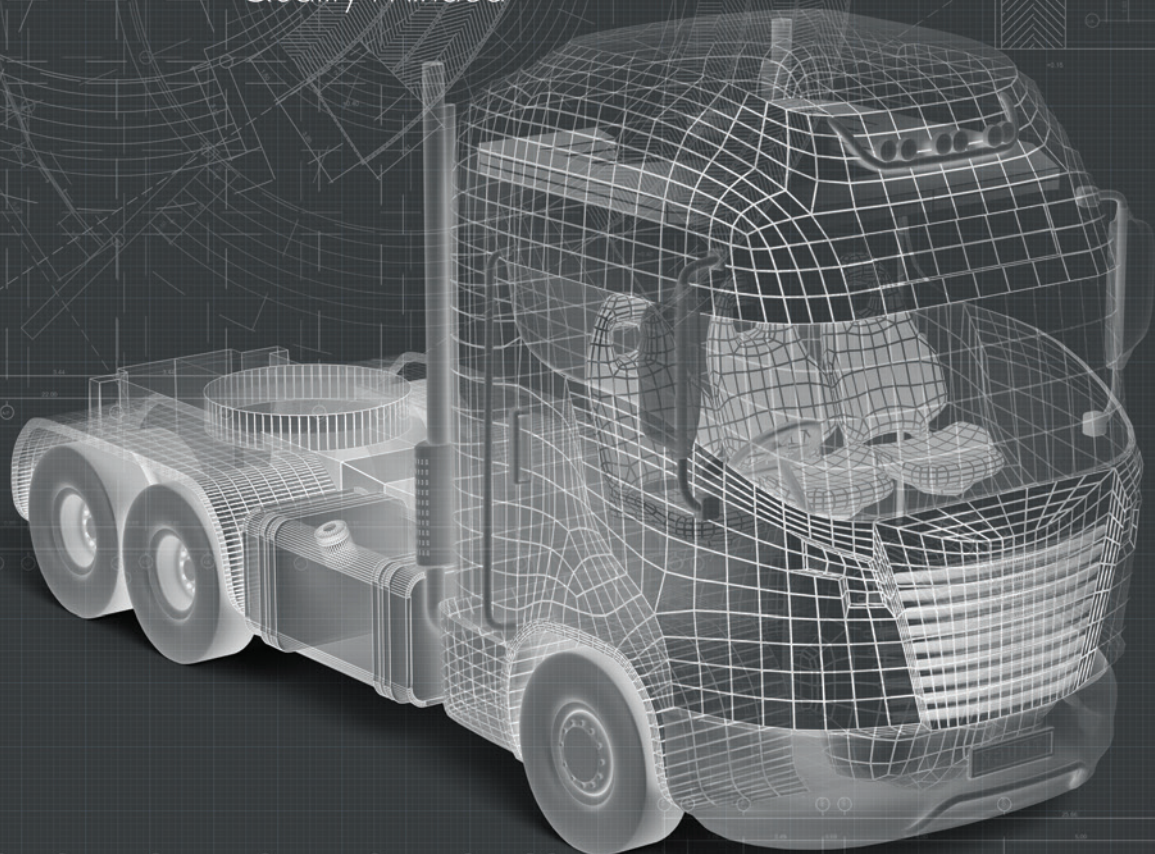

CRAFT BEARINGS

Quality Minded



COMMERCIAL VEHICLE BEARING CATALOG



www.craft-bearings.com





**CRAFT
BEARINGS**

CRAFT BEARINGS

Produces and supplies comprehensive range of industrial and automotive bearings globally





METAL CHEMICAL
COMPOSITION



HARDNESS &
AXIAL CLEARANCE



DIMENSIONAL
MEASUREMENT



RADIAL CLEARANCE



QUALITY CONTROL LABORATORY

We have the latest measurement and quality-assurance systems utilizing high-quality and precise measuring equipment with which we conduct all necessary tests to guarantee high quality of entire production



BEARING LIFE



GREASE LEAKAGE
& DUSTPROOFING



NOISE & VIBRATION



WAVING & ROUGHNESS



CONTINUOUS PARTICIPATION IN AUTOSPORT



WORKING WITH 80 COUNTRIES WORLDWIDE



CRAFT BEARINGS QUALITY CONTROL LABORATORY	7
LUBRICATION	10
BEARING FAILURES	11
EUROPEAN COMMERCIAL VEHICLES	14
TRUCK & TRAILER WHEEL END KITS	15
TRUCK & TRAILER WHEEL END HUBS	23
TRUCK & TRAILER WHEEL END MODULES	25
TRAILER AXLES	27
TAPERED ROLLER BEARINGS	37
BALL BEARINGS	43
CIS COMMERCIAL VEHICLES	46
AUTOMOTIVE JOINTS	57
ROLLERS	58
INSTRUCTIONS	59
CROSS REFERENCES	64
CERTIFICATION	68

CRAFT bearings Quality Control Laboratory

All CRAFT bearings production is guaranteed because it is tested twice to meet high standards: first in the factory and second time in the CRAFT bearings Quality Control Laboratory in Kaunas, Lithuania.

The CRAFT bearings Quality Control Laboratory was established in 2012 with the help of University of Technology. We conduct all necessary tests with the latest measurement and quality-assurance systems utilizing high-quality and precise measuring equipment:

- Bearing Life (Longevity)
- Bearing Waviness
- Noise and Vibration
- Radial and Axial clearance
- Hardness
- Geometry
- Metal structure
- Roundness
- Roughness
- Grease leakage
- Dimension measurement
- Spectroscopic analysis



Roughness, Roundness and Form analysis

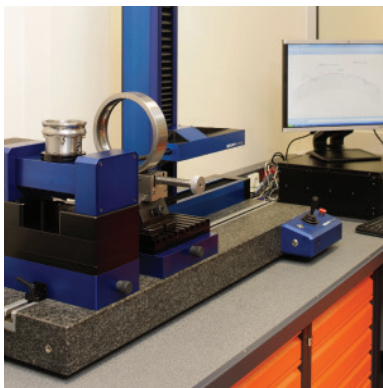

Characterization of surface topography is important in applications involving friction, lubrication and wear. Generally it has been found that friction increases with average roughness.

An accurate knowledge of the expected bearing life is essential to the proper selection of ball bearings. Bearings principally fail due to fatigue if they are properly lubricated, mounted and sealed against dirt entry. Fatigue strongly correlates with the surface roughness. One of the most important fundamental forms for engineering components is the circular cross-section. Circular forms arise in many applications, particularly in bearing surfaces. Roughness, roundness and bearing forms' testers are critically important elements in the development of precision-tolerance capabilities. For such measurements, we use the German-made OPTACOM surface measuring machine VC-10-EL.

Noise and vibration testing for bearings

A noisy application might be caused by wavy bearing components, local defects in the rings and balls or by dirt particles in the bearing. While basic requirements for a bearing such as stiffness, load capacity, speed limit and service life play a critical role in applications, low noise and vibration are even more important.

All of these quality issues for bearings can be tested with the following bearing vibration equipment: SN-X, S9912-X. High-tech analyses and measurements such as frequency analysis and further advanced analyses pinpoint faults. Spectral masks help to optimize the bearing performance in the particular customer application. With some experience, the measurement results of these machines can also be used by experts to detect imperfect manufacturing steps. The introduction of a worldwide calibration system enables vibration equipment to operate according to international standards.



Hardness Testing for bearings

Hardness is the property of a material that enables it to resist plastic deformation, usually by penetration. Hardness is not an intrinsic material property dictated by precise definitions in terms of fundamental units of mass, length and time. A hardness property value is the result of a defined measurement procedure. The hardness test of bearing surfaces is conducted with the SHR-3000 tester using the Rockwell hardness test method. The Rockwell hardness test method consists of indenting the test material with a diamond cone or a hardened steel ball indenter. The indenter is forced into the test material under a preliminary minor load of usually 150 kg. When equilibrium has been reached, an indicating device which follows the movements of the indenter and responds to changes in depth of penetration of the indenter is set to a datum position.

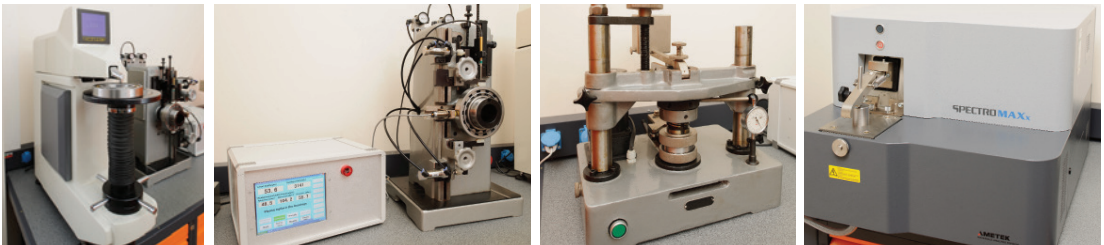

Axial & Radial Internal Clearance testing for bearings

A bearing's internal clearance is defined as the total distance in which one bearing ring can be moved in relation to the other in the radial direction (radial internal clearance) or in the axial direction (axial internal clearance). Too little or too much internal clearance will significantly influence factors such as heat, vibration, noise and fatigue life. In extreme applications that produce high or low temperatures, this clearance needs to be considered in the overall design to compensate for thermal expansion and contraction of housings and shafts. Bearings having an internal clearance other than Normal are identified by the suffixes C1 to C5.

Materials testing for bearings rings and rolling elements

There are essentially two choices for the material used in ball bearings - chrome steel or stainless steel. Since the material plays a major part in the performance of a bearing in any given application, it is very important to use the correct material. Note that the specified material applies to the load-bearing components only - the rings and the balls. The retainer and the shields, if used, are usually made from a different material and are subject to separate specifications. Chrome steel is the standard material used for ball bearing applications where load capacity is the main consideration. The machinability of this steel is excellent, giving smooth, low-noise raceway finishes together with superior life. A chrome steel material is

recommended in applications where corrosion is not a factor. Stainless steel is the standard material for miniature and instrument ball bearings where corrosion resistance is more important than load capacity. These materials have evolved in response to different manufacturing and application needs. It is important to note that the actual material used is generally determined by the manufacturer and cannot be specified by the user.

The bearing's metal structure is easily determined using the analytical instrument SPECTROMAXx made in Germany. This instrument is able to monitor the carbon signal during the pre-spark phase and to recognize the existence and proportion of free graphite in the sample.

Dimension measuring for bearings parts

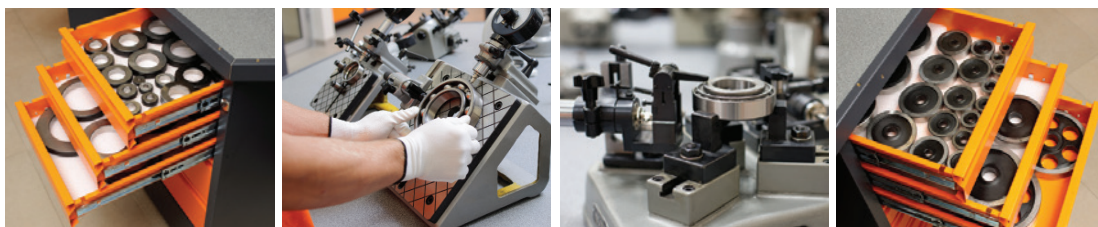

The Universal Length Measurer (ULM) is a kind of length measuring instrument that integrates fine mechanics, an optical system and electrical parts into an organic whole. This instrument is used for direct measurement and comparative measurement for dimensions of parts and components. It also offers additional equipment for carrying out various special measurements.

Bearing “tolerances”, or dimensional accuracy and running accuracy, are regulated by ISO standards. For dimensional accuracy, these standards prescribe the tolerances necessary when installing bearings on shafts or in housings. Running accuracy is defined as the allowable limits for bearing runout during operation. Dimensional accuracy constitutes the acceptable values for bore diameter, outer diameter, assembled bearing width and bore diameter uniformity in chamfer dimensions, allowable inner ring tapered bore deviation and shape error. Average bore diameter variation, outer diameter variation, average outer diameter unevenness as well as raceway width and height variation (for thrust bearings) are also included. Running accuracy constitutes the acceptable values for inner and outer ring radial runout and axial runout, inner ring side runout and outer ring outer diameter runout. All these dimensions of the bearing parts are measured with high-quality equipment.

Bearing life and grease leakage testing

Bearings are run to failure, using accelerated speeds and loads and continuous vibration monitoring. Bearing life testing confirms that any changes to components, materials or the manufacturing process will not negatively impact the bearing's characteristics.

Proper lubrication is a crucial factor in maximizing bearing service life. Contamination can have a great impact on the grease service life and the bearing service life itself. Using high-quality measuring and test equipment, CRAFT bearings conducts grease-leaking and bearing-life research.



Features

In regards to grease and its application, there are critical elements used in the formulation process that must be considered. These elements include the thickener type and concentration, lubricant type, viscosity and additive package. Greases are rated by the National Lubricating Grease Institute (NLGI) and range from 000 through 6. An NLGI 2 grade is typically the specification used in automotive greases. Regardless of the application, greases should reduce friction and wear, protect against corrosion, seal bearings from water and contaminants. While one of the main reasons for grease failure is selecting the wrong type of grease for the intended application, there may also be other causes, such as incompatibility resulting in excessive softening of the grease, contamination leading to excessive wear or applying too little or too much grease for the application. Over 50 percent of all rolling-bearing defects are due to improper lubrication (see **Chart 1**). In close cooperation with our quality engineers and manufacturing shops we made conclusions and the following greases are used in our automotive bearings: ESSO/ MOBIL RONEX MP, SHELL Alvania RL2 (Gadus S2 V100 2), China Hangu No.2 & Kyodo Yushi RareMax AF-1 (**Table 1**)

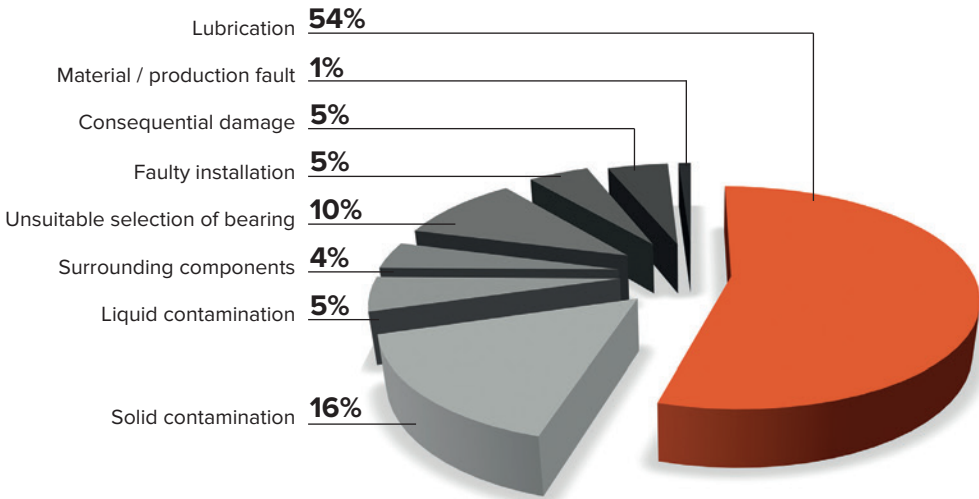

Chart 1 Common causes of rolling-bearings failure

Grease brands	Manufacturer	Thickener	Base Oil
RareMax AF-1	Kyodo Yushi Co	Urea	Mineral
Ronex MP	Exxon/Mobil	Lithium	Mineral
Alvania RL2	Shell	Lithium	Mineral
Hangu No.2	Great Wall	Urea	Mineral

Table 1 Grease brands used in CRAFT Automotive bearings

Common Causes of Wheel Hub Failures

Wheel hub assemblies are designed to require little or no maintenance once they are installed, but that does not mean assemblies can not fail, for a variety of reasons. Some of these failures are associated with actions that take place during the installation process, while others are attributable to weather and road conditions. If you are troubleshooting failures, look to these common root causes for answers.

I Excessive Vehicle Loads - If customers' vehicles are constantly overloaded past recommended carrying capacities, vehicles can end up getting damaged, which includes the failure of wheel hub assemblies. It is important to follow manufacturer guidelines and specifications for the intended use of vehicles.

II Road Hazards - Whether it is a pothole, large rock or some other form of obstruction or deformity, road hazards can damage car wheels and their supporting structures. This includes wheel bearings and wheel hub assemblies, along with other parts in wheel areas.

III Poor Handling - If a customer abuses their vehicle, all sorts of bad things can happen. This includes the misalignment of wheels and tires, along with the damaging of important parts, such as wheel hub assemblies.

It is a known statistical fact that greater than 90% of all bearing failures are due to external influences. These include lubrication conditions, assembly installation techniques, contamination of the operating environment, and improper bearing size selection for the application. Under proper operating conditions, a bearing should only fail from fatigue which is predictable based on the bearing size and it's application parameters. For that reason, we present this guide as a reference towards understanding the causes and effects of bearing damage:

1. Fatigue spalling

Change in the structure, which is caused by the repeated stresses developed in the contacts between the rolling elements and the raceways.



Figure 1 Fatigue spalling on the raceway

2. Wear

Can be defined as a process where interaction between two surfaces or bounding faces of solids within the

working environment results in dimensional loss of one solid, with or without any actual decoupling and loss of material. Wear can be divided into 2 groups : Adhesive and Abrasive.



Figure 2 Adhesion occurs in equipment operating in the mixed and boundary lubrication regimes due to insufficient lube supply, inadequate viscosity, incorrect internal clearances, incorrect installation or misalignment.



Figure 3 Abrasive wear is the result of inadequate lubrication or the ingress of foreign particles.

3. Corrosion

A chemical reaction on metal surfaces. Mostly common appearances of corrosion are: moisture, frictional, fretting and false brinelling corrossions.



Figure 4 Rusting of a bearing inner ring caused by moisture in a lubricant.



Figure 5 Fretting corrosion occurs in fit interfaces that are transmitting loads under oscillating contact surface micro-movements.

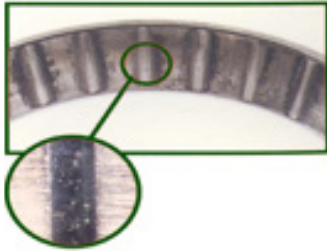

Figure 6 Localized wear spots made by rolling elements on raceway due to limited rolling/ repeated impact are called false brinelling.

4. Electrical erosion

Removal of material from the contact surfaces caused by the passage of electric current. Can be described in 2 types: electrical pitting and electrical fluting.



Figure 7 Electrical pitting are small burns created by arcs from improper electric grounding while the bearing is stationary.



Figure 8 When electric currents pass through a bearing, there is arcing and burning at the points between the races and the rolling elements where the current jumps the air gap.

5. Plastic deformation

Appears on a bearing whenever the yield strength of the material is exceeded.



Figure 9 Plastic deformation appearance on the raceway after overloading.



Figure 10 Cage deformation

caused by improperly installation or dropped bearing.

6. Indentation from debris

A result of contamination during mounting operation or inadequate sealing.



Figure 11 Raceways and rolling elements can incur indentations and nicks caused by hard, possibly sharp, objects.

7. Fracture and cracking

In general are initiated and propagated when the ultimate tensile strength of the material is exceeded.



Figure 12 Forced fracture caused by a direct hammer blow.



Figure 13 Thermal cracking is caused by high frictional heating due to sliding motion.



CRAFT BEARINGS

Quality Minded



Truck & trailer bearings

www.craft-bearings.com

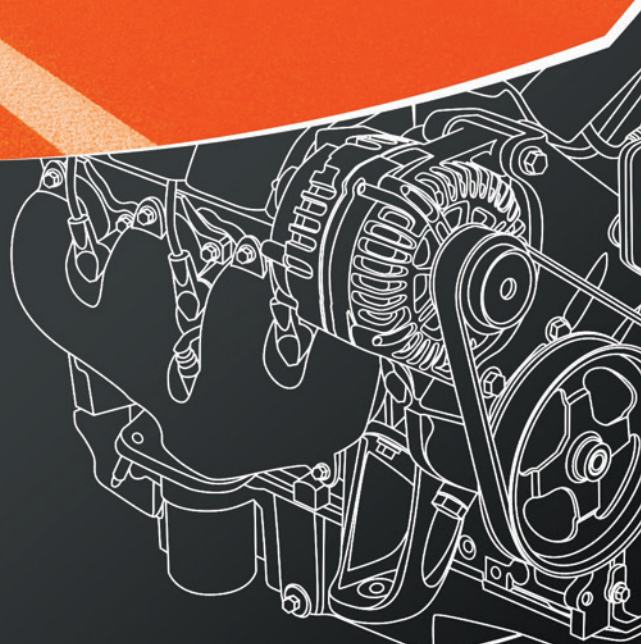

CRAFT Automotive for European commercial vehicles

CRAFT Bearings Automotive supplies wide range bearings for aftermarket of leading manufacturers of commercial vehicles and trailer brands as DAF, VOLVO, MERCEDES-BENZ, SCANIA, MAN, IVECO, RENAULT, SAF, BPW, ROR, GIGANT, SCHMITZ - CARGOBULL.

High quality automotive products whose parts are manufactured under continued control, guarantees the bearing ability to withstand harsh conditions.

Product list:

- Wheel end hubs
- Wheel end kits
- Wheel end modules
- Tapered roller and ball bearings
- Rollers
- Automotive joints

Features:

- Wheel end hubs requires minimum maintenance, as it is already lubricated for life;
- Wheel end kits are provided with all necessary parts required for replacement: seals, grease, mounting rings;
- Wheel end modules are easy to adjust, as they are already pre-set by the manufacturer;
- Tapered roller bearings frequently used in truck axles are able to withstand considerable axial and radial loading. By enlarging the outer ring angle, the bearing ability to withstand the axial load increases.
- Ball bearing is one of the most popular type of rolling bearings. Widely used also in trucks - transmission, reduction gears and engines. We present ball bearing in accuracy class 6, closed type.
- Rollers and roller systems for the single & tandem side curtains, tent halls and roof.
- Tapered roller and ball bearings for automotive industry has increased wear resistance which results in increase of work-life in comparison with general usage bearings.
- CRAFT Bearings conducted extensive research on color schemes, designs and types of new product packaging that is the most appealing to its intended consumer.

41.01594

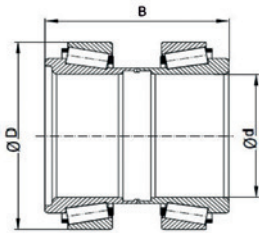

OEM references

180 1594

Cross references

FAG 566283.01.H195

Fersa F 200017

SKF VKBA 5431

Fitting position

Rear axle

Dimensions

d (mm)	D (mm)	B (mm)	Weight (kg)
99,8/100	148/148	67,5/67,5	6

Brand



DAF

45, 55
75 CF
85, 85 CF
95, 95 XF
CF 65, CF 75,
CF 85
LF 45, LF 55
XF 95, 105

41.01595

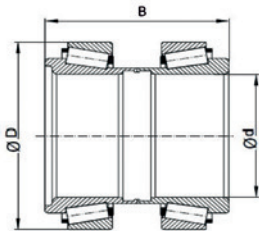

OEM references

180 1595

Cross references

FAG 566834.H195

Fersa F 200019

SKF VKBA 5429

Fitting position

Front axle

Dimensions

d (mm)	D (mm)	B (mm)	Weight (kg)
69,8/70	119,7/124,7	48,82/61,22	4,5

Brand



DAF

45
55
75 CF
85, 85 CF
95, 95 XF
CF 65, CF 75,
CF 85
LF 45, LF 55
XF 95, 105

41.03628

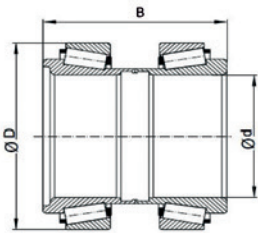

OEM references

180 1595

Cross references

FAG	566834.H195
Fersa	F 200019
SKF	VKBA 5429

Fitting position

Rear axle

Dimensions

d (mm)	D (mm)	B (mm)	Weight (kg)
69,8/70	120/125	35/47,25	4,15

Brand



DAF	45 55 75 CF 85, 85 CF 95, 95 XF CF 65, CF 75, CF 85 LF 45, LF 55 XF 95, 105
-----	---

41.05052

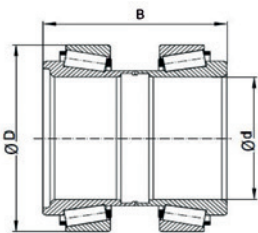

OEM references

1812161 / 1818003 / 1801594

Cross references

FAG	566283.01.H195
Fersa	F 200017
SKF	VKBA 5431

Fitting position

Rear axle

Dimensions

d (mm)	D (mm)	B (mm)	Weight (kg)
100	148	135	5,7

Brand



DAF	45, 55 75 CF 85, 85 CF 95, 95 XF CF 65, CF 75, CF 85 XF 95, 105 LF 45, LF 55
-----	---

41.05923

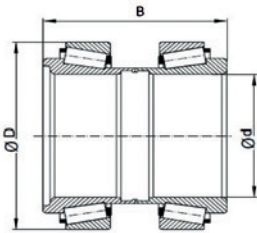

OEM references

1818004 / 1801592

Cross references

FAG	566074.H195
Fersa	F 200016
SKF	VKBA 5453

Fitting position

Front axle

Dimensions

d (mm)	D (mm)	B (mm)	Weight (kg)
69,8/70	125/125	57/57	4,7

Brand



DAF	75CF 85, 85CF LF55 XF95 XF95II XF 95, 105 XF105
-----	---

41.67828

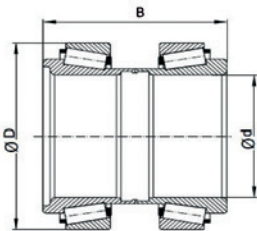

OEM references

20792439 / 20967828 / 7420967828

Cross references

FAG	566425.H195
Fersa	F 200014
SKF	VKBA 5423

Fitting position

Rear axle

Dimensions

d (mm)	D (mm)	B (mm)	Weight (kg)
93,8	148	135	4,563

Brand



VOLVO	B6 7700 8500 8700 9700 9900	FH12, FH16, FL6, FL7, FL10, FL12, FM7, FM9, FM12, NH12
-------	--	---

RENAULT	Magnum Premium 2 Kerax
---------	------------------------------

41.67830

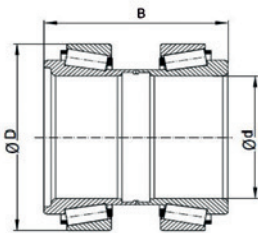

OEM references

20518617 / 20967830 / 7420518617 / 7421021381

Cross references

FAG	566427.H195
Fersa	F 200015
SKF	VKBA 5424

Fitting position

Front axle / Rear axle

Dimensions

d (mm)	D (mm)	B (mm)	Weight (kg)
58	110	115	4,5

Brand



RENAULT	Magnum Dxi Premium 2 C series, T series, K series		
VOLVO	B6, B9, 7700, 8500, 8700, 9700, 9900	FM NH 12 FH FE	
FENDT	Vario 922, Vario 924		

41.67831

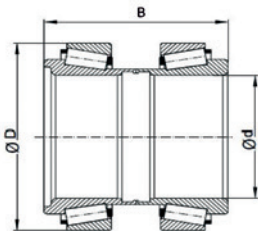

OEM references

20967831 / 7421021391

Cross references

FAG	566426.H195
Fersa	F 200013
SKF	VKBA 5425

Fitting position

Front axle / Rear axle

Dimensions

d (mm)	D (mm)	B (mm)	Weight (kg)
68	125	115	4,773

Brand



RENAULT	Magnum C series T series K series Premium 2 Kerax		
VOLVO	B6, B9, 7700, 8500, 8700, 9700, 9900	FH12, FH16 FM7, 9, FMX FM10, 12 NH12	
FENDT	Vario 922, Vario 92		

41.93420

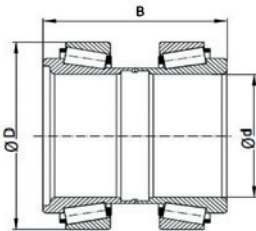

OEM references

81.93420.0320 / 81.93420.0342 / 81.93420.0376 / 81.93420.6097

Cross references

FAG	803750B
Fersa	F 200004
SKF	VKBA 5408

Fitting position

Rear axle

Dimensions

d (mm)	D (mm)	B (mm)	Weight (kg)
105	160	140	6,968

Brand



MAN	Lions coach	TGA
	Lions city	TGM
	HOCL	TGS
	NG, NL, SL	TGX
		M 2000

VOLVO	7700
	8500
	8700

42.098033

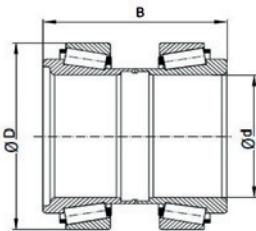

OEM references

09.801.02.72.0 / 09.801.02.33.0 / 02.6406.50.00

Cross references

FAG	723 7001 10
Fersa	32310 F/ 33116 F
SKF	VKBA 5521

Fitting position

Trailer axle

Dimensions

d (mm)	D (mm)	B (mm)	Weight (kg)
50/80	110/130	42,25/37	5,11

Brand



BPW	6,5T
	8-9T
ROR	9T
	9,3T
GIGANT	DH 5/6
	DH 5/6
	GNV5/6

42.098034

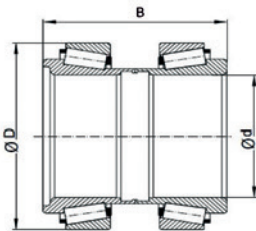

OEM references

09.801.02.34.0 / 02.6407.65.00

Cross references

FAG	723 7005 10
Fersa	33118 F/ 33213 F
SKF	VKBA 5522 / VKBA 2422

Fitting position

Trailer axle

Dimensions

d (mm)	D (mm)	B (mm)	Weight (kg)
90/65	150/120	45/41	6,64

Brand



BPW	10-12t 8-9t
GIGANT	GNV5 GVH5 GNVH5 DH6

42.343012

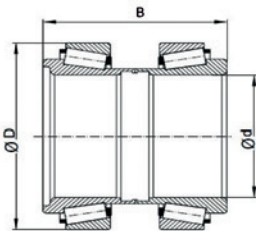

OEM references

4 200 1016 02 / 3 434 3012 00

Cross references

FAG	566830.H195
Fersa	F 200028

Fitting position

Trailer axle

Dimensions

d (mm)	D (mm)	B (mm)	Weight (kg)
120	175	123	6,65

Brand



SAF	SK SKRS SKRZ
-----	--------------------

42.343016

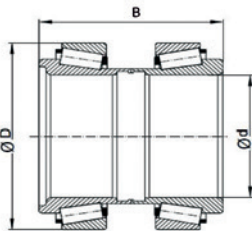

OEM references

3434301600 / 4200100600 / 10500558

Cross references

FAG	723 7008 10
Fersa	33213 F / HM 218248 / HM 218210
SKF	VKHB 2029 / VKHB 2051 / VKBA 5507

Fitting position

Trailer axle

Dimensions

d (mm)	D (mm)	B (mm)	Weight (kg)
65/89,975	120/146,975	41/40	5,65

Brand



SAF

RBM/RLSM/
RSM/RZM
WRLZM/
WRZM

42.343018

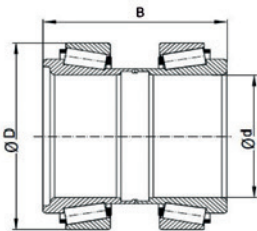

OEM references

3 434 301 800

Cross references

FAG	569868.H195
Fersa	F 200029

Fitting position

Trailer axle

Dimensions

d (mm)	D (mm)	B (mm)	Weight (kg)
82	138	110	5,85

Brand



SAF

SKRB
SKRLB

42.343019

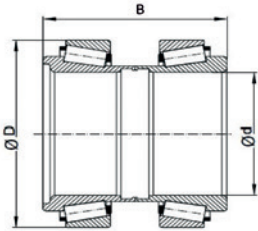

OEM references

03 434 3020 00

Cross references

FAG 570530.H195
 Fersa F 200025

Fitting position

Trailer axle

Dimensions

d (mm)	D (mm)	B (mm)	Weight (kg)
88	138	120	5,058

Brand



SAF

B, S, Z

41.19305

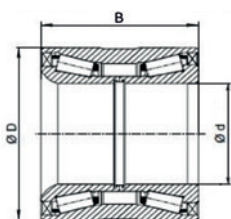

OEM references

014 981 9905 / 017 981 5005 / 014 981 93 05

Cross references

FAG	805003A.H195
Fersa	F 15100
SKF	VKBA 5552

Fitting position

Front axle

Dimensions

d (mm)	D (mm)	B (mm)	Weight (kg)
82	140	115	6,45

Brand



MB	Actros Antos Arocs Axor 2
----	------------------------------------

41.24482

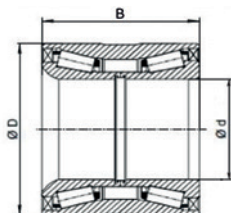

OEM references

1413785 / 1439070 / 1476945 / 1724482

Cross references

FAG	571762.01.H195
Fersa	F 15097
SKF	VKBA 5314

Fitting position

Front axle

Dimensions

d (mm)	D (mm)	B (mm)	Weight (kg)
68	127	115	6,257

Brand



SCANIA	4 series bus	2 series 3 series 4 series K series P,G,R,T ser
--------	--------------	---

41.80379

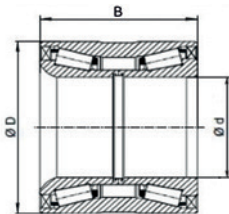

OEM references

7182915 / 85103257 / 81934200336

Cross references

FAG	803194.26.H195
Fersa	F 15125
SKF	VKBA 5415

Fitting position

Front axle / Rear axle

Dimensions

d (mm)	D (mm)	B (mm)	Weight (kg)
78	130	90	4,4



Brand	Vehicle Type
IVECO	EuroCargo I-IV
MAN	TGL, TGM
MB	Atego 3
RENAULT	D-Serie
VOLVO	B 12 FL 6

41.83074

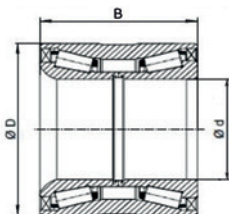

OEM references

2996882 / 7183074 / 7189050 / 1400291 / 1408086

Cross references

FAG	805012.06.H195
Fersa	F 15122
SKF	VKBA 5397

Fitting position

Rear axle

Dimensions

d (mm)	D (mm)	B (mm)	Weight (kg)
90	160	125	10,208



Brand	Vehicle Type
IVECO	Eurostar Eurotech Stralis Trakker
DAF	LF55
IRISBUS	Arway Evadys Magelys

41.03650

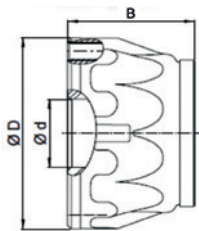

OEM references

3.200.2001.51 / 3.434.3650.00 / 4.200.2001.00

Cross references

FAG	564734.H195
Fersa	F 300001
SKF	VKBA 5549

Fitting position

Trailer axle

Dimensions

d (mm)	D (mm)	B (mm)	Weight (kg)
82	196	110	14,8

Brand



SAF	SKRB SKRLB
Schmitz Cargobull	ROTOS 06/06

41.39770

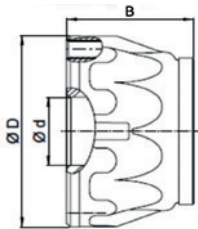

OEM references

5010439770 / 504189654

Cross references

FAG	201043
Fersa	F 300003
SKF	VKBA 5420

Fitting position

Front axle

Dimensions

d (mm)	D (mm)	B (mm)	Weight (kg)
70	195	110	10,7

Brand



RENAULT	Kerax Magnum Midlum Premium (front and rear axle)
IVECO	Magelys Urbanway
IRISBUS	Ares, Arway, Axer, Citelis

41.93288

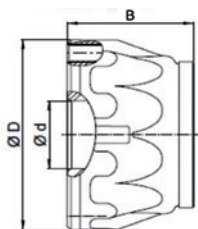

OEM references

81.93420.0330 / 81.93420.0288 / 81.93420.0349

Cross references

FAG	801974AE.H195
Fersa	F 300005
SKF	VKBA 5377

Fitting position

Front axle



Dimensions



d (mm)	D (mm)	B (mm)	Weight (kg)
90	196	130	12,618

Brand



IVECO	Cityclass	
	Europolis	
MAN	Lions coach	TGA, TGM
	Lions city	TGS, TGX
	Lions star	E2000
	Tourliner	F2000
	NG, NL, NM	M2000

			Inboard	Outboard
BPW				
E				
E 8010	TRL	42.098033	33116 A	32310 A
NH SERIES				
6-6.5T	TRL	42.098033	33116 A	32310 A
8-9T	TRL	42.098033	33116 A	32310 A
10-12T	TRL	42.098034	33118 A	33213 A
GS				
GS 11010-1	TRL		32219 A	33215 A
GS 5506, GS 5508, GS 7008	TRL	42.098033	33116 A	32310 A
GS 8008-1	TRL	42.098034	33118 A	33213 A
NH SERIES ECO/ECO MAXX				
6.5T	TRL	42.098033	33116 A	32310 A
8-9T	TRL	42.098033	33116 A	32310 A
10-12T	TRL	42.098034	33118 A	33213 A
H SERIES				
6-6.5T	TRL	42.098033	33116 A	32310 A
8-9T	TRL	42.098033	33116 A	32310 A
10-12T	TRL	42.098034	33118 A	33213 A
13-14T	TRL		32219 A	33215 A
16-18T	TRL		32222 A	32314 A
20T	TRL		32224 A	32316 A
NH SERIES ECOPLUS				
8-12T	TRL	42.098034	33118 A	33213 A
NR SERIES				
6-6.5T	TRL	42.098033	33116 A	32310 A
8-9T	TRL	42.098033	33116 A	32310 A
10-12T	TRL	42.098034	33118 A	33213 A
13-14T	TRL		32219 A	33215 A
H SERIES ECO/ECO MAXX				
6.5T	TRL	42.098033	33116 A	32310 A
8-9T	TRL	42.098033	33116 A	32310 A
10-12T	TRL	42.098034	33118 A	33213 A
13T	TRL		32219 A	33215 A
NR SERIES ECO/ECO MAXX				
6.5T	TRL	42.098033	33116 A	32310 A
8-9T	TRL	42.098033	33116 A	32310 A
10-12T	TRL	42.098034	33118 A	33213 A
H SERIES ECOPLUS				
8-12T	TRL	42.098034	33118 A	33213 A

			Inboard	Outboard
R SERIES				
6-6.5T	TRL	42.098033	33116 A	32310 A
8-9T	TRL	42.098033	33116 A	32310 A
10-12T	TRL	42.098034	33118 A	33213 A
KH SERIES				
6-6.5T	TRL	42.098033	33116 A	32310 A
8-9T	TRL	42.098033	33116 A	32310 A
10-12T	TRL	42.098034	33118 A	33213 A
R SERIES ECO/ECO MAXX				
6.5T	TRL	42.098033	33116 A	32310 A
8-9T	TRL	42.098033	33116 A	32310 A
10-12T	TRL	42.098034	33118 A	33213 A
KH SERIES ECO/ECO MAXX				
6.5T	TRL	42.098033	33116 A	32310 A
8-9T	TRL	42.098033	33116 A	32310 A
10-12T	TRL	42.098034	33118 A	33213 A
SH SERIES ECOPLUS				
8-12T	TRL	42.098034	33118 A	33213 A
KH SERIES ECOPLUS				
8-12T	TRL	42.098034	33118 A	33213 A
SKH SERIES ECOPLUS				
8-12T	TRL	42.098034	33118 A	33213 A
KR SERIES				
6.4T	TRL		33215 A	32310 A
6-6.5T	TRL	42.098033	33116 A	32310 A
8-9T	TRL	42.098033	33116 A	32310 A
10-12T	TRL	42.098034	33118 A	33213 A
KR SERIES ECO/ECO MAXX				
6.5T	TRL	42.098033	33116 A	32310 A
8-9T	TRL	42.098033	33116 A	32310 A
10-12T	TRL	42.098034	33118 A	33213 A
13-14T	TRL		32219 A	33215 A
KRBM 6408				
	TRL		33215 A	32310 A
FRUEHAUF				
PROPAR				
Propar P-Serie, Propar PSL-Serie, Propar PS-Serie	TRL		HM518445/ 518410	HM 518445/ 518410
P-SERIE				
P15/1-Serie, P75-Serie	TRL		HM518445/ 518410	HM 518445/ 518410



Inboard

Outboard

KASSBOHRER

09-01.089

TRL

32218 A

32216 A

09-01.093

TRL

32218 A

32216 A

09-01.100

TRL

32218 A

32216 A

09-01.088

TRL

30218 A

30216 A

09-01.111

TRL

30218 A

30216 A

09-01.112

TRL

30218 A

32216 A

09-01.113

TRL

30218 A

32216 A

09-01.114

TRL

30218 A

32216 A

09-01.119

TRL

30218 A

32216 A

09-01.122

TRL

30218 A

32216 A

09-01.030

TRL

30218 A

32216 A

09-01.062

TRL

32218 A

32216 A

09-01.075

TRL

32218 A

32216 A

09-01.077

TRL

32218 A

32216 A

GIGANT

PROTEC

DH4 05506 3334

TRL

32212 A

33208 A

DH5 09010 4345, DH6 09010 3745,
DH6 09010 4345

TRL

33116 A

32310 A

DH6 10008 3745, DH6 10010 4345

TRL

33118 A

33213 A

DKH1 09010 3745, DKH1 09010 4345,
DNKH1 09010 3745, DNKH1 09010 4345

TRL

41.19305

GH4 05506 3010

TRL



32212 A



33208 A

GKH1 09010 4218, GKH1 10010 4220,
GKH1 10510 3020, GKH1 12010 3020,
GNK1 12010 3020, GNKH1 09010 4218,
GNKH1 10510 3020



TRL



41.19305



			Inboard	Outboard
GVH5 10008 3620, GVH5 10010 3020, GVH5 10010 3620, GVH5 10010 4220, GVH5 12008 3620, GVH5 12010 3020, GVH5 12010 3620, GVH5 12010 4220	TRL		33118 A	33213 A
GZK1 10510 3020, GZK1 12010 3020	TRL	41.19305		
SV2 05506 3012	TRL		32212 A	32211 A
SV2 06706 3015	TRL		32214 A	32212 A
MERCEDES-BENZ				
NR				
NR5/10DC6L-9, NR5/10DC7L-9, NR5/8KC6-9, NR5/8KC7-9, NR5/8NC6-9, NR5/8NC7-9	TRL		33217 A	32311 A
TE				
TE4/2C 6-9, TE4/2KC6-9, TE4/2NC6-9, TE4/3C 6-9, TE4/3KC6-9, TE4/3NC6-9, TE4/5C 6-9, TE4/6C 6-9, TE4/8C 6-9, TE4/8KC6-9, TE4/8NC6-9, TE5/1C 7-9, TE5/2C 7-9, TE5/2KC6-9, TE5/2KC7-9, TE5/2NC6-9, TE5/2NC7-9, TE5/3C 7-9, TE5/3KC6-9, TE5/3KC7-9, TE5/3NC6-9, TE5/3NC7-9	TRL	41.19305		
TE5/4C 7-10, 5	TRL		33020 A	33116 A
TE5/5C 7-9, TE5/6C 7-9, TE5/8C 7-9, TE5/8C6-9, TE5/8KC6-9, TE5/8KC7-9, TE5/8NC6-9, TE5/8NC7-9	TRL	41.19305		
TL				
TL4/1C 6-9, TL4/1KC6-9, TL4/1NC6-9, TL5/1C 7-9, TL5/1C6-9, TL5/1KC6-9, TL5/1KC7-9, TL5/1NC6-9, TL5/1NC7-9	TRL	41.19305		
TZ				
TZ3/2C6-10, 5, TZ3/2KC6-9, TZ3/2NC6-9	TRL		33020 A	33116 A
TZ4/2KC6-9, TZ4/2NC6-9, TZ4/8C 6-9, TZ4/8KC6-9	TRL	41.19305		
TZ5/1C 7-10, 5, TZ5/2KC6-9, TZ5/2KC7-9, TZ5/2NC6-9, TZ5/2NC7-9	TRL		33020 A	33116 A
TZ5/4KC6-9, TZ5/4KC7-9, TZ5/4NC6-9, TZ5/4NC7-9, TZ5/8C 7-9, TZ5/8C6-9, TZ5/8KC6-9, TZ5/8KC7-9, TZ5/8NC6-9, TZ5/8NC7-9	TRL	41.19305		
MERITOR				
TA				
	TRL		HM218248/ 218210	HM218248/ 218210
TE				
TE 9000	TRL	42.098033	33116 A	32310 A
TE 9300	TRL	42.098033	33116 A	32310 A

			Inboard	Outboard
TM				
TM 22000	TRL	42.434016	HM218248/218210	33213 A
TM 22500	TRL	42.434016	HM218248/218210	33213 A
TM 25000	TRL	42.434016	HM218248/218210	33213 A
TM 33000	TRL		32220 A	32218 A
SAF				
B				
B9-19, B9-22, BL9-22, BIL9-22, BINL9-22	TRL	42.343019		
EBN				
EBN 3130/12"	TRL		33211 A	33207 A
EBN 3140	TRL		30310 A	30307 A
EBN 3140-6	TRL		33211 A	33207 A
EBN 4040	TRL		30311 A	30307 A
EBN 4530, EBN 4535, EBN 4540-10, EBN 4540-6	TRL		33212 A	33209 A
EBN 4540-8	TRL		30311 A	30307 A
EBN 5535	TRL		33113 A	30309 A
ES				
ES 5030	TRL		30312 A	33209 A
ESN				
ESN 4030, ESN 4040	TRL		30311 A	30307 A
ESN 4540, ESN 5030	TRL		30312 A	30309 A
ESN 5542	TRL		32213 A	30309 A
ESN 6030	TRL		30312 A	30309 A
EZN				
EZN 4030, EZN 4030/12	TRL		30311 A	30307 A
EZN 5030	TRL		30312 A	30309 A
EZN 6030	TRL		30313 A	30309 A
KRS				
KRS 12242, KRS 12242/18	TRL	42.343016	HM218248/218210	33213 A
KRS 14242	TRL		32219 A	33215 A
KRZ				
KRZ 14242	TRL		32219 A	33215 A
KRZ 16242	TRL		32221 A	32314 A
KRZT				
KRZT 14242 Trillex	TRL		32219 A	33215 A
KRZT 16242 Trillex	TRL		32221 A	32314 A
RBM				
RBM 8442	TRL	42.343016	HM218248/218210	33213 A
RBM 8442/12	TRL	42.343016	HM215249/215210	33213 A

			Inboard	Outboard
RLBM				
RLBM 8442	TRL	42.343016	HM218248/218210	33213 A
RLSM				
RLSM 11242	TRL	42.343016	HM218248/218210	33213 A
RLSM 11242	TRL		32924 A	32924 A
RLSM 11242	TRL	42.343016	HM218248/218210	33213 A
RLSM 8442	TRL	42.343016	HM218248/218210	33213 A
RLSM 9042, RLSM 9042/20	TRL		32924 A	32924 A
SK				
SK 1000 ETO, SK 1000 ETO InTRLax	TRL	42.313012		
SK 500, SK 500 Plus	TRL	42.343016	HM218248/218210	33213 A
SKRZ 9019 K	TRL	42.313012		
SKRB				
SKRB 9019 K	TRL	41.0365		
SKRB 9019 KI (SN6) Integral	TRL	42.343018		
SKRB 9019 W	TRL	41.0365		
SKRB 9019 WI Integral	TRL	42.343018		
SKRB 9022 H, SKRB 9022 H (MK IV), SKRB 9022 H (Modul X), SKRB 9022 K, SKRB 9022 K 01 (SN7)	TRL	41.0365		
SKRB 9022 KI (SN7) Integral, SKRB 9022 KI 01 (SN7) Integral	TRL	42.343018		
RS				
RS 5030	TRL		30312 A	30309 A
RSM				
RSM 11242	TRL	42.343016	HM218248/218210	33213 A
RSM 6242/12-10, RSM 6242/12-8	TRL	42.343016	HM215249/215210	33113 A
RSM 6542	TRL		32924 A	32924 A
RSM 8442, RSM 8442-8	TRL	42.343016	HM218248/218210	33213 A
RSM 9042, RSM 9042/20	TRL		32924 A	32924 A
SKRLB				
SKRLB 9019 K (SN6)	TRL	41.0365		
SKRLB 9019 K (SN6) Integral	TRL	42.343018		
SKRLB 9019 KI (SN6)	TRL	41.0365		
SKRLB 9019 KI (SN6) Integral	TRL	42.343018		
SKRLB 9019 W	TRL	41.0365		
SKRLB 9019 W Integral	TRL	42.343018		
SKRLB 9022 H (MK II/III), SKRLB 9022 H (MK IV), SKRLB 9022 H (Modul X), SKRLB 9022 K (SN7), SKRLB 9022 K 01 (SN7)	TRL	41.0365		

			Inboard	Outboard
SKRLB 9022 KI (SN7) Integral, SKRLB 9022 KI 01 (SN7) Integral	TRL	42.343018		
SKRLB 9022 W	TRL	41.0365		
SKRLB 9022 WI Integral	TRL	42.343018		
RZM				
RZM 11030, RZM 11242	TRL	42.343016	HM218248/218210	33213 A
RZM 12242	TRL		33118 A	33213 A
RZM 13130	TRL		32218 A	32312 A
RZM 14242	TRL		32219 A	32312 A
RZM 16242	TRL		32221 A	32314 A
RZM 8442, RZM 8442-8	TRL	42.343016	HM218248/218210	33213 A
RZT				
RZT 14242	TRL		32219 A	32312 A
RZT 16242	TRL		32221 A	32314 A
S				
S11-3720, S11-4218, S11-4220, S7-3015, S9-3718, S9-4220, S11-19, S11-22, S19-19, S19-22, SIL11-22, SL11-4220, SZL11-4220, SL9-3718, SL9-4218, SZL11-4218	TRL	42.343019		
SKRLZ				
SKRLZ 11030	TRL	42.343016	HM218248/218210	33213 A
SKRLZ 9030	TRL	42.343016	HM218248/218210	33213 A
SAF - B, S, Z				
B9-19K, B9-19W, B9-22K01, B9-22W, BA9-22K01, B19-19K, B19-19W, BA9-22K01, B19-19K, B19-19W, BA9-22K01, B19-19K, B19-19W, BA9-22K01, B19-19K, B19-19W, BA9-22K01, B19-19K, B19-19W, BA9-22K01, B19-19K, B19-19W, BA9-22K01, B19-19K, B19-19W	TRL	42.343019		
SKRS				
SKRS 11019 K, SKRS 11222 W	TRL	42.343012		
SKRS 12242, SKRS 9030, SKRS 9042/ SK500, SKRS 9042/ SK500 plus	TRL	42.343016	HM218248/218210	33213 A
SKRZ				
SKRZ 11030	TRL	42.343016	HM218248/218210	33213 A
SKRZ 11242	TRL	42.343012		
SKRZ 12030, SKRZ 12037, SKRZ 12242, SKRZ 6530, SKRZ 9030, SKRZ 9037-10	TRL	42.343016	HM218248/218210	33213 A
SKRZ 9042/20	TRL	42.343012		
SKRZT				
SKRZT 12242	TRL	42.343016	HM218248/218210	33213 A

			Inboard	Outboard
SKZRLZ				
SKZRLZ 11030, SKZRLZ 12030	TRL	42.343016	HM218248/218210	33213 A
WESN				
WESN 5030	TRL		30312 A	30309 A
WESN 6030	TRL		30313 A	30309 A
WEZN				
WEZN 5030	TRL		30312 A	30309 A
WEZN 6030, WEZN 6030/12	TRL		30313 A	30309 A
WRLZM				
WRLZM 11030, WRLZM 11035-10, WRLZM 11035-8, WRLZM 8130, WRLZM 8435-10, WRLZM 8435-8	TRL	42.343016	HM218248/218210	33213 A
WRZM				
WRZM 11030, WRZM 11035-10, WRZM 11035-8, WRZM 11242	TRL	42.343016	HM218248/218210	33213 A
WRZM 6242, WRZM 6242-8	TRL		HM 215249/215210	33113 A
WRZM 8130, WRZM 8435-8, WRZM 8442, WRZM 8442-8	TRL	42.343016	HM218248/218210	33213 A
Z				
Z11-3020, Z11-3720-10L, Z11-3720-8L, Z11-4218, Z11-4220, Z7-3015, Z8-3718, Z9-3020, Z9-3720-10L, Z9-3720-8L, Z9-4218, Z9-4220, Z11-19, Z11-22, Z19-19, Z19-22, ZL11-3020, ZL11-3720, ZL11-4220, ZL8-3718, ZL9-3020, ZL9-3720	TRL	42.343019		
SCHMITZ CARGOBULL				
SC ROTOS				
		41.0365		
MONTENEGRO				
7.5 T				
	TRL		32217 A	32217 A
8 T				
	TRL		32217 A	32217 A
8.5 T				
	TRL		32217 A	32217 A
9.5 T				
	TRL		32217 A	32217 A
10.5 T				

			Inboard	Outboard
	TRL		32217 A	32217 A
11 T				
	TRL		HM518445/518410	HM518445/518410
11.5 T				
	TRL		HM518445/518410	HM518445/518410
13 T				
	TRL		32217 A	32217 A
YORK				
10 T				
	TRL		HM218248/218210	33213 A
13 T				
	TRL		HM218248/218210	HM 212749/212710
15 T				
	TRL		HM220149/220110	HM218248/218210



**CRAFT
BEARINGS**

Quality Minded

**Automotive
bearings**

www.craft-bearings.com

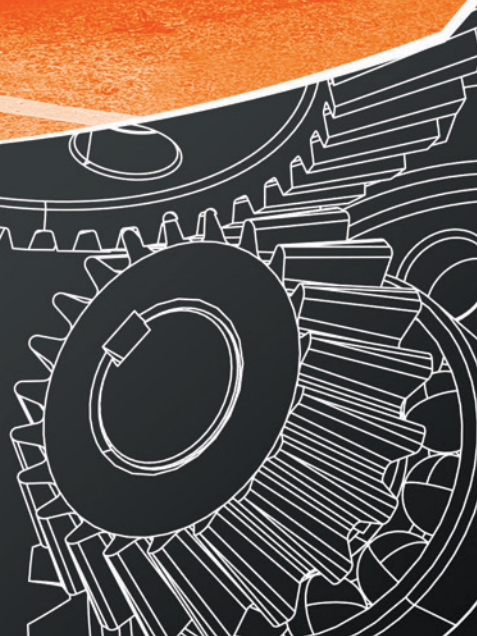

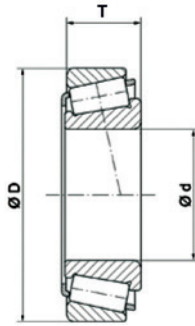

CRAFT	OEM	SKF code	Dimensions (mm)			Application
			d	D	T	
215249/215210 A	183348	VKHB 2050	76	132	40,9	VOLVO wheel bearing
218248/218210 A	1698580	VKHB 2029	90	147	42,1	RENAULT, SCANIA, VOLVO wheel bearing Meritor, SAF axle bearing
	1524625					
	4 200 1006 00					
220149/220110 A	354076	VKHB 2285	100	157	42	SCANIA wheel bearing
	183326					
30204 A	02 6401 20 00	-	20	47	15,250	BPW axle bearing
30205 A	77 03 090 098	VKHB 2189	25	52	16,25	RENAULT wheel bearing
30206 A	8197270	VKT 8404	30	62	17,25	Transmission bearing
30207 A	11042	VKT 8605	35	72	18,25	Transmission bearing
30208 A	11043	VKT 8647	40	80	19,75	Transmission bearing
30209 A	635 371 036	VKHB 2296	45	85	20,75	ZF wheel bearing
30210 A	06.32489-0047	VKHB 2167	50	90	21,75	MAN wheel bearing
30211 A	38540711	-	55	100	22,75	IVECO differential bearing
30212 A	06.32489-0056	-	60	110	23,75	MAN wheel bearing
30213 A	26800010	-	65	120	24,75	IVECO differential bearing
30214 A	85 900 013 207	VKT 8632	70	125	26,25	MAN, VOLVO differential bearing
30215 A	1102857	VKHB 2168	75	130	27,25	IVECO, MAN wheel bearing
	06.32489-0019					
30216 A	26800040	VKHB 2204	80	140	28,25	IVECO Wheel bearing
30217 A	06.32480-4700	VKHB 2334	85	150	30,5	MAN wheel bearing
30218 A	1102858	VKHB 2248	90	160	32,5	IVECO, MAN wheel bearing
	87.52310-1710					
30219 A	-	-	95	170	34,5	Tapered roller bearing
30220 A	06.32480-5000	VKHB 2164	100	180	37	MAN, MB wheel bearing
	004 981 21 05					
30221 A	1102864	VKHB 2215	105	190	39	IVECO, MB wheel bearing
30304 A	635 372 002	-	20	52	16,25	ZF
30305 A	183316	VKHB 2262	25	62	18,25	RENAULT, VOLVO wheel bearing
	82 00 021 441					
30307 A	26800350	VKHB 2202	35	80	22,75	IVECO, SAF wheel bearing
30308 A	19 813 105	-	40	90	25,25	MB gearbox

CRAFT	OEM	SKF code	Dimensions (mm)			Application
			d	D	T	
30309 A	26800370 04 200 0012 00	VKHB 2201	45	100	27,5	IVECO, SAF wheel bearing
30310 A	04 200 0013 00	-	50	110	29,25	SAF axle bearing
30311 A	06.32489-0026 04 200 0014 00	VKHB 2198	55	120	31,5	SAF, MAN wheel bearing
30312 A	1102859 04 200 0015 00	VKHB 2283	60	130	33,5	IVECO, SAF wheel bearing
30313 A	04 200 0016 00 000720 030313	VKHB 2304	65	140	36	SAF wheel bearing
30314 A	001 981 75 05	-	70	150	38	MB wheel bearing
30315 A	-	-	75	160	40	Tapered roller bearing
30316 A	-	-	80	170	42,5	Tapered roller bearing
30318 A	-	-	90	190	46,5	Tapered roller bearing
30319 A	-	-	95	200	49,5	Tapered roller bearing
31310 A	-	-	50	110	29,25	Tapered roller bearing
31311 A	000 981 0005	VKT 8759	55	120	31,5	SCANIA differential
31312 A	-	VKT 8758	60	130	33,5	Transmission bearing
31313 A	6 324 990 022	VKT 8761	65	140	36	MAN, MB, SCANIA differential bearing
32010 A	009 981 41 05	VKHB 2191	50	80	20	RENAULT wheel bearing
32011 A	5000392237 009 981 7005	VKHB 2060	55	90	23	Renault wheel bearing
32013 A	43 21 098 18R	VKHB 2199	65	100	23	Renault wheel bearing
32017 A	06.32489-0060 017 981 82 05	VKHB 2169	85	130	29	MAN, MB wheel bearing
32018 A	06.32489-0011 004 981 17 05 1699173	VKHB 2170	90	140	32	MAN, MB, VOLVO wheel bearing
32019 A	50 10 534 822 20593429 062 2103	VKHB 2161	95	145	32	DAF, MAN, VOLVO, MB wheel bearing
32020 A	001 981 64 05	VKHB 2306	100	180	37	MB wheel bearing
32021 A	1104922 06.32489-0071 003 981 25 05	VKHB 2160	105	160	35	IVECO, MB, SCANIA wheel bearing
32022 A	02.6404.11.00 50 01 014 916	VKHB 2281	110	170	38	SCANIA, RENAULT wheel bearing
32024 A	1102860	VKHB 2216	120	180	38	IVECO wheel bearing
32028 A	55 16 014 042 06.32489-0080	VKHB 2020	40	80	24,75	IVECO, MAN wheel bearing
32206 A	A0.02343-2206 8835016	VKHB 2016	30	62	21,25	IVECO, MAN wheel bearing

CRAFT	OEM	SKF code	Dimensions (mm)			Application
			d	D	T	
32207 A	06.32499-0068 319 981 00 05 26800130	VKHB 2018	35	72	24,25	IVECO, MAN, MB wheel bearing
32208 A	81.93420-0055 26800140	VKHB 2020	40	80	24,75	IVECO, MAN wheel bearing
32209 A	1101909	VKHB 2015	45	85	24,75	IVECO wheel bearing
32210 A	1110003 002 981 19 05	VKHB 2017	50	90	24,75	IVECO, MB wheel bearing
32211 A	1125929 87.52330-0610 001 981 84 05	VKHB 2019	55	100	26,75	IVECO, MAN, MB wheel bearing
32212 A	1 602 388	VKHB 2347	60	110	29,75	DAF wheel bearing
32213 A	04 200 0023 00	VKHB 2288	65	120	32,75	SAF axle bearing
32214 A	011 981 06 05	VKHB 2284	70	125	33,25	MB wheel bearing
32215 A	942 981 02 05 14102 81.93420-6096	VKHB 2033	75	130	33,25	SCANIA, MAN, MB wheel bearing
32216 A	14103 000 981 72 05	VKHB 2026	80	140	35,25	MB, SCANIA wheel bearing
32217 A	1905354 002 981 17 05	VKHB 2080	85	150	38,5	IVECO, MB wheel bearing
32218 A	1905353 N 000720 032218 04 200 0027 00	VKHB 2030	90	160	42,5	IVECO, MB, SCANIA wheel bearing SAF axle bearing
32219 A	04 200 0026 00 000 981 21 05 1905350	VKHB 2031	95	170	45,5	IVECO, MB wheel bearing BPW, SAF axle bearing
32220 A	7 178 989	VKHB 2297	100	180	49	IVECO wheel bearing
32221 A	26800270	VKHB 2212	105	190	53	IVECO wheel bearing SAF axle bearing
32222 A	02.6405.11.00	-	110	200	56	BPW axle bearing
32224 A	-	-	120	215	61,5	Tapered roller bearing
32305 A	2992590 50 10 439 053	VKHB 2294	25	62	25,25	RENAULT wheel bearing
32306 A	N 000720 032306	VKHB 2007	30	72	28,75	MB wheel bearing
32307 A	1110016	VKHB 2063	35	80	33	Wheel bearing
32308 A	1126887	VKHB 2001	40	90	35,25	IVECO wheel bearing
32309 A	283684 34.93420-0003 1362149	VKHB 2004	45	100	38,25	DAF, MAN, SCANIA wheel bearing
32310 A	02.6406.50.00 062 6875 001 981 29 05 10500491 81.93420-0131	VKHB 2070	50	110	42,25	DAF, MAN, MB, IVECO wheel bearing BPW, GIGANT axle bearing

CRAFT	OEM	SKF code	Dimensions (mm)			Application
			d	D	T	
32311 A	027 5828 26800610 006 981 74 05	VKHB 2002	55	120	45,5	DAF, IVECO, MB wheel bearing
32312 A	014 836 04 200 0033 00 011 981 68 05	VKHB 2003	60	130	48,5	MB, SCANIA , VOLVO wheel bearing SAF axle bearing
32313 A	9884-65102	VKHB 2626	65	140	51	Wheel bearing
32314 A	005 981 00 05 04 200 0034 00 02.6406.70.00	VKHB 2072	70	150	54	MB wheel bearing BPW, SAF axle bearing
32315 A	-	-	75	160	58	Tapered roller bearing
32316 A	-	-	80	170	61,5	Tapered roller bearing
32318 A	-	-	90	190	67,5	Tapered roller bearing
32320 A	-	-	100	215	77,5	Tapered roller bearing
32321 A	-	-	105	225	81,5	Tapered roller bearing
32924 A	04 200 1010 00	VKHB 2247	120	165	29	SAF axle bearing
33008 A	-	-	40	68	22	Tapered roller bearing
33009 A	-	-	45	75	24	Tapered roller bearing
33010 A	-	-	50	80	24	Tapered roller bearing
33011 A	002 981 93 05	VKHB 2156	55	90	27	MB wheel bearing
33012 A	50 00 685 835 183777	VKHB 2045	60	95	27	RENAULT, VOLVO wheel bearing
33013 A	50 10 439 190 23336093	VKHB 2047	65	100	27	RENAULT wheel bearing
33014 A	183778 50 00 685 837 06.32499-0109	VKHB 2044	70	110	31	MAN, MB, VOLVO wheel bearing
33015 A	06.32499-0180 50 10 439 171	VKHB 2046	75	115	31	MAN, RENAULT wheel bearing
33016 A	631780	VKHB 2140	80	125	36	DAF wheel bearing
33017 A	06.32499-0122 006 981 87 05	VKHB 2321	85	130	36	MAN, MB wheel bearing
33018 A	50 00 685 839 183768	VKHB 2048	90	140	39	RENAULT, VOLVO wheel bearing
33019 A	000 980 96 02 87.52460-1503 1104923 067 6987	VKHB 2082	95	145	39	DAF, MAN, MB, IVECO wheel bearing
33020 A	06.32499-0124 017063 005 981 84 05	VKHB 2124	100	150	39	MAN, MB wheel bearing
33021 A	026 6488 351713 003 981 28 05	VKHB 2162	105	160	43	DAF, MB, SCANIA wheel bearing
33022 A	004 981 07 05	VKHB 2163	110	170	47	MB wheel bearing

CRAFT	OEM	SKF code	Dimensions (mm)			Application
			d	D	T	
33108 A	50 03 090 072	VKHB 2190	40	75	26	RENAULT wheel bearing
33109 A	00 23 336 288 003 981 11 05	VKHB 2056	45	80	26	RENAULT, MB wheel bearing
33110 A	1654323	VKT 8615	50	85	26	VOLVO manual transmission bearing
33111 A	000 980 75 02	VKHB 2059	55	95	30	MB wheel bearing
33112 A	008 981 94 05	VKHB 2233	60	100	30	MB wheel bearing
33113 A	4690299 04 200 0055 00	VKHB 2214	65	110	34	IVECO wheel bearing SAF axle bearing
33114 A	002-9819-705	VKT 8860	70	120	37	MB differential bearing
33115 A	06.32499-0040 184678	VKHB 2222	75	125	37	MAN, VOLVO wheel bearing
33116 A	02.6408.80.00 99041067 012 981 40 05	VKHB 2326	80	130	37	MB wheel bearing BPW, GIGANT axle bearing
33117 A	50 10 587 007 001 980 67 02 20593388	VKHB 2158	85	140	41	MB, RENAULT, VOLVO wheel bearing
33118 A	42103253 04 200 1009 00 10500582 02.6410.23.00	VKHB 2331	90	150	45	IVECO wheel bearing BPW, GIGANT, SAF axle bearing
33119 A	-	-	95	160	49	Tapered roller bearing
33120 A	-	-	100	165	52	Tapered roller bearing
33121 A	-	-	105	175	56	Tapered roller bearing
33122 A	-	-	110	180	56	Tapered roller bearing
331293 A	002 981 95 05	VKHB 2155	75	115	32,95	MB wheel bearing
331933 A	81.93420-0074	VKHB 2132	70	130	57,5	MAN wheel bearing
33205 A	003 981 10 05 50 01 852 654	VKHB 2057	25	52	22	MB, RENAULT wheel bearing
33206 A	06.32499-0065 50 10 439 054	VKHB 2179	30	62	25	MAN, RENAULT wheel bearing
33207 A	014 981 06 05 04 200 0057 00 7169935 183648	VKHB 2182	35	72	28	MAN, MB, RENAULT, VOLVO wheel bearing SAF axle bearing
33208 A	384 981 76 05 1652127 06.32489-0002 02.6407.40.00	VKHB 2065	40	80	32	DAF, MB, VOLVO wheel bearing BPW, GIGANT axle bearing
33209 A	02.6407.45.01 004 981 72 05 04 200 0063 00 06.32489-0044 50 10 439 060	VKHB 2067	45	85	32	MAN, MB, RENAULT, wheel bearing SAF, BPW axle bearing
33210 A	06.32489-0041 002 981 79 05 50 10 439 057	VKHB 2068	50	90	32	MAN, MB, RENAULT wheel bearing

CRAFT	OEM	SKF code	Dimensions (mm)			Application
			d	D	T	
33211 A	50 10 439 061 04 200 0058 00 004 981 64 05 7165686	VKHB 2061	55	100	35	IVECO, MB, RENAULT wheel bearing SAF axle bearing
33212 A	7160361 00 23 336 081 04 200 0064 00	VKHB 2173	60	110	38	IVECO, RENAULT wheel bearing SAF axle bearing
33213 A	02.6407.67.00 04 200 0060 00 50 10 368 899 10500558 008 981 00 05 184672	VKHB 2051	65	120	41	MB, RENAULT, VOLVO wheel bearing BPW, SAF, GIGANT, MERITOR axle bearing
33214 A	50 10 439 064 006 981 52 05	VKHB 2066	70	125	41	MB, RENAULT wheel bearing
33215 A	260998 04 200 0070 00 06.32489-0042 02.6410.29.00	VKHB 2028	75	130	41	IVECO, MB, SCANIA wheel bearing BPW axle bearing
33216 A	50 10 587 008 20723502	VKHB 2194	80	140	46	RENAULT, VOLVO wheel bearing
33217 A	011 981 08 05 02.6407.85.00 1699339 06.32499-0193	VKHB 2225	85	150	49	MAN, MB, VOLVO wheel bearing BPW axle bearing
33220 A	06.32499-0046 004 981 10 05	VKHB 2165	100	180	63	MAN, MB wheel bearing
332330 A	004 981 24 05	VKHB 2071	70	130	57	MB wheel bearing
39580/39520 A	184088	VKHB 2036	57,15	112,71	30,16	VOLVO wheel bearing
39581/39520 A	1 400 075	VKHB 2088	57,15	112,71	30,16	DAF wheel bearing
39590/39520 A	06.32499-0101 183245	VKHB 2175	66,68	112,71	30,16	MAN, VOLVO wheel bearing
537/532 A	184825 184425	VKHB 2014	50,8	107,95	38,1	VOLVO wheel bearing
575/572 A	284988 1121538	-	76,2	139,7	36,512	SCANIA transmission bearing
580/572 A	004 981 46 05	VKHB 2041	82,55	139,992	36,512	MB wheel bearing
594/592 A	183704	VKHB 2040	95,25	152,4	39,688	VOLVO wheel bearing
598/592 A	000 981 75 05	VKHB 2083	92,075	152,4	39,688	MB wheel bearing
663/653 A	184794 017 4592	VKHB 2043	82,55	146,05	41,28	DAF, VOLVO wheel bearing
683/672 A	00 23 336 006 184795	VKHB 2042	95,25	168,275	41,275	RENAULT, VOLVO wheel bearing
7815 A	-	-	75	135	44,5	Tapered roller bearing
T2ED070 A	322748 8151816 1584340	VKHB 2024	70	130	42	SCANIA, VOLVO wheel bearing

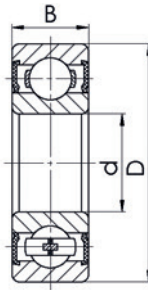

2RS

CRAFT	OEM	FAG	Dimensions (mm)			Application
			d	D	B	
608 2RSA	06.31460.9100	608 2RS	8	22	7	MAN
6003 2RS P6	06.31440.7000 06.31410.4300	6003 2RS	17	35	10	MAN
6200 2RS P6	06.31450.4300	6200 2RS	10	30	9	MAN
6201 2RSA	06.31410.8900 005 981 3425 007 981 6725	6201 2RS	12	32	10	MAN / MB
6202 2RS	06.31410.9000	6202 2RS	15	35	11	MAN
6203 2RS P6	3544565 1908902 06.31410.9102 51.93410.0110 81.93410.0101 007 981 7325 7702037779	6203 2RS	17	40	12	VOLVO / IVECO / MAN / MB / RENAULT / RVI
6204 2RS P6	1363775 1905010 06.31419.0026 06.31450.6200 06.31450.1700 000625006204 770620400 0226578	6204 2RS	20	47	14	SCANIA / IVECO / MAN / MB / RENAULT / RVI / DAF
6205 2RS	181335 228836 06.31450.1800 06.31450.4800 906 981 0325 0635 332 194	6205 2RS	25	52	15	VOLVO / SCANIA / MAN / MB / ZF
6206 2RS	06.31450.1900 06.31450.6400 1205222	6206 2RS	30	62	16	MAN / DAF
6303 2RS P6	06.31460.4302 06.31460.0402 06.31420.3302	6303 2RS	17	47	14	MAN
6304 2RSA	181876 06.31460.3102	6304 2RS	20	52	15	VOLVO / MAN

CRAFT	OEM	FAG	Dimensions (mm)			Application
			d	D	B	
6305 2RSA	1313606	6305 2RS	25	62	17	SCANIA / MAN
	06.31420.3602					
	06.31420.3603					
	51.93410.0100					
	51.93410.0018					
	51.93410.0030					
	51.93410.0134					
	51.93410.0101					
	51.93410.0099					
	51.93410.0029					
	06.31469.0001					
51.93410.0100						
6306 2RSA	1652989	6306 2RS	30	72	19	VOLVO / SCANIA / MAN / MB / RENAULT / RVI / DAF
	243866					
	1652986					
	209722					
	06.31420.3803					
	06.31420.3822					
	000625900183					
	002 341 6316					
	0531037					



CRAFT BEARINGS

Quality Minded



CIS commercial vehicle bearings

www.craft-bearings.com



CRAFT	GOST	Dimensions (mm)			Application
		d	D	T	
BELAZ					
30312 A	6-7312 A	60	130	33,5	Drive shaft
30318 A	7318 A	90	190	46,5	Hub bearing
32222 A	7522 A	110	200	56	Hub bearing
32312 A	6-7612 A	60	130	48,5	Hub bearing
32313 A	7613 A	65	140	51	Hub bearing
32318 A	6-7618 A	90	190	67,5	Front axle
6203 2RSA	180203 A	17	40	12	Air-starter / Tractive electric drive
6204 2RSA	180204 A	20	47	14	Fuel pump
6305 2RSA	180305 A	25	52	15	Air-motor
6306 2RSA	180306 A	30	62	16	Air-motor
GAZ					
30207 A	6-7207 A	35	72	18,25	Hub bearing
30208 A	6-7208 A1	40	80	19,75	Gear box
30214 A	6-7214 AY	70	125	26,25	Back -axle
30304 A	6-7304 A	20	52	16,25	Hub bearing
30305 A	6-7305 ALL	25	62	18,25	Front wheels hubs, external support
30307 A	6-7307 A1	35	80	22,75	Front wheels hubs, internal support
30308 A	6-7308 A	40	90	25,25	Hub bearing
30309 A	6-7309 A1	45	100	27,25	Transfer gear-box
32209 A	6-7509 A	45	85	24,75	Back wheels hubs, external support
32210 A	6Y-7510 ALL	50	90	24,75	Back wheels hubs, internal support/ back-axle differential gear
32215 A	6-7515 A	75	130	33,25	Back wheel hub bearing, internal
32305 A	6-7605 A	25	62	25,25	Front wheel hub bearing, external
32306 A	6-7606 A	30	72	28,75	Front wheel hub bearing, external
32307 A	6-7607 A	35	80	32,75	Front wheel hub bearing, external
32309 A	6-7609 AK	45	100	38,25	Front wheel hub bearing, internal
32310 A	6-7610 A	50	110	42,25	Front wheel hub bearing, internal
6201 2RSA	180201 A	12	32	10	Engine
6203 2RSA	180203 A	17	40	12	Engine / Pickup pump
6204 2RSA	180204 A	20	47	14	Steering gear
6205 2RSA	180205 A	25	52	15	Gear box
6206 2RSA	180206 A	30	62	16	Drive shaft, transitional support
6303 2RSA	180303 A	17	47	14	Engine / Fan
6306 2RSA	180306 A	30	72	19	Power selection gear
ZIL					
30204 A	6-7204 A	20	47	15,25	High pressure fuel pump
30214 A	6-7214 AY	70	125	26,5	Back hub
30215 A	6-7215 A1	75	130	27,25	Differential gear bearing
30308 A	7308 A	40	90	25,25	Drive shaft
30311 A	6-7311 A	55	120	31,5	Front hub bearing

CRAFT	GOST	Dimensions (mm)			
		d	D	T	
32209 A	6-7509 A	45	85	24,75	Hub bearing
32212 A	6-7512 A	60	110	29,75	Hub bearing, front axle
32215 A	6-7515 A1	75	130	33,25	Wheels hub
32216 A	6-7516 A1	80	140	35,25	Back axle differential gear bearing
32217 A	6-7517 A	85	150	38,5	Back wheel hub, internal
32307 A	7607 A	35	80	27	Hub bearing
32308 A	6-7608 A1K	40	90	35,25	Front wheel hub, outside
32309 A	6-7609 AK	45	100	38,25	Front wheel hub
32310 A	6-7610 A	50	110	42,25	Conic gear wheel
32311 A	6-7611 AK	55	120	45,5	Main drive transitional shaft/ wheels hubs
32313 A	6-7613 A1	65	140	51	Conic gear wheel, internal
7815 A	6-7815 A	75	135	44,5	Back wheel hub, external
594/592 A	594/592 A	95,25	152,4	39,688	Hub bearing
6201 2RSA	180201 A	12	32	10	Engine: fuel system, cooling system
6203 2RSA	180203 A	17	40	12	Engine: fuel system
6204 2RSA	180204 A	20	47	14	Engine: cooling system
6205 2RSA	180205 A	25	52	15	Engine, fuel system / Gear box
6305 2RSA	180305 A	25	62	17	Steering gear
KAMAZ					
30204 A	6-7204 A	20	47	15,25	Engine: fuel system
30211 A	6-7211 A1	55	100	22,75	Wheels hubs
30212 A	6-7212 A	60	110	23,75	Middle axle
30214 A	6-7214 AY	70	125	26,25	Middle axle, back axle
30216 A	6-7216 A	80	140	28,25	Back axle
30217 A	6-7217 A	85	150	30,5	Middle axle
30218 A	6-7218 A	90	160	32,5	Wheels hubs
30219 A	7219 A	95	170	34,5	Back axle
30311 A	6-7311 A	55	120	31,5	Hub bearing
30312 A	6-7312 A	60	130	33,5	Hub bearing
30315 A	6-7315 A	75	160	40	Hub bearing
31310 A	6-27310 HA	50	110	29,25	Middle axle, back axle
31313 A	6-27313 A1	65	140	36	Middle axle
32017 A	6-2007117 A	85	130	29	Wheels hubs
32018 A	6-2007118 A	90	140	32	Wheels hubs
32216 A	6-7516 A1	80	140	35,25	Middle axle, back axle
32217 A	6-7517 A	85	150	38,5	Wheels hubs
32218 A	6-7518 A	90	160	42,5	Wheels hubs
32219 A	7519 A	95	170	45,5	Wheels hubs
32220 A	6-7520 A	100	180	49	Wheels hubs
32309 A	6-7609 AK	45	100	38,25	Hub bearing
32310 A	6-7610 A	50	110	42,25	Wheels hubs

CRAFT	GOST	Dimensions (mm)			Application
		d	D	T	
32312 A	6-7612 A	60	130	48,5	Wheels hubs
32313 A	6-7613 A1	65	140	51	Wheels hubs
32314 A	7614 A	70	150	54	Wheels hubs
32315 A	6-7615 A	75	160	58	Middle axle, back axle
33210 A	6-3007210 A	50	90	32	Wheels hubs
7815 A	6-7815 A	75	135	44,5	Wheels hubs
6201 2RSA	180201 A	12	32	10	Engine: fuel system
6203 2RSA	180203 A	17	40	12	Engine: fuel system
6204 2RSA	180204 A	20	47	14	Engine: cooling system
6205 2RSA	180205 A	25	52	15	Gear box / Steering gear
6305 2RSA	180305 A	25	62	17	Engine: cooling system, steering gear
KRAZ					
30204 A	6-7204 A	20	47	15,25	Engine: fuel system
30218 A	6-7218 A	90	160	32,5	Back axle, middle axle
30219 A	7219 A	95	170	34,5	Back axle
30307 A	7307 A	35	80	22,75	Hub bearing
30312 A	6-7312 A	60	130	33,5	Front axle
31313 A	6-27313 A1	65	140	36	Back axle, middle axle, front axle
32218 A	6-7518 A	90	160	42,5	Back axle, middle axle, front axle
32219 A	7519 A	95	170	45,5	Front axle
32310 A	6-7610 A	50	110	42,25	Wheels hubs
32311 A	6-7611 AK	55	120	45,5	Front axle
32312 A	6-7612 A	60	130	48,5	Wheels hubs
32313 A	6-7613 A1	65	140	51	Wheels hubs
32314 A	6-7614 A	70	150	54	Wheels hubs
6200 2RSA	180200 A	10	30	9	Engine, adjuster transmission cylinder
6201 2RSA	180201 A	12	32	10	Engine, rack drive shaft nozzle burner pump
6202 2RSA	180202 A	15	35	11	Generator, armature, back support
6203 2RSA	180203 A	17	40	12	Engine, cooling system
6205 2RSA	180205 A	25	52	15	Engine, fan pulley, back support
6303 2RSA	180303 A	17	47	14	Generator, armature, front support
6304 2RSA	180304 A	20	52	15	Engine / Gear box
6305 2RSA	180305 A	25	62	17	Engine
LIAZ					
30204 A	6-7204 A	20	47	15,25	Engine, fuel system
30206 A	6-7206 A	30	62	17,25	Steering gear
30207 A	6-7207 A	35	72	18,25	Steering gear
30216 A	6-7216 A	80	140	28,25	Back axle
30220 A	7220 A	100	180	37	Hub bearing
30312 A	7312 A	60	130	33,5	Hub bearing
30314 A	6-7314 A	70	150	38	Back axle

CRAFT	GOST	Dimensions (mm)			Application
		d	D	T	
32212 A	6-7512 A1	60	110	29,75	Wheels hubs
32215 A	6-7515 A1	75	130	33,25	Wheels hubs
32309 A	7609 A	45	100	38,25	Hub bearing
32310 A	6-7610 A	50	110	42,25	Wheels hubs
32313 A	6-7613 A	65	140	51	Wheels hubs
32315 A	6-7615 A	75	160	58	Back axle
33212 A	3007212 A	60	110	38	Wheels hubs
33215 A	3007215 A	75	130	41	Wheels hubs
7815 A	6-7815 A	75	135	44,5	Front wheel hub
MAZ					
30204 A	6-7204 A	20	47	15,25	Engine, fuel system
30205 A	6-7205 A	25	52	16,25	Engine, fuel system
30212 A	6-7212 A	60	110	23,75	Front and back axles distributing box drive
30215 A	7215 K1A	75	130	27,25	Front axle
30217 A	7217 A	85	150	30,5	Hub bearing
30220 A	6-7220 A1	100	180	37	Front axle hub
30311 A	6-7311 A	55	120	31,5	Distributing box
30312 A	6-7312 A	60	130	33,5	Hoist
30313 A	7313 A	65	140	36	Hub bearing
30314 A	6-7314 A	70	150	38	Distributing box, middle axle reduction gear
31312 A	27312 A	60	130	33,5	Back axle
31313 A	6-27313 A1	65	140	36	Back axle
32013 A	6-2007113 A	65	100	23	Middle axle back shaft
32018 A	2007118 A	90	140	32	Hub bearing
32020 A	2007120 A	100	150	32	Back axle
32024 A	6-2007124 A	120	180	38	Front axle hub
32208 A	7508 A	40	80	24,75	Steering gear
32212 A	6-7512 A	60	110	29,75	Hub bearing
32213 A	6-7513 A1	65	120	32,75	Back axle drive
32215 A	6-7515 A1	75	130	33,25	Hoist / Back axle
32216 A	6-7516 A	80	140	35,25	Middle axle reduction gear
32218 A	6-7518 A	90	160	42,5	Between wheels driving axles differential gear
32220 A	6-7520 A	100	180	49	Back axle hub
32222 A	6-7522 A	110	200	56	Hub bearing
32224 A	6-7524 A	120	215	61,5	Wheels hubs
32310 A	6-7610 A	50	110	42,25	Front axle hub
32312 A	6-7612 A	60	130	48,5	Front wheels hubs
32314 A	6-7614 A	70	150	54	Front axle hub / Distributing box
32315 A	6-7615 A	75	160	58	Front axle hub
32316 A	7616 A	80	170	61,5	Differential gear bearing
33018 A	3007118 A	90	140	39	Hub bearing

CRAFT	GOST	Dimensions (mm)			Application
		d	D	T	
33116 A	3007716 A	80	130	37	Hub bearing
33117 A	3007717 A	85	140	41	Hub bearing
33213 A	3007213 A	65	120	41	Hub bearing
6200 2RSA	180200 A	10	30	9	Engine, fuel system
6201 2RSA	180201 A	12	32	10	Detecting device
6202 2RSA	180202 A	15	35	11	Engine, fuel system
6203 2RSA	180203 A	17	40	12	Engine, cooling system
6205 2RSA	180205 A	25	52	15	Engine / Gear box
6206 2RSA	180206 A	30	62	16	Spare wheel lift
6303 2RSA	180303 A	17	47	14	Engine, cooling system
6305 2RSA	180305 A	25	62	17	Engine
PAZ					
30204 A	6-7204 A	20	47	15,25	Engine, cooling system
32215 A	6-7515 A1	75	130	33,25	Back wheels hubs, internal support
32216 A	6-7516 A1	80	140	35,25	Differential gear box
32217 A	6-7517 A	85	150	38,5	Back wheel hub, internal
32308 A	6-7608 A1	40	90	35,25	Wheels hubs
32310 A	6-7610 A	50	110	42,25	Front wheel hub, external
32311 A	6-7611 AK	55	120	45,5	Front wheels hubs, internal support
32313 A	6-7613 A1	65	140	51	Front wheel hub, internal
7815 A	6-7815 A	75	135	44,5	Back wheel hub, external
6203 2RSA	180203 A	17	40	12	Gear box / Tension roller / Engine
6206 2RSA	180206 A	30	62	16	Engine / Steering gear
UAZ					
30305 A	6-7305 AШ	25	62	18,25	Wheels hubs
30307 A	6-7307 A	35	80	22,75	Wheels hubs
32210 A	6-7510 A	50	90	24,75	Front and back axles
32306 A	6-7606 AУШ	30	72	28,75	Front and back axles
32308 A	6У-7608 A1	40	90	35,25	Front and back axles
6203 2RSA	180203 A	17	40	12	Leading end of driving shaft
6305 2RSA	180305 A	25	52	15	Gear box middle shaft
6306 2RSA	180306 A	30	72	19	Distributing box
URAL					
30204 A	6-7204 A	20	47	15,25	Engine
30209 A	6-7209 A	45	85	20,75	Steering gear
30216 A	6-7216 A	80	140	28,25	Hoist
30310 A	6-7310 A1	50	110	29,25	Main drive reduction gear / Axle
30311 A	6-7311 A	55	120	31,5	Axle
30312 A	6-7312 A	60	130	33,5	Distributing box / Hoist
30315 A	6-7315 A	75	160	40	Axle
32018 A	2007118 A	90	140	32	Middle and back axles

CRAFT	GOST	Dimensions (mm)			Application
		d	D	T	
32024 A	2007124 A	120	180	38	Wheels hubs
32215 A	6-7515 A	75	130	33,25	Main drive reduction gear / Shaft front support
32216 A	6-7516 A1	80	140	35,25	Axle / Main drive reduction gear
32306 A	7606 A	30	72	28,75	Electronic equipment
32310 A	6-7610 A	50	110	42,25	Distributing box
6201 2RSA	180201 A	12	32	10	Engine
6203 2RSA	180203 A	17	40	12	Engine
6204 2RSA	180204 A	20	47	14	Engine
6205 2RSA	180205 A	25	52	15	Gear box
6206 2RSA	180206 A	30	62	16	Power selection box
6305 2RSA	180305 A	25	62	17	Engine

CRAFT	GOST	Dimensions (mm)			Application
		d	D	T	
6-20703	6-20703	14	40	14	GAZ / UAZ
6-20803	6-20803	17	47	15	GAZ / UAZ / ZIL
1180304	1180304	20	52	18	ZIL / KAMAZ / MAZ
1180305	1180305	25	62	21	GAZ / KAMAZ
160703	160703	17	62	20	LAZ / ZIL
29908K1	29908K1	38,4	72,9	21.340	LAZ / PAZ
98206	98206	30,2	53	16	ZIL
170314 _n	170314 _n	70	150	35	ZIL / KAMAZ / KRAZ / MAZ
170412 _n	170412 _n	60	150	35	ZIL / KAMAZ / URAL
66412 _n	66412 _n	60	150	35	KRAZ
108804	108804	20	37	11	GAZ / IZ
108710	108710	50	80,5	22,8	KAMAZ / KRAZ
108810	108810	50	97,5	32	LIAZ / LAZ
180707	180707	35	80	23	DON / NIVA
127509AK	127509AK	45	85	24.750	ERAZ / UAZ
Y-27911A	Y-27911A	53,975	123,825	39,5	-
Y-807813A	Y-807813A	65	110	30,5	PAZ / GAZ / ZIL
67512	67512	60	110/117	29.750	MTZ
70-592708M1	70-592708M1	40	77,5	23	KAMAZ / URAL
6-12115EM	6-12115EM	75	115	20	MTZ
7809A	7809A	45	90	38.250	ZIL / MTZ
7909A	7909A	47	100	42.750	T-74 / T-75 / T-150
6-7815A	6-7815A	75	135	44,5	KAMAZ
7718	7718	90	160	49,5	KAMAZ / KRAZ
27310	27310	50	110	29.250	KAMAZ
27311	27311	55	120	31,5	MAZ
27312	27312	60	130	33,5	MAZ
27313	27313	65	140	36	KRAZ
27613	27613	65	140	51	MAZ
27616	27616	80	170	61,5	MAZ
97516A	97516A	80	140	79,625	-
530206K1	530206K1	30	62	16/24	RAF / ERAZ / GAZ
3086313	3086313	65	140	58,7	DET-250
954712K1	954712K1	60	120	58/60	T-4A
6-137205A	6-137205A	25	52	16.250	LAZ
962715XC17	962715XC17	75	129	30	MTZ
6-102409	6-102409	45	120	29	KAMAZ
42415 _n	42415 _n	75	190	45	-
57707AY	57707AY	35	80	57	UAZ / ERAZ
942/40	942/40	40	50	32	MTZ
943/30	943/30	30	38	32	MTZ

CRAFT	GOST	Dimensions (mm)			Application
		d	D	T	
264706	264706	29.96	43.98	33	LAZ / GAZ / ZIL
664913E	664913E	62	70	31	ZIL / KAMAZ / URAL / DON
664916E	664916E	81	92	15462	KAMAZ / URAL
664706	664706	30	42	113/59	MAZ
3KK20*26*34E	3KK20*26*34E	20	26	34	MTZ / IZ
3KK30*35*46E	3KK30*35*46E	30	35	46	-
3KK42*47*30E	3KK42*47*30E	42	47	30	GAZ
K55*63*20E	K55*63*20E	55	63	20	-
3KK72*82*45E	3KK72*82*45E	72	82	45	MTZ
K80*88*30E	K80*88*30E	80	88	30	-
776900X	776900X	11,6	39	29	VAZ
776900XK2	776900XK2	11,6	46,03	29	VAZ
776701XY	776701XY	12	49,4	40	GAZ / UAZ / RAF
776702X	776702X	12,75	57,5	48	PAZ / GAZ
776801X	776801X	12,75	51,56	38	UAZ / ERAZ / T -012 / DT-20
348702K2	348702K2	14,5	52	14	VAZ / ZAZ
820702AK8	820702AK8	15	37,65	13,5	-
356803E	356803E	17	40	25	GAZ
356803E1	356803E1	17	66	25	GAZ
156704E1	156704E1	20	50	20,6	VAZ
916904E	916904E	20	62	17	GAZ / UAZ
930904AE1	930904AE1	21,5	37	11,5	VAZ
126805E	126805E	25	62	17	ZAZ / T13010 / M-2141
746905	746905	26	44	21	MMVZ - 3.11211
866706E	866706E	28	72	27	M-2141
996905E1	996905E1	28	47	13,15	VAZ
996805E1	996805E1	28	50	20,15	VAZ
706Y	706Y	30	42	7	LAZ / KAVZ / LIAZ
7690906	7690906	30	47	8	ZAZ
808/32A	808/32A	32	66	16	-
3207BN	3056207K	35	72	27	UAZ
830700AE2	830700AE2	10,1	55	27	VAZ
830700AE	830700AE	10,1	55	32,4	VAZ
830700AKE	830700AKE	10,1	71	23	VAZ
830700AK2E	830700AK2E	10,1	71	26	UAZ
830900AE2	830900AE2	10,1	55	27	VAZ
830700AE3	830700AE3	10,1	55	30	UAZ
830900AE1	830900AE1	10,1	55	32,4	VAZ
830900AKE	830900AKE	10,1	60,3	23	VAZ
830900AK1E	830900AK1E	10,1	71	26	VAZ
256801 E1	256801 E1	12	82	26,7	VOLGA

CRAFT	GOST	Dimensions (mm)			Application
		d	D	T	
256801E	256801E	12	82	30	VOLGA
830701A	830701A	12	82	18	VAZ
180902AK	180902AK	16	35	14	IZ
HB 4366	330802E	16	30	39/92	VAZ / ZAZ / LIAZ
HB 4388	330902E	16	30	39/115	GAZ / VAZ / ERAZ
20703 A	20703 A	17	40	14	UAZ
20803 A	20803 A	17	47	15,5	UAZ / RAF / GAZ
830803AK4	830803AK4	17	64	28	-
830803AK3	830803AK3	17	78	28	-
7804Y	7804Y	19,058	42,25	16,637	VAZ
256705E1	256705E1	25	55	22	VAZ / M-2141
256605E1	256605E1	25	55	28	-
256805E	256805E	25	52	23	ZIL
256905E	256905E	25	55	30	-
6305N	50305Y	25	62	17	VAZ / LIAZ
6305 2RSN	750305	25	62	17	VAZ / LIAZ
7805Y	7805Y	26	57,15	17,462	VAZ
830700AK3E	830700AK3E	27,4	71	25	UAZ
256906E	256906E	28	58	42	-
7705Y	7705Y	28	67	20,5	VAZ / LADA / NIVA
256706E1	256706E1	30	60	37	VAZ
6306N	50306Y	30	72	19	LADA / NIVA
6306 2RSN	750306	30	72	19	VAZ
50706Y	50706Y	30	75	19	VAZ
750706Y	750706Y	30	75	19	RAF / IZ
520806K1Y	520806K1Y	31	55	19	VAZ
7707Y	7707Y	33	62	16	VAZ
956900KE1	956900KE1	33,05	52	20,6	-
956900E1	956900E1	33,05	62,17	40	-
256907A1E7	256907A1E7	34	64	37	ZAZ / VAZ
7807Y	7807Y	34,938	73,03	26,987	KKG -1,4 / PK -1,6A / ZAU-3
256807E13	256807E13	35	64	37	-
256707AK1E12	256707AK1E12	35	68	37	-
256908A1E7	256908A1E7	35	68	37	-
520907AE	520907AE	37	62	21	M-2141
520907A1E	520907A1E	37	62	20,6	IZ 2126
256908AE7	256908AE7	37	72	37	KAMAZ
256808AE	256808AE	40	74,048	40	VAZ
256708E	256708E	42	75	37	Aleko(Moskvich)
280114A	280114A	70	110	28	BELAZ
280714A1	280714A1	70	110	31	KAMAZ

CRAFT	GOST	Dimensions (mm)			Application
		d	D	T	
CB-588911	588911	52,388	84,5	20,84	GAZ-53
CB-360708	360708K1C17	40	70	18	LADA (NIVA/ VAZ old)
CB-360708K3	360708K3	40	66	17	LADA (NIVA/ VAZ new)
CB-360710	360710Y	50	82	20	VOLGA old
CB-360106	360106K1C23	30	55,6	17,5	LADA (SAMARA old)
CB-520806	520806K1Y	31	55	19	LADA (SAMARA new)
CB-986710	986710AE1	50	82	15,8	VOLGA new
CB-688811	688811K1C23	55	90/89	21	ZIL
CB-688911	688911C17	52,388	84,5/83,5	20,7	UAZ
CB-986714	986714KC17	70	105	21/21,5	MAZ / KAMAZ / KRAZ
CB-9588213	9588213C9	65	100	21	T-40
CB-9588214	958214K1C9	70	105	21,5	MTZ-50 / MTZ-52
CB-9588217	9588217C23	85	125	24,5	T-25 / DTZ-75



**CRAFT
BEARINGS**

Quality Minded

**Automotive
joints & rollers**

www.craft-bearings.com



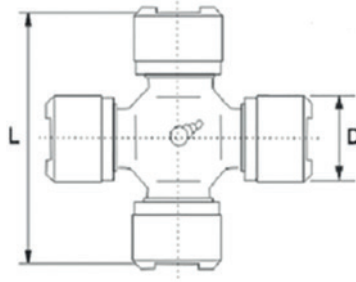

CRAFT	GOST	Dimensions (mm)	
		D	L
SG 1200A	MTZ	19	44
SG 1244A	LADA (2101-2201025-02)	23,8	61,3
SG 1266A	NIVA	28	71
SG 1277A	NIVA/MOSKVICH	28	84
SG 1288A	VOLGA(3102-2201025-01)	30	88
SG 1306A	GAZ(53A-2201025-01)	35	98
SG 1308A	ZIL- KAMAZ(5320-2201025-02)	39	118
SG 1310A	KAMAZ(5320-2205025-01)	50	135
SG 1977A	MAZ	50	155,8

CRAFT	OEM	Brand	Photo	Dimensions (mm)
55.6741	1016741	EDSCHA		6x24x7,2x15,2
55.3004	83004	EDSCHA		8x24x7,2x19,5
55.1158	30051158 1026011	TSE / SCHMITZ		6x30x8,8x19
55.3968	53968 801584	AUTOCAR / KOGEL		5,2x24x7x20,7
55.3367	53367 801583	AUTOCAR / KOGEL		6,4x24x7x16,3
55.4241	38069460 242410001 28410015 SPRT0028W	EDSCHA / SESAM VERSUS / SUER		11,8x31,5x6x19
55.0091	38080091 4038080090	EDSCHA / EDSCHA		8x31,5x6x12
55.1300	4038081301	EDSCHA		8x31,5x6,15x12
55.1001	13201001 6352604	VERSUS / KOGEL		10x26,3x9,5x17,5
55.1168	30051168 057718 1147082	TSE / SCHMITZ		10x26,1x9,1x20,8

Mounting instructions

Correct bearing installation techniques:

1. Use the appropriate sized tools for the bearing. Check for tool wear often.
2. Assure that both the shaft and housing seating areas are clean and free from contaminants.
3. Do not apply shock loads to the bearing during assembly either through mishandling or direct use of a hammer.
4. Use only the lubricant chosen for the application during installation. Do not mix lubricants.
5. Avoid touching bearing surfaces with bare hands as this can lead to surface oxidation.
6. Prior to press fitting, assure the bearing is aligned. Only apply force to the bearing race being pressed. For example: Do not cross load the bearing by pressing on the inner race when the outer race is being fitted.

Prior to installation:

1. Bearings should be stored in a clean and dry location without exposure to vibration.
2. Keep bearings in their original packaging until they are installed.
3. Hands should be clean and dry. Gloves recommended.
4. The work area should be clean with minimal exposure to contaminant generating equipment.
5. Handle bearings with care. A drop from even a low height or a low shock load can cause rolling surface brinelling, a starting point for surface damage.
6. Avoid cleaning or degreasing a new bearing as it will remove the preventative rust coating.

Manual of Scania Hub Bearing Mounting

1.

Remove retaining ring of wheel bearing, using lifter for spring retaining rings.

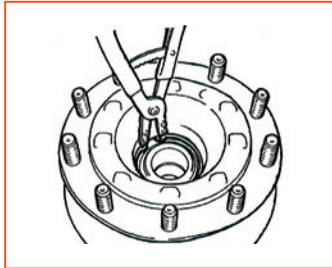

Drawing 1

2.

Place hub into press-device. The hub should bear on three points, but not on the bolts of wheel fixing. Press out bearing unit, using mandrel. Keep impact wheel if the automobile is equipped with ABS system.

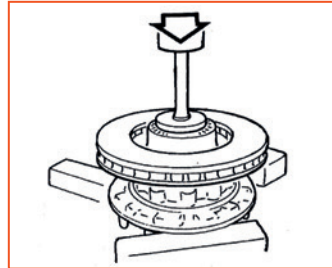

Drawing 2

3.

Important note! Clean thoroughly placement surface inside the hub.
Place mandrel under brake disc, so that the hub will not go down. Place the bearing into the hub. If the bearing is placed correctly, it should stand out a little the bottom part of hub.
Press in the bearing, using mandrel.

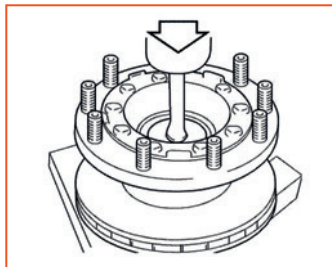

Drawing 3

4.

Overturn the hub and place carefully ABS impact wheel, using special hummber. If it's difficult to place impact wheel into the hub, just use the plate.

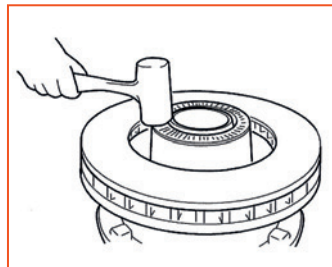

Drawing 4

5.

Place the retaining ring of wheel bearing.

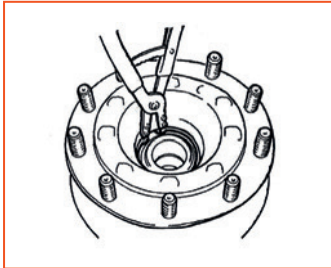

Drawing 5

6.

Grease wheel axle with the lubricant for chassis and place carefully the hub in such way that the retaining ring of bearing unit is not damaged. Grease remote washer and place it. Place washer lug in the gap on the wheel axle.

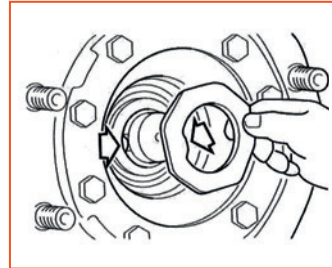

Drawing 6

7.

Important note! Follow the fact that the remote washer is kept in correct position. Otherwise the hub will not be fixed surely, even if the necessary tightening torque used. If during the tightening without distortion push on end head, the washer displacement risk is minimized.

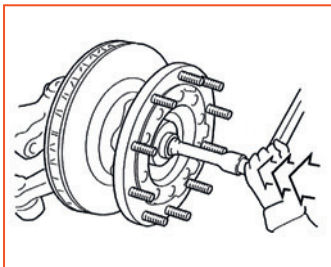

Drawing 7

8.

Grease hub nut and treaded surface of wheel axle. The nut is self-controlled and can be used several times. Tighten the nut with the help of end head. Continuously turn the hub during tightening. Tighten the nut – with force 300 Nm and afterward turn nut for more 45°. Afterwards make the marking on the remote washer opposite one of nut ribs. And afterwards tighten the nut in such way that the next nut rib is opposite the marking. As the hub nut is octahedral, this will provide 45° turning of it.

9.

Pay attention that the retaining ring is not damaged. Grease the hood-device that is contacted with the hub and place the hood. Place the cap and tighten in with 10 Nm force.

Manual of DAF Bearing Mounting

1.

Carefully remove the retaining ring that fixes inner bearing races in between. (Drawing 1)

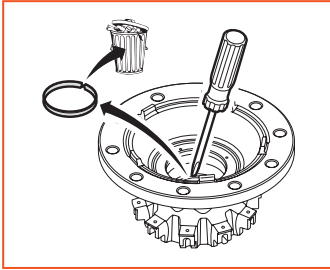

Drawing 1

2.

Remove inner races with rollers with the help of tapping. (Drawings 2, 3)

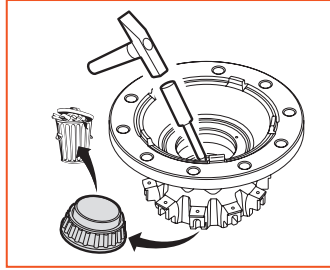

Drawing 2

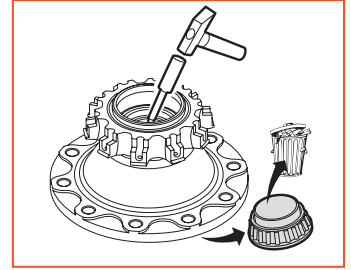

Drawing 3

3.

With the help of special device press out inner bearing races. (Drawings 4, 5)

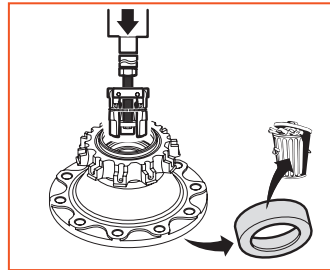

Drawing 4

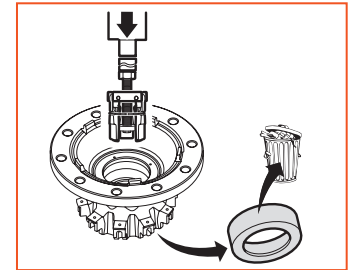

Drawing 5

4.

Attention! Thoroughly clean the hub and make visual inspection in order to find any damages of bearings placing slots. (Drawings 6, 7)

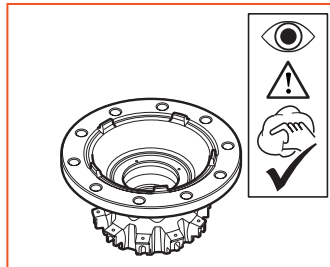

Drawing 6

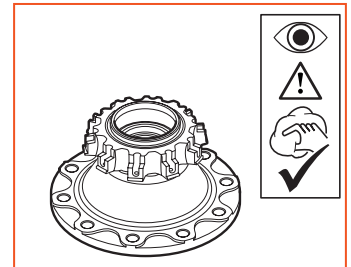

Drawing 7

5.

Assemble bearings inside the hub, follow marking on the race. (Drawing 8)

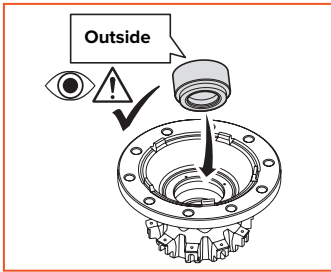

Drawing 8

6.

With the help of special device press in outer bearings races with the effort not more than 60kNm. (Drawing 9)

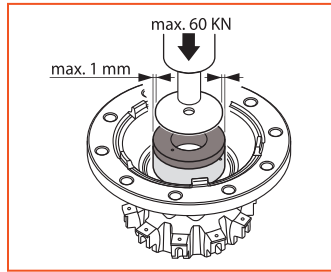

Drawing 9

7.

Assemble bearings inside the hub, follow marking on the race. (Drawing 10)

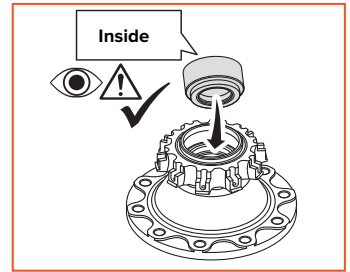

Drawing 10

8.

With the help of special device press in outer bearings races with the effort not more than 60kNm. (Drawing 11)

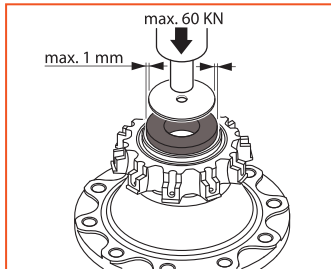

Drawing 11

9.

Place the retaining ring into the gaps on the outer bearing races till click. Make sure that the ring fits in correctly. (Drawing 12)

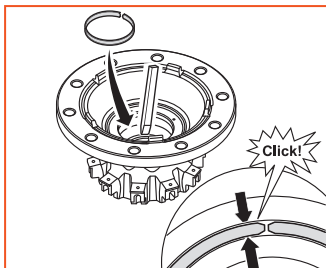

Drawing 12

CRAFT	FAG
41.01594	566283.01.H195
41.01595	566834.H195
41.03628	566834.H195
41.03650	564734.H195
41.05052	566283.01.H195
41.05923	566074.H195
41.19305	805003A.H195
41.24482	571762.01.H195
41.39770	201043
41.67828	566425.H195
41.67830	566427.H195
41.67831	566426.H195
41.80374	805012.06.H195
41.93288	801974AE.H195
41.93420	803750B
41.80379	803194.26.H195
42.343016	723 7008 10
42.343018	569868.H195
42.343019	570530.H195
42.098033	723 7001 10
42.098034	723 7005 10
42.343012	566830.H195

CRAFT	SKF
41.01594	VKBA 5431
41.01595	VKBA 5429
41.03628	VKBA 5429
41.03650	VKBA 5549
41.05052	VKBA 5431
41.05923	VKBA 5453
41.19305	VKBA 5552
41.24482	VKBA 5314
41.39770	VKBA 5420
41.67828	VKBA 5423
41.67830	VKBA 5424
41.67831	VKBA 5425
41.80374	VKBA 5397
41.93288	VKBA 5377
41.93420	VKBA 5408
41.80379	VKBA 5415
42.343016	VKBA 5507
42.098033	VKBA 5521
42.098034	VKBA 5522

CRAFT	FERSA
41.01594	F 200017
41.01595	F 200019
41.03628	F 200019
41.03650	F 300001
41.05052	F 200017
41.05923	F 200016
41.19305	F 15100
41.24482	F 15097
41.39770	F 300003
41.67828	F 200014

CRAFT	FERSA
41.67830	F 200015
41.67831	F 200013
41.80374	F 15122
41.93288	F 300005
41.93420	F 200004
41.80379	F 15125
42.343018	F 200029
42.343019	F 200025
42.343012	F 200028

CRAFT	OEM
DAF	
41.01594	1801594
41.01595	1801595
41.03628	1801595
41.05052	1801594
41.05923	1801592
41.83074	1408086
IVECO	
41.83074	2996882
41.93288	5006207845
41.39770	504189654
41.80379	7181863
MAN	
41.80379	81.93420.0336
41.93288	81.93420.0288
41.93420	81.93420.6097
MERCEDES BENZ	
41.80379	013 981 23 05
41.19305	017 981 50 05
RENAULT TRUCK	
41.39770	5010439770
41.67830	7420967830
41.67831	7420967831
VOLVO	
41.67828	20967828
41.67830	20967830
41.93420	85110616
41.80379	85103257
SCANIA	
41.24482	1724482
SAF	
42.343016	4 200 1006 00
42.343018	3 434 3018 00
42.343012	3 434 3012 00
42.343019	3 434 3019 00
BPW	
42.098033	09 801 02 33 0
42.098034	09 801 02 34 0

CRAFT	OEM
BPW	
30204 A	02.6401.20.00
30205 A	02.6401.25.00
30206 A	02.6401.30.00
30207 A	02.6401.35.00
30209 A	02.6401.45.00
30210 A	02.6401.50.00
30212 A	02.6401.60.00
30313 A	02.6402.65.00
32007 A	02.6404.35.00
32212 A	02.6405.60.00
32219 A	02.6405.95.00
32309 A	02.6406.45.00
32310 A	02.6406.50.00
32314 A	02.6406.70.00
33209 A	02.6407.45.00
33213 A	02.6407.65.00
33215 A	02.6407.75.00
33217 A	02.6407.85.00
33215 A	02.6408.29.00
33116 A	02.6408.80.00
33118 A	02.6408.90.00
33213 A	02.6410.22.00
33118 A	02.6410.23.00
33116 A	02.6410.24.00
32310 A	02.6410.25.00
32222 A	02.6410.26.00
32219 A	02.6410.28.00
32222 A	02.6405.11.00
32310 A	02.6406.50.00
32314 A	02.6406.70.00
33213 A	02.6407.67.00
33215 A	02.6407.75.00
33116 A	02.6408.80.00
33118 A	02.6408.90.00
33118 A	02.6408.92.00
33213 A	02.6410.22.00
33118 A	02.6410.23.00

CRAFT	OEM	CRAFT	OEM
33116 A	02.6410.24.00	33213 A	10500558
32310 A	02.6410.25.00	32208 A	10500474
32222 A	02.6410.26.00	32210 A	10500496
32314 A	02.6410.27.00	32220 A	10500505
32219 A	02.6410.28.00	MERCEDES BENZ	
33215 A	02.6410.29.00	4119305	000 350 05 35
GIGANT		4119305	000 350 09 35
33117 A	10500574	33020 A	001 980 66 02
33118 A	10500582	33020 A	005 981 84 05
32224 A	10500787	33020 A	005 981 85 05
33208 A	10500799	33020 A	006 981 01 05
33215 A	10500858	32311 A	006 981 08 05
32219 A	10500859	32311 A	006 981 69 05
32222 A	10500872	32311 A	006 981 74 05
32314 A	10500873	33217 A	007 981 70 05
4119305	9272681	32311 A	010 981 93 05
32208 A	10500474	33217 A	011 981 08 05
32210 A	10500496	33116 A	012 981 40 05
32220 A	10500505	33116 A	012 981 41 05
33213 A	10500558	33020 A	014 981 32 05
33116 A	10500572	33116 A	017 981 49 05
33117 A	10500574	33020 A	A 005 981 85 05
33118 A	10500582	MERITOR (ROR)	
32224 A	10500787	HM 218248/ HM 218210	99041035B
33208 A	10500799	HM 218248/ HM 218210	99041035S
33215 A	10500858	33213 A	99041045B
32219 A	10500859	33213 A	99041045S
32222 A	10500872	32218 A	99041057
32314 A	10500873	32220 A	99041058
4119305	9272778	32310 A	99041068
32212 A	10500481	32218 A	99041058
32310 A	10500491	HM 218248/ HM 218210	99041035S
32211 A	10500498	33213 A	99041045S
32214 A	10500503	SAF	
33213 A	10500558	30206 A	4 200 0003 00
33116 A	10500572		
33118 A	10500582		
33208 A	10500799		

CRAFT	OEM	CRAFT	OEM
30307 A	4 200 0011 00	HM 215249/ HM 215210	4 200 1007 00
30309 A	4 200 0012 00		
30310 A	4 200 0013 00	33118 A	4 200 1009 00
30312 A	4 200 0015 00	41.03650	03 200 2001 51
30313 A	4 200 0016 00	41.03650	03 434 3650 00
32209 A	4 200 0022 00	30307 A	04 200 0011 00
32219 A	4 200 0026 00	30309 A	04 200 0012 00
32218 A	4 200 0027 00	30310 A	04 200 0013 00
32221 A	4 200 0028 00	30311 A	04 200 0014 00
32309 A	4 200 0031 00	30312 A	04 200 0015 00
32311 A	4 200 0032 00	30313 A	04 200 0016 00
32312 A	4 200 0033 00	32219 A	04 200 0026 00
32314 A	4 200 0034 00	32218 A	04 200 0027 00
33113 A	4 200 0055 00	32221 A	04 200 0028 00
33207 A	4 200 0057 00	32312 A	04 200 0033 00
33211 A	4 200 0058 00	32314 A	04 200 0034 00
33213 A	4 200 0060 00	32213 A	04 200 0023 00
33209 A	4 200 0063 00	SCHMITZ CARGOBULL	
33212 A	4 200 0064 00	100167600	41.03650
33215 A	4 200 0070 00	100167601	41.03650
HM 218248/ HM 218210	4 200 1006 00	1002689	41.03650

BUREAU VERITAS
Certification



Certification

Awarded to

CRAFT bearings, UAB

Draugystės g. 19, LT-51230 Kaunas, Lithuania



Bureau Veritas Certification Holding SAS – UK Branch certify that the Management System of the above organisation has been audited and found to be in accordance with the requirements of the management system standards detailed below

STANDARD

ISO 9001:2015 / LST EN ISO 9001:2015

SCOPE OF CERTIFICATION

Trade and management of development, design, and manufacture of bearings, chains, bearing related products, and their parts

Certification cycle start date **9 December 2017**

Subject to the continued satisfactory operation of the organisation's Management System, this certificate expires on **8 December 2020**

Original certification date **7 October 2008**

To check the validity of this certificate please call tel. +370 5 233 79 75.
Further clarification regarding the scope of this certificate and the applicability of the Management System requirements may be obtained by consulting the organisation.

Certificate No: **LT2080Q**

Version No: **1**

Issuing date: **11 December 2017**

Certification authority



Certification body address: 66 Prescot Street, London E1 8JL, United Kingdom
Office in Lithuania: UAB "Bureau Veritas Lit", Ukmens g. 369A, LT-12142 Vilnius, Lithuania



