

SEALS/BEARINGS

457 601 — WHEELS

SPECIFICATIONS

SCOTSEAL CLASSIC/SCOTSEAL LONGLIFE SPECIFICATIONS

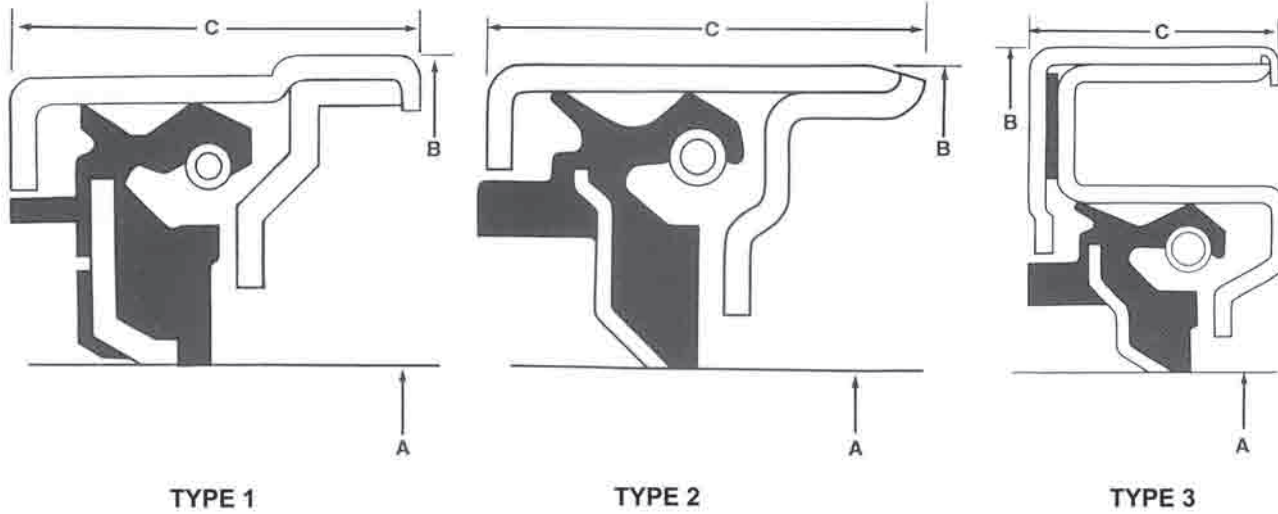

SCOTSEAL

HUB CAP

GASKET

INSTALLATION TOOL GUIDE

BEARING SPACER

SCOTSEAL NO.	TYPE	SHAFT DIAM. (A)	O.D. (B)	OVERALL WIDTH (C)
27438	1	2.750	3.784	.762
28758	1	2.875	3.881	.750
28820	1	2.875	4.131	.844
28832	1	2.875	4.181	.844
31175*	2	3.125	4.131	.781
31244*	1	3.125	4.381	.781
31264	1	3.125	4.405	.844
31266*	1	3.125	4.442	.781
31281	1	3.125	4.506	.672
31307	1	3.125	4.631	.672
32470	1	3.250	4.506	.672
34387	1	3.438	4.762	.859
34975	2	3.500	4.552	.862
35000*	1	3.500	4.631	.986
35060*	1	3.500	4.819	.906
35066	1	3.500	4.847	.904
35072	1	3.500	4.857	.904
35075	1	3.500	5.006	.891
35820	1	3.577	4.819	.906
36285*	1	3.625	4.819	.906
36358	1	3.625	5.006	.859
36365	1	3.625	5.006	.891
38709	1	3.875	5.134	.844
38736	1	3.875	5.255	.844
38747	2	3.875	5.381	1.016
38750	1	3.875	5.506	.937
38780	1	3.875	5.696	.937

SCOTSEAL NO.	TYPE	SHAFT DIAM. (A)	O.D. (B)	OVERALL WIDTH (C)
39380	2	3.938	5.381	1.016
39420	1	3.938	5.506	.937
39425	1	3.938	5.509	1.016
39988	1	4.000	5.131	1.047
40040	1	4.000	5.381	1.016
40086	3	4.000	5.631	.715
40136	1	4.000	5.759	1.078
40139	1	4.000	5.765	1.078
42550	1	4.250	5.506	.938
42623	1	4.250	6.014	.984
42624	1	4.250	6.048	.984
42625	5	4.250	6.020	1.122
42672	1	4.250	6.259	1.250
42800	1	4.266	6.071	.875
43752	1	4.375	5.756	1.016
43764	1	4.375	5.910	1.000
43800*	1	4.375	6.008	1.047
43860	1	4.375	6.259	.922
43865	1	4.375	6.259	1.047
43875	1	4.375	6.316	1.125
44922	1	4.500	5.381	.984
44964	1	4.500	5.506	.750
45010	1	4.500	5.506	.938
45099	1	4.500	5.756	1.016
45100	1	4.500	5.756	1.016
45103	1	4.500	5.881	.984
45152	1	4.500	6.316	1.125
45160	1	4.500	6.259	1.047
45162	1	4.500	6.446	.938

Scotseals must be installed with tools listed in this catalog.
* Fits Cup Bore

457 601 — WHEELS

SEALS/BEARINGS

SCOTSEAL CLASSIC/SCOTSEAL LONGLIFE SPECIFICATIONS— (Continued)

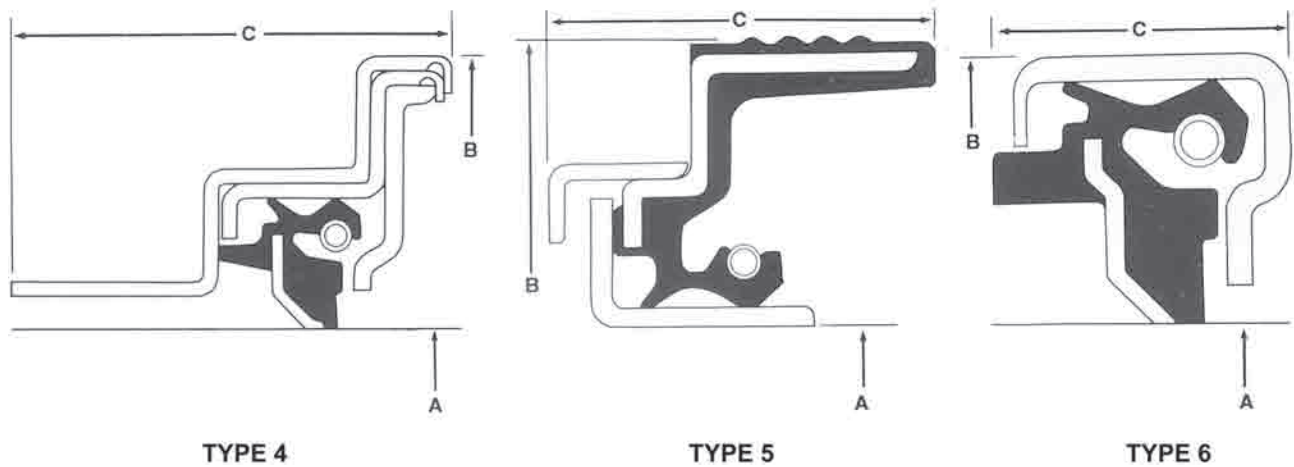

SCOTSEAL NO.	TYPE	SHAFT DIAM. (A)	O.D. (B)	OVERALL WIDTH (C)
46305	1	4.625	6.006	1.063
46390	1	4.635	6.014	1.031
47483*	1	4.750	6.006	1.063
47690*	1	4.766	6.006	1.063
47697	1	4.766	6.316	1.125
47698	1	4.766	6.320	1.125
47699	1	4.766	7.006	1.250
48000	1	4.766	6.259	1.047
48297	1	4.824	6.316	1.125
48298	1	4.824	6.506	1.125

SCOTSEAL NO.	TYPE	SHAFT DIAM. (A)	O.D. (B)	OVERALL WIDTH (C)
48690	1	4.875	6.006	.875
48792	1	4.875	6.259	1.047
48794	1	4.875	6.384	.938
48796	1	4.875	6.446	.938
48884	1	4.875	6.508	1.063
50124	1	5.000	6.259	1.047
50190	4	5.000	7.385	1.875
52658	1	5.250	7.381	.945
52664	4	5.250	7.385	2.500

Scotseal Longlife™ Specifications

SCOTSEAL LONGLIFE NO.	TYPE	SHAFT DIAM. (A)	O.D. (B)	OVERALL WIDTH (C)
35103	1	3.500	4.847	.904
42631	1	4.250	6.014	.984

SCOTSEAL LONGLIFE NO.	TYPE	SHAFT DIAM. (A)	O.D. (B)	OVERALL WIDTH (C)
46308	1	4.625	6.006	1.063
47693	1	4.767	6.316	1.125

Scotseals must be installed with tools listed in this catalog.
* Fits Cup Bore

NOTE: Oil seals are usually installed in the OEM seal bore. However, on some applications, they are installed in the bearing cup bore.

SPECIFICATIONS

SCOTSEAL

HUB CAP

GASKET

INSTALLATION TOOL GUIDE

BEARING SPACER

SCOTSEAL PLUS XL SPECIFICATIONS

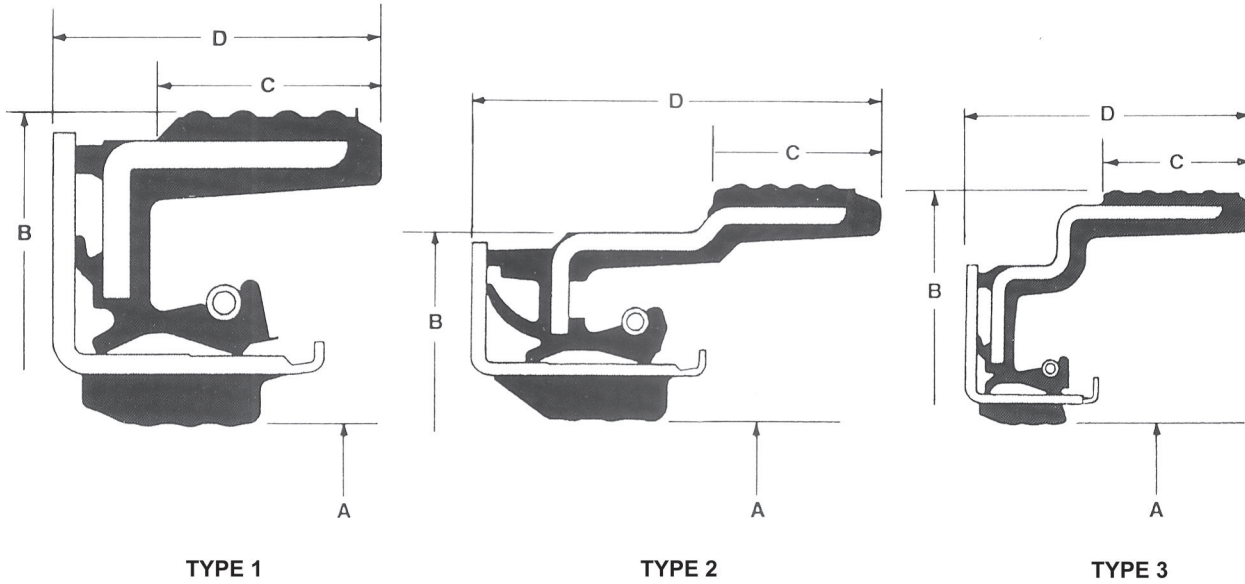

SCOTSEAL PLUS XL NO.	TYPE	SHAFT DIAM. (A)	SEAL O.D. (B)	PRESSFIT WIDTH (C)	OVERALL WIDTH (D)
23590		2.359	3.949	.575	.686
29480		2.948	4.736	.526	.637
34384	1	3.438	4.770	.598	.700
34971	1	3.500	4.557	.512	.900
34994*	1	3.500	4.765	.409	.706
35058	2	3.500	4.854	.580	.903
38776	3	3.875	5.704	.580	.892
39426†	1	3.937	5.526	.478	.591
39979	1	4.000	5.137	.517	.953
40091	1	4.000	5.639	.376	.688
40129	2	4.000	5.767	.594	.995
42627	2	4.250	6.025	.581	.971
42673	3	4.250	6.267	.852	1.245
43754	2	4.375	5.764	.594	.995
43761	2	4.375	5.918	.585	1.000
44916	1	4.500	5.389	.548	.975
45093	1	4.500	5.764	.659	.767
45095	2	4.500	5.890	.581	1.009
45157	1	4.500	6.264	.470	.750
46300	2	4.625	6.014	.562	.912
47691	1	4.767	6.324	.562	1.035
47692	2	4.767	6.326	.559	1.420
48002	1	4.767	6.264	.433	.795

† Scotseal Plus Design

* Fits Cup Bore

457 601 — WHEELS

SEALS/BEARINGS

TAMPER-PROOF, VENTED HUBCAP SPECIFICATIONS NUMERICAL LIST

HOW TO DETERMINE CORRECT HUBCAP FOR MOUNTING

Bolt-on-Caps: Count the number of mounting holes, measure diameter of bolts; measure bolt circle (select 2 holes opposite each other and measure from the center of one bolt hole to the center of the one opposite).

Screw-on-Caps: Male threads; measure outside diameter and determine the number of threads per inch.

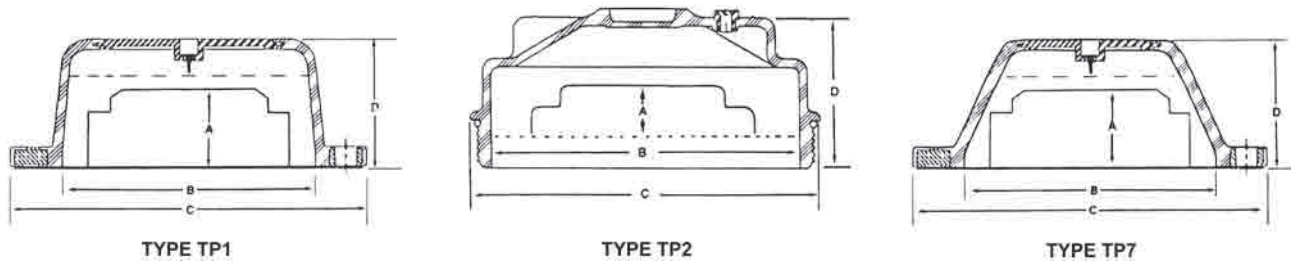

CR NUMBER		BOLT HOLES	HOLE SIZE	BOLT CIRCLE	MAX. AXLE EXT. (A)	HUBCAP SIZE			TYPE
HUBCAP KIT	REPLACEMENT GASKET					I.D. (B)	O.D. (C)	HEIGHT (D)	
1300 ¹	453795	6	.349	5.500-5.562	1.703	4.400	6.250	2.161	TP3
1305	453868	4	.349	3.625	1.566	2.400	4.313	2.024	TP1
1311	453869	6	.349	4.500	1.878	3.500	5.250	2.370	TP1
1331	453795	6	.349	5.500-5.562	2.081	4.287	6.250	2.727	TP7
1343	453795	6	.349	5.500-5.562	1.703	4.440	6.250	2.161	TP1
1362	453818	5	.349	5.500	1.717	4.440	6.250	2.175	TP1
1396 ²	450799	6	.349	6.750	2.805	5.647	7.500	3.370	TP3
1399	450799	6	.349	6.750	2.805	5.647	7.500	3.370	TP1

¹ Hubodometer mount version of 1343

² Hubodometer mount version of 1399

For installation procedures, reference page 27.

SPECIFICATIONS

SCOTSEAL

HUB CAP

GASKET

INSTALLATION
TOOL GUIDE

BEARING
SPACER

SEALS/BEARINGS

457 601 — WHEELS

SPECIFICATIONS

SCOTSEAL

GASKET

INSTALLATION
TOOL GUIDE

BEARING
SPACER

TF (ZYTEL®) HUBCAP NUMERICAL LIST

HOW TO DETERMINE CORRECT HUBCAP FOR MOUNTING

Bolt-on-Caps: Count the number of mounting holes, measure diameter of bolts; measure bolt circle (select 2 holes opposite each other and measure from the center of one bolt hole to the center of the one opposite).

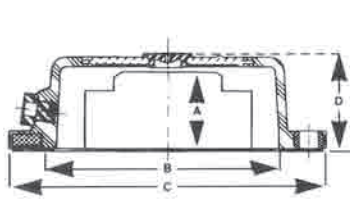

TF1

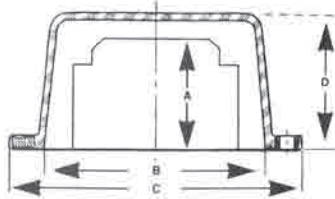

TF2

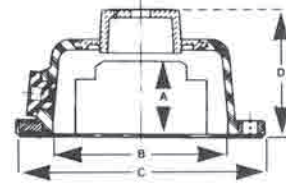

TF3

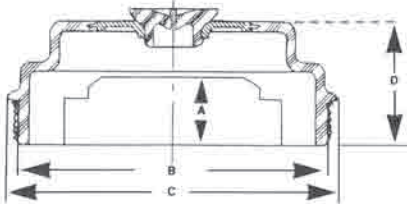

TF4

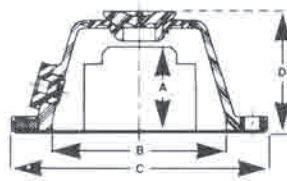

TF7

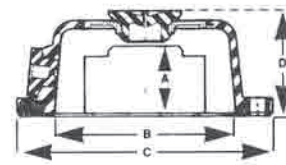

TF8

CR NUMBER				BOLT HOLES	HOLE SIZE	BOLT CIRCLE	MAX. AXLE EXT. (A)	HUBCAP SIZE			TYPE
HUBCAP KIT	REPLACEMENT GASKET	REPLACEMENT PLUG	REPLACEMENT SIDE FILL					I.D. (B)	O.D. (C)	HEIGHT (D)	
1600 ¹	453795	—	453770	6	.349	5.500-5.562	1.990	4.432	6.250	3.082	TF3
1601 ¹	453818	—	453770	5	.349	5.500	1.920	4.440	6.250	3.012	TF3
1608 ²	453868	453879	453811	4	.349	3.625	1.808	2.400	4.313	2.024	TF8
1612 ²	453869	453807	453811	6	.349	4.500	1.880	3.500	5.250	2.609	TF8
1613 ²	453795	453879	453942	6	.349	5.500-5.562	1.586	4.385	6.250	1.643	TF1
1623	453909	450434	453770	6	.349	5.125-5.250	2.125	4.132	6.000	2.632	TF8
1627	453912	450434	453770	3	.416	5.250	2.125	4.132	6.000	2.632	TF8
1630 ²	453795	453807	453811	6	.349	5.500-5.562	2.220	4.290	6.250	2.727	TF7
1640	453795	—	—	6	.349	5.500-5.562	2.055	4.440	6.250	2.235	TF2
1642	453818	450434	453770	5	.349	5.500	1.730	4.440	6.250	2.469	TF8
1643	453795	450434	453770	6	.349	5.500-5.562	1.730	4.440	6.250	2.469	TF8
1644 ²	453795	453807	453811	6	.349	5.500-5.562	1.730	4.440	6.250	2.469	TF8
1665	453909	450434	453770	6	.349	5.125-5.250	1.400	4.132	6.000	1.905	TF8
1669 ²	453918	453813	453819	6	.349	5.875	1.323	4.715	6.580	1.600	TF8
1670 ²	453825	450434	453770	6	.286	6.625	1.775	5.526	7.344	2.564	TF8
1681	453915	450434	453770	4	.349	5.500	1.375	4.060	5.615	1.880	TF8
1691 ²	453795	453879	453942	6	.349	5.500-5.562	1.120	4.257	6.250	1.397	TF1
1694	450799	450434	453770	6	.349	6.750	2.887	5.645	7.500	3.392	TF3
1696	450799	450434	453770	6	.349	6.750	2.887	5.645	7.500	3.688	TF8
1697	450799	—	—	6	.349	6.750	3.137	5.644	7.500	3.380	TF2
1698	453906	450434	453770	6	.416	6.000	2.000	5.000	6.750	2.507	TF8

¹ Hubdrometer mount version of 1643

² Black Design

For installation procedures, reference page 27.

Zytel® is a DuPont Product.

457 601 — WHEELS

SEALS/BEARINGS

STEEL HUBCAP SPECIFICATIONS NUMERICAL LIST

HOW TO DETERMINE CORRECT HUBCAP FOR MOUNTING

Bolt-on-Caps: Count the number of mounting holes, measure diameter of bolts; measure bolt circle (select 2 holes opposite each other and measure from the center of one bolt hole to the center of the one opposite).

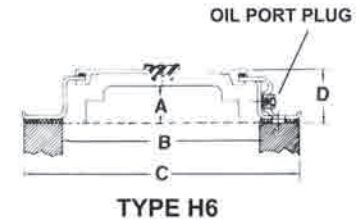
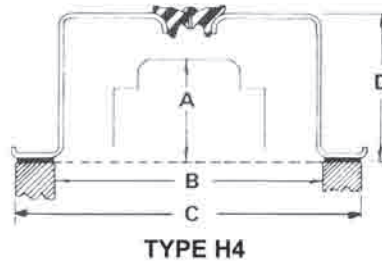
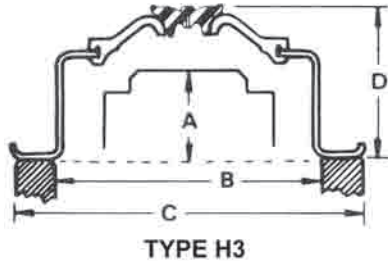

CR NUMBER			BOLT HOLES	HOLE SIZE	BOLT CIRCLE	MAX. AXLE EXT. (A)	HUBCAP SIZE			TYPE
HUBCAP KIT	REPLACEMENT GASKET	REPLACEMENT PLUG					I.D. (B)	O.D. (C)	HEIGHT (D)	
1702	450741	450434	6	.313	5.875	1.835	4.525	7.000	2.683	H3
1703	450781	453813	6	.313	5.562	1.625	4.540	6.625	1.837	H6
1711	450755	450434	6	.313	4.500	1.720	3.413	5.250	2.568	H3
1715	450749	450434	4	.250	5.000	2.315	3.912	6.250	3.163	H3
1723	450748	450434	6	.313	5.125	2.315	3.912	6.000	3.163	H3
1727	450777	450434	3	.375	5.250	2.315	3.912	6.250	3.163	H3
1742	450775	450434	5	.313	5.500	1.742	4.525	6.313	2.683	H3
1743	453795	450434	6	.313	5.500	1.742	4.525	6.313	2.683	H3
1744 ¹	453795	450434	6	.313	5.500	1.742	4.525	6.313	2.683	H3
1753	453795	450434	6	.313	5.500	1.835	4.525	6.173	2.683	H4
1754	450760	450434	8	.375	7.750	2.000	5.625	8.750	2.848	H3
1765	450748	450434	6	.313	5.125	1.190	4.288	6.625	2.038	H3
1768	450778	450434	6	.313	5.250	2.315	3.912	6.250	3.163	H3
1770	450768	450434	6	.250	6.625	1.525	4.540	7.313	2.675	H3
1787	453645	453813	6	.313	5.875	1.485	4.540	6.875	1.702	H6
1788	450788	453813	6	.313	5.500	1.485	4.540	6.625	1.702	H6
1790	453644	453813	6	.313	5.500	.995	4.540	6.625	1.227	H6
1796	450799	450434	6	.297	6.750	2.192	5.510	7.710	3.312	H4
1798	450752	450434	6	.375	6.000	2.250	4.970	6.938	3.098	H3
1799	450799	450434	6	.297	6.750	2.086	5.290	7.710	3.312	H3

¹ Black Design

For installation procedures, reference page 27.

SPECIFICATIONS

SCOTSEAL

HUB CAP

GASKET

INSTALLATION
TOOL GUIDE

BEARING
SPACER

SEALS/BEARINGS

457 601 — WHEELS

SPECIFICATIONS

LEXAN HUBCAP SPECIFICATIONS NUMERICAL LIST

HOW TO DETERMINE CORRECT HUBCAP FOR MOUNTING

Bolt-on-Caps: Count the number of mounting holes, measure diameter of bolts; measure bolt circle (select 2 holes opposite each other and measure from the center of one bolt hole to the center of the one opposite).

Screw-on-Caps: Male threads; measure outside diameter and determine the number of threads per inch.

CR NUMBER					MAX. AXLE EXT.	HUBCAP SIZE				
HUBCAP KIT	REPLACEMENT GASKET	PLUG	BOLT HOLES	HOLE SIZE	BOLT CIRCLE	(A)	I.D. (B)	O.D. (C)	HEIGHT (D)	TYPE
1282	454051	450434	6	6.250 x 8 OD	Threaded	1.500	5.282	6.465	3.103	TMFV
1283 ¹	454051	NR	6	6.250 x 8 OD	Threaded	1.320	5.756	6.465	2.750	HDM2
1284 ²	454051	NR	6	6.250 x 8 OD	Threaded	1.500	5.282	6.465	3.103	TMB
1733	450293	450434	6	.313	5.500	2.438	4.750	6.250	3.000	HFV

¹ Hubodometer mount version of 1282

² Black Design

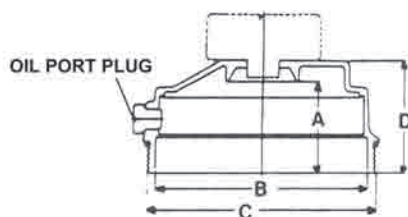

TYPE HDM2

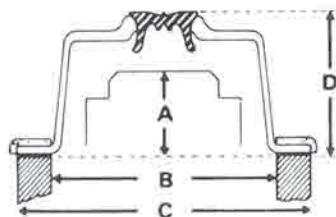

TYPE HFV

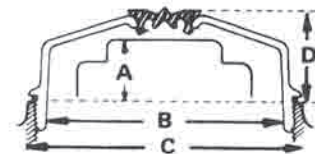

TYPE TMFV

TAMPER-PROOF, (ZYTEL) VENTED HUBCAP SPECIFICATIONS LISTED BY SIZE

			MAX. AXLE EXT.	HUBCAP SIZE				CR NUMBER	
BOLT CIRCLE	BOLT HOLES	HOLE SIZE	(A)	I.D. (B)	O.D. (C)	HEIGHT (D)	TYPE	REPLACEMENT GASKET	HUBCAP KIT
3.625	4	.349	1.566	2.400	4.313	2.024	TP1	453868	1305
4.500	6	.349	1.878	3.500	5.250	2.370	TP1	453869	1311
5.500	5	.349	1.717	4.440	6.250	2.250	TP1	453818	1362
5.500 - 5.562	6	.349	1.703	4.440	6.250	2.161	TP3	453795	1300 ¹
5.500 - 5.562	6	.349	2.081	4.287	6.250	2.727	TP7	453795	1331
5.500 - 5.562	6	.349	1.703	4.440	6.250	2.250	TP1	453795	1343
6.750	6	.349	2.805	5.647	7.500	3.370	TP3	450799	1396 ¹
6.750	6	.349	2.805	5.647	7.500	2.340	TP1	453969	1399

¹ Hubodometer mount version

For installation procedures, reference page 27.

SCOTSEAL

HUB CAP

GASKET

INSTALLATION TOOL GUIDE

BEARING SPACER

457 601 — WHEELS

SEALS/BEARINGS

TF (ZYTEL) HUBCAP
LISTED BY SIZE

BOLT CIRCLE	BOLT HOLES	HOLE SIZE	MAX. AXLE EXT. (A)	HUBCAP SIZE			TYPE	CR NUMBER		
				I.D. (B)	O.D. (C)	HEIGHT (D)		REPLACEMENT		HUBCAP KIT
								GASKET	PLUG	
3.625	4	.349	1.808	2.390	4.124	2.124	TF8	453868	453807	1608 ²
4.500	6	.349	1.880	3.500	5.250	2.609	TF8	453869	453807	1612 ²
5.125 - 5.250	6	.349	1.400	4.132	6.000	1.905	TF8	453909	450434	1665
5.125 - 5.250	6	.349	2.125	4.132	6.000	2.632	TF8	453909	450434	1623
5.250	3	.411	2.125	4.132	6.000	2.632	TF8	453912	450434	1627
5.500	5	.349	1.730	4.440	6.250	2.469	TF8	453818	450734	1642
5.500	5	.349	1.825	4.440	6.250	3.012	TF3	453818	450434	1601 ¹
5.500	4	.349	1.375	4.060	5.615	2.100	TF8	453915	450434	1681
5.500 - 5.562	6	.349	.995	4.257	6.250	1.397	TF1	453795	453807	1691 ²
5.500 - 5.562	6	.349	1.625	4.385	6.250	1.886	TF1	453795	453879	1613 ²
5.500 - 5.562	6	.349	1.730	4.440	6.250	2.469	TF8	453795	450434	1643
5.500 - 5.562	6	.349	1.730	4.440	6.250	2.469	TF8	453795	453807	1644 ²
5.500 - 5.562	6	.349	1.732	4.385	6.250	2.471	TF5	453795	450434	1633
5.500 - 5.562	6	.349	1.825	4.432	6.250	3.082	TF3	453795	450434	1600 ¹
5.500 - 5.562	6	.349	2.025	4.440	6.250	2.235	TF2	453795	—	1640
5.500 - 5.562	6	.349	2.151	4.273	6.250	2.727	TF7	453795	453807	1630 ²
5.875	6	.349	.661	4.190	6.563	1.166	TF8	453918	453807	1669 ²
6.000	6	.411	2.000	5.000	6.750	2.727	TF8	453906	450434	1698
6.625	6	.286	1.835	5.526	7.344	2.564	TF8	453825	453807	1670 ²
6.750	6	.349	3.255	5.662	7.500	3.455	TF2	453969	—	1697
6.750	6	.349	3.400	5.662	7.500	3.688	TF8	453969	450434	1696

¹ Hubdrometer mount version² Black Design

For installation procedures, reference page 27.

Zytel® is a DuPont Product.

S
P
E
C
I
F
I
C
A
T
I
O
N
S

SCOTSEAL

HUB
CAP

GASKET

I
N
S
T
A
L
L
A
T
I
O
N
T
O
O
L
G
U
I
D
EB
E
A
R
I
N
G
S
P
A
C
E
R

SEALS/BEARINGS**457 601 — WHEELS****STEEL HUBCAP SPECIFICATIONS
LISTED BY SIZE**

			MAX. AXLE EXT.	HUBCAP SIZE				CR NUMBER		
BOLT CIRCLE	BOLT HOLES	HOLE SIZE	(A)	I.D. (B)	O.D. (C)	HEIGHT (D)	TYPE	REPLACEMENT		HUBCAP KIT
								GASKET	PLUG	
4.500	6	.313	1.720	3.413	5.250	2.568	H3	450755	450434	1711
5.000	4	.250	2.315	3.912	6.250	3.163	H3	450749	450434	1715
5.125	6	.313	2.315	3.912	6.000	3.163	H3	450748	450434	1723
5.125	6	.313	1.190	4.288	6.625	2.038	H3	450748	450434	1765
5.250	3	.375	2.315	3.912	6.250	3.163	H3	450777	450434	1727
5.250	6	.313	2.315	3.912	6.250	3.163	H3	450778	450434	1768
5.500	5	.313	1.742	4.525	6.313	2.683	H3	450775	450434	1742
5.500	6	.313	.995	4.540	6.625	1.227	H6	453644	453813	1790
5.500	6	.313	1.485	4.540	6.625	1.702	H6	450788	453813	1788
5.500	6	.313	1.742	4.525	6.313	2.683	H3	453795	450434	1743
5.500	6	.313	1.742	4.525	6.313	2.683	H3	453795	450434	1744 ¹
5.500	6	.313	1.835	4.525	6.173	2.683	H4	453795	450434	1753
5.562	6	.313	1.625	4.540	6.625	1.837	H6	450781	453813	1703
5.875	6	.313	1.835	4.525	7.000	2.683	H3	450741	450434	1702
5.875	6	.313	1.485	4.540	6.875	1.702	H6	453645	453813	1787
6.000	6	.375	2.250	4.970	6.938	3.098	H3	450752	450434	1798
6.625	6	.250	1.525	4.540	7.313	2.675	H3	450768	450434	1770
6.750	6	.297	2.086	5.290	7.710	3.312	H3	450799	450434	1799
6.750	6	.297	2.192	5.510	7.710	3.312	H4	450799	450434	1796
7.750	8	.375	2.000	5.625	8.750	2.848	H3	450760	450434	1754

¹ Black Design**LEXAN HUBCAP SPECIFICATIONS
LISTED BY SIZE**

			MAX. AXLE EXT.	HUBCAP SIZE				CR NUMBER		
BOLT CIRCLE	BOLT HOLES	HOLE SIZE	(A)	I.D. (B)	O.D. (C)	HEIGHT (D)	TYPE	REPLACEMENT		HUBCAP KIT
								GASKET	PLUG	
5.500	6	.313	2.438	4.750	6.250	3.000	HFV	450293	450434	1733
Threaded	6.250 x 8 OD		1.500	5.282	6.465	3.103	TMFV	454051	450434	1282
Threaded	6.250 x 8 OD		1.320	5.756	6.465	2.750	HDM2	454051	NR	1283 ¹
Threaded	6.250 x 8 OD		1.500	5.282	6.465	3.103	TMB	454051	NR	1284 ²

¹ Hubodometer version of 1282² Black Design

For installation procedures, reference page 27.

457 601 — WHEELS

SEALS/BEARINGS

CR HUBCAP INTERCHANGE REFERENCE CHART

CR TF/ZYTEL			STEMCO				SENTINEL		NATIONAL OIL	CR STEEL
OIL	GREASE	APPLICATION	OIL			OIL	GREASE			
1282 ²	1284 ²	Pro-Par Trailer	340-4075			348-4075	349-4075	HU-075A		
1600		Trailer/Hubo	347-4009							
1601		Trailer/Hubo	347-4013							
1608 ¹	1305 ¹	Steer	340-4065	343-4065				HU-065A		
1612 ¹	1311 ¹	Steer	340-4024	343-4024	350-4024	348-4024	349-4024	HU-024A	1711	
1613 ¹		Steer	340-4249	343-4249	350-4249			HU-149-A	1703	
1623		Trailer	340-4066	343-4066				HU-066A	1723	
1627		Trailer	340-4002	343-4002					1727	
1627		Steer	340-4019	343-4019				HU-019A		
1630 ¹	1331	Trailer	340-4014	343-4014						
1642	1342	Trailer	340-4013	343-4013		348-4013	349-4013	HU013A	1742	
1643	1343	Trailer	340-4009	343-4009		348-4009	349-4009	HU-009A	1743	
1643	1343	Trailer	340-4046	343-4046				HU-046A		
1644 ¹	1343	Trailer/Steer	340-4009	343-4009		348-4009	349-4009		1743	
1665		Trailer	340-4042	343-4042				HU-042A	1765	
1669 ¹		Steer	340-4025	343-4025	350-4025			HU-036A		
1670 ¹		Steer	340-4034	343-4034	350-4034			HU-034A	1770	
1681		Trailer	340-4029	343-4029				HU-028A		
1691 ¹		Steer	340-4098	343-4098					1790	
1696	1399	Trailer	340-4195	343-4195		348-4195	349-4195		1796	
1697		Trailer								
1698		Trailer	340-4059	343-4059					1798	
1698		Trailer	340-4080	343-4080						

¹ Black Design² Lexan

SPECIFICATIONS

SCOTSEAL

HUB
CAP

GASKET

INSTALLATION
TOOL GUIDEBEARING
SPACER

SEALS/BEARINGS**457 601 — WHEELS****HUBCAP GASKET SPECIFICATIONS
NUMERICAL LIST**

GASKET	I.D.	O.D.	BOLT CIRCLE	NO. OF HOLES	HOLE SIZE	USED WITH
450293	4.500	6.250	5.500	6	.328	1733
450741	4.500	6.625	5.875	6	.328	1702, 1769, 1787
450748	4.500	5.875	5.125	6	.328	1723, 1765
450749	4.500	6.125	5.000	4	.265	1715, 1781
450752	5.000	6.875	6.000	6	.390	1798, 1898
450755	3.750	5.125	4.500	6	.328	1711, 1811
450760	6.000	8.625	7.750	8	.390	1754
450762	6.000	8.625	6.875	7	.452	1720
450768	5.000	7.313	6.625	6	.265	1770
450772	5.000	7.500	6.500	3	.390	1705
450775	4.500	6.125	5.500	5	.328	1742
450777	4.500	6.125	5.250	3	.390	1727
450778	4.500	6.125	5.250	6	.328	1768
450781	4.500	6.625	5.563	6	.328	1703, 1803
450782	4.500	6.250	5.500	12	.328	*
450788	4.500	6.625	5.500	6	.328	1788, 1790, 1890
450799	5.510	7.625	6.750	6	.349	1396, 1399, 1696, 1697, 1796, 1799
453795	4.500	6.125	5.500 - 5.562	6	.349	1300, 1331, 1343, 1600, 1613, 1630, 1643, 1644, 1690, 1691, 1743, 1744, 1753
453818	4.500	6.125	5.500	5	.349	1362, 1601, 1642
453825	5.550	7.312	6.625	6	.286	1670
453868	2.500	4.250	3.625	4	.349	1305, 1608
453869	3.500	5.125	4.500	6	.349	1311, 1612
453906	5.125	6.625	6.000	6	.416	1698
453909	4.250	5.812	5.125 - 5.250	6	.349	1623, 1665
453912	4.250	5.875	5.250	3	.416	1627
453915	4.250	5.500	5.000	4	.349	1681
453918	4.321	6.500	5.875	6	.349	1669

* Universal Gasket

S
P
E
C
I
F
I
C
A
T
I
O
N
SS
C
O
T
S
E
A
LH
U
B
C
A
PG
A
S
K
E
TI
N
S
T
A
L
L
A
T
I
O
N
T
O
O
L
G
U
I
D
EB
E
A
R
I
N
G
S
P
A
C
E
R

457 601 — WHEELS

SEALS/BEARINGS

HUBCAP GASKET SPECIFICATIONS

LISTED BY BOLT CIRCLE

HOW TO DETERMINE GASKET REQUIRED

Count the number of mounting holes; measure diameter of bolts; measure bolt circle (select 2 holes opposite each other and measure from the center of one bolt hole to the center of the one opposite.)

BOLT CIRCLE	HOLE SIZE	NO. OF HOLES	I.D.	O.D.	USED WITH	GASKET
3.625	.349	4	2.500	4.250	1305, 1608	453868
4.500	.328	6	3.750	5.125	1711	450755
4.500	.349	6	3.500	5.125	1311, 1612	453869
5.000	.349	4	4.250	5.500	1681	453915
5.000	.265	4	4.500	6.125	1715	450749
5.125 - 5.250	.349	6	4.250	5.812	1623, 1665	453909
5.125	.328	6	4.500	5.875	1723, 1765	450748
5.250	.416	3	4.250	5.875	1627	453912
5.250	.328	6	4.500	6.125	1768	450778
5.250	.390	3	4.500	6.125	1727	450777
5.500 - 5.562	.349	6	4.500	6.125	1300, 1331, 1343, 1600, 1613, 1630, 1643, 1644, 1690, 1691, 1743, 1744, 1753	453795
5.500	.328	5	4.500	6.125	1742	450775
5.500	.349	5	4.500	6.125	1362, 1601, 1642	453818
5.500	.328	6	4.500	6.250	1733	450293
5.500	.328	12	4.500	6.250	*	450782
5.500	.328	6	4.500	6.625	1788, 1790	450788
5.563	.328	6	4.500	6.625	1703	450781
5.875	.349	6	4.321	6.500	1669	453918
5.875	.328	6	4.500	6.625	1702, 1769, 1787	450741
6.000	.390	6	5.000	6.875	1798	450752
6.000	.416	6	5.125	6.625	1698	453906
6.500	.390	3	5.000	7.500	1705	450772
6.625	.265	6	5.000	7.313	1770	450768
6.625	.286	6	5.500	7.312	1670	453825
6.750	.349	6	5.510	7.625	1396, 1399, 1696, 1697, 1796, 1799	450799
7.750	.390	8	6.000	8.625	1754	450760

*Universal Gasket

S
P
E
C
I
F
I
C
A
T
I
O
N
SS
C
O
T
S
E
A
LH
U
B
C
A
PG
A
S
K
E
TI
N
S
T
A
L
L
A
T
I
O
N
T
O
O
L
G
U
I
D
EB
E
A
R
I
N
G
S
P
A
C
E
R

SEALS/BEARINGS

457 601 — WHEELS

SPECIFICATIONS

DRIVE AXLE FLANGE GASKETS NUMERICAL LIST

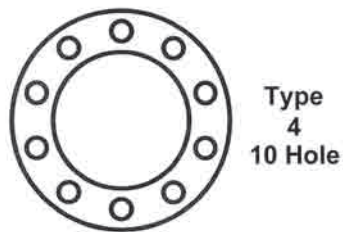
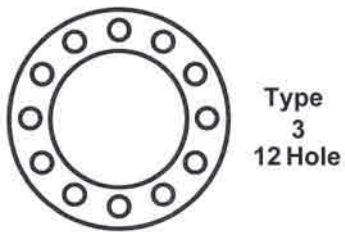
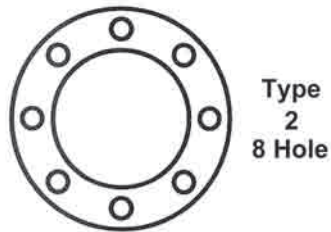
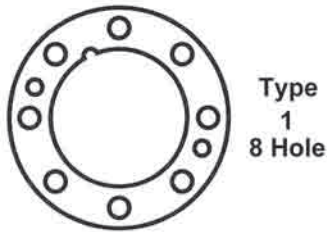

SCOTSEAL

HUB
CAP

GASKET

INSTALLATION
TOOL GUIDE

BEARING
SPACER

CR NO.	TYPE	I.D.	O.D.	BOLT CIRCLE	HOLE SIZE	NO. OF HOLES
450802	4	5.875	8.500	7.250	.609	10
450874	2	5.500	8.625	7.000	.813	8
450875	3	5.688	7.438	6.500	.500	12
450876	2	6.000	8.250	7.000	.625	8
450877	1	5.625	8.500	7.000	.750	8
450878	2	4.000	5.563	4.750	.438	8
450879	2	4.500	6.125	5.313	.500	8
450980	2	5.375	7.375	6.375	.563	8
450981	2	5.750	8.375	7.000	.625	8
450982	2	4.000	6.438	5.500	.625	8
450983	3	4.500	6.063	5.250	.500	12

457 601 — WHEELS

SEALS/BEARINGS

**CR SCOTSEAL CLASSIC & SCOTSEAL LONGLIFE
INSTALLATION TOOL GUIDE**

SCOTSEAL NO.	INNER BEARING CONE NO.	CENTERING TOOL	DRIVE TOOL	SCOTSEAL NO.	INNER BEARING CONE NO.	CENTERING TOOL	DRIVE TOOL	
27438	3778	730	463	35103	557A	703	436 (354*)	
	33891	700	463		39581	702	436	
	33895	701	463		HM212044	703	436 (354*)	
28758	25877	722	463	HM212047	704	436 (351*)		
	JM205149A	722	463	HM212049	706	436 (352*)		
	JM207049A	723	463	35820			427	
28820	28995	703	463	36274	5557	721	427	
	45284	700	463	36285	HM212047	704	427 (351*)	
28832	45284	700	463		HM212049	706	427 (352*)	
	31175	45284	700		428	HM212049X	706	427
31182	45284	700	428	36358	3982	704	427	
31244	539	701	428		HM212047	704	427 (351*)	
		4595	701	428	36365	555S	702	427
31264	539	701	428	559		704	427 (353*)	
31266	39578	701	428	560		706	427	
	39585	704	428	3982		704	427 (353*)	
31281	JM511946	724	428	HM212047	704	427		
31307	582	710	428	38709	42688	708	448	
	3984	706	428	38736			448	
32470	539	701	428	38747	47686	710	462	
	3984	706	428		6386	706	462	
	39581	702	428		47678	708	462 (381*)	
34387	33281	716	427	38750	495AX	708	462	
	33287	707	427		566	710	462	
34975	39581	702	436		33287	707	462	
	45284	700	436		47686	710	462	
					47687	710	462	
35000	33281	716	436	38780	495AX	708	462 (390*)	
	33287	707	436		566	710	462	
35060	HM212046	704	436		582	710	462	
35066	557A	703	436 (354*)		598	714	462	
	39581	702	436		594A	714	462	
	HM212044	703	436 (354*)		598A	714	462	
	HM212047	704	436 (351*)		5760	708	462 (390*)	
	HM212049	706	436 (352*)		47678	708	462 (390*)	
35072	557A	703	436		47686	710	462 (357*)	
	39581	702	436		38783	495AX	708	462 (390*)
	HM212044	703	436			566	710	462
	HM212047	704	436	582		710	462	
	HM212049	706	436	594A		714	462	
	HM212049X	706	436	598		714	462	
			598A	714		462		
35075	557A	703	436	5760		708	462 (390*)	
	567	707	436	47678		708	462 (390*)	
	39250	704	436	47686		710	462 (357*)	
	HM212044	703	436					

SPECIFICATIONS
 SCOTSEAL
 HUB CAP
 GASKET
 INSTALLATION TOOL GUIDE
 BEARING SPACER

ALL INSTALLATION TOOLS REQUIRE HANDLE ASSEMBLY 450237
 (1) 629 Spacer Not Required.
 * Production Installation Tool Equivalent

SEALS/BEARINGS

457 601 — WHEELS

CR SCOTSEAL CLASSIC & SCOTSEAL LONGLIFE INSTALLATION TOOL GUIDE—(Continued)

SPECIFICATIONS

SCOTSEAL

HUB
CAP

GASKET

INSTALLATION
TOOL GUIDE

BEARING
SPACER

SCOTSEAL NO.	INNER BEARING CONE NO.	CENTERING TOOL	DRIVE TOOL	SCOTSEAL NO.	INNER BEARING CONE NO.	CENTERING TOOL	DRIVE TOOL	
39380	495AX	708	445 (380*)	42631	593	712	452 (387*)	
	497	711	445		749	719	452	
	568	713	445		HM518445	712	452 (387*)	
	39420	663A	710	445	42672	663	710	445 (364*)
		6386	706	445		665	710	445
		6389	706	445	HM516449	710	445 (364*)	
		33287	707	445	HM516449A	710	445	
HM215249		707	445	42800	495AX	708	445	
39425	495AX	708	445		582	710	445 (360*)	
	33287	707	445		598A	714	445	
	47686	710	445		659	708	445	
39988	639	704	448		663A	710	445	
	641	706	448	43752	663	710	465	
	42688	708	448		665A	711	465 (356*)	
	HM212049	706	448	JM718149	713	465		
40040	6386A	706	457	43764	749	719	465	
	40086	6379	705		441 (385*)	6461A	708	465 (359*)
		6386	706	441	43800	5760	708	465
6389	706	441	6461	708		465		
40136	575	708	457	43860	594A	715	446	
	580	710	457 (357*)		595	710	446	
	663	710	457 (357*)		598	714	446 (361*)	
	33281	716	457		598A	714	446 (361*)	
	665A	711	457		663	710	446	
40139	575	708	457	749	719	446		
	580	710	457 (384*)	43865	598	714	446 (361*)	
	663	710	457 (384*)	43875	594	715	446	
	665A	711	457		598	714	446	
	33281	716	457		598A	714	446	
40147	575	708	457	44922	641	706	484 (388*)	
	580	710	457 (357*)		HM212049	706	484	
	663	710	457 (357*)	H715345	716	484 (383*)		
	665A	711	457	44964	663	710	484 (382*)	
	33281	711	457		665	711	484	
42550	495AX	708	445		749	719	452	
	33287	707	445	749A	710	484 (382*)		
	47686	710	445	6559	710	484 (382*)		
42623	593	712	452 (387*)	45010	6559	710	484 (382*)	
	749	719	452	45099	580	710	484 (357*)	
	HM518445	712	245 (387*)		582	710	484	
42624	593	712	452 (387*)	45100	663	710	484	
	749	719	452		665A	711	484	
	HM518445	712	245 (387*)	JM718149	713	484		
42625	593	450737		45103	641	706	484 (389*)	
	HM518445	450737			H715345	716	484 (358*)	

ALL INSTALLATION TOOLS REQUIRE HANDLE ASSEMBLY 450237
(1) 629 Spacer Not Required.
* Production Installation Tool Equivalent

457 601—WHEELS

SEALS/BEARINGS

**CR SCOTSEAL CLASSIC & SCOTSEAL LONGLIFE
INSTALLATION TOOL GUIDE—(Continued)**

SCOTSEAL NO.	INNER BEARING		DRIVE TOOL	SCOTSEAL NO.	INNER BEARING		DRIVE TOOL	
	CONE NO.	CENTERING TOOL			CONE NO.	CENTERING TOOL		
45152	594	715	461 (362*)	48000	594A	715	435 (362*)	
45160	594	715	461 (362*)	48297	598A	714	435 (361*)	
	594A	715	461 (362*)		594	715	446	
	595	710	461		594A	715	446	
	598	715	461	598A	714	446		
	598A	714	461	48298	758	711	446	
	663	710	461		759	712	446	
	759	712	461		760	717	446	
760	717	461	52401		718	446		
45162	759	712	461	48690	595	710	446	
	HM218248	713	461		687	718	446	
45163			461		6580	712	446 (391*)	
46305	52400	718	451	48792	598	714	446 (361*)	
	HM218248	713	451 (386*)	48794	756A	709	446 (363*)	
	JM719149	733	451	48796	756A	709	446 (363*)	
46308	52400	718	451	48884	598A	714	446	
	HM218248	713	451 (386*)		758	711	446	
	JM719149	733	451		759	712	446	
46390	593	712	446		760	717	446 (365*)	
47483	594	715	446		50124	663	710	446
	594A	715	446	687		718	446	
47690	594A	715	435 (362*)	760		710	446	
	598A	714	435 (361*)	780		718	446	
	760	717	435	HM516449		710	446	
	47693	594	715	435 (362*)	50190	663	710	453 (1)
47693	594A	715	435 (362*)	780	718	453 (1)		
	598	714	435 (361*)	52658	687	718	474	
	598A	714	435 (362*)		780	718	474	
	681A	714	435	52660	687	718	453 (1)	
	760	710	435		780	718	453 (1)	
	6580	712	435	52664	687	718	453 (1)	
	47697	594	715		435 (362*)	780	718	453 (1)
	47697	594A	715	435 (362*)	47698	594A	715	435 (362*)
598		714	435 (361*)	598		714	435 (361*)	
598A		714	435 (361*)	598A		714	435 (361*)	
681A		714	435	681A		714	435	
760		710	435	760		710	435	
6580		712	435	6580		712	435	
47698	594A	715	435 (362*)	47699		681A	714	449
	598	714	435 (361*)			683	715	449
	598A	714	435 (361*)		683XA	715	449	
	681A	714	435					
	760	710	435					
6580	712	435						

ALL INSTALLATION TOOLS REQUIRE HANDLE ASSEMBLY 450237

(1) 629 Spacer Not Required.

* Production Installation Tool Equivalent

S
P
E
C
I
F
I
C
A
T
I
O
N
S

SCOTSEAL

HUB
CAP

GASKET

I
N
S
T
A
L
L
A
T
I
O
N
T
O
O
L
G
U
I
D
EB
E
A
R
I
N
G
S
P
A
C
E
R

SEALS/BEARINGS

457 601 — WHEELS

SPECIFICATIONS

BEARING SPACER SPECIFICATIONS

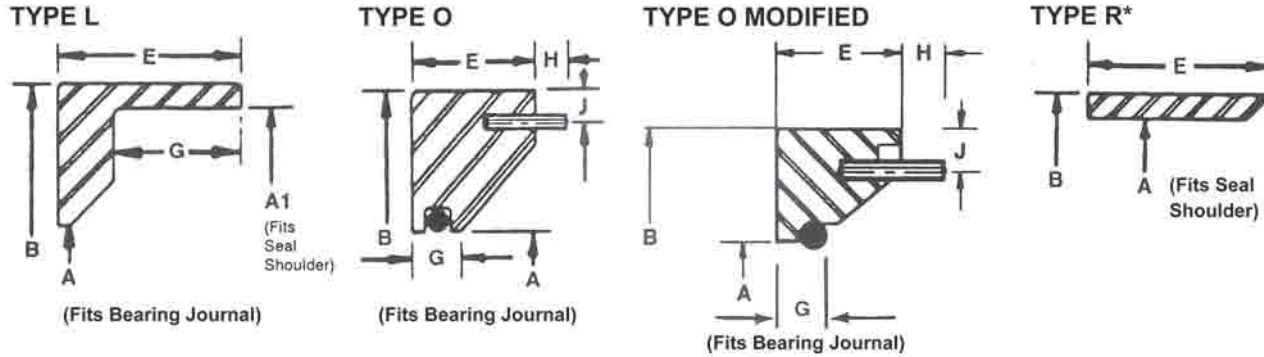

CR NO.	REPLACEMENT O-RING		INSIDE DIAM. (A)	OUTSIDE DIAM. (B)	OVERALL WIDTH (E)	WIDTH (G)	EXT. (H)	(J)	TYPE
	CR NO.	STD. ARP NO. (2)							
450208	717152	6230-16	3.502	4.635	.625	.313	.250	.192	O
455001	717153	6230-5	2.133	3.125	.688	.288	.156	.125	O
455004	717154	6230-8	2.502	3.500	.594	.282	.156	.313	O
455006	717155	6230-9	2.596	3.500	.563	.250	.156	.078	O
455009	717157	6230-12	3.002	4.250	.813	.500	.156	.078	O
455019	(3)		3.583 (A1) 4.557	4.875	.750	.594			L
455024*	(3)		3.836	4.250	.940				R*
455026	717153	6230-5	2.127	2.750	.485	.266	.250	.125	O
455031	717155	568-231	2.629	4.000	.750	.375	.250	.250	O(Mod.)
455050	(3)		3.260 (A1) 4.246	4.500	1.000	.750			L
455052*	(3)		2.497	3.125	.625				R*
455054	(3)		4.752 (A1) 5.226	5.500	.812	.662			L
456301	717155	568-231	2.629	4.000	.750	.237	.250	.250	O

SCOTSEAL

HUB CAP

GASKET

INSTALLATION TOOL GUIDE

BEARING SPACER

(3) No O-Ring Required
* Adhesive Recommended