

NPS Spherical Pre-Lubed Units

NPS Spherical Pre-Lubed Units

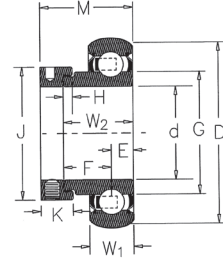

Parts are not Original Equipment parts and are not sponsored, affiliated or otherwise connected with any major brand.

Part	Description	[d BORE]	[D]	[W1]	[W2]	[G]	[J]	[M]
A-NPS008RPC	NPS Spherical Pre-Lubed Units	0.50	1.5748	0.75	0.5118	0.957	1.125	1.125
A-BC008	Collar (only) No.	0.50	1.5748	0.75	0.5118	0.957	1.125	1.125
A-NPS010RPC	NPS Spherical Pre-Lubed Units	0.625	1.5748	0.75	0.5118	0.957	1.125	1.125
A-BC010	Collar (only) No.	0.625	1.5748	0.75	0.5118	0.957	1.125	1.125
A-NPS012RPC	NPS Spherical Pre-Lubed Units	0.75	1.8504	0.8437	0.5906	1.134	1.3125	1.21875
A-BC012	Collar (only) No.	0.75	1.8504	0.5906	1.34375	1.134	1.3125	1.71875
A-NPS014RPS	NPS Spherical Pre-Lubed Units	0.875	2.0472	0.8437	0.5906	1.331	1.50	1.21875
A-BC014	Collar (only) No.	0.875	2.0472	0.5906	1.375	1.331	1.3125	1.75
A-NPS015RPC	NPS Spherical Pre-Lubed Units	0.9375	2.0472	0.8437	0.5906	1.331	1.5	11.21875
A-BC015	Collar (only) No.	0.9375	2.0472	0.5906	1.375	1.331	1.3125	1.75
A-NPS100RPC	NPS Spherical Pre-Lubed Units	1	2.0472	0.8437	0.5906	1.331	1.5	1.21875
A-RA100NPPB	NPS Spherical Pre-Lubed Units- Import	1	2.0472	0.8437	0.5906	1.331	1.5	1.21875
A-BC100	Collar (only) No.	1	2.0472	0.5906	1.375	1.331	1.3125	1.75
A-NPS101RPC	NPS Spherical Pre-Lubed Units	1.0625	2.4409	0.9375	0.7087	1.584	1.75	1.40625
A-BC101	Collar (only) No.	1.0625	2.4409	0.7087	1.4375	1.589	1.75	1.90625
A-NPS102RPC	NPS Spherical Pre-Lubed Units	1.125	2.4409	0.9375	0.7087	1.584	1.75	1.40625
A-BC102	Collar (only) No.	1.125	2.4409	0.7087	1.4375	1.589	1.75	1.90625
A-NPS103RPC	NPS Spherical Pre-Lubed Units	1.1875	2.4409	0.9375	0.7087	1.584	1.75	1.40625
A-BC103	Collar (only) No.	1.1875	2.4409	0.7087	1.4375	1.589	1.75	1.90625
A-NPS103RP2C	NPS Spherical Pre-Lubed Units	1.25	2.4409	0.9375	0.7087	1.584	1.75	1.40625
A-GRA103RRB2	NPS Spherical Pre-Lubed Units- Import	1.25	2.4409	0.9375	0.7087	1.584	1.75	1.40625
A-BC1032	Collar (only) No.	1.25	2.4409	0.7087	1.4375	1.589	1.75	1.90625
A-NPS104RPC	NPS Spherical Pre-Lubed Units	1.25	2.8346	1	0.748	1.894	2.125	1.53125
A-BC104	Collar (only) No.	1.25	2.8346	0.748	1.484375	1.847	2.125	2.015625
A-NPS105RPC	NPS Spherical Pre-Lubed Units	1.3125	2.8346	1	0.748	1.894	2.125	1.53125
A-BC105	Collar (only) No.	1.3125	2.8346	0.748	1.484375	1.847	2.125	2.015625
A-NPS106RPC	NPS Spherical Pre-Lubed Units	1.375	2.8346	1	0.748	1.894	2.125	1.53125
A-BC106	Collar (only) No.	1.375	2.8346	0.748	1.484375	1.847	2.125	2.015625
A-NPS107RPC	NPS Spherical Pre-Lubed Units	1.4375	2.8346	1	0.748	1.894	2.125	1.53125
A-BC107	Collar (only) No.	1.4375	2.8346	0.748	1.484375	1.847	2.125	2.015625
A-NPS108RPC	NPS Spherical Pre-Lubed Units	1.50	3.1496	1.1875	0.8661	2.084	2.375	1.71875
A-BC108	Collar (only) No.	1.50	3.1496	0.8661	1.6875	2.084	2.375	2.21875
A-NPS109RPC	NPS Spherical Pre-Lubed Units	1.5625	3.1496	1.1875	0.8661	2.084	2.375	1.71875
A-BC109	Collar (only) No.	1.5625	3.1496	0.8661	1.6875	2.084	2.375	2.21875
A-BC110	Collar (only) No.	1.625	3.3465	0.8661	1.6875	2.28	2.5	0.84375
A-BC111	Collar (only) No.	1.6875	3.3465	0.8661	1.6875	2.28	2.5	2.21875
A-NPS112RPC	NPS Spherical Pre-Lubed Units	1.75	3.3465	1.1875	0.8661	-	2.5	1.71875
A-BC112	Collar (only) No.	1.75	3.3465	0.8661	1.6875	2.28	2.50	2.21875
A-BC113	Collar (only) No.	1.8125	3.5433	0.8661	1.9375	2.413	2.75	2.46875
A-BC114	Collar (only) No.	1.875	3.5433	0.8661	1.9375	2.413	2.75	2.46875
A-NPS115RPC	NPS Spherical Pre-Lubed Units	1.3125	3.5433	1.1875	0.8661	-	2.75	1.71875
A-BC115	Collar (only) No.	1.9375	3.5433	0.8661	1.9375	2.413	2.75	2.46875
A-NPS115RP2C	NPS Spherical Pre-Lubed Units	2	3.5433	1.1875	0.8661	-	2.75	1.71875
A-BC1152	Collar (only) No.	2	3.5433	0.7874	1.9375	2.473	2.75	2.46875

NPS Spherical Re-Lubable Units

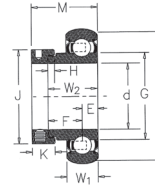

Part	Description	[d BORE]	[D]	[W1]	[W2]	[G]	[J]	[M]
A-NPS008RRC	NPS Spherical Re-Lubable Units	0.50	1.5748	0.75	0.5118	0.957	1.125	1.125
A-BC008	Collar (only) No.	0.50	1.5748	0.75	0.5118	0.957	1.125	1.125
A-NPS010RRC	NPS Spherical Re-Lubable Units	0.625	1.5748	0.75	0.5118	0.957	1.125	1.125
A-BC010	Collar (only) No.	0.625	1.5748	0.75	0.5118	0.957	1.125	1.125
A-NPS012RRC	NPS Spherical Re-Lubable Units	0.75	1.8504	0.8437	0.5906	1.134	1.3125	1.21875
A-BC012	Collar (only) No.	0.75	1.8504	0.5906	1.34375	1.134	1.3125	1.71875
A-NPS013RRS	NPS Spherical Re-Lubable Units	0.8125	2.0472	0.8437	0.5906	1.331	1.5	1.21875
A-BC013	Collar (only) No.	0.8125	2.0472	0.5906	1.375	1.331	1.3125	1.75
A-NPS014RRS	NPS Spherical Re-Lubable Units	0.875	2.0472	0.8437	0.5906	1.331	1.50	1.21875
A-BC014	Collar (only) No.	0.875	2.0472	0.5906	1.375	1.331	1.3125	1.75
A-NPS015RRC	NPS Spherical Re-Lubable Units	0.9375	2.0472	0.8437	0.5906	1.331	1.5	1.21875
A-BC015	Collar (only) No.	0.9375	2.0472	0.5906	1.375	1.331	1.3125	1.75
A-NPS100RRC	NPS Spherical Re-Lubable Units	1	2.0472	0.8437	0.5906	1.331	1.5	1.21875
A-BC100	Collar (only) No.	1	2.0472	0.5906	1.375	1.331	1.3125	1.75
A-BC101	Collar (only) No.	1.0625	2.4409	0.7087	1.4375	1.589	1.75	1.90625
A-NPS102RRC	NPS Spherical Re-Lubable Units	1.125	2.4409	0.9375	0.7087	1.584	1.75	1.40625
A-BC102	Collar (only) No.	1.125	2.4409	0.7087	1.4375	1.589	1.75	1.90625
A-NPS103RRC	NPS Spherical Re-Lubable Units	1.1875	2.4409	0.9375	0.7087	1.584	1.75	1.40625
A-BC103	Collar (only) No.	1.1875	2.4409	0.7087	1.4375	1.589	1.75	1.90625
A-NPS103RR2C	NPS Spherical Re-Lubable Units	1.25	2.4409	0.9375	0.7087	1.584	1.75	1.40625
A-BC1032	Collar (only) No.	1.25	2.4409	0.7087	1.4375	1.589	1.75	1.90625
A-NPS104RRC	NPS Spherical Re-Lubable Units	1.25	2.8346	1	0.748	1.894	2.125	1.53125
A-BC104	Collar (only) No.	1.25	2.8346	0.748	1.484375	1.847	2.125	2.015625
A-NPS105RRC	NPS Spherical Re-Lubable Units	1.3125	2.8346	1	0.748	1.894	2.125	1.53125
A-BC105	Collar (only) No.	1.3125	2.8346	0.748	1.484375	1.847	2.125	2.015625
A-NPS106RRC	NPS Spherical Re-Lubable Units	1.375	2.8346	1	0.748	1.894	2.125	1.53125
A-BC106	Collar (only) No.	1.375	2.8346	0.748	1.484375	1.847	2.125	2.015625
A-NPS107RRC	NPS Spherical Re-Lubable Units	1.4375	2.8346	1	0.748	1.894	2.125	1.21875
A-BC107	Collar (only) No.	1.4375	2.8346	0.748	1.484375	1.847	2.125	2.015625
A-NPS108RRC	NPS Spherical Re-Lubable Units	1.50	3.1496	1.1875	0.8661	2.064	2.375	1.71875
A-BC108	Collar (only) No.	1.50	3.1496	0.8661	1.6875	2.084	2.375	2.21875
A-NPS109RRC	NPS Spherical Re-Lubable Units	1.5625	3.1496	1.1875	0.8661	2.064	2.375	1.71875
A-BC109	Collar (only) No.	1.5625	3.1496	0.8661	1.6875	2.084	2.375	2.21875
A-NPS110RRC	NPS Spherical Re-Lubable Units	1.625	3.3465	1.1875	0.8661	-	2.5	1.71875
A-BC110	Collar (only) No.	1.625	3.3465	0.8661	1.6875	2.28	2.5	0.84375
A-NPS111RRC	NPS Spherical Re-Lubable Units	1.6875	3.3465	1.1875	0.8661	-	2.5	1.71875
A-BC111	Collar (only) No.	1.6875	3.3465	0.8661	1.6875	2.28	2.5	2.21875
A-NPS112RRC	NPS Spherical Re-Lubable Units	1.75	3.3465	1.1875	0.8661	-	2.50	1.71875
A-BC112	Collar (only) No.	1.75	3.3465	0.8661	1.6875	2.28	2.50	2.21875
A-BC113	Collar (only) No.	1.8125	3.5433	0.8661	1.9375	2.413	2.75	2.46875
A-NPS114RRC	NPS Spherical Re-Lubable Units	1.875	3.5433	1.1875	0.8661	-	2.75	1.71875
A-BC114	Collar (only) No.	1.875	3.5433	0.8661	1.9375	2.413	2.75	2.46875
A-NPS115RRC	NPS Spherical Re-Lubable Units	1.9375	3.5433	1.1875	0.8661	-	2.75	1.71875
A-BC115	Collar (only) No.	1.9375	3.5433	0.8661	1.9375	2.413	2.75	2.46875
A-NPS115RR2C	NPS Spherical Re-Lubable Units	2	3.5433	1.1875	0.8661	-	2.75	1.71875
A-BC1152	Collar (only) No.	2	3.5433	0.7874	1.9375	2.473	2.75	2.46875

Parts are not Original Equipment parts and are not sponsored, affiliated or otherwise connected with any major brand.

BEARINGS

NPC Cylindrical Pre-Lubed Units

NPC Cylindrical Pre-Lubed Units

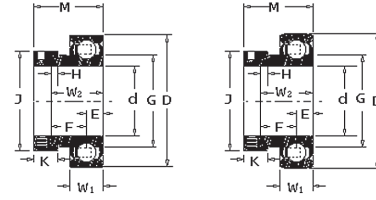

Part	Description	[d BORE]	[D]	[W1]	[W2]	[G]	[J]	[M]
A-NPC008RPC	NPC Cylindrical Pre-Lubed Units	0.50	1.5748	0.75	0.5118	0.957	1.125	1.125
A-BC008	Collar (only) No.	0.50	1.5748	0.75	0.5118	0.957	1.125	1.125
A-NPC010RPC	NPC Cylindrical Pre-Lubed Units	0.625	1.5748	0.75	0.5118	0.957	1.125	1.125
A-BC010	Collar (only) No.	0.625	1.5748	0.75	0.5118	0.957	1.125	1.125
A-NPC012RPC	NPC Cylindrical Pre-Lubed Units	0.75	1.8504	0.8437	0.5906	1.134	1.3125	1.21875
A-BC012	Collar (only) No.	0.75	1.8504	0.5906	1.34375	1.134	1.3125	1.71875
A-BC013	Collar (only) No.	0.8125	2.0472	0.5906	1.375	1.331	1.3125	1.75
A-NPC014RPC	NPC Cylindrical Pre-Lubed Units	0.875	2.0472	0.8437	0.5906	1.331	1.5	1.21875
A-BC014	Collar (only) No.	0.875	2.0472	0.5906	1.375	1.331	1.3125	1.75
A-NPC015RPC	NPC Cylindrical Pre-Lubed Units	0.9375	2.0472	0.8437	0.5906	1.331	1.5	1.21875
A-BC015	Collar (only) No.	0.9375	2.0472	0.5906	1.375	1.331	1.3125	1.75
A-NPC100RPC	NPC Cylindrical Pre-Lubed Units	1	2.0472	0.8437	0.5906	1.331	1.50	1.21875
A-BC100	Collar (only) No.	1	2.0472	0.5906	1.375	1.331	1.3125	1.75
A-NPC101RPC	NPC Cylindrical Pre-Lubed Units	1.0625	2.4409	0.9375	0.7087	1.584	1.75	1.40625
A-BC101	Collar (only) No.	1.0625	2.4409	0.7087	1.4375	1.589	1.75	1.90625
A-NPC102RPC	NPC Cylindrical Pre-Lubed Units	1.125	2.4409	0.9375	0.7087	1.584	1.75	1.40625
A-BC102	Collar (only) No.	1.125	2.4409	0.7087	1.4375	1.589	1.75	1.90625
A-NPC103RPC	NPC Cylindrical Pre-Lubed Units	1.1875	2.4409	0.9375	0.7087	1.584	1.75	1.40625
A-BC103	Collar (only) No.	1.1875	2.4409	0.7087	1.4375	1.589	1.75	1.90625
A-NPC103RP2C	NPC Cylindrical Pre-Lubed Units	1.25	2.4409	0.9375	0.7087	1.584	1.75	1.40625
A-BC1032	Collar (only) No.	1.25	2.4409	0.7087	1.4375	1.589	1.75	1.90625
A-NPC104RPC	NPC Cylindrical Pre-Lubed Units	1.25	2.8346	1	0.748	1.894	2.125	1.53125
A-BC104	Collar (only) No.	1.25	2.8346	0.748	1.484375	1.847	2.125	2.015625
A-NPC105RPC	NPC Cylindrical Pre-Lubed Units	1.3125	2.8346	1	0.748	1.894	2.125	1.53125
A-BC105	Collar (only) No.	1.3125	2.8346	0.748	1.484375	1.847	2.125	2.015625
A-NPC106RPC	NPC Cylindrical Pre-Lubed Units	1.375	2.8346	1	0.748	1.894	2.125	1.53125
A-BC106	Collar (only) No.	1.375	2.8346	0.748	1.484375	1.847	2.125	2.015625
A-NPC107RPC	NPC Cylindrical Pre-Lubed Units	1.4375	2.8346	1	0.748	1.894	2.125	1.53125
A-BC107	Collar (only) No.	1.4375	2.8346	0.748	1.484375	1.847	2.125	2.015625
A-NPC108RPC	NPC Cylindrical Pre-Lubed Units	1.50	3.1496	1.1875	0.8661	2.084	2.375	1.71875
A-BC108	Collar (only) No.	1.50	3.1496	0.8661	1.6875	2.084	2.375	2.21875
A-NPC109RPC	NPC Cylindrical Pre-Lubed Units	1.5625	3.1496	1.1875	0.8661	2.084	2.375	1.71875
A-BC109	Collar (only) No.	1.5625	3.1496	0.8661	1.6875	2.084	2.375	2.21875
A-NPC110RPC	NPC Cylindrical Pre-Lubed Units	1.625	3.3465	1.1875	0.8661	-	2.5	1.71875
A-BC110	Collar (only) No.	1.625	3.3465	0.8661	1.6875	2.28	2.5	0.84375
A-NPC111RPC	NPC Cylindrical Pre-Lubed Units	1.6875	3.3465	1.1875	0.8661	-	2.50	1.71875
A-BC111	Collar (only) No.	1.6875	3.3465	0.8661	1.6875	2.28	2.5	2.21875
A-NPC112RPC	NPC Cylindrical Pre-Lubed Units	1.75	3.3465	1.1875	0.8661	-	2.50	1.71875
A-BC112	Collar (only) No.	1.75	3.3465	0.8661	1.6875	2.28	2.50	2.21875
A-NPC113RPC	NPC Cylindrical Pre-Lubed Units	1.8125	3.5433	1.1875	0.8661	-	2.75	1.71875
A-BC113	Collar (only) No.	1.8125	3.5433	0.8661	1.9375	2.413	2.75	2.46875
A-NPC114RPC	NPC Cylindrical Pre-Lubed Units	1.875	3.5433	1.1875	0.8661	-	2.75	1.71875
A-BC114	Collar (only) No.	1.875	3.5433	0.8661	1.9375	2.413	2.75	2.46875
A-BC115	Collar (only) No.	1.9375	3.5433	0.8661	1.9375	2.413	2.75	2.46875
A-NPC115RP2C	NPC Cylindrical Pre-Lubed Units	2	3.5433	1.1875	0.8661	-	2.75	1.71875
A-BC1152	Collar (only) No.	2	3.5433	0.7874	1.9375	2.473	2.75	2.46875

Parts are not Original Equipment parts and are not sponsored, affiliated or otherwise connected with any major brand.

WPS Sph Pre-Lubed, Wide Inner Ring (single lip seal)



WPS Sph Pre-Lubed, Wide Inner Ring (single lip seal)

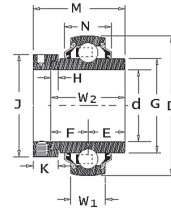

Parts are not Original Equipment parts and are not sponsored, affiliated or otherwise connected with any major brand.

BEARINGS

Part	Description	[d BORE]	[D]	[W1]	[W2]	[G]	[J]	[M]	[N]
A-WPS012GPC	WPS Type Wide Inner Ring	0.75	1.8504	1.34375	0.5512	1.134	1.833	1.71875	0.76
A-BC012	Collar (only) No.	0.75	1.8504	0.5906	1.34375	1.134	1.3125	1.71875	0.76
A-WPS013GPC	WPS Type Wide Inner Ring	0.8125	2.0472	1.375	0.5906	1.331	1.50	1.75	0.787
A-BC013	Collar (only) No.	0.8125	2.0472	0.5906	1.375	1.331	1.3125	1.75	0.787
A-WPS014GPC	WPS Type Wide Inner Ring	0.875	2.0472	1.375	0.5906	1.331	1.50	1.75	0.787
A-BC014	Collar (only) No.	0.875	2.0472	0.5906	1.375	1.331	1.3125	1.75	0.787
A-WPS015GPC	WPS Type Wide Inner Ring	0.9375	2.0472	1.375	0.5906	1.331	1.50	1.75	0.787
A-BC015	Collar (only) No.	0.9375	2.0472	0.5906	1.375	1.331	1.3125	1.75	0.787
A-WPS100GPC	WPS Type Wide Inner Ring	1	2.0472	1.375	0.5906	1.331	1.5	1.75	0.787
A-BC100	Collar (only) No.	1	2.0472	0.5906	1.375	1.331	1.3125	1.75	0.787
A-WPS101GPC	WPS Type Wide Inner Ring	1.0625	2.4409	1.4375	0.6299	1.589	1.75	1.90625	0.876
A-BC101	Collar (only) No.	1.0625	2.4409	0.7087	1.4375	1.589	1.75	1.90625	0.876
A-WPS102GPC	WPS Type Wide Inner Ring	1.125	2.4409	1.4375	0.6299	1.589	1.75	1.90625	0.876
A-BC102	Collar (only) No.	1.125	2.4409	0.7087	1.4375	1.589	1.75	1.90625	0.876
A-WPS103GPC	WPS Type Wide Inner Ring	1.1875	2.4409	1.4375	0.6299	1.589	1.75	1.90625	0.876
A-BC103	Collar (only) No.	1.1875	2.4409	0.7087	1.4375	1.589	1.75	1.90625	0.876
A-WPS103GP2C	WPS Type Wide Inner Ring	1.25	2.4409	0.6299	1.4375	1.589	1.75	1.90625	0.876
A-1103KRRB3	WPS Type Wide Inner Ring- Import	1.25	2.4409	1.4375	0.6299	1.589	1.75	1.90625	0.876
A-BC1032	Collar (only) No.	1.25	2.4409	0.7087	1.4375	1.589	1.75	1.90625	0.876
A-WPS104GPC	WPS Type Wide Inner Ring	1.25	2.8346	0.6693	1.484375	1.847	2.125	2.015625	0.912
A-BC104	Collar (only) No.	1.25	2.8346	0.748	1.484375	1.847	2.125	2.015625	0.912
A-WPS105GPC	WPS Type Wide Inner Ring	1.3125	2.8346	0.6693	1.484375	1.847	2.125	2.015625	0.912
A-BC105	Collar (only) No.	1.3125	2.8346	0.748	1.484375	1.847	2.125	2.015625	0.912
A-WPS106GPC	WPS Type Wide Inner Ring	1.375	2.8346	0.6693	1.484375	1.847	2.125	2.015625	0.912
A-BC106	Collar (only) No.	1.375	2.8346	0.748	1.484375	1.847	2.125	2.015625	0.912
A-BC107	Collar (only) No.	1.4375	2.8346	0.748	1.484375	1.847	2.125	2.015625	0.912
A-BC109	Collar (only) No.	1.5625	3.1496	0.8661	1.6875	2.084	2.375	2.21875	1.17
A-WPS110GPC	WPS Type Wide Inner Ring	1.625	3.3465	0.748	1.6875	2.28	2.5	2.21875	1.1
A-BC110	Collar (only) No.	1.625	3.3465	0.8661	1.6875	2.28	2.5	0.84375	1.1
A-WPS111GPC	WPS Type Wide Inner Ring	1.6875	3.3465	0.748	1.6875	2.28	2.5	2.21875	1.1
A-BC111	Collar (only) No.	1.6875	3.3465	0.8661	1.6875	2.28	2.5	2.21875	1.1
A-WPS112GPC	WPS Type Wide Inner Ring	1.75	3.3465	0.748	1.6875	2.28	2.5	2.21875	1.1
A-BC112	Collar (only) No.	1.75	3.3465	0.8661	1.6875	2.28	2.50	2.21875	1.1
A-WPS113GPC	WPS Type Wide Inner Ring	1.8125	3.5433	0.7874	1.9375	2.473	2.75	2.46875	1.119
A-BC113	Collar (only) No.	1.8125	3.5433	0.8661	1.9375	2.413	2.75	2.46875	1.119
A-WPS114GPC	WPS Type Wide Inner Ring	1.875	3.5433	0.7874	1.9375	2.473	2.75	2.46875	1.119
A-BC114	Collar (only) No.	1.875	3.5433	0.8661	1.9375	2.413	2.75	2.46875	1.119
A-WPS115GPC	WPS Type Wide Inner Ring	1.9375	3.5433	0.7874	1.9375	2.473	2.75	2.46875	1.119
A-BC115	Collar (only) No.	1.9375	3.5433	0.8661	1.9375	2.413	2.75	2.46875	1.119
A-WPS115GP2C	WPS Type Wide Inner Ring	2	3.5433	0.7874	1.9375	2.473	2.75	2.46875	1.119
A-BC1152	Collar (only) No.	2	3.5433	0.7874	1.9375	2.473	2.75	2.46875	1.119

WPS Sph Re-Lubable, Wide Inner Ring (single lip seal)

WPS Sph Re-Lubable, Wide Inner Ring (single lip seal)

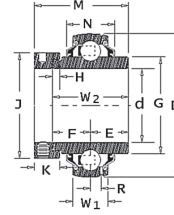

Parts are not Original Equipment parts and are not sponsored, affiliated or otherwise connected with any major brand.

Part	Description	[d BORE]	[D]	[W1]	[W2]	[G]	[J]	[M]	[N]
A-WPS012GRC	WPS Type Wide Inner Ring	0.75	1.8504	0.5906	1.34375	1.134	1.3125	1.71875	0.76
A-G1012KRRB	WPS Type Wide Inner Ring- Import	-	1.8504	1.34375	0.5906	1.134	1.3125	1.71875	0.76
A-BC012	Collar (only) No.	0.75	1.8504	0.5906	1.34375	1.134	1.3125	1.71875	0.76
A-WPS013GRC	WPS Type Wide Inner Ring	0.8125	2.0472	0.5906	1.375	1.331	1.50	1.75	0.787
A-BC013	Collar (only) No.	0.8125	2.0472	0.5906	1.375	1.331	1.3125	1.75	0.787
A-G1014KRRB	WPS Type Wide Inner Ring- Import	0.875	2.0472	1.375	0.5906	1.331	1.50	1.75	0.787
A-BC014	Collar (only) No.	0.875	2.0472	0.5906	1.375	1.331	1.3125	1.75	0.787
A-WPS015GRC	WPS Type Wide Inner Ring	0.9375	2.0472	0.5906	1.375	1.331	1.50	1.75	0.787
A-G1015KRRB	WPS Type Wide Inner Ring- Import	0.9375	2.0472	1.375	0.5906	1.331	1.50	1.75	0.787
A-BC015	Collar (only) No.	0.9375	2.0472	0.5906	1.375	1.331	1.3125	1.75	0.787
A-WPS100GRC	WPS Type Wide Inner Ring	1	2.0472	0.5906	1.375	1.331	1.5	1.75	0.787
A-G1100KRRB	WPS Type Wide Inner Ring- Import	1	2.0472	1.375	0.5906	1.331	1.50	1.75	0.787
A-BC100	Collar (only) No.	1	2.0472	0.5906	1.375	1.331	1.3125	1.75	0.787
A-WPS101GRC	WPS Type Wide Inner Ring	1.0625	2.4409	0.7087	1.4375	1.589	1.75	1.90625	0.876
A-BC101	Collar (only) No.	1.0625	2.4409	0.7087	1.4375	1.589	1.75	1.90625	0.876
A-WPS102GRC	WPS Type Wide Inner Ring	1.125	2.4409	0.7087	1.4375	1.589	1.75	1.90625	0.876
A-BC102	Collar (only) No.	1.125	2.4409	0.7087	1.4375	1.589	1.75	1.90625	0.876
A-WPS103GRC	WPS Type Wide Inner Ring	1.1875	2.4409	0.7087	1.4375	1.589	1.75	1.90625	0.876
A-G1103KRRB	WPS Type Wide Inner Ring- Import	1.1875	2.4409	1.4375	0.7087	1.589	1.75	1.90625	0.876
A-BC103	Collar (only) No.	1.1875	2.4409	0.7087	1.4375	1.589	1.75	1.90625	0.876
A-WPS103GR2C	WPS Type Wide Inner Ring	1.25	2.4409	1.4375	0.7087	1.589	1.75	1.90625	0.876
A-BC1032	Collar (only) No.	1.25	2.4409	0.7087	1.4375	1.589	1.75	1.90625	0.876
A-WPS104GRC	WPS Type Wide Inner Ring	1.25	2.8346	0.748	1.484375	1.847	2.125	2.015625	0.912
A-G1104KRRB	WPS Type Wide Inner Ring- Import	1.25	2.8346	1.484375	0.748	1.847	2.125	2.015625	0.912
A-BC104	Collar (only) No.	1.25	2.8346	0.748	1.484375	1.847	2.125	2.015625	0.912
A-WPS105GRC	WPS Type Wide Inner Ring	1.3125	2.8346	1.484375	0.748	1.847	2.125	2.015625	0.912
A-BC105	Collar (only) No.	1.3125	2.8346	0.748	1.484375	1.847	2.125	2.015625	0.912
A-WPS106GRC	WPS Type Wide Inner Ring	1.375	2.8346	1.484375	0.748	1.847	2.125	2.015625	0.912
A-G1106KRRB	WPS Type Wide Inner Ring- Import	-	2.8346	1.484375	0.748	1.847	2.125	2.015625	0.912
A-BC106	Collar (only) No.	1.375	2.8346	0.748	1.484375	1.847	2.125	2.015625	0.912
A-WPS107GRC	WPS Type Wide Inner Ring	1.4375	2.8346	1.484375	0.748	1.847	2.125	2.015625	0.912
A-G1107KRRB	WPS Type Wide Inner Ring- Import	1.4375	2.8346	1.484375	0.748	1.847	2.125	2.015625	0.912
A-BC107	Collar (only) No.	1.4375	2.8346	0.748	1.484375	1.847	2.125	2.015625	0.912
A-WPS108GRC	WPS Type Wide Inner Ring	1.083	3.1496	1.6875	0.8661	2.084	2.375	2.21875	1
A-G1108KRRB	WPS Type Wide Inner Ring- Import	1.083	3.1496	1.6875	0.8661	2.084	2.375	2.21875	1
A-BC108	Collar (only) No.	1.50	3.1496	0.8661	1.6875	2.084	2.375	2.21875	1
A-WPS109GRC	WPS Type Wide Inner Ring	1.5625	3.1496	1.6875	0.8661	2.084	2.375	2.21875	1
A-BC109	Collar (only) No.	1.5625	3.1496	0.8661	1.6875	2.084	2.375	2.21875	1.17
A-BC110	Collar (only) No.	1.625	3.3465	0.8661	1.6875	2.28	2.5	0.84375	1.1
A-WPS111GRC	WPS Type Wide Inner Ring	1.6875	3.3465	1.6875	0.8661	2.28	2.5	2.21875	1.1
A-BC111	Collar (only) No.	1.6875	3.3465	0.8661	1.6875	2.28	2.5	2.21875	1.1
A-WPS112GRC	WPS Type Wide Inner Ring	1.75	3.3465	1.6875	0.8661	2.28	2.5	2.21875	1.1
A-G1112KRRB	WPS Type Wide Inner Ring- Import	1.75	3.3465	1.6875	0.748	2.28	2.50	2.21875	1.1
A-BC112	Collar (only) No.	1.75	3.3465	0.8661	1.6875	2.28	2.50	2.21875	1.1
A-WPS113GRC	WPS Type Wide Inner Ring	1.8125	3.5433	1.8125	0.8661	2.413	2.75	2.46875	1.119
A-BC113	Collar (only) No.	1.8125	3.5433	0.8661	1.9375	2.413	2.75	2.46875	1.119

BEARINGS

WPS Sph Re-Lubable, Wide Inner Ring (single lip seal)

WPS Sph Re-Lubable, Wide Inner Ring (single lip seal)

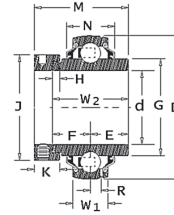

Part	Description	[d BORE]	[D]	[W1]	[W2]	[G]	[J]	[M]	[N]
A-WPS114GRC	WPS Type Wide Inner Ring	1.875	3.5433	1.9375	0.8661	2.413	2.75	2.46875	1.119
A-BC114	Collar (only) No.	1.875	3.5433	0.8661	1.9375	2.413	2.75	2.46875	1.119
A-WPS115GRC	WPS Type Wide Inner Ring	1.9375	3.5433	1.9375	0.8661	2.413	2.75	2.46875	1.119
A-G1115KRRB	WPS Type Wide Inner Ring- Import	1.9375	3.5433	1.9375	0.8661	2.413	2.75	2.46875	1.119
A-BC115	Collar (only) No.	1.9375	3.5433	0.8661	1.9375	2.413	2.75	2.46875	1.119
A-BC1152	Collar (only) No.	2	3.5433	0.7874	1.9375	2.473	2.75	2.46875	1.119
A-WPS200GRC	WPS Type Wide Inner Ring	2	3.937	2.1875	0.9843	2.762	3	2.8125	1.22
A-G1200KRRB	WPS Type Wide Inner Ring- Import	2	3.937	2.1875	0.9843	2.762	3	2.8125	1.22
A-WPS203GRC	WPS Type Wide Inner Ring	2.1875	3.937	2.1875	0.9843	2.762	3	2.8125	1.22
A-G1203KRRB	WPS Type Wide Inner Ring- Import	2.1875	3.937	2.1875	0.9843	2.762	3	2.8125	1.22
A-BC203	Collar (only) No.	2.1875	3.937	0.8268	2.1875	2.762	3	2.8125	1.22
A-WPS204GRC	WPS Type Wide Inner Ring	2.25	4.3307	2.4375	1.063	3.049	3.3125	3.0625	1.22
A-BC204	Collar (only) No.	2.25	4.3307	2.4375	1.063	3.049	3.3125	3.0625	1.22
A-WPS207GRC	WPS Type Wide Inner Ring	2.4375	4.3307	2.4375	1.063	3.049	3.3125	3.0625	1.22
A-BC207	Collar (only) No.	2.4375	4.3307	2.4375	1.063	3.049	3.3125	3.0625	1.22

WPSH Sph Hvy Duty, Wide Inner Ring

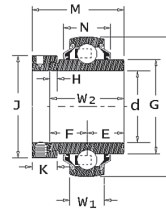

Part	Description	[d BORE]	[D]	[W1]	[W2]	[G]	[J]	[M]	[N]
A-WPSH103RRC	WPSH Hvy Duty, Wide Inner Ring	1.1875	2.8346	0.748	1.4375	1.718	1.937	1.969	0.75
A-CH103	Collar (only) No.	1.1875	2.8346	0.748	1.4375	1.718	1.937	1.969	0.75
A-WPSH104RRC	WPSH Hvy Duty, Wide Inner Ring	1.25	3.1496	0.8268	1.5	2.138	2.187	2.031	0.83
A-CH104	Collar (only) No.	1.25	3.1496	0.8268	1.5	2.138	2.187	2.031	0.83
A-WPSH106RRC	WPSH Hvy Duty, Wide Inner Ring	1.375	3.1496	0.8268	1.5	2.138	2.187	2.031	0.83
A-CH106	Collar (only) No.	1.375	3.1496	0.8268	1.5	2.138	2.187	2.031	0.83
A-WPSH107RRC	WPSH Hvy Duty, Wide Inner Ring	1.4375	3.1496	0.8268	1.5	2.138	2.187	2.031	0.83
A-CH107	Collar (only) No.	1.4375	3.1496	0.8268	1.5	2.138	2.187	2.031	0.83
A-WPSH108RRC	WPSH Hvy Duty, Wide Inner Ring	1.5	3.5433	0.9055	1.625	2.138	2.5	2.25	0.91
A-CH108	Collar (only) No.	1.5	3.5433	0.9055	1.625	2.138	2.5	2.25	0.91
A-WPSH110RRC	WPSH Hvy Duty, Wide Inner Ring	1.625	3.937	0.9843	1.6875	2.471	2.75	2.313	0.98
A-CH110	Collar (only) No.	1.625	3.937	0.9843	1.6875	2.471	2.75	2.313	0.98
A-WPSH111RRC	WPSH Hvy Duty, Wide Inner Ring	1.6875	3.937	0.9843	1.6875	2.471	2.75	2.313	0.98
A-CH111	Collar (only) No.	1.6875	3.937	0.9843	1.6875	2.471	2.75	2.313	0.98
A-WPSH112RRC	WPSH Hvy Duty, Wide Inner Ring	1.75	3.937	0.9843	1.6875	2.471	2.75	2.313	0.98
A-WPSH114RRC	WPSH Hvy Duty, Wide Inner Ring	1.875	4.3307	1.063	1.9375	2.79	3	2.625	1.17
A-CH114	Collar (only) No.	1.875	4.3307	1.063	1.9375	2.79	3	2.625	1.17
A-WPSH115RRC	WPSH Hvy Duty, Wide Inner Ring	1.9375	4.3307	1.063	1.9375	2.79	3	2.625	1.17
A-CH115	Collar (only) No.	1.9375	4.3307	1.063	1.9375	2.79	3	2.625	1.17
A-CH200	Collar (only) No.	2	4.7244	1.1417	2.1875	2.947	3.25	2.875	1.36
A-WPSH203RRC	WPSH Hvy Duty, Wide Inner Ring	2.1875	4.7244	1.1417	2.1875	2.947	3.25	2.875	1.36
A-CH203	Collar (only) No.	2.1875	4.7244	1.1417	2.1875	2.947	3.25	2.875	1.36

Parts are not Original Equipment parts and are not sponsored, affiliated or otherwise connected with any major brand.

BEARINGS

WPSH Sph Hvy Duty, Wide Inner Ring

WPSH Sph Hvy Duty, Wide Inner Ring

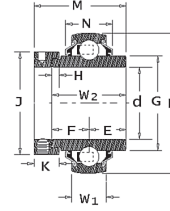

Part	Description	[d BORE]	[D]	[W1]	[W2]	[G]	[J]	[M]	[N]
A-WPSH207RRC	WPSH Hvy Duty, Wide Inner Ring	2.4375	5.1181	1.22	2.4375	3.205	3.25	3.125	1.44
A-CH207	Collar (only) No.	2.4375	5.1181	1.22	2.4375	3.205	3.25	3.125	1.44
A-WPSH211RRC	WPSH Hvy Duty, Wide Inner Ring	2.6875	5.9055	1.378	2.6875	3.721	4	3.5	1.56
A-CH211	Collar (only) No.	2.6875	5.9055	1.378	2.6875	3.721	4	3.5	1.56
A-WPSH215RRC	WPSH Hvy Duty, Wide Inner Ring	2.9375	6.2992	1.457	2.9375	3.979	4.875	3.938	1.63
A-CH215	Collar (only) No.	2.9375	6.2992	1.457	2.9375	3.979	4.875	3.938	1.63
A-WPSH303RRC	WPSH Hvy Duty, Wide Inner Ring	3.1875	6.6929	1.5354	3.1875	4.251	4.688	4.188	1.71
A-CH303	Collar (only) No.	3.1875	6.6929	1.5354	3.1875	4.251	4.688	4.188	1.71
A-WPSH307RRC	WPSH Hvy Duty, Wide Inner Ring	3.4375	7.4803	1.693	3.4375	4.767	5.25	4.563	1.87
A-CH307	Collar (only) No.	3.4375	7.4803	1.693	3.4375	4.767	5.25	4.563	1.87
A-WPSH315RRC	WPSH Hvy Duty, Wide Inner Ring	3.9375	8.4646	1.8504	3.9375	5.339	5.75	5.063	2.03
A-CH315	Collar (only) No.	3.9375	8.4646	1.8504	3.9375	5.339	5.75	5.063	2.03

WPC Cyl Pre-Lubed, Wide Inner Ring (single lip seal)

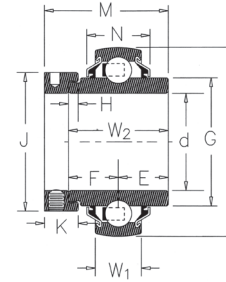

Part	Description	[d BORE]	[D]	[W1]	[W2]	[G]	[J]	[M]	[N]
A-WPC012GPC	WPC Type Wide Inner Ring	0.75	1.8504	0.5512	1.34375	1.134	1.3125	1.71875	0.76
A-BC012	Collar (only) No.	0.75	1.8504	0.5906	1.34375	1.134	1.3125	1.71875	0.76
A-WPC013GPC	WPC Type Wide Inner Ring	0.8125	2.0472	0.5906	1.375	1.331	1.50	1.75	0.787
A-BC013	Collar (only) No.	0.8125	2.0472	0.5906	1.375	1.331	1.3125	1.75	0.787
A-WPC014GPC	WPC Type Wide Inner Ring	0.875	2.0472	0.5906	1.375	1.331	1.50	1.75	0.787
A-BC014	Collar (only) No.	0.875	2.0472	0.5906	1.375	1.331	1.3125	1.75	0.787
A-WPC015GPC	WPC Type Wide Inner Ring	0.9375	2.0472	0.5906	1.375	1.331	1.50	1.75	0.787
A-BC015	Collar (only) No.	0.9375	2.0472	0.5906	1.375	1.331	1.3125	1.75	0.787
A-WPC100GPC	WPC Type Wide Inner Ring	1	2.0472	0.5906	1.375	1.331	1.50	1.75	0.787
A-BC100	Collar (only) No.	1	2.0472	0.5906	1.375	1.331	1.3125	1.75	0.787
A-WPC101GPC	WPC Type Wide Inner Ring	1.0625	2.4409	0.6299	1.4375	1.589	1.75	1.90625	0.876
A-BC101	Collar (only) No.	1.0625	2.4409	0.7087	1.4375	1.589	1.75	1.90625	0.876
A-WPC102GPC	WPC Type Wide Inner Ring	1.125	2.4409	0.6299	1.4375	1.569	1.75	1.90625	0.876
A-BC102	Collar (only) No.	1.125	2.4409	0.7087	1.4375	1.589	1.75	1.90625	0.876
A-WPC103GPC	WPC Type Wide Inner Ring	1.375	2.4409	0.6299	1.4375	1.589	1.75	1.90625	0.876
A-BC103	Collar (only) No.	1.1875	2.4409	0.7087	1.4375	1.589	1.75	1.90625	0.876
A-WPC103GP2C	WPC Type Wide Inner Ring	1.25	2.4409	0.6299	1.4375	1.589	1.75	1.90625	0.876
A-BC1032	Collar (only) No.	1.25	2.4409	0.7087	1.4375	1.589	1.75	1.90625	0.876
A-WPC104GPC	WPC Type Wide Inner Ring	1.25	2.8346	0.6693	1.484375	1.847	2.125	2.015625	0.912
A-BC104	Collar (only) No.	1.25	2.8346	0.748	1.484375	1.847	2.125	2.015625	0.912
A-WPC105GPC	WPC Type Wide Inner Ring	1.3125	2.8346	0.6693	1.484375	1.847	2.125	2.015625	0.912
A-BC105	Collar (only) No.	1.3125	2.8346	0.748	1.484375	1.847	2.125	2.015625	0.912
A-WPC106GPC	WPC Type Wide Inner Ring	1.375	2.8346	0.6693	1.484375	1.847	2.125	2.015625	0.912

Parts are not Original Equipment parts and are not sponsored, affiliated or otherwise connected with any major brand.

WPC Cyl Pre-Lubed, Wide Inner Ring (single lip seal)

WPC Cyl Pre-Lubed, Wide Inner Ring (single lip seal)

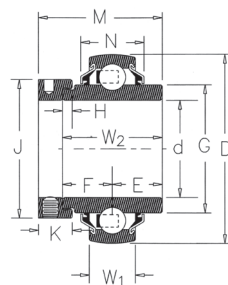

Part	Description	[d BORE]	[D]	[W1]	[W2]	[G]	[J]	[M]	[N]
A-BC106	Collar (only) No.	1.375	2.8346	0.748	1.484375	1.847	2.125	2.015625	0.912
A-WPC107GPC	WPC Type Wide Inner Ring	1.4375	2.8346	0.6693	1.484375	1.847	2.125	2.015625	0.912
A-BC107	Collar (only) No.	1.4375	2.8346	0.748	1.484375	1.847	2.125	2.015625	0.912
A-BC108	Collar (only) No.	1.50	3.1496	0.8661	1.6875	2.084	2.375	2.21875	1
A-WPC109GPC	WPC Type Wide Inner Ring	1.5625	3.1496	0.7087	1.6875	2.084	2.375	2.21875	1
A-BC109	Collar (only) No.	1.5625	3.1496	0.8661	1.6875	2.084	2.375	2.21875	1.17
A-WPC110GPC	WPC Type Wide Inner Ring	1.625	3.3465	0.748	1.6875	2.28	2.50	2.21875	1.1
A-BC110	Collar (only) No.	1.625	3.3465	0.8661	1.6875	2.28	2.5	0.84375	1.1
A-WPC111GPC	WPC Type Wide Inner Ring	1.6875	3.3465	0.748	1.6875	2.28	2.5	2.21875	1.1
A-BC111	Collar (only) No.	1.6875	3.3465	0.8661	1.6875	2.28	2.5	2.21875	1.1
A-WPC112GPC	WPC Type Wide Inner Ring	1.75	3.3465	0.748	1.6875	2.28	2.50	2.21875	1.1
A-BC112	Collar (only) No.	1.75	3.3465	0.8661	1.6875	2.28	2.50	2.21875	1.1
A-WPC113GPC	WPC Type Wide Inner Ring	1.8125	3.5433	0.7874	1.9375	2.473	2.75	2.46875	1.119
A-BC113	Collar (only) No.	1.8125	3.5433	0.8661	1.9375	2.413	2.75	2.46875	1.119
A-WPC114GPC	WPC Type Wide Inner Ring	1.875	3.5433	0.7874	1.9375	2.473	2.75	2.46875	1.119
A-BC114	Collar (only) No.	1.875	3.5433	0.8661	1.9375	2.413	2.75	2.46875	1.119
A-WPC115GPC	WPC Type Wide Inner Ring	1.9375	3.5433	0.7874	1.9375	2.473	2.75	2.46875	1.119
A-BC115	Collar (only) No.	1.9375	3.5433	0.8661	1.9375	2.413	2.75	2.46875	1.119
A-WPC115GP2C	WPC Type Wide Inner Ring	2	3.5433	0.7874	1.9375	2.473	2.75	2.46875	1.119
A-BC1152	Collar (only) No.	2	3.5433	0.7874	1.9375	2.473	2.75	2.46875	1.119
A-WPC203GPC	WPC Type Wide Inner Ring	2.1875	3.937	0.8268	2.1875	2.782	3	2.8125	1.22
A-BC203	Collar (only) No.	2.1875	3.937	0.8268	2.1875	2.762	3	2.8125	1.22
A-WPC106GRC	WPC Type Wide Inner Ring	1.375	2.8346	0.748	1.484375	1.847	2.125	2.015625	0.912

HP Cylindrical Pre-lubed, Hex Bore Bearing

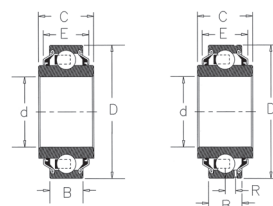

Part	Description	[HEX BORE]	[D]	[d]	[C]	[E]
A-HPC010GP	Cylindrical Pre-lubed, Hex Bore Brg.	0.625	1.8504	0.5512	0.825	0.76
A-HPC011GP	Cylindrical Pre-lubed, Hex Bore Brg.	0.6875	1.8504	0.5512	0.825	0.76
A-HPC012GP	Cylindrical Pre-lubed, Hex Bore Brg.	0.75	2.0472	0.5906	1	0.787
A-HPC014GP	Cylindrical Pre-lubed, Hex Bore Brg.	0.875	2.0472	0.5906	1	0.787
A-HPC102GP	Cylindrical Pre-lubed, Hex Bore Brg.	1.125	2.8346	0.6693	1.4844	0.912
A-HPC103TP2	Cylindrical Pre-lubed, Hex Bore Brg.	1.25	2.8346	0.6693	1.4844	0.912

Parts are not Original Equipment parts and are not sponsored, affiliated or otherwise connected with any major brand.

BEARINGS

HP Spherical Pre-lubed, Hex Bore Bearing

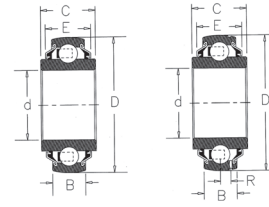

HP Spherical Pre-lubed, Hex Bore Bearing

Part	Description	[HEX BORE]	[D]	[d]	[C]	[E]
A-HPS010GP	Spherical Pre-lubed, Hex Bore Brg.	0.625	1.8504	0.5512	0.825	0.76
A-HPS011GP	Spherical Pre-lubed, Hex Bore Brg.	0.6875	1.8504	0.5512	0.825	0.76
A-HPS011GPA	Spherical Pre-lubed, Hex Bore Brg.	0.6875	1.8504	0.5512	0.825	0.76
A-HPS012GP	Spherical Pre-lubed, Hex Bore Brg.	0.75	2.0472	0.5906	1	0.787
A-HPS100GP	Spherical Pre-lubed, Hex Bore Brg.	1	2.4409	0.6299	0.9449	0.876
A-HPS014GP	Spherical Pre-lubed, Hex Bore Brg.	0.875	2.0472	0.5906	1	0.78
A-HPS102GP	Spherical Pre-lubed, Hex Bore Brg.	1.125	2.8346	0.6693	1.4844	0.912
A-HPS104GP	Spherical Pre-lubed, Hex Bore Brg.	1.25	3.1496	0.7087	1.4375	1
A-HPS106GP	Spherical Pre-lubed, Hex Bore Brg.	1.375	3.1496	0.8268	1.4375	0.992
A-HPS108GPA	Spherical Pre-lubed, Hex Bore Brg.	1.50	3.3465	0.8661	1.1811	1.102
A-HPS108GPB	Spherical Pre-lubed, Hex Bore Brg.	1.50	3.5420	-	1.1811	-

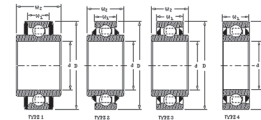

HP Spherical Pre-lubed, Hex Bore Bearing

Part	Description	LUBE TYPE	BRG TYPE	[HEX BORE]	[D]	[W1]	[W2]
A-G208PPB22	Spherical Pre-lubed, Hex Bore Brg.	Relubricable	4	1.25	3.1496	.8270	1.4380
A-W208PP21	Spherical Pre-lubed, Hex Bore Brg.	Pre-lubed	3	1.25	3.1496	.7090	1.4380
A-G5209KYYB2	Spherical Pre-lubed, Hex Bore Brg.	Relubricable	-	1.50	3.3465	1.1811	1.2992
A-210PPB20	Spherical Pre-lubed, Hex Bore Brg.	Pre-lubed	3	1.25	1.2550	.8661	1.4350
A-210PP20	Spherical Pre-lubed, Hex Bore Brg.	Pre-lubed	3	1.25	1.2550	.8661	1.435
A-G210KPPB2	Spherical Pre-lubed, Hex Bore Brg.	Relubricable	4	1.50	1.5010	.8661	1.1811

SATNR 2 Bolt Flanged w/ Set Screws

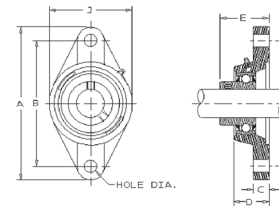

Part	Description	BORE	[A]	[B]	[C]	[D]	[E]
A-SATNR12R	2 Bolt Flanged w/ Set Screws	0.5	3.875	3	0.4375	0.71875	1
A-SNPS008RR	Bearing (only) No.	0.5	1.1875	2.25	-	2.125	3.5
A-T40R	Housing No.	0.625	3.875	3	0.4375	0.703125	1
A-8H303	Housing No.	0.50	-	-	-	-	-
A-SATNR58R	2 Bolt Flanged w/ Set Screws	0.625	3.875	3	0.4375	0.703125	1
A-SNPS010RR	Bearing (only) No.	0.625	1.1875	2.25	-	2.125	3.50
A-T40R	Housing No.	0.625	3.875	3	0.4375	0.703125	1
A-8H303	Housing No.	0.50	-	-	-	-	-
A-SATNR34R	2 Bolt Flanged w/ Set Screws	0.75	4.59375	3.53125	0.4375	0.75	1.125
A-SNPS012RR	Bearing (only) No.	0.75	1.3125	2.5625	-	2.50	3.875
A-SATNR78R	2 Bolt Flanged w/ Set Screws	0.4375	4.875	3.89	0.4375	0.78125	1.171875
A-SNPS014RR	Bearing (only) No.	0.875	1.4375	2.8125	-	2.75	4.125
A-8H305	Housing No.	1	4.875	3.89	0.4375	0.8125	1.171875

Parts are not Original Equipment parts and are not sponsored, affiliated or otherwise connected with any major brand.

SATNR 2 Bolt Flanged w/ Set Screws

SATNR 2 Bolt Flanged w/ Set Screws

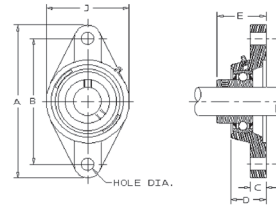

Part	Description	BORE	[A]	[B]	[C]	[D]	[E]
A-SATNR1516R	2 Bolt Flanged w/ Set Screws	0.9375	4.875	3.89	0.4375	0.8125	1.171875
A-SNPS015RR	Bearing (only) No.	0.9375	1.4375	2.8125	-	2.75	4.875
A-8H305	Housing No.	1	4.875	3.89	0.4375	0.8125	1.171875
A-SATNR1R	2 Bolt Flanged w/ Set Screws	1	4.875	3.89	0.4375	0.8125	1.171875
A-SNPS100RR	Bearing (only) No.	1	1.4375	2.8125	-	2.75	4.125
A-8H305	Housing No.- Import	1	4.875	3.89	0.4375	0.8125	1.171875
A-SNPS102RR	Bearing (only) No.	1.125	1.6875	3.28125	-	3.1875	4.75
A-8H306	Housing No.	1.25	5.5625	4.59375	0.53125	0.84375	0.34375
A-SATNR1316R	2 Bolt Flanged w/ Set Screws	1.1875	5.5625	4.59375	0.53125	0.84375	1.34375
A-SNPS103RR	Bearing (only) No.	1.1875	1.6875	3.28125	-	3.1875	4.75
A-8H306	Housing No.	1.25	5.5625	4.59375	0.53125	0.84375	0.34375
A-SATNR1142R	2 Bolt Flanged w/ Set Screws	1.25	5.5625	4.59375	0.53125	0.84375	1.34375
A-SNPS103RR2	Bearing (only) No.	1.25	1.6875	3.28125	-	3.1875	4.75
A-8H306	Housing No.	1.25	5.5625	4.59375	0.53125	0.84375	0.34375
A-SATNR114R	2 Bolt Flanged w/ Set Screws	1.25	6.125	5.125	0.5625	0.96875	1.5
A-SNPS104RR	Bearing (only) No.	1.25	1.875	3.6875	-	3.625	5
A-8H307	Housing No.	1.4375	6.125	5.125	0.5625	0.96875	1.50
A-SNPS106RR	Bearing (only) No.	1.375	1.875	3.6875	-	3.625	5
A-8H307	Housing No.	1.4375	6.125	5.125	0.5625	0.96875	1.50
A-SATNR1716R	2 Bolt Flanged w/ Set Screws	1.4375	6.125	5.125	0.5625	0.96875	1.5
A-SNPS107RR	Bearing (only) No.	1.4375	1.875	3.6875	-	3.625	5
A-8H307	Housing No.	1.4375	6.125	5.125	0.5625	0.96875	1.50
A-SATNR112R	2 Bolt Flanged w/ Set Screws	1.50	6.75	5.65625	0.5625	1.03125	1.609375
A-SNPS108RR	Bearing (only) No.	1.50	1.9375	3.9375	-	4	0.416
A-8H308	Housing No.	1.50	6.750	5.65625	0.5625	1.03125	1.609375

SATNR 4 Bolt Flanged w/ set screws

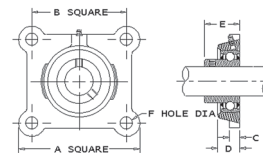

Part	Description	BORE	[A]	[B]	[C]	[D]	[E]
A-SAFNR12R	4 Bolt Flanged w/ Set Screws	0.5	3	2.125	0.4375	0.7031	1
A-SNPS008RR	Bearing (only) No.	0.5	1.1875	2.25	-	2.125	3.5
A-SAFNR58R	4 Bolt Flanged w/ Set Screws	0.625	3	2.125	0.4375	0.7031	1
A-SNPS010RR	Bearing (only) No.	0.625	1.1875	2.25	-	2.125	3.50
A-SAFNR34R	4 Bolt Flanged w/ Set Screws	0.75	3.375	2.50	0.4375	0.75	1.125
A-FWG34R	4 Bolt Flanged w/ Set Screws	0.75	3.375	2.50	0.4375	0.75	1.125
A-SNPS012RR	Bearing (only) No.	0.75	1.3125	2.5625	-	2.50	3.875
A-8H404	Housing No.- Import	0.75	-	-	-	-	-
A-SAFNR78R	4 Bolt Flanged w/ Set Screws	0.875	3.75	2.75	0.53125	0.78125	1.1718
A-SNPS014RR	Bearing (only) No.	0.875	1.4375	2.8125	-	2.75	4.125
A-8H405	Housing No.- Import	-	-	-	-	-	-
A-SAFNR1516R	4 Bolt Flanged w/ Set Screws	0.9375	3.75	2.75	0.53125	0.78125	1.1718
A-SNPS015RR	Bearing (only) No.	0.9375	1.4375	2.8125	-	2.75	4.875

Parts are not Original Equipment parts and are not sponsored, affiliated or otherwise connected with any major brand.

BEARINGS

SATNR 4 Bolt Flanged w/ set screws

SATNR 4 Bolt Flanged w/ set screws

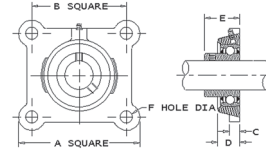

Part	Description	BORE	[A]	[B]	[C]	[D]	[E]	
A-SAFNR1R	4 Bolt Flanged w/ Set Screws	1	3.75	2.75	0.53125	0.7813	1.1718	
A-FWG1R	4 Bolt Flanged w/ Set Screws	1	3.75	2.75	0.53125	0.7813	1.1718	
A-SNPS100RR	Bearing (only) No.	1	1.4375	2.8125	0.53125	0.7813	1.1718	
A-8H405	Housing No.- Import	-	-	-	-	-	-	
A-SAFNR118R	4 Bolt Flanged w/ Set Screws	1.125	4.25	3.25	0.5625	0.8437	1.34375	
A-SNPS102RR	Bearing (only) No.	1.125	1.6875	3.2813	-	3.1875	4.75	
A-8H406	Housing No.	-	-	-	-	-	-	
A-SAFNR1316R	4 Bolt Flanged w/ Set Screws	1.1875	4.25	3.25	0.5625	0.84375	1.3475	
A-SNPS103RR	Bearing (only) No.	1.1875	1.6875	3.2813	-	3.1875	4.75	
A-8H406	Housing No.	-	-	-	-	-	-	
A-SAFNR1142R	4 Bolt Flanged w/ Set Screws	1.25	4.25	0.75	0.5625	0.87375	1.34375	
A-SNPS103RR2	Bearing (only) No.	1.25	1.6875	3.28125	-	3.1875	4.75	
A-SAFNR114R	4 Bolt Flanged w/ Set Screws	1.25	4.625	3.625	0.59375	0.96875	1.5	
A-SNPS104RR	Bearing (only) No.	1.25	1.875	3.6875	-	3.625	5	
A-8H407	Housing No.	-	-	-	-	-	-	
A-SAFNR138R	4 Bolt Flanged w/ Set Screws	1.375	4.625	3.625	0.59375	0.96875	1.50	
A-FWG138R	4 Bolt Flanged w/ Set Screws	1.375	4.625	3.625	0.59375	0.96875	1.50	
A-SNPS106RR	Bearing (only) No.	1.375	1.875	3.6875	-	3.625	5	
A-8H407	Housing No.	-	-	-	-	-	-	
A-SAFNR176R	4 Bolt Flanged w/ Set Screws	1.4375	4.625	3.625	0.59375	0.96875	1.50	
A-FWG1716R	4 Bolt Flanged w/ Set Screws	1.4375	4.625	3.625	0.59375	0.96875	1.50	
A-SNPS107RR	Bearing (only) No.	1.4375	1.875	3.6875	-	3.625	5	
A-8H407	Housing No.	-	-	-	-	-	-	
A-SAFNR112R	4 Bolt Flanged w/ Set Screws	1.50	5.125	4	0.3928	1.03125	1.609	
A-FWG112R	4 Bolt Flanged w/ Set Screws	1.50	5.125	4	0.3928	1.03125	1.609	
A-SNPS108RR	Bearing (only) No.	1.50	1.9375	3.9375	-	4	0.416	
A-8H408	Housing No.	-	-	-	-	-	-	
A-FWG158R	4 Bolt Flanged w/ Set Screws	1.625	-	-	-	-	-	
A-8H409	Housing No.	-	-	-	-	-	-	
A-FWG11116R	4 Bolt Flanged w/ Set Screws	1.6875	-	-	-	-	-	
A-WPS111GRC	Bearing (only) No.	1.6875	1.6875	3.3465	1.6875	0.8661	2.28	2.5
A-8H409	Housing No.	-	-	-	-	-	-	

Parts are not Original Equipment parts and are not sponsored, affiliated or otherwise connected with any major brand.

SATNR 4 Bolt Flanged w/ set screws



SATNR 4 Bolt Flanged w/ set screws

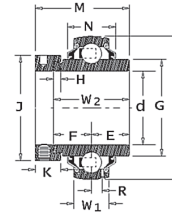

Part	Description	BORE	D	W1	W2	G	J	M	N
A-FWG134R	4 Bolt Flanged w/ Set Screws- Import	1.75	1.75	1.75	1.75	1.75	1.75	1.75	1.75
A-WPS112GRC	Bearing (only) No.	1.75	1.75	1.75	1.75	1.75	1.75	1.75	1.75
A-8H409	Housing No.								
A-FWG178R	4 Bolt Flanged w/ Set Screws	1.875	1.875	1.875	1.875	1.875	1.875	1.875	1.875
A-WPS114GRC	Bearing (only) No.	1.875	1.875	1.875	1.875	1.875	1.875	1.875	1.875
A-8H410	Housing No.								
A-WPS115GRC	Bearing (only) No.	1.9375	1.9375	1.9375	1.9375	1.9375	1.9375	1.9375	1.9375
A-8H410	Housing No.								
A-FWG2R	4 Bolt Flanged w/ Set Screws	2	2	2	2	2	2	2	2
A-WPS200GRC	Bearing (only) No.	2	2	2	2	2	2	2	2
A-8H411	Housing No.								
A-FWG2316R	4 Bolt Flanged w/ Set Screws	2.1875	2.1875	2.1875	2.1875	2.1875	2.1875	2.1875	2.1875
A-WPS203GRC	Bearing (only) No.	2.1875	2.1875	2.1875	2.1875	2.1875	2.1875	2.1875	2.1875
A-8H411	Housing No.								
A-FWG2716R	4 Bolt Flanged w/ Set Screws	2.4375	2.4375	2.4375	2.4375	2.4375	2.4375	2.4375	2.4375
A-WPS207GRC	Bearing (only) No.	2.4375	2.4375	2.4375	2.4375	2.4375	2.4375	2.4375	2.4375

SPNR Pillow Block Set Screw Units

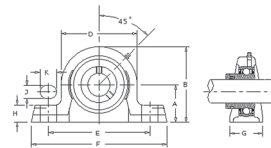

Part	Description	BORE	[A]	[B]	[D]	[E]	[F]	[G]	[H]
A-SPNR12RS	Pillow Block Unit w/ Set Screws	0.5	1.1875	2.25	2.125	3.50	4.75	0.25	0.5
A-SNPS008RR	Bearing (only) No.	0.5	1.1875	2.25	2.125	3.5	4.75	0.25	0.5
A-P40RS	Housing No.	0.625	1.1875	2.25	2.125	3.5	4.75	1.25	0.50
A-8H203	Housing No.	0.625	1.1875	2.25	2.125	3.50	4.75	1.25	0.5
A-SPNR58RS	Pillow Block Unit w/ Set Screws	0.625	1.1875	2.25	2.125	3.50	4.75	1.25	0.50
A-SNPS010RR	Bearing (only) No.	0.625	1.1875	2.25	2.125	3.50	4.75	1.25	0.50
A-P40RS	Housing No.	0.625	1.1875	2.25	2.125	3.5	4.75	1.25	0.50
A-8H203	Housing No.	0.625	1.1875	2.25	2.125	3.50	4.75	1.25	0.5
A-SPNR34RS	Pillow Block Unit w/ Set Screws	0.75	1.3125	2.5625	2.50	3.875	5.25	1.50	0.5625
A-SNPS012RR	Bearing (only) No.	0.75	1.3125	2.5625	2.50	3.875	5.25	1.50	0.5625
A-P47RS	Housing No.	0.75	1.3125	2.5625	2.50	3.875	5.25	1.50	0.5625
A-8H204	Housing No.	0.75	1.3125	2.5625	2.5	3.875	5.25	1.5	0.5625
A-SPNR78RS	Pillow Block Unit w/ Set Screws	0.875	1.4375	2.8125	2.75	4.125	5.50	1.625	0.625
A-SNPS014RR	Bearing (only) No.	0.875	1.4375	2.8125	2.75	4.125	5.50	1.625	0.625
A-P52RS	Housing No.	1	1.4375	2.8125	2.75	4.125	5.50	1.625	0.625
A-8H205	Housing No.	1	1.4375	2.8125	2.75	4.125	5.50	1.625	0.625
A-SPNR1516RS	Pillow Block Unit w/ Set Screws	0.9375	1.4375	2.8125	2.75	4.875	5.5	1.625	0.625
A-SNPS015RR	Bearing (only) No.	0.9375	1.4375	2.8125	2.75	4.875	5.50	1.625	0.625
A-P52RS	Housing No.	1	1.4375	2.8125	2.75	4.125	5.50	1.625	0.625
A-8H205	Housing No.	1	1.4375	2.8125	2.75	4.125	5.50	1.625	0.625
A-SPNR1RS	Pillow Block Unit w/ set screws	1	1.4375	2.8125	2.75	4.125	5.50	1.625	0.625
A-SNPS100RR	Bearing (only) No.	1	1.4375	2.8125	2.75	4.125	5.50	1.625	0.625

Parts are not Original Equipment parts and are not sponsored, affiliated or otherwise connected with any major brand.

BEARINGS

SPNR Pillow Block Set Screw Units

SPNR Pillow Block Set Screw Units

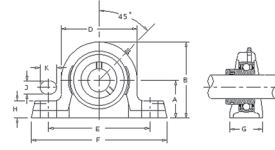

Part	Description	BORE	[A]	[B]	[D]	[E]	[F]	[G]	[H]
A-P52RS	Housing No.	1	1.4375	2.8125	2.75	4.125	5.50	1.625	0.625
A-8H205	Housing No.	1	1.4375	2.8125	2.75	4.125	5.50	1.625	0.625
A-SPNR118RS	Pillow Block Unit w/ Set Screws	1.125	1.6875	3.28125	3.1875	4.75	6.3125	1.75	0.75
A-SNPS102RR	Bearing (only) No.	1.125	1.6875	3.28125	3.1875	4.75	6.3125	1.75	0.75
A-8H206	Housing No.	1.25	1.6875	3.28125	3.1875	4.75	6.3125	1.75	0.75
A-SPNR136RS	Pillow Block Unit w/ Set Screws	1.1875	1.6875	3.28125	3.1875	4.75	6.3125	1.75	0.75
A-SNPS103RR	Bearing (only) No.	1.1875	1.6875	3.28125	3.1875	4.75	6.3125	1.75	0.75
A-8H206	Housing No.	1.25	1.6875	3.28125	3.1875	4.75	6.3125	1.75	0.75
A-SPNR1142RS	Pillow Block Unit w/ Set Screws	1.25	1.6875	3.28125	3.1875	4.75	6.3125	1.75	0.75
A-SNPS103RR2	Bearing (only) No.	1.25	1.6875	3.28125	-	3.1875	4.75	6.3125	1.75
A-8H206	Housing No.	1.25	1.6875	3.28125	3.1875	4.75	6.3125	1.75	0.75
A-SPNR114RS	Pillow Block Unit w/ Set Screws	1.25	1.875	3.6875	3.625	5	6.5625	1.875	0.8125
A-SNPS104RR	Bearing (only) No.	1.25	1.875	3.6875	3.625	5	6.5625	1.875	0.8125
A-8H207	Housing No.	1.4375	1.875	3.6875	3.625	5	6.5625	1.875	0.8125
A-SPNR138RS	Pillow Block Unit w/ Set Screws	1.375	1.875	3.6875	3.625	5	6.5625	1.875	0.8125
A-SNPS106RR	Bearing (only) No.	1.375	1.875	3.6875	3.625	5	6.5625	1.875	0.8125
A-8H207	Housing No.	1.4375	1.875	3.6875	3.625	5	6.5625	1.875	0.8125
A-SPNR1716RS	Pillow Block Unit w/ Set Screws	1.4375	1.875	3.6875	3.625	5	6.5625	1.875	0.8125
A-SNPS107RR	Bearing (only) No.	1.4375	1.875	3.6875	3.625	5	6.5625	1.875	0.8125
A-8H207	Housing No.	1.4375	1.875	3.6875	3.625	5	6.5625	1.875	0.8125
A-SPNR112RS	Pillow Block Unit w/ Set Screws	1.50	1.9375	3.9375	4	0.416	7.125	2	0.875
A-SNPS108RR	Bearing (only) No.	1.50	1.9375	3.9375	4	0.416	7.125	2	0.875
A-8H208	Housing No.	1.5	1.9375	3.9375	4	5.083	7.125	2	0.50
A-PWG1116RM	Pillow Block Brg	1.0625							
A-WPS111GRC	Bearing (only) No.	1.6875	3.3465	1.6875	0.8661	2.28	2.5	2.21875	1.1
A-8H209	Housing No.								
A-PWG134R	Pillow Block Brg	1.75							
A-WPS112GRC	Bearing (only) No.	1.75	3.3465	1.6875	0.8661	2.28	2.5	2.21875	1.1
A-8H209	Housing No.								
A-PWG178R	Pillow Block Brg	1.875							
A-WPS114GRC	Bearing (only) No.	1.875	3.5433	1.9375	0.8661	2.413	2.75	2.46875	1.119
A-8H210	Housing No.								
A-PWG2716R	Pillow Block Brg	2.4375							
A-WPS207GRC	Bearing (only) No.	2.4375	4.3307	2.4375	1.063	3.049	3.3125	3.0625	1.22
A-RAK11516	Pillow Block Bearing & Housing	1.9375							

Parts are not Original Equipment parts and are not sponsored, affiliated or otherwise connected with any major brand.

Hvy Disc Bearing, Round Bore, Relub.



Hvy Disc Bearing, Round Bore

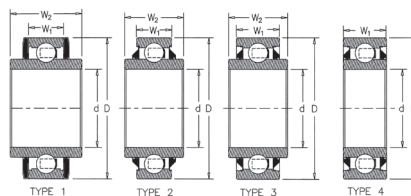

Part	Description	LUBE TYPE	BRG TYPE	[d BORE]	[D]	[W2]	[W1]
A-DC210TTR3	Hvy Disc Bearing, Round Bore	Relubable	4	1.406	3.5433	1.1875	1.1875
A-DC208TT10	Hvy Disc Bearing, Round Bore	Pre-lubed	2	1.5	3.1496	1.6875	0.8268
A-DC208TTA	Hvy Disc Bearing, Round Bore	Pre-lubed	3	1.525	3.1496	1.4375	1.1875
A-DC209TTR10	Hvy Disc Bearing, Round Bore	Relubable	3	1.76985	3.3465	1.687	1.093
A-DC211TTR21	Hvy Disc Bearing, Round Bore	Relubable	3	1.775	3.937	1.75	1.3125
A-DC210TTA	Hvy Disc Bearing, Round Bore	Pre-lubed	3	1.9375	3.5433	1.9375	1.355
A-DC210TT2	Hvy Disc Bearing, Round Bore	Pre-lubed	4	1.9375	3.5433	1.1875	1.1875
A-DC211TT2	Hvy Disc Bearing, Round Bore	Pre-lubed	4	2.1874	3.937	1.3125	1.3125
A-DC214TT2	Hvy Disc Bearing, Round Bore	Pre-lubed	4	2.1874	3.937	1.3125	1.3125
A-DC211TTR2	Hvy Disc Bearing, Round Bore	Relubable	1	2.6875	4.9213	2.6875	0.9449
A-DC214TTR3	Hvy Disc Bearing, Round Bore	Relubable	3	2.6875	4.9213	2.6875	1.5625
A-DC214TTR2	Hvy Disc Bearing, Round Bore	Relubable	4	2.7553	4.9213	1.5625	1.5625

Hvy Disc Bearing, Square Bore

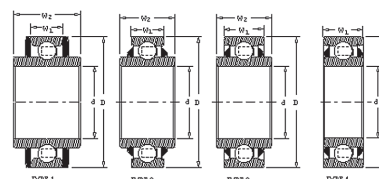

Part	Description	LUBE TYPE	BRG TYPE	[d BORE]	[D]	[W2]	[W1]
A-DC2082	Hvy Disc Bearing, Square Bore	Pre-lubed	1	1	3.1496	1.6875	0.7087
A-DC208TT6	Hvy Disc Bearing, Square Bore	Pre-lubed	2	1	3.1496	1.4375	0.7087
A-DC208	Hvy Disc Bearing, Square Bore	Pre-lubed	1	1.125	3.1496	1.6875	0.7087
A-DC208TTB	Hvy Disc Bearing, Square Bore	Pre-lubed	3	1.125	3.1496	1.6875	1.279
A-DC208TT5	Hvy Disc Bearing, Square Bore	Pre-lubed	2	1.125	3.1496	1.4375	0.7087
A-DC208TT8	Hvy Disc Bearing, Square Bore	Pre-lubed	3	1.125	3.1496	1.4375	1.1875
A-DC208TTR17	Hvy Disc Bearing, Square Bore	Relubable	3	1.125	3.3755	1.4375	1.188
A-DC210TT4	Hvy Disc Bearing, Square Bore	Pre-lubed	4	1.125	3.5433	1.1875	1.1875
A-DC210TTR4	Hvy Disc Bearing, Square Bore	Relubable	4	1.125	3.5433	1.1875	1.1875
A-DC209TTR8	Hvy Disc Bearing, Square Bore	Relubable	2	1.25	3.3465	1.4375	0.8861
A-DC211TT3	Hvy Disc Bearing, Square Bore	Pre-lubed	4	1.50	3.937	1.3125	1.3125
A-DC211TTR3	Hvy Disc Bearing, Square Bore	Relubable	4	1.50	3.937	1.3125	1.3125
A-DC211TTR3E	Hvy Disc Bearing, Square Bore	Relubable	3	1.50	3.937	1.75	1.3125
A-DC211TTR4	Hvy Disc Bearing, Square Bore	Relubable	3	1.50	3.937	1.75	1.3125
A-DC211TT5	Hvy Disc Bearing, Square Bore	Pre-lubed	3	1.50	4	1.75	1.438
A-DC212TT	Hvy Disc Bearing, Square Bore	Pre-lubed	3	1.75	4.3307	2	1.506
A-DC212TTR	Hvy Disc Bearing, Square Bore	Relubable	3	1.75	4.3307	2	1.506
A-DC212TTRA	Hvy Disc Bearing, Square Bore	Relubable	3	1.75	4.3307	2	1.506
A-DC212TTR2	Hvy Disc Bearing, Square Bore	Relubable	2	1.75	4.3307	2	1.063
A-DC216TTR2	Hvy Disc Bearing, Square Bore	Relubable	2	2.25	5.5118	2.5	1.1811
A-DC216TTR3	Hvy Disc Bearing, Square Bore	Relubable	2	2.25	5.5118	2.5	1.1811

Parts are not Original Equipment parts and are not sponsored, affiliated or otherwise connected with any major brand.

BEARINGS

Hvy Disc Bearing, Round Bore, Non-Relub.

Hvy Disc Bearing, Round Bore

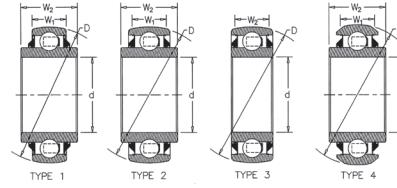

Part	Description	LUBE TYPE	BRG TYPE	[d BORE]	[D]	[W2]	[W1]
A-DS208TT7	Hvy Disc Bearing, Round Bore	Pre-lubed	1	1.1875	3.1496	1.1875	0.7087
A-DS208TT2A	Hvy Disc Bearing, Round Bore	Pre-lubed	2	1.5	3.1496	1.6875	1.1875
A-DS208T0	Hvy Disc Bearing, Round Bore	Pre-lubed	4	1.525	3.443	1.4375	1.188
A-DS208TT3	Hvy Disc Bearing, Round Bore	Pre-lubed	4	1.525	3.443	1.4375	1.188
A-DS209TT4	Hvy Disc Bearing, Round Bore	Pre-lubed	3	1.525	3.3465	1.1875	1.1875
A-DS209TTR4	Hvy Disc Bearing, Round Bore	Relubable	3	1.525	3.3465	1.1875	1.1875
A-DS209TT4A	Hvy Disc Bearing, Round Bore	Pre-lubed	1	1.525	3.34685	1.1875	0.748
A-DS209TT6	Hvy Disc Bearing, Round Bore	Pre-lubed	4	1.525	3.443	1.1875	1.1875
A-DS209TT6S	Hvy Disc Bearing, Round Bore	Pre-lubed	4	1.525	3.443	1.1875	1.1875
A-DS209TT6M	Hvy Disc Bearing, Round Bore	Pre-lubed	4	1.525	3.443	1.1875	1.1875
A-DS209TTR6JA	Hvy Disc Bearing, Round Bore	Relubable	4	1.525	3.443	1.1875	1.1875
A-DS209TTR6P	Hvy Disc Bearing, Round Bore	Relubable	4	1.525	3.4925	1.6875	1.251
A-DS209TTR9A	Hvy Disc Bearing, Round Bore	Relubable	4	1.525	3.437	1.687	1.25
A-DS209TTR12	Hvy Disc Bearing, Round Bore	Relubable	1	1.7645	3.3465	1.687	1.042
A-DS209TTR11B	Hvy Disc Bearing, Round Bore	Relubable	4	1.769	3.437	1.687	1.25
A-DS209TT2	Hvy Disc Bearing, Round Bore	Pre-lubed	3	1.7712	3.3465	1.1875	1.1875
A-DS209TTR2	Hvy Disc Bearing, Round Bore	Relubable	3	1.7712	3.3465	1.1875	1.1875
A-DS209TTR10	Hvy Disc Bearing, Round Bore	Relubable	1	1.771	3.3465	1.4375	0.8661
A-DS210TTR5A	Hvy Disc Bearing, Round Bore	Relubable	3	1.775	3.5433	1.1875	1.1875
A-DS210TT5	Hvy Disc Bearing, Round Bore	Pre-lubed	3	1.775	3.5433	1.1875	1.1875
A-DS211TTR13	Hvy Disc Bearing, Round Bore	Relubable	1	1.775	3.937	1.3125	0.9843
A-DS211TT13A	Hvy Disc Bearing, Round Bore	Pre-lubed	1	1.775	3.91	1.3125	0.8265
A-DS211TTR21A	Hvy Disc Bearing, Round Bore	Relubable	4	1.775	3.971	2.187	1.312
A-DS211TTR23	Hvy Disc Bearing, Round Bore	Relubable	4	1.775	3.98	2.125	1.335
A-DS210TT2	Hvy Disc Bearing, Round Bore	Pre-lubed	3	1.9375	3.5433	1.1875	1.1875
A-DS210TTR2	Hvy Disc Bearing, Round Bore	Relubable	3	1.9375	3.5433	1.1875	1.1875
A-DS210TT2B	Hvy Disc Bearing, Round Bore	Pre-lubed	3	1.9375	3.5433	1.1875	1.1875
A-DS211TTR3A	Hvy Disc Bearing, Round Bore	Relubable	3	1.9374	3.937	1.3155	1.3155
A-DS211TTR1	Hvy Disc Bearing, Round Bore	Relubable	4	2.1875	3.971	2.187	1.312
A-DS211TTR12A	Hvy Disc Bearing, Round Bore	Relubable	4	1.9375	3.971	2.125	1.312
A-DS214TTR2	Hvy Disc Bearing, Round Bore	Relubable	3	2.768"	4.9213	1.5625	1.5625
A-DS214TTR3	Hvy Disc Bearing, Round Bore	Relubable	3	1.9375	4.9213	1.5625	1.5625
A-DS211TTR7A	Hvy Disc Bearing, Round Bore	Relubable	4	1.938	3.971	2.1845	1.312
A-DS211TTR14	Hvy Disc Bearing, Round Bore	Relubable	1	2.005	3.937	1.312	0.9843
A-DS211TTR8R	Hvy Disc Bearing, Round Bore	Relubable	2	2.1874	3.937	2.187	1.438
A-DS211TR8R	Hvy Disc Bearing, Round Bore	Relubable	1	2.1874	3.937	1.3125	0.9843
A-DS211TT2	Hvy Disc Bearing, Round Bore	Pre-lubed	3	2.1874	3.937	1.3125	1.3125
A-DS211TTR2	Hvy Disc Bearing, Round Bore	Relubable	3	2.1874	3.937	1.3125	1.3125
A-DS211TTR1	Hvy Disc Bearing, Round Bore	Relubable	4	2.1875	3.971	2.187	1.312
A-DS211TTR11A	Hvy Disc Bearing, Round Bore	Relubable	4	2.1874	3.971	2.187	1.312
A-DS211TT4	Hvy Disc Bearing, Round Bore	Pre-lubed	4	2.1874	3.937	2.187	1.312
A-DS211TTR9	Hvy Disc Bearing, Round Bore	Relubable	1	2.188	3.937	1.5625	0.9843
A-DS214TTRA	Hvy Disc Bearing, Round Bore	Relubable	1	2.6875	4.9213	2.6875	1.1024
A-DS214TTR5	Hvy Disc Bearing, Round Bore	Relubable	2	2.7553	4.9213	2.438	1.562
A-DS214TT2	Hvy Disc Bearing, Round Bore	Pre-lubed	3	2.758	4.9213	1.5625	1.5625
A-DS216TTR3	Hvy Disc Bearing, Round Bore	Relubable	1	3.01	5.5118	2.5	1.1811

Parts are not Original Equipment parts and are not sponsored, affiliated or otherwise connected with any major brand.

BEARINGS

Hvy Disc Bearing, Square Bore, Relub.



Hvy Disc Bearing, Square Bore

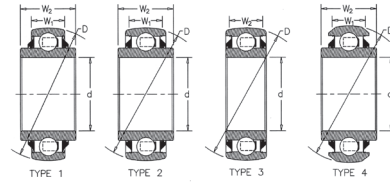

Parts are not Original Equipment parts and are not sponsored, affiliated or otherwise connected with any major brand.

Part	Description	LUBE TYPE	BRG TYPE	[d BORE]	[D]	[W2]	[W1]
A-DS208TT11	Hvy Disc Bearing, Square Bore	Pre-lubed	4	0.875	3.443	1.4375	1.1875
A-DS208TT1A	Hvy Disc Bearing, Square Bore	Pre-lubed	4	0.875	3.4385	1.4375	1.1875
A-DS208TT13	Hvy Disc Bearing, Square Bore	Pre-lubed	1	0.875	3.1496	1.4375	0.7087
A-DS208TT13B	Hvy Disc Bearing, Square Bore	Pre-lubed	1	0.875	3.1496	1.4375	0.7087
A-DS208TT6	Hvy Disc Bearing, Square Bore	Pre-lubed	1	1	3.1496	1.4375	0.7087
A-DS208TTR6	Hvy Disc Bearing, Square Bore	Relubable	2	1	3.1496	1.4375	0.9449
A-DS208TT9	Hvy Disc Bearing, Square Bore	Pre-lubed	2	1	3.1496	1.4375	1.1875
A-DS208TT5	Hvy Disc Bearing, Square Bore	Pre-lubed	2	1.125	3.1496	1.4375	0.7087
A-DS208TTR5	Hvy Disc Bearing, Square Bore	Relubable	2	1.125	3.1496	1.4375	0.9449
A-DS208TT8	Hvy Disc Bearing, Square Bore	Pre-lubed	2	1.125	3.1496	1.4375	1.1875
A-DS208TTR8	Hvy Disc Bearing, Square Bore	Relubable	2	1.125	3.1496	1.4375	1.1875
A-DS208TTR21	Hvy Disc Bearing, Square Bore	Relubable	1	1.125	3.1496	1.4375	0.8661
A-DS208TT12	Hvy Disc Bearing, Square Bore	Pre-lubed	4	1.125	3.443	1.4375	1.1875
A-DS208TT12A	Hvy Disc Bearing, Square Bore	Pre-lubed	4	1.125	3.4385	1.4375	1.1875
A-DS209TT7M	Hvy Disc Bearing, Square Bore	Pre-lubed	4	1.125	3.441	1.687	1.312
A-DS209TT7P	Hvy Disc Bearing, Square Bore	Pre-lubed	4	1.125	3.441	1.438	1.188
A-DS209TTR13	Hvy Disc Bearing, Square Bore	Relubable	2	1.125	3.437	1.687	1.25
A-DS209TTR13A	Hvy Disc Bearing, Square Bore	Relubable	2	1.125	3.437	1.687	1.25
A-DS209TTR15	Hvy Disc Bearing, Square Bore	Relubable	2	1.125	3.437	1.687	1.25
A-DS210TT4	Hvy Disc Bearing, Square Bore	Pre-lubed	3	1.125	3.5433	1.1875	1.1875
A-DS210TTR4	Hvy Disc Bearing, Square Bore	Relubable	3	1.125	3.5433	1.1875	1.1875
A-DS211TT4A	Hvy Disc Bearing, Square Bore	Pre-lubed	3	1.125	3.5433	1.1875	1.1875
A-DS210TT6	Hvy Disc Bearing, Square Bore	Pre-lubed	2	1.125	3.5433	1.4375	1.1875
A-DS210TTR5	Hvy Disc Bearing, Square Bore	Relubable	2	1.125	3.5433	1.75	1.1875
A-DS209TT5	Hvy Disc Bearing, Square Bore	Pre-lubed	2	1.25	3.3465	1.4375	1.1875
A-DS209TTR5	Hvy Disc Bearing, Square Bore	Relubable	2	1.25	3.3465	1.4375	1.1875
A-DS209TTR5B	Hvy Disc Bearing, Square Bore	Relubable	2	1.25	3.3465	1.4375	1.1875
A-DS209TT7	Hvy Disc Bearing, Square Bore	Pre-lubed	4	1.25	3.443	1.4375	1.1875
A-DS209TT7J	Hvy Disc Bearing, Square Bore	Pre-lubed	4	1.25	3.441	1.687	1.312
A-DS209TTR8	Hvy Disc Bearing, Square Bore	Relubable	1	1.25	3.3465	1.4375	0.8661
A-DS209TT8A	Hvy Disc Bearing, Square Bore	Pre-lubed	1	1.25	3.3465	1.4375	0.8661
A-DS209TTR8A	Hvy Disc Bearing, Square Bore	Relubable	1	1.25	3.3465	1.4375	0.8661
A-DS209TTR14	Hvy Disc Bearing, Square Bore	Relubable	4	1.295	3.437	1.687	1.25
A-DS211TT3	Hvy Disc Bearing, Square Bore	Pre-lubed	3	1.5	3.937	1.3125	1.3125
A-DS211TTR3	Hvy Disc Bearing, Square Bore	Relubable	3	1.5	3.937	1.3125	1.3125
A-DS211TTR3B	Hvy Disc Bearing, Square Bore	Relubable	3	1.5	3.937	1.3125	1.3125
A-DS211TTR20	Hvy Disc Bearing, Round Bore	Relubable	2	1.5	3.937	2	1.438
A-DS211TTR22	Hvy Disc Bearing, Square Bore	Relubable	4	1.5	3.937	2	1.312
A-DS211TT6	Hvy Disc Bearing, Square Bore	Pre-lubed	4	1.5	4.13	1.75	1.4375
A-DS211TTR24	Hvy Disc Bearing, Square Bore	Relubable	4	1.625	3.971	2	1.3125
A-DS216TTR2	Hvy Disc Bearing, Square Bore	Relubable	1	2.25	5.5118	2.5	1.1811

BEARINGS

Flanged Disc Unit

Flanged Disc Unit

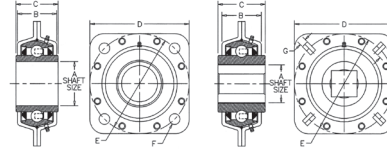

Part	Description	BORE	[A]	[B]	[C]	[D&E]	[F]	[G]
A-FD209RJ	Flanged Disc Bearing	round	1.75	1.64	1.687	5	0.531	-
A-FD209RIMP	Flanged Disc Bearing- Import	round	1.75	1.64	1.687	5	0.531	-
A-FD209RE	Flanged Disc Bearing	round	1.5	1.64	1.687	5	-	0.531
A-FD209REIMP	Flanged Disc Bearing- Import	round	1.5	1.64	1.687	5	-	0.531
A-FD209RK	Flanged Disc Bearing	square	1.25	1.64	1.687	5	-	0.531
A-FD209RM	Flanged Disc Bearing	square	1.125	1.64	1.687	5	-	0.531
A-FD211RBA	Flanged Disc Bearing	round	2.1875	1.799	2.187	5.5	0.531	-
A-FD211REA	Flanged Disc Bearing	round	1.75	1.799	2.187	5.5	0.531	-
A-FD211REIMP	Flanged Disc Bearing- Import	round	1.75	1.799	2.187	5.5	0.531	-
A-FD211RJA	Flanged Disc Bearing	round w/ cam	1.9375	1.799	2.125	5.5	0.531	-
A-FD211RJAIMP	Flanged Disc Bearing- Import	round w/ cam	1.9375	1.799	2.125	5.5	0.531	-
A-FD211RKA	Flanged Disc Bearing	hex	1.75	1.799	2.188	5.5	0.531	-
A-FD211RKB	Flanged Disc Bearing	hex	1.75	1.799	2.188	5.5	0.531	-
A-FD211RM	Flanged Disc Bearing	square	1.5	1.799	2	5.5	-	0.531
A-FD211RP	Flanged Disc Bearing	square	40mm	1.799	2.006	5.5	0.531	-

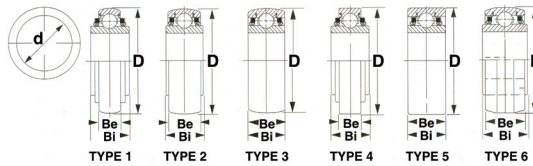

Additional Hvy Disc Bearing, Round Bore, NonRelub.

Part	[d]	[D]	[Be]	[Bi]	LUBE TYPE	BRG TYPE
A-W208PPB2	1.5005"/38.113 mm	3.1496"/80.000 mm	.7090"/18.000 mm	1.6880"/42.875 mm	Pre-lubed	1
A-W208PPB7	1.1880"/30.175 mm	3.1496"/80.000 mm	.7090"/18.000 mm	1.1880"/30.175 mm	Pre-lubed	1
A-W208PP10	1.5005"/38.113 mm	3.1496"/80.000 mm	.8270"/21.000 mm	1.6880"/42.875 mm	Pre-lubed	4
A-W208PPB10	1.5005"/38.113 mm	3.1496"/80.000 mm	.8270"/21.000 mm	1.6880"/42.875 mm	Pre-lubed	1
A-W208PPB23	1.5005"/38.113 mm	3.1496"/80.000 mm	1.1880"/30.175 mm	1.6880"/42.875 mm	Pre-lubed	2
A-W209PPB2	1.7717"/45.000 mm	3.3460"/85.000 mm	1.1880"/30.175 mm	1.1880"/30.175 mm	Pre-lubed	3
A-W209PPB4	1.5350"/39.000 mm	3.3460"/85.000 mm	1.1880"/30.175 mm	1.1880"/30.175 mm	Pre-lubed	3
A-W210PP2	1.9380"/49.225 mm	3.5433"/90.000 mm	1.1880"/30.175 mm	1.1880"/30.175 mm	Pre-lubed	5
A-W210PPB2	1.9380"/49.225 mm	3.5430"/90.000 mm	1.1880"/30.175 mm	1.1880"/30.175 mm	Relubable	3
A-W210PPB5	1.7850"/45.339 mm	3.5430"/90.000 mm	1.1880"/30.175 mm	1.1880"/30.175 mm	Pre-lubed	3
A-W210PP8	1.5300"/38.862 mm	3.5433"/90.000 mm	1.1880"/30.175 mm	1.1880"/30.175 mm	Pre-lubed	5
A-W210PPB9	1.9448"/49.400 mm	3.5433"/90.000 mm	.9055"/23.000 mm	1.4382"/36.530 mm	Pre-lubed	2
A-W211PP2	2.1880"/55.575 mm	3.9370"/100.000 mm	1.3120"/33.325 mm	1.3120"/33.325 mm	Pre-lubed	4
A-W211PPB2	2.1880"/55.575 mm	3.9370"/100.00 mm	1.3120"/33.325 mm	1.3120"/33.325 mm	Pre-lubed	3
A-W211PPB4	2.1880"/55.575 mm	3.9370"/100.000 mm	1.3120"/33.325 mm	2.1870"/55.500 mm	Pre-lubed	6
A-W214PP2	2.7559"/70.000 mm	4.9213"/125.000 mm	1.5620"/39.675 mm	1.5620"/39.675 mm	Pre-lubed	5
A-W214PPB2	2.7559"/70.000 mm	4.9213"/125.000 mm	1.5620"/39.675 mm	1.5620"/39.675 mm	Pre-lubed	3
A-W214PPB9	2.7660"/70.256 mm	4.9213"/125.000 mm	1.1020"/28.000 mm	1.7500"/44.450 mm	Pre-lubed	3

Parts are not Original Equipment parts and are not sponsored, affiliated or otherwise connected with any major brand.

Hvy Disc Bearing, Square Bore, NonRelub.

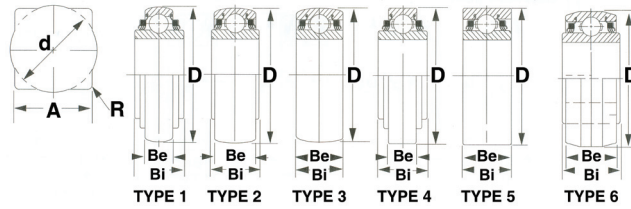

Additional Hvy Disc Bearing, Square Bore, NonRelub.

Part	[Shaft Size]	[Max d]	[A]	[R]	[D]	[Be]	[Bi]	LUBE TYPE
A-W208PP5	1 1/8" / 28.575 mm	1.2360" / 31.394 mm	1.1800" / 29.970 mm	.1000" / 2.540 mm	3.1496" / 80.00 mm	.7090" / 18.000 mm	1.4380" / 36.520 mm	Pre-lubed
A-W208PPB5	1 1/8" / 28.575 mm	1.2360" / 31.394 mm	1.1800" / 29.970 mm	.1000" / 2.540 mm	3.1496" / 80.00 mm	.7090" / 18.000 mm	1.4380" / 36.520 mm	Pre-lubed
A-W208PP6	1" / 25.400 mm	1.0940" / 27.788 mm	1.0300" / 26.162 mm	.1000" / 2.540 mm	3.1496" / 80.000 mm	.7090" / 18.000 mm	1.4380" / 36.520 mm	Pre-lubed
A-W208PPB6	1" / 25.400 mm	1.0940" / 27.788 mm	1.0300" / 26.162 mm	.1000" / 2.540 mm	3.1496" / 80.000 mm	.7090" / 18.000 mm	1.4380" / 36.520 mm	Pre-lubed
A-W208PP8	1 1/8" / 28.575 mm	1.2360" / 31.394 mm	1.1800" / 29.972 mm	.1000" / 2.540 mm	3.1496" / 80.000 mm	1.1880" / 30.175 mm	1.4380" / 36.520 mm	Pre-lubed
A-W208PPB8	1 1/8" / 28.575 mm	1.2360" / 31.394 mm	1.1800" / 29.972 mm	.1000" / 2.540 mm	3.1496" / 80.000 mm	1.1880" / 30.175 mm	1.4380" / 36.520 mm	Pre-lubed
A-W208PPB9	1" / 25.400 mm	1.0940" / 27.7888 mm	1.0300" / 26.162 mm	.1000" / 2.540 mm	3.1496" / 80.000 mm	1.1880" / 30.175 mm	1.4380" / 36.520 mm	Pre-lubed
A-W208PPB11	7/8" / 22.225 mm	.9610" / 24.441 mm	.9050" / 23.000 mm	.1000" / 2.540 mm	3.3760" / 85.750 mm	1.1880" / 30.175 mm	1.4380" / 36.520 mm	Pre-lubed
A-W208PPB12	1 1/8" / 28.575 mm	1.2360" / 31.394 mm	1.1800" / 29.972 mm	.1000" / 2.540 mm	3.3760" / 85.750 mm	1.1880" / 30.175 mm	1.4380" / 36.520 mm	Pre-lubed
A-W208PPB13	7/8" / 22.225 mm	.9610" / 24.441 mm	.9050" / 23.000 mm	.1000" / 2.540 mm	3.1496" / 80.000 mm	.7090" / 18.000 mm	1.4380" / 36.520 mm	Pre-lubed
A-W209PPB5	1 1/4" / 31.750 mm	1.3700" / 34.798 mm	1.2900" / 32.766 mm	.1000" / 2.540 mm	3.3465" / 85.000 mm	1.1880" / 30.175 mm	1.4380" / 36.520 mm	Pre-lubed
A-W209PPB7	1 1/4" / 31.750 mm	1.3700" / 34.798 mm	1.2900" / 32.766 mm	.1000" / 2.540 mm	3.3760" / 85.750 mm	1.1800" / 30.175 mm	1.4375" / 36.510 mm	Pre-lubed
A-W210PP4	1 1/8" / 28.575 mm	1.2360" / 31.394 mm	1.1800" / 29.972 mm	.1000" / 2.540 mm	3.5433" / 90.000 mm	1.1880" / 30.175 mm	1.1880" / 30.175 mm	Pre-lubed
A-W210PPB4	1 1/8" / 28.575 mm	1.2360" / 31.394 mm	1.1800" / 29.972 mm	.1000" / 2.540 mm	3.5433" / 90.000 mm	1.1880" / 30.175 mm	1.1880" / 30.175 mm	Pre-lubed
A-W210PPB6	1 1/8" / 28.575 mm	1.2360" / 31.394 mm	1.1800" / 29.972 mm	.1000" / 2.540 mm	3.5433" / 90.000 mm	1.1880" / 30.175 mm	1.4380" / 36.520 mm	Pre-lubed
A-W211PP3	1 1/2" / 38.100 mm	1.6220" / 41.199 mm	1.5311" / 38.890 mm	.1000" / 2.540 mm	3.9370" / 100.000 mm	1.3120" / 33.324 mm	1.3120" / 33.324 mm	Pre-lubed
A-W211PPB3	1 1/2" / 38.100 mm	1.6220" / 41.199 mm	1.5311" / 38.890 mm	.1000" / 2.540 mm	3.9370" / 100.000 mm	1.3120" / 33.324 mm	1.3120" / 33.324 mm	Pre-lubed
A-W211PP5	1 1/2" / 38.100 mm	1.6220" / 41.199 mm	1.5311" / 38.890 mm	.1000" / 2.540 mm	4.0000" / 101.600 mm	1.4380" / 36.520 mm	1.7500" / 44.450 mm	Pre-lubed
A-W211PPB6	1 1/2" / 38.100 mm	1.6220" / 41.199 mm	1.5311" / 38.890 mm	.1000" / 2.540 mm	4.0770" / 103.556 mm	1.4380" / 36.520 mm	1.7500" / 44.450 mm	Pre-lubed

Parts are not Original Equipment parts and are not sponsored, affiliated or otherwise connected with any major brand.

BEARINGS

Hvy Disc Bearing, Round Bore, Relub.

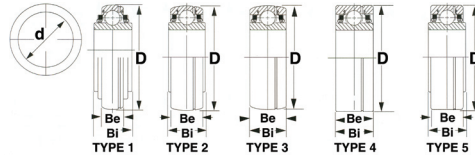

Additional Hvy Disc Bearing, Round Bore, Relub.

Part	[d]	[D]	[Be]	[Bi]	LUBE TYPE	BRG TYPE
A-GW209PPB2	1.7717" / 45.000 mm	3.3465" / 85.000 mm	1.1880" / 30.175 mm	1.1880" / 30.175 mm	Relubable 3	
A-GW209PPB4	1.5350" / 39.000 mm	3.3465" / 85.000 mm	1.1880" / 30.175 mm	1.1880" / 30.175 mm	Relubable 3	
A-GW209PPB11	1.7810" / 45.237 mm	3.3465" / 85.000 mm	.8660" / 22.000 mm	1.4380" / 36.525 mm	Relubable 1	
A-GW210PPB2	1.9380" / 49.225 mm	3.5433" / 90.000 mm	1.1880" / 30.175 mm	1.1880" / 30.175 mm	Relubable 3	
A-GW210PPB5	1.7850" / 45.339 mm	3.5433" / 90.000 mm	1.1880" / 30.175 mm	1.1880" / 30.175 mm	Relubable 3	
A-GW210PP9	1.9450" / 49.403 mm	3.5433" / 90.000 mm	.9060" / 23.000 mm	1.4380" / 36.525 mm	Relubable 5	
A-GW211PP2	2.1880" / 55.575 mm	3.9370" / 100.000 mm	1.3120" / 33.325 mm	1.3120" / 33.325 mm	Relubable 1	
A-GW211PPB2	2.1880" / 55.575 mm	3.9370" / 100.000 mm	1.3120" / 33.325 mm	1.3120" / 33.325 mm	Relubable 3	
A-GW211PPB8	2.1880" / 55.575 mm	3.9370" / 100.000 mm	.9840" / 25.000 mm	1.3120" / 33.325 mm	Relubable 1	
A-GW211PPB9	2.1950" / 55.753 mm	3.9370" / 100.000 mm	.9840" / 25.000 mm	1.5620" / 39.657 mm	Relubable 1	
A-GW211PPB10	1.9380" / 49.225 mm	3.9370" / 100.000 mm	1.3120" / 33.325 mm	1.3120" / 33.325 mm	Relubable 3	
A-GW211PPB13	1.7850" / 45.339 mm	3.9370" / 100.000 mm	.9840" / 25.000 mm	1.3120" / 33.325 mm	Relubable 1	
A-GW211PPB14	2.0150" / 51.181 mm	3.9370" / 100.000 mm	.9840" / 25.000 mm	1.3120" / 33.325 mm	Relubable 1	
A-GW211PP25	1.7800" / 45.212 mm	3.9370" / 100.000 mm	1.3120" / 33.325 mm	1.7500" / 44.450 mm	Relubable 5	
A-GW214PP2	2.7559" / 70.000 mm	4.9213" / 125.000 mm	1.5620" / 39.675 mm	1.5620" / 39.675 mm	Relubable 4	
A-GW214PPB2	2.7559" / 70.000 mm	4.9213" / 125.000 mm	1.5620" / 39.675 mm	1.5620" / 39.675 mm	Relubable 3	
A-GW214PPB3	1.9380" / 49.225 mm	4.9213" / 125.000 mm	1.5620" / 39.675 mm	1.5620" / 39.675 mm	Relubable 3	
A-GW214PPB5	2.7559" / 70.000 mm	4.9213" / 125.000 mm	1.5620" / 39.675 mm	2.4380" / 61.925 mm	Relubable 2	
A-GW214PPB6	2.6881" / 68.278 mm	4.9213" / 125.000 mm	1.1024" / 28.000 mm	2.6875" / 68.263 mm	Relubable 1	

Hvy Disc Bearing, Square Bore, Relub.

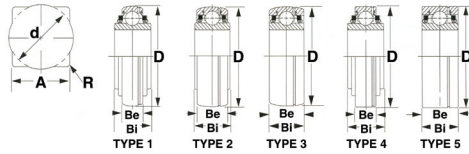

Additional Hvy Disc Bearing, Square Bore, Relub.

Part	[Shaft Size]	[Max d]	[A]	[R]	[D]	[Be]	[Bi]	LUBE TYPE
A-GW208PPB5	1 1/8" / 28.575 mm	1.2360" / 31.394 mm	1.1800" / 29.972 mm	.1000" / 2.540 mm	3.1496" / 80.000 mm	.8270" / 21.000 mm	1.4380" / 36.525	Relubable
A-GW208PPB6	1" / 25.400 mm	1.0940" / 27.788 mm	1.0300" / 26.162 mm	.1000" / 2.540 mm	3.1496" / 80.000 mm	.8270" / 21.000 mm	1.4380" / 36.525 mm	Relubable
A-GW208PPB8	1 1/8" / 28.575 mm	1.2360" / 31.394 mm	1.1800" / 29.972 mm	.1000" / 2.540 mm	3.1496" / 80.000 mm	1.1880" / 30.175 mm	1.4380" / 36.525 mm	Relubable
A-GW208PP17	1 1/8" / 28.575 mm	1.2360" / 31.394 mm	1.1800" / 29.972 mm	.1000" / 2.540 mm	3.3755" / 85.738 mm	1.1880" / 30.175 mm	1.4380" / 36.525 mm	Relubable
A-GW208PPB17	1 1/8" / 28.575 mm	1.2360" / 31.394 mm	1.1800" / 29.972 mm	.1000" / 2.540 mm	3.3755" / 85.738 mm	1.1880" / 30.175	1.4380" / 36.525	Relubable
A-GW209PPB5	1 1/4" / 31.750 mm	1.3700" / 34.798 mm	1.2900" / 32.776 mm	.1000" / 2.540 mm	3.3465" / 85.000 mm	1.1880" / 30.175 mm	1.4380" / 36.525 mm	Relubable
A-GW209PPB8	1 1/4" / 31.750 mm	1.3700" / 34.798 mm	1.2900" / 32.776 mm	.1000" / 2.540 mm	3.3465" / 85.000 mm	.8660" / 22.000 mm	1.4380" / 36.525	Relubable
A-GW210PP4	1 1/8" / 28.575 mm	1.2360" / 31.394 mm	1.1800" / 29.972 mm	.1000" / 2.540 mm	3.5433" / 90.000 mm	1.1880" / 30.175 mm	1.1880" / 30.175 mm	Relubable
A-GW210PPB4	1 1/8" / 28.575 mm	1.2360" / 31.394 mm	1.1800" / 29.972 mm	.1000" / 2.540 mm	3.5433" / 90.000 mm	1.1880" / 30.175 mm	1.1880" / 30.175 mm	Relubable
A-GW211PP3	1 1/2" / 38.100 mm	1.6220" / 41.199 mm	1.5311" / 39.890 mm	.1000" / 2.540 mm	3.9370" / 100.000 mm	1.3120" / 33.325 mm	1.3120" / 33.325 mm	Relubable
A-GW211PPB3	1 1/2" / 38.100 mm	1.6220" / 41.199 mm	1.5311" / 38.890 mm	.1000" / 2.540 mm	3.9370" / 100.000 mm	1.3120" / 33.325 mm	1.3120" / 33.325 mm	Relubable
A-GW211PP5	1 1/2" / 38.100 mm	1.6220" / 41.199 mm	1.5311" / 38.890 mm	.1000" / 2.540 mm	4.000" / 101.600 mm	1.4380" / 36.525 mm	1.7500" / 44.450 mm	Relubable
A-GW211PP17	1 1/2" / 38.100 mm	1.6220" / 41.199 mm	1.5311" / 38.890 mm	.1000" / 2.540 mm	3.9370" / 100.000 mm	1.3120" / 33.325 mm	1.7500" / 44.450 mm	Relubable
A-GW211PPB17	1 1/2" / 38.100 mm	1.6220" / 41.199 mm	1.5311" / 38.890 mm	.1000" / 2.540 mm	3.9370" / 100.000 mm	1.3120" / 33.325 mm	1.7500" / 44.450 mm	Relubable
A-GW214PPB4	2" / 50.800 mm	2.1610" / 54.889 mm	2.0551" / 52.200 mm	.1000" / 2.540 mm	4.9213" / 125.000 mm	1.5620" / 39.675 mm	1.5620" / 39.675 mm	Relubable
A-GW216PP2	2 1/4" / 57.150 mm	2.6850" / 68.200 mm	2.3150" / 58.800 mm	.1000" / 2.540 mm	5.5118" / 140.000 mm	1.1810" / 30.000 mm	2.5000" / 63.500 mm	Relubable

Parts are not Original Equipment parts and are not sponsored, affiliated or otherwise connected with any major brand.

BEARINGS

HP Spherical Prelubed Hex Bore Bearing

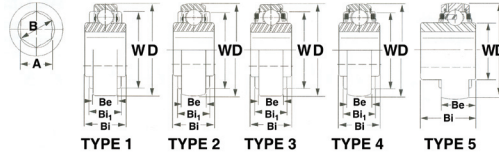

HP Spherical Prelubed Hex Bore Bearing

Part	[Hex Shaft Size]	[B]	[A]	[D]	[Be]	[Bi]	[W]	LUBE TYPE
A-202KRR3	9/16"	.6480" / 16.459 mm	.5630" / 14.300 mm	1.3780" / 35.000 mm	.4330" / 11.000 mm	.5120" / 13.000 mm	.9720" / 24.689 mm	Pre-lubed
A-204KPP2	11/16"	.7960" / 20.218 mm	.6950" / 17.653 mm	1.8504" / 47.000 mm	.5510" / 14.000 mm	.8250" / 20.955 mm	1.1340" / 28.804 mm	Pre-lubed
A-204KRR2	11/16"	.7960" / 20.218 mm	.6950" / 17.653 mm	1.8504" / 47.000 mm	.5510" / 14.000 mm	.8250" / 20.955 mm	1.1340" / 28.804 mm	Pre-lubed
A-204KRRB2	11/16"	.7960" / 20.218 mm	.6950" / 17.653 mm	1.8504" / 47.000 mm	.5510" / 14.000 mm	.8250" / 20.955 mm	1.1340" / 28.804 mm	Pre-lubed
A-205KPP2	7/8"	1.0100" / 25.654 mm	.8760" / 22.250 mm	2.0472" / 52.000 mm	.5910" / 15.000 mm	1.000" / 25.400 mm	1.3340" / 33.883 mm	Pre-lubed
A-205KRR2	7/8"	1.0100" / 25.654 mm	.8760" / 22.250 mm	2.0472" / 52.000 mm	.5910" / 15.000 mm	1.000" / 25.400 mm	1.3340" / 33.883 mm	Pre-lubed
A-205KPPB2	7/8"	1.0100" / 25.654 mm	.8760" / 22.250 mm	2.0472" / 52.000 mm	.5910" / 15.000 mm	1.000" / 25.400 mm	1.3340" / 33.883 mm	Pre-lubed
A-205KRRB2	7/8"	1.0100" / 25.654 mm	.8760" / 22.250 mm	2.0472" / 52.000 mm	.5910" / 15.000 mm	1.000" / 25.400 mm	1.3340" / 33.883 mm	Pre-lubed
A-206KRR6	1"	1.1520" / 29.261 mm	1.0010" / 25.425 mm	2.4409" / 62.000 mm	.6300" / 16.000 mm	.9450" / 24.000 mm	1.5940" / 40.488 mm	Pre-lubed
A-206KRRB6	1"	1.1520" / 29.261 mm	1.0010" / 25.425 mm	2.4409" / 62.000 mm	.6300" / 16.000 mm	.9450" / 24.000 mm	1.5940" / 40.488 mm	Pre-lubed
A-G207KPPB2	1 1/8"	1.2980" / 32.969 mm	1.1260" / 28.600 mm	2.8346" / 72.000 mm	.7480" / 19.000 mm	1.4840" / 37.694 mm	1.8430" / 46.812 mm	Relubricable
A-207KRRB9	1 1/8"	1.2980" / 32.969 mm	1.1260" / 28.600 mm	2.8346" / 72.000 mm	.6690" / 17.000 mm	1.4840" / 37.694 mm	1.8430" / 46.812 mm	Pre-lubed
A-207KRRB12	1 1/8"	1.2980" / 32.969 mm	1.1260" / 28.600 mm	2.8346" / 72.000 mm	.6690" / 17.000 mm	.9840" / 25.000 mm	1.8430" / 46.812 mm	Pre-lubed
A-GW208PPB22	1 1/4"	1.4500" / 36.830 mm	1.2510" / 31.877 mm	3.1496" / 80.000 mm	.8270" / 21.000 mm	1.4380" / 36.520 mm	2.0840" / 52.934 mm	
A-W208KRRB6	1 3/8"	1.5870" / 40.301 mm	1.3760" / 34.950 mm	3.1496" / 80.000 mm	.8270" / 21.000 mm	1.4380" / 36.520 mm	2.0840" / 52.934 mm	Pre-lubed
A-W208PPB16	1 1/4"	1.4500" / 36.652 mm	1.2510" / 31.775 mm	3.1496" / 80.000 mm	.7090" / 18.000 mm	1.4380" / 36.520 mm	2.0840" / 52.934 mm	Pre-lubed
A-G209KPPB2	1 1/2"	1.7300" / 43.942 mm	1.5010" / 38.125 mm	3.3465" / 85.000 mm	.7480" / 19.000 mm	1.1810" / 30.000 mm	2.3050" / 58.547 mm	Relubricable
A-209KRRB2	1 1/2"	1.7300" / 43.942 mm	1.5010" / 38.125 mm	3.3465" / 85.000 mm	.7480" / 19.000 mm	1.1810" / 30.000 mm	2.3050" / 58.547 mm	Pre-lubed
A-GC21132NLC	1 3/4"	2.0200" / 51.308 mm	1.7510" / 44.475 mm	3.9370" / 100.000 mm	.9840" / 25.000 mm	2.2500" / 57.150 mm	2.7461" / 69.750 mm	Relubricable

BEARINGS

Parts are not Original Equipment parts and are not sponsored, affiliated or otherwise connected with any major brand.

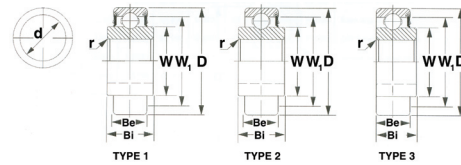

200 Series

Part	[d]	[D]	[Bi]	[Be]	[W]	[W1]	[r]	BRG TYPE
A-203KR2	.6253" / 15.883 mm	1.5748" / 40.000 mm	.5510" / 14.000 mm	.4724" / 12.000 mm	.9620" / 24.435 mm	-	.024" / .610 mm	3
A-BB203KRR2	.640" / 16.260 mm	1.5748" / 40.000 mm	.7200" / 18.288 mm	.4724" / 12.000 mm	.9620" / 24.435 mm	-	.024" / .610 mm	1
A-203KRR2	.6400" / 16.260 mm	1.5748" / 40.000 mm	.7200" / 18.288 mm	.4724" / 12.000 mm	.9620" / 24.435 mm	-	.024" / .610 mm	1
A-203KKRR2FD	.6400" / 16.260 mm	1.5748" / 40.000 mm	.7200" / 18.288 mm	.4724" / 12.000 mm	.9620" / 24.435 mm	-	.024" / .610 mm	-
A-203KRR5	.5150" / 13.081 mm	1.5748" / 40.000 mm	.7200" / 18.288 mm	.4724" / 12.000 mm	.9620" / 24.435 mm	-	.024" / .610 mm	1
A-203KRR7	.6693" / 17.000 mm	1.5748" / 40.000 mm	.6540" / 16.612 mm	.4724" / 12.000 mm	.9620" / 24.435 mm	-	.024" / .610 mm	1
A-204KR2	.7505" / 19.063 mm	1.7805" / 45.225 mm	.6100" / 15.494 mm	.6100" / 15.494 mm	1.1310" / 28.727 mm	-	.039" / .991 mm	
A-204KRR3	.7874" / 20.000 mm	1.8504" / 47.000 mm	.6990" / 17.755 mm	.5510" / 14.000 mm	1.1310" / 28.727 mm	-	.039" / .991 mm	
A-205KR4	1.0005" / 25.413 mm	2.0472" / 52.000 mm	1.0000" / 25.400 mm	.5910" / 15.000 mm	1.3310" / 33.807 mm	1.6800" / 42.672 mm	.039" / .991 mm	
A-206KR7	1.1811" / 30.000 mm	2.4409" / 62.000 mm	.9450" / 24.000 mm	.6300" / 16.000 mm	1.5860" / 40.284 mm	2.0500" / 52.070 mm	.039" / .991 mm	
A-206KRR8	1.1811" / 30.000 mm	2.4409" / 62.000 mm	.9450" / 24.000 mm	.6300" / 16.000 mm	1.5390" / 39.091 mm	2.0500" / 52.070 mm	.039" / .991 mm	
A-207KRR	1.3780" / 35.000 mm	2.8346" / 72.000 mm	.9840" / 25.000 mm	.6690" / 17.000 mm	1.8480" / 46.939 mm	2.3760" / 60.350 mm	.039" / .991 mm	1
A-208KRR2	1.5748" / 40.000 mm	3.1496" / 80.000 mm	1.0630" / 27.000 mm	.8270" / 21.000 mm	2.0570" / 52.248 mm	2.6950" / 68.453 mm	.039" / .991 mm	1

22 Series Spherical O.D.

Part	Description	[d]	[D]	[W]	[rs min]
A-62022RST22	Bearing	.5906" / 15.000 mm	1.3780" / 35.000 mm	.4331" / 11.000 mm	.0236" / .600 mm
A-62032RST22	Bearing	.6693" / 17.000 mm	1.5748" / 40.000 mm	.4724" / 12.000 mm	.0236" / .600 mm
A-62042RST22	Bearing	.7874" / 20.000 mm	1.8504" / 47.000 mm	.5512" / 14.000 mm	.0394" / 1.000 mm
A-62052RST22	Bearing	.9843" / 25.000 mm	2.0472" / 52.000 mm	.5906" / 15.000 mm	.0394" / 1.000 mm
A-62062RST22	Bearing	1.1811" / 30.000 mm	2.4409" / 62.000 mm	.6299" / 16.000 mm	.0394" / 1.000 mm
A-62072RST22	Bearing	1.378" / 35.000 mm	2.8346" / 72.000 mm	.6693" / 17.000 mm	.0433" / 1.100 mm
A-62082RST22	Bearing	1.5748" / 4.000 mm	3.1496" / 80.000 mm	.7087" / 18.000 mm	.0433" / 1.100 mm
A-62092RST22	Bearing	1.7717" / 45.000 mm	3.3465" / 85.000 mm	.7480" / 19.000 mm	.0433" / 1.100 mm
A-62102RST22	Bearing	1.9685" / 50.000 mm	3.5433" / 90.000 mm	.7874" / 20.000 mm	.0433" / 1.100 mm
A-63052RST22	Bearing	.9843" / 25.000 mm	2.4409" / 62.000 mm	.6693" / 17.000 mm	.0433" / 1.100 mm
A-63062RST22	Bearing	1.1811" / 30.000 mm	2.8346" / 72.000 mm	.7480" / 19.000 mm	.0433" / 1.100 mm
A-63072RST22	Bearing	1.3780" / 35.000 mm	3.1496" / 80.000 mm	.8268" / 21.000 mm	.0591" / 1.500 mm
A-63082RST22	Bearing	1.5748" / 40.000 mm	3.5433" / 90.000 mm	.9055" / 23.000 mm	.0591" / 1.500 mm
A-63092RST22	Bearing	1.7717" / 45.000 mm	3.9370" / 100.000 mm	.9843" / 25.000 mm	.0591" / 1.500 mm
A-63102RST22	Bearing	1.9685" / 50.000 mm	4.3307" / 110.000 mm	1.0630" / 27.000 mm	.0787" / 2.000 mm

Parts are not Original Equipment parts and are not sponsored, affiliated or otherwise connected with any major brand.

BEARINGS

Cam Follower Bearings

Cam Follower Bearings

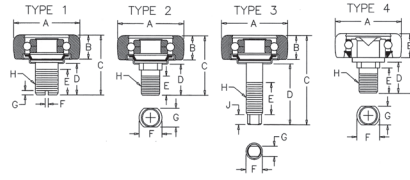

Part	Description	BRG TYPE	[A]	[B]	[C]	[D]	[E]	[F]	[G]
A-CF108S4F6	Cam Follower Bearing	3	1.50	0.625	1.40625	0.78125	0.375 24 UNF2A	0.50 HEX	-
A-CF108S10F	Cam Follower Bearing	4	1.50	0.625	1.75	0.8125	0.50 20 UNF2A	-	-
A-CF110S8F10	Cam Follower Bearing	6	1.625	0.875	1.1875	0.75	0.83 18 UNF2A	-	-
A-CF6888	Cam Follower Bearing	4	1.75	0.75	1.71875	0.75	.375-.378	-	-
A-CF7811E	Cam Follower Bearing	3	1.50	0.625	2.03125	1.0625	0.50 20 UNF2A	0.3125 HEX	-
A-CF7811	Cam Follower Bearing	3	1.5	0.625	2.03125	1.0625	0.50 20 UNF2A	0.3125 HEX	-
A-CF9727	Cam Follower Bearing	7	1.75	0.75	2.125	1	0.50 20 UNF2A	0.3125 HEX	-

Plunger Roller Bearings

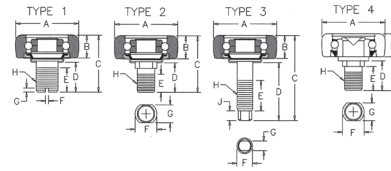

Part	Description	BRG TYPE	[A]	[B]	[C]	[D]	[E]	[F]	[G]
A-6901P	Plunger Roller Bearing	4	2.5	0.888	2.25	1.15625	0.8125	1	0.75
A-6901PA	Plunger Roller Bearing	4	2.5	0.888	2.25	1.15625	0.8125	1	0.75
A-6901PW	Plunger Roller Bearing	4	2.5	1.125	2.484375	1.15625	0.8125	1	0.75
A-6901M	Plunger Roller Bearing	2	2.5	0.888	2.25	1.15625	0.8125	1	0.795
A-6901S	Plunger Roller Bearing	2	2.5	0.888	2.25	1.1875	0.8125	1	0.75
A-PR6956	Plunger Roller Bearing	1	2.5	0.888	2.21875	1.166	0.9375	0.157	0.16

CDC Rubber Mounted Disc Harrow Bearings

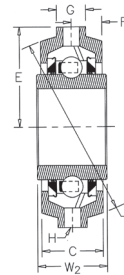

Part	Description	[d BORE]	BRG INSERT	[W2]	[C]	[D]	[E]	[F]	[G]
A-CDS209TTR6P	CDC Rubber Mtd Disc Bearing	1.5	DS209TTR6P	1.6875	1.565	4	2.152	0.78	0.75
A-CDS211TTR23	CDC Rubber Mtd Disc Bearing	1.75	DS211TTR23	2.125	1.792	4.438	2.375	0.894	0.75
A-CDS211TTR25	CDC Rubber Mtd Disc Bearing	1.78	DS211TTR25	2.125	1.769	4.438	2.375	0.88	0.75

Parts are not Original Equipment parts and are not sponsored, affiliated or otherwise connected with any major brand.

Tine Bar Bearings

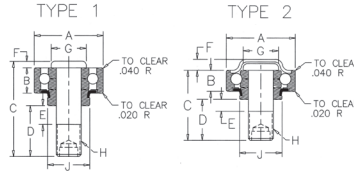

Part	Description	BRG TYPE	[A]	[B]	[C]	[D]	[E]	[F]	[G]
A-TB7890	Tine Bar Bearings	1	1.8504	0.551	2.125	1.3125	0.375	0.207	1.08
A-7890A	Tine Bar Bearings	1	1.8504	0.551	2.35	1.296875	0.5625	0.21	1.12
A-8821	Tine Bar Bearings	2	1.8504	0.551	2.125	1.3125	0.375	0.3	1.438

2 Bolt Flangette For Self-Aligning Bearing

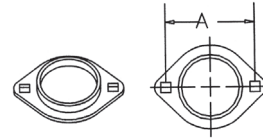

Part	Description	[OD]	[A]
A-F240	2 Bolt Flange	40mm	2.5"
A-F247	2 Bolt Flange	47mm	2.812"
A-F252	2 Bolt Flange	52mm	3"
A-F262	2 Bolt Flange	62mm	3.562"
A-F272	2 Bolt Flange	72mm	3.937"
A-F285	2 Bolt Flange	85mm	3.937"
A-F290	2 Bolt Flange	90mm	3.937"

3 Bolt Flangette For Self-Align

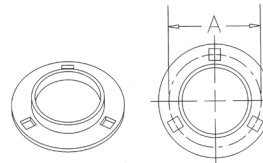

Part	Description	[OD]	[A]
A-F340	3 Bolt Flange	40mm	2.5"
A-F347	3 Bolt Flange	47mm	2.812"
A-F352	3 Bolt Flange	52mm	3"
A-F362	3 Bolt Flange	62mm	3.562"
A-F372	3 Bolt Flange	72mm	3.937"

Relub. 3 Bolt Flangette For Self-Align

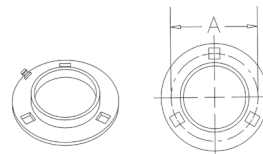

Part	Description	[OD]	[A]
A-F3Z52	Relubricatable 3 Bolt Flange	52mm	3"
A-F3Z62	Relubricatable 3 Bolt Flange	62mm	3.562"
A-F3Z72	Relubricatable 3 Bolt Flange	72mm	3.937"

Parts are not Original Equipment parts and are not sponsored, affiliated or otherwise connected with any major brand.

BEARINGS

3 Triangular Bolt Flangette For Self-Align

3 Triangular Bolt Flangette For Self-Align

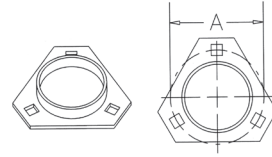

Part	Description	[OD]	[A]
A-FTR340	3 Bolt Triangular Flange	40mm	2.5"
A-FTR347	3 Bolt Triangular Flange	47mm	2.812"
A-FTR352	3 Bolt Triangular Flange	52mm	3"
A-FTR362	3 Bolt Triangular Flange	62mm	3.562"
A-62MM-3GPZP	3 Bolt Flange, Relubeable		
A-62MM-3GZP	3 Bolt Flange, Relubeable		
A-H103265	3 Bolt Triangular Flange	72mm	3.937"

4 Bolt Round Flangette For Self-Align

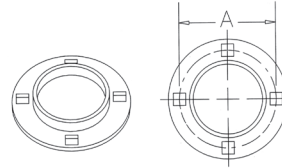

Part	Description	[OD]	[A]
A-F480	4 Bolt Round Flange	80mm	4.687"
A-F485	4 Bolt Round Flange	85mm	4.750"
A-F487	4 Bolt Round Flange	87mm Special	4.750"
A-F490	4 Bolt Round Flange	90mm Domestic	5"
A-F4100	4 Bolt Round Flange	100mm	5.438"

Relub. 4 Bolt Round Flangette For Self-Align

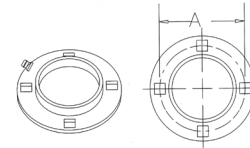

Part	Description	[OD]	[A]
A-F4Z80	Relubricatable 4 Bolt Flange	80mm	4.687"
A-F4Z85	Relubricatable 4 Bolt Flange	85mm	4.750"
A-F4Z90	Relubricatable 4 Bolt Flange	90mm	5"
A-F4Z100	Relubricatable 4 Bolt Flange	100mm	5.438"
A-G52MSA	Bearing Flange		

Pressed Steel Pillow Block Flangette

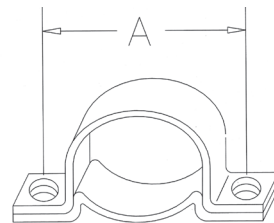

Part	Description	[OD]	[A]
A-PB40	Pressed Steel Pillow Block	40mm	2.656"
A-PB47	Pressed Steel Pillow Block	47mm	3"
A-PB52	Pressed Steel Pillow Block	52mm	3.406"
A-PB62	Pressed Steel Pillow Block	62mm	3.812"

Parts are not Original Equipment parts and are not sponsored, affiliated or otherwise connected with any major brand.



Parts are not Original Equipment parts and are not sponsored, affiliated or otherwise connected with any major brand.

PART	DESCRIPTION	PART	DESCRIPTION	PART	DESCRIPTION
A-107	Ball Bearing	A-307FF	Ball Bearing	A-NPS014RPC	Bearing
A-108FFL	Ball Bearing	A-307SS	Ball Bearing	A-NPS014RRC	Bearing
A-108FFN	Ball Bearing	A-310	Ball Bearing	A-NT3055	Bearing
A-109L	Ball Bearing	A-311	Ball Bearing	A-P6361	Bearing
A-110S	Ball Bearing	A-499502H	Ball Bearing	A-P6362	Bearing
A-1206	Ball Bearing	A-88016	Ball Bearing	A-PR6901	Bearing
A-1208L	Ball Bearing	A-88107	Ball Bearing	A-R16SS	Bearing
A-1208SS	Ball Bearing	A-8980DD	Ball Bearing	A-RA008NPPB	Bearing
A-1210SSL	Ball Bearing	A-8984YY	Ball Bearing	A-RA010NPPB	Bearing
A-202CC1	Ball Bearing	A-S204FF	Ball Bearing	A-RA012NPPB	Bearing
A-202FFB	Ball Bearing	A-S305FF	Ball Bearing	A-RA014NPPB	Bearing
A-202FFH8	Ball Bearing	A-1210A	Bearing	A-RA100NPP	Bearing
A-202FFLB	Ball Bearing	A-1211B	Bearing	A-RA102NPPB	Bearing
A-202NPP9	Ball Bearing	A-15385TIM	Bearing	A-RA103NPPB	Bearing
A-202RRE	Ball Bearing	A-15520B	Bearing	A-RA103NPPB2	Bearing
A-202SS	Ball Bearing	A-1621DC	Bearing	A-RA104NPPB	Bearing
A-203	Ball Bearing	A-17520B	Bearing	A-RA106NPPB	Bearing
A-203RRH10	Ball Bearing	A-203S	Bearing	A-RA107NPPB	Bearing
A-204	Ball Bearing	A-205PP9	IBearing	A-RA108NPP	Bearing
A-204BBAR	Ball Bearing	A-25581	Bearing	A-RA108NPPB	Bearing
A-204BBE	Ball Bearing	A-2785	Bearing	A-RA112NPPB	Bearing
A-204F	Ball Bearing	A-30206	Bearing	A-T113	Bearing
A-204KRD4	Ball Bearing	A-37625	Bearing	A-VPH4213	Bearing
A-204KRR8	Ball Bearing	A-3920E	Bearing	A-WC87504	Bearing
A-204SS	Ball Bearing	A-3975	Bearing	A-WPS100GPA	Bearing
A-205	Ball Bearing	A-497A	Bearing	A-UCFU134	4-Bolt, 1 3/4" Sq. Flange
A-205PPB7	Ball Bearing	A-53375	Bearing	A-UCFU2	4-Bolt, 2" Square Flange
A-205RHN	Ball Bearing	A-55517230	Bearing	A-8H211	Pillow Blk Brg
A-205RRAN	Ball Bearing	A-60072RSC3	Bearing	A-8H309	Pillow Blk Brg
A-205S	Ball Bearing	A-62032RS	Bearing	A-FDT2316R	Pillow Blk Brg
A-205TTH	Ball Bearing	A-6208C3	Bearing	A-PWG11116R	Pillow Blk Brg
A-206	Ball Bearing	A-6305ZZ	Bearing	A-PWG1316RM	Pillow Blk Brg
A-206FF	Ball Bearing	A-63072RSC3	Bearing	A-PWG158R	Pillow Blk Brg
A-206KRRB	Ball Bearing	A-88128RA	Bearing	A-PWG2316R	Pillow Blk Brg
A-206L	Ball Bearing	A-88508	Bearing	A-RAK1	Pillow Blk Imp
A-206RRMN	Ball Bearing	A-8851651	Bearing	A-RAK112	Pillow Blk Imp
A-206SS	Ball Bearing	A-BB203KRR2FD	Bearing	A-RAK114	Pillow Blk Imp
A-207	Ball Bearing	A-GRA014NPPB	Bearing	A-RAK1316	Pillow Blk Imp
A-207L	Ball Bearing	A-GRA100NPPB	Bearing	A-RAK138	Pillow Blk Imp
A-207SS	Ball Bearing	A-GRA102NPPB	Bearing	A-RAK2	Pillow Blk Imp
A-208	Ball Bearing	A-GRA103NPPB	Bearing	A-RAK78	Pillow Blk Imp
A-208FF	Ball Bearing	A-GRA104NPPB	Bearing	A-RCJ11516	Pillow Blk Imp
A-208L	Ball Bearing	A-GRA106NPPB	Bearing	A-TNR1316RM	Pillow Blk Brg
A-208SS	Ball Bearing	A-GRA107NPPB	Bearing	A-385SD	Disc Bearing
A-209	Ball Bearing	A-GRA108NPPB	Bearing	A-DC208TT2	Disc Bearing
A-210	Ball Bearing	A-HPC104TPA	Bearing	A-FD209RMIMP	Disc Bearing
A-210S	Ball Bearing	A-HPS108GPH	Bearing	A-GW211PPB23	Disc Bearing
A-210SS	Ball Bearing	A-LM48548XL	Bearing	A-LM501334SD	Disc Bearing
A-212	Ball Bearing	A-LM603014	Bearing	A-W208PPB6S	Disc Bearing
A-212CC	Ball Bearing	A-LM814810	Bearing	A-1640	Pilot Bearing
A-302CC	Ball Bearing	A-LM814849	Bearing	A-6003	Pilot Bearing
A-304SS	Ball Bearing	A-M1306EL	Bearing	A-7109	Pilot Bearing
A-305	Ball Bearing	A-MU1205L	Bearing	A-9009	Pilot Bearing
A-306	Ball Bearing	A-MU1305TDM	Bearing	A-N018	Release Bearing

BEARINGS



Misc Bearings

PART	DESCRIPTION	PART	DESCRIPTION	PART	DESCRIPTION
A-02007495	Ball Bearing				
A-N1495	Release Bearing				
A-N215	Release Bearing				
A-N3753	Release Bearing				
A-N3804	Release Bearing				
A-R24	Pilot Bearing				

BEARINGS

Parts are not Original Equipment parts and are not sponsored, affiliated or otherwise connected with any major brand.

Tapered Roller Bearing

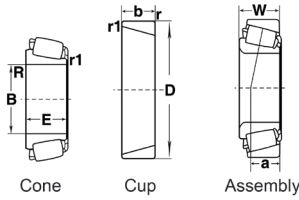

Parts are not Original Equipment parts and are not sponsored, affiliated or otherwise connected with any major brand.

BEARINGS

Part	Description	[B]	[E]	[R]	[D]	[b]	[r]	[W]
A-342A	Taper Cone	1.625 (41.275)	1.180 (29.977)	.14 (3.5)				
A-332A	Tapered Cup				3.149 (80.000)	.827 (21.000)	.09 (2.3)	.952 (24.176)
A-342S	Taper Cone	1.688 (42.875)	0.882 (22.403)	.14 (3.5)				
A-332A	Tapered Cup				3.149 (80.000)	.827 (21.000)	.09 (2.3)	.952 (24.176)
A-355X	Taper Cone	1.750 (44.450)	0.854 (21.692)	.14 (3.5)				
A-354A	Tapered Cup				3.347 (85.000)	.688 (17.462)	.05 (1.3)	.813 (20.638)
A-366BR	Taper Cone	1.969 (49.999)	0.875 (22.225)	0.09 (2.3)				
A-362	Tapered Cup				3.543 (90.000)	.625 (15.875)	.08 (2.0)	.787 (20.000)
A-368	Taper Cone	2 (50.8)	0.875 (22.225)	0.06 (1.5)				
A-362A	Tapered Cup				3.500 (88.900)	.650 (16.513)	.05 (1.3)	.813 (20.638)
A-368A	Taper Cone	2 (50.8)	0.875 (22.225)	.14 (3.5)				
A-363	Tapered Cup				3.543 (90.000)	.787 (20.000)	.03 (0.8)	.787 (20.000)
A-369A	Taper Cone	1.875 (47.625)	0.875 (22.225)	.14 (3.5)				
A-363	Tapered Cup				3.543 (90.000)	.787 (20.000)	.03 (0.8)	.787 (20.000)
A-370A	Taper Cone	2 (50.8)	0.875 (22.225)	0.2 (5)				
A-363	Tapered Cup				3.543 (90.000)	.787 (20.000)	.03 (0.8)	.787 (20.000)
A-386A	Taper Cone	1.875 (47.625)	0.864 (21.946)	0.03 (0.8)				
A-383A	Tapered Cup				3.937 (100.000)	.702 (17.826)	.08 (2.0)	.827 (21.000)
A-387A	Taper Cone	2.25 (57.15)	0.864 (21.946)	.14 (3.5)				
A-383A	Tapered Cup				3.937 (100.000)	.702 (17.826)	.08 (2.0)	.827 (21.000)
A-387S	Taper Cone	2.25 (57.15)	0.864 (21.946)	0.03 (0.8)				
A-383A	Tapered Cup				3.937 (100.000)	.702 (17.826)	.08 (2.0)	.827 (21.000)
A-387	Taper Cone	2.25 (57.15)	0.864 (21.946)	0.09 (2.3)				
A-383A	Tapered Cup				3.937 (100.000)	.702 (17.826)	.08 (2.0)	.827 (21.000)
A-395A	Taper Cone	2.625 (66.675)	0.866 (21.996)	0.03 (0.8)				
A-394AS	Tapered Cup				4.331 (110.000)	.741 (18.824)	.13 (3.3)	.866 (22.000)
A-395S	Taper Cone	2.625 (66.675)	0.866 (21.996)	.14 (3.5)				
A-394AS	Tapered Cup				4.331 (110.000)	.741 (18.824)	.13 (3.3)	.866 (22.000)
A-399A	Taper Cone	2.688 (68.263)	0.866 (21.996)	0.09 (2.3)				
A-394AS	Tapered Cup				4.331 (110.000)	.741 (18.824)	.13 (3.3)	.866 (22.000)
A-420	Taper Cone	1.575 (39.999)	1.145 (29.083)	.14 (3.5)				
A-414	Tapered Cup				3.484 (88.500)	.875 (22.225)	.06 (1.5)	1.063 (26.988)
A-462	Taper Cone	2.25 (57.15)	1.154 (29.317)	0.09 (2.3)				
A-453X	Tapered Cup				4.125 (104.775)	.969 (24.605)	.13 (3.3)	1.188 (30.162)
A-469	Taper Cone	2.25 (57.15)	1.154 (29.317)	.14 (3.5)				
A-454	Tapered Cup				4.331 (110.000)	1.063 (27.000)	.08 (2.0)	1.094 (27.795)
A-497	Taper Cone	3.375 (85.725)	1.172 (29.769)	.14 (3.5)				
A-493	Tapered Cup				5.375 (136.525)	.875 (22.225)	.13 (3.3)	1.188 (30.162)
A-580	Taper Cone	3.250 (82.550)	1.421 (36.098)	.14 (3.5)				
A-572X	Tapered Cup				5.500 (139.700)	1.125 (28.575)	.13 (3.3)	1.438 (36.512)
A-594A	Taper Cone	3.750 (95.250)	1.430 (36.322)	.20 (5.0)				
A-592XS	Tapered Cup				5.813 (147.638)	1.031 (26.192)	.13 (3.3)	1.406 (35.717)

Tapered Roller Bearing

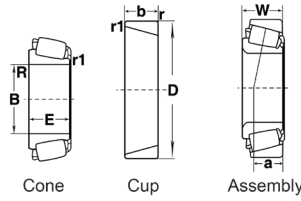

Part	Description	[B]	[E]	[R]	[D]	[b]	[r]	[W]
A-623	Taper Cone	2.250 (57.150)	1.625 (41.275)	.14 (3.5)				
A-612	Tapered Cup				4.750 (120.650)	1.250 (31.750)	.13 (3.3)	1.625 (41.275)
A-659-A	Taper Cone	3 (76.2)	1.625 (41.275)	.14 (3.5)				
A-652	Tapered Cup				6.000 (152.400)	1.250 (31.750)	.13 (3.3)	1.500 (38.100)
A-749S	Taper Cone	3.348 (85.026)	1.838 (46.672)	.20 (5.0)				
A-743	Tapered Cup				5.909 (150.089)	1.378 (35.000)	.13 (3.3)	1.750 (44.455)
A-1779	Taper Cone	.938 (23.812)	.781 (19.837)	.03 (0.8)				
A-1729X	Tapered Cup				2.240 (56.896)	.625 (15.875)	.06 (1.5)	.763 (19.368)
A-1988	Taper Cone	1.125 (28.575)	.762 (19.355)	.14 (3.5)				
A-1922	Tapered Cup				2.250 (57.150)	.625 (15.875)	.06 (1.5)	.781 (19.845)
A-2585	Taper Cone	1.313 (33.338)	.998 (25.357)	.14 (3.5)				
A-2631	Tapered Cup				2.615 (66.421)	.750 (19.050)	.05 (1.3)	.938 (23.812)
A-2776	Taper Cone	1.500 (38.100)	1.010 (25.654)	.17 (4.3)				
A-2729	Tapered Cup				3.000 (76.200)	.750 (19.050)	.03 (0.8)	.938 (23.812)
A-2789	Taper Cone	1.563 (39.688)	1.010 (25.654)	.14 (3.5)				
A-2735X	Tapered Cup				2.875 (73.025)	.750 (19.050)	.03 (0.8)	.938 (23.812)
A-2790	Taper Cone	1.3125 (33.338)	1.010 (25.654)	.06 (1.5)				
A-2735X	Tapered Cup				2.875 (73.025)	.750 (19.050)	.03 (0.8)	.938 (23.812)
A-2794	Taper Cone	1.437 (36.487)	1.010 (25.654)	.14 (3.5)				
A-2735X	Tapered Cup				2.875 (73.025)	.750 (19.050)	.03 (0.8)	.938 (23.812)
A-2788	Taper Cone	1.500 (38.100)	1.010 (25.654)	.14 (3.5)				
A-2735X	Tapered Cup				2.875 (73.025)	.750 (19.050)	.03 (0.8)	.938 (23.812)
A-3780	Taper Cone	2.000 (50.800)	1.193 (30.302)	.14 (3.5)				
A-3730	Tapered Cup				3.672 (93.264)	.938 (23.812)	.03 (.08)	1.188 (30.162)
A-3782	Taper Cone	1.750 (44.450)	1.193 (30.302)	.14 (3.5)				
A-3730	Tapered Cup				3.672 (93.264)	.938 (23.812)	.03 (.08)	1.188 (30.162)
A-3795	Taper Cone	2.000 (50.800)	1.193 (30.302)	.14 (3.5)				
A-3730	Tapered Cup				3.672 (93.264)	.9385 (23.812)	.03 (.08)	1.188 (30.162)
A-3880	Taper Cone	1.625 (41.275)	1.188 (30.162)	.03 (0.8)				
A-3820	Tapered Cup				3.375 (85.725)	.938 (23.812)	.13 (3.3)	1.188 (30.162)
A-3982	Taper Cone	2.500 (63.500)	1.183 (30.048)	.14 (3.5)				
A-3925	Tapered Cup				4.438 (112.712)	.938 (23.812)	.03 (.08)	1.188 (30.162)
A-3984	Taper Cone	2.625 (66.675)	1.183 (30.048)	.14 (3.5)				
A-3925	Tapered Cup				4.438 (112.712)	.938 (23.812)	.03 (.08)	1.188 (30.162)
A-3994	Taper Cone	2.625 (66.675)	1.183 (30.048)	.22 (5.5)				
A-3925	Tapered Cup				4.438 (112.712)	.938 (23.812)	.03 (.08)	1.188 (30.162)
A-2474	Taper Cone	1.125 (28.575)	.875 (22.225)	.03 (0.8)				
A-2420	Tapered Cup				2.688 (68.262)	.688 (17.462)	.06 (1.5)	.8750 (22.225)
A-07093	Taper Cone	.938 (23.812)	.5614 (14.260)	.06 (1.5)				
A-07210X	Tapered Cup				2.0000 (50.800)	.5000 (12.700)	.06 (1.5)	.591 (15.011)
A-07100	Taper Cone	1.000 (25.400)	.561 (14.260)	.04 (1.0)				
A-07210X	Tapered Cup				2.000 (50.800)	.500 (12.700)	.06 (1.5)	.591 (15.011)

Parts are not Original Equipment parts and are not sponsored, affiliated or otherwise connected with any major brand.

Tapered Roller Bearing

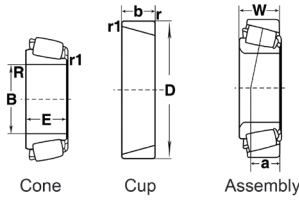

Parts are not Original Equipment parts and are not sponsored, affiliated or otherwise connected with any major brand.

BEARINGS

Part	Description	[B]	[E]	[R]	[D]	[b]	[r]	[W]
A-15126	Taper Cone	1.250 (31.750)	.813 (20.638)	.03 (0.8)				
A-15250X	Tapered Cup				2.500 (63.500)	.625 (15.875)	.06 (1.5)	.813 (20.638)
A-15123	Taper Cone	1.250 (31.750)	.750 (19.050)	spec.				
A-15243	Tapered Cup				2.438 (61.912)	.563 (14.288)	.08 (2.0)	.750 (19.050)
A-15580B	Taper Cone	1.063 (26.988)	.688 (17.462)	.14 (3.5)				
A-15520BR	Tapered Cup				2.250 (57.150)	.531 (13.495)	.06 (1.5)	.688 (17.462)
A-17580	Taper Cone	.625 (15.875)	.656 (16.670)	.06 (1.5)				
A-17520	Tapered Cup				1.688 (42.682)	.531 (13.495)	.06 (1.5)	.656 (16.670)
A-22780	Taper Cone	1.688 (42.862)	1.063 (26.988)	.14 (3.5)				
A-22720	Tapered Cup				3.250 (82.550)	.813 (20.638)	.13 (3.3)	1.031 (26.195)
A-24780	Taper Cone	1.625 (41.275)	.906 (23.020)	.14 (3.5)				
A-24720	Tapered Cup				3.000 (76.200)	.688 (17.462)	.03 (0.8)	.875 (22.225)
A-25577	Taper Cone	1.688 (42.875)	1.000 (25.400)	.13 (3.5)				
A-25519	Tapered Cup				3.250 (82.550)	.750 (19.050)	.08 (2.0)	.938 (23.812)
A-25578	Taper Cone	1.688 (42.862)	1.000 (25.400)	.09 (2.3)				
A-25520	Tapered Cup				3.265 (82.931)	.750 (19.050)	.03 (0.8)	.938 (23.812)
A-25580	Taper Cone	1.750 (44.450)	1.000 (25.400)	.14 (3.5)				
A-25521	Tapered Cup				3.270 (83.058)	.750 (19.050)	.13 (3.3)	.938 (23.812)
A-25584	Taper Cone	1.771 (44.983)	1.000 (25.400)	.06 (1.5)				
A-25522	Tapered Cup				3.270 (83.058)	.753 (19.114)	.08 (2.0)	.940 (23.876)
A-25590	Taper Cone	1.796 (45.618)	1.000 (25.400)	.14 (3.5)				
A-25523	Tapered Cup				3.265 (82.931)	.875 (22.225)	.09 (2.3)	1.063 (26.988)
A-25877	Taper Cone	1.375 (34.925)	.969 (24.608)	.06 (1.5)				
A-25820	Tapered Cup				2.875 (73.025)	.750 (19.050)	.09 (2.3)	.938 (23.812)
A-25878	Taper Cone	1.375 (34.925)	.969 (24.608)	.14 (3.5)				
A-25821	Tapered Cup				2.875 (73.025)	.750 (19.050)	.03 (0.8)	.938 (23.812)
A-25880	Taper Cone	1.437 (36.487)	.969 (24.608)	.06 (1.5)				
A-25821	Tapered Cup				2.875 (73.025)	.750 (19.050)	.03 (0.8)	.938 (23.812)
A-26882	Taper Cone	1.625 (41.275)	1.000 (25.400)	.14 (3.5)				
A-26823	Tapered Cup				3.000 (76.200)	.813 (20.638)	.06 (1.5)	1.000 (25.400)
A-28682	Taper Cone	2.250 (57.150)	.969 (24.608)	.14 (3.5)				
A-28622	Tapered Cup				3.844 (97.630)	.766 (19.446)	.03 (0.8)	.969 (24.608)
A-28985	Taper Cone	2.375 (60.325)	1.000 (25.400)	.14 (3.5)				
A-28921	Tapered Cup				3.937 (100.000)	.781 (19.845)	.13 (3.3)	1.000 (25.400)
A-29685	Taper Cone	2.875 (73.025)	1.000 (25.400)	.14 (3.5)				
A-29630	Tapered Cup				4.750 (120.650)	.750 (19.050)	.13 (3.3)	1.000 (25.400)
A-LM29748	Taper Cone	1.500 (38.100)	.720 (18.288)	spec.				
A-LM29710	Tapered Cup				2.563 (65.088)	.550 (13.970)	.05 (1.3)	.710 (18.034)
A-33262	Taper Cone	2.625 (66.675)	2.625 (66.675)	.14 (3.5)				
A-33472	Tapered Cup				4.724 (120.000)	.923 (23.444)	.03 (0.8)	1.173 (29.764)
A-39581	Taper Cone	2.250 (57.150)	2.250 (57.150)	.31 (8.0)				
A-39520	Tapered Cup				4.438 (112.712)	.938 (23.812)	.13 (3.3)	1.188 (30.162)

Tapered Roller Bearing

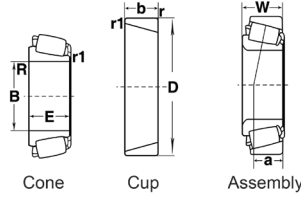

Part	Description	[B]	[E]	[R]	[D]	[b]	[r]	[W]
A-39585	Taper Cone	2.500 (63.500)	2.500 (63.500)	.14 (3.5)				
A-39520	Tapered Cup				4.438 (112.712)	.938 (23.812)	.13 (3.3)	1.188 (30.162)
A-39590	Taper Cone	2.625 (66.675)	2.625 (66.675)	.14 (3.5)				
A-39520	Tapered Cup				4.438 (112.712)	.938 (23.812)	.13 (3.3)	1.1885 (30.162)
A-L44643	Taper Cone	1.000 (25.400)	1.000 (25.400)	.05 (1.3)				
A-L44610	Tapered Cup				1.980 (50.292)	.420 (10.668)	.05 (1.3)	.560 (14.224)
A-L44649	Taper Cone	1.063 (26.988)	1.063 (26.988)	.14 (3.5)				
A-L44610	Tapered Cup				1.980 (50.292)	.420 (10.668)	.05 (1.3)	.560 (14.224)
A-LM48548	Taper Cone	1.375 (34.925)	.720 (18.288)	spec.				
A-LM48510	Tapered Cup				2.5635 (65.088)	.550 (13.970)	.05 (1.3)	.710 (18.034)
A-LM67048	Taper Cone	1.250 (31.750)	.660 (16.764)	spec.				
A-LM67010	Tapered Cup				2.328 (59.131)	.465 (11.811)	.05 (1.3)	.625 (15.875)
A-L68149	Taper Cone	1.378 (35.000)	.660 (16.764)	.203 (5.2)				
A-L68110	Tapered Cup				2.328 (59.131)	.470 (11.938)	.05 (1.3)	.625 (15.875)
A-JL69349	Taper Cone	1.496 (38.000)	.669 (17.000)	spec.				
A-JL69310	Tapered Cup				2.480 (63.000)	.531 (13.495)	.05 (1.3)	.669 (17.000)
A-M86649	Taper Cone	1.188 (30.162)	.844 (21.433)	.06 (1.5)				
A-M86610	Tapered Cup				2.531 (64.292)	.656 (16.670)	.06 (1.5)	.8448 (21.433)
A-M88048	Taper Cone	1.313 (33.338)	.875 (22.225)	.03 (0.8)				
A-M88010	Tapered Cup				2.688 (68.262)	.688 (17.462)	.06 (1.5)	.875 (22.225)
A-HM88649	Taper Cone	1.375 (34.925)	1.000 (25.400)	.09 (2.3)				
A-HM88611	Tapered Cup				2.835 (72.000)	.844 (21.443)	.06 (1.5)	1.063 (27.000)
A-LM102949	Taper Cone	1.781 (45.242)	.780 (19.812)	.14 (3.5)				
A-LM102910	Tapered Cup				2.891 (73.431)	.620 (15.748)	.03 (0.8)	.770 (19.558)
A-LM104949	Taper Cone	2.000 (50.800)	.875 (22.225)	.14 (3.5)				
A-LM104911	Tapered Cup				3.250 (82.550)	.650 (16.510)	.05 (1.3)	.850 (21.590)
A-JLM104948	Taper Cone	1.969 (5.000)	.847 (21.500)	.12 (3.0)				
A-JLM104910	Tapered Cup				3.228 (82.000)	.669 (17.000)	.02 (0.5)	.847 (21.500)
A-LM501349	Taper Cone	1.625 (41.275)	.780 (19.812)	.14 (3.5)				
A-LM501310	Tapered Cup				2.891 (73.431)	.580 (14.732)	.03 (0.8)	.770 (19.558)
A-JLM506849	Taper Cone	2.165 (55.000)	.906 (23.000)	.06 (1.5)				
A-JLM506810	Tapered Cup				3.543 (90.000)	.728 (18.500)	.02 (0.5)	.906 (23.000)
A-LM603049	Taper Cone	1.781 (45.242)	.781 (19.842)	.14 (3.5)				
A-LM603011	Tapered Cup				3.063 (77.788)	.594 (15.080)	.03 (0.8)	.781 (19.842)
A-HM903249	Taper Cone	1.750 (44.450)	1.125 (28.575)	.14 (3.5)				
A-HM903210	Differential Bearing Cup				3.750 (95.250)	.875 (22.225)	.03 (0.8)	1.219 (30.958)

Parts are not Original Equipment parts and are not sponsored, affiliated or otherwise connected with any major brand.

Tapered Roller Bearing

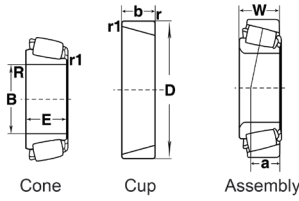

Parts are not Original Equipment parts and are not sponsored, affiliated or otherwise connected with any major brand.

Part	Description	[B]	[E]	[R]	[D]	[b]	[r]	[W]
A-02474	Taper Cone							
A-13600LA	Timken Cone							
A-14136AA	Timken Brg Cone							
A-15126	Taper Cone	1.2500 (31.750)	.8125 (20.638)	.03 (0.8)				
A-2780B	Cone							
A-2788A	Timken Cone							
A-2820	Timken Cone							
A-367	Timken Cone							
A-389AS	Timken Cone							
A-397	Timken Cone							
A-53176	Timken Cone							
A-53177	Timken Cone							
A-5BC	Timken Cone							
A-02820	Tapered Cup				2.8750 (73.025)	.6875 (17.462)	.13 (3.3)	.8750 (22.225)
A-07196	Tapered Cup				1.9687 (50.005)	.3750 (9.525)	.04 (1.0)	.5313 (13.495)
A-1328	Tapered Cup				2.0615 (52.388)	.5625 (14.288)	.06 (1.5)	.7625 (19.368)
A-25526	Tapered Cup				3.3465 (85.000)	.7500 (19.050)	.09 (2.3)	.9375 (23.812)
A-26820	Tapered Cup				3.1562 (80.167)	.8125 (20.638)	.13 (3.3)	1.0000 (25.400)
A-2729X	Timken Cup							
A-29620	Tapered Cup				4.4375 (112.712)	.7500 (19.050)	.13 (3.3)	1.0000 (25.400)
A-332	Tapered Cup				3.1496 (80.000)	.7018 (17.826)	.05 (1.3)	.8268 (21.000)
A-352	Tapered Cup				3.5480 (90.119)	.8586 (21.808)	.09 (2.3)	.9055 (23.000)
A-382	Tapered Cup				3.8750 (98.425)	.7018 (17.826)	.03 (0.8)	.8268 (21.000)
A-382A	Tapered Cup				3.8125 (96.838)	.6250 (15.875)	.03 (0.8)	.8268 (21.000)
A-3920	Tapered Cup				4.4375 (112.712)	.9375 (23.812)	.13 (3.3)	1.1875 (30.162)
A-394A	Tapered Cup				4.3307 (110.000)	.7411 (18.824)	.05 (1.3)	.8661 (22.000)
A-49520	Tapered Cup				4.0000 (101.600)	1.0000 (25.400)	.13 (3.3)	1.2500 (31.750)
A-592A	Tapered Cup				6.0000 (152.400)	1.1875 (30.162)	.13 (3.3)	1.5625 (39.668)
A-6	Timken Cup							
A-HM212011	Tapered Cup				4.8125 (122.238)	1.1700 (29.718)	.13 (3.3)	1.5000 (38.100)
A-LM11910XL	Bearing Cup							

BEARINGS



Misc Seals

BEARINGS

PART	DESCRIPTION	PART	DESCRIPTION	PART	DESCRIPTION
A-05956BH	Seal (200881)	A-470334	Seal	A-CR20044	Seal
A-1007BH	Seal (472394)	A-470351	Seal	A-CR22392	Seal
A-11242SC	Seal, 2 7/16" O.D. X 1 1/8" I.D. X 1/4" Width	A-470380	Seal	A-CR25091	Seal
A-12363	PTO In/Seal	A-471192	Seal	A-CR26310	Seal
A-12530	PTO In/Seal	A-471267	Seal	A-CR27394	Seal
A-172532	Seal	A-471344	Seal	A-R33340	Seal
A-175272	Seal	A-471413	Seal	A-TCM121194VB	Seal
A-18265	Seal	A-471419	Seal	A-TCM171255VB	Seal
A-19760	PTO Out/Seal	A-471466	Seal	A-VPH4205	Oil Seal
A-200110	Seal	A-471504	Seal	A-VPJ2831	Oil Seal
A-200861	Seal	A-471554	Seal	A-VPJ2911	Oil Seal
A-203013	Seal	A-471652	Seal	A-W239583B	Seal
A-203025	Seal	A-471689	Seal		
A-203034	Seal	A-471760	Seal		
A-204002	Seal	A-471765	Seal		
A-204008	Seal	A-471766	Seal		
A-204013	Seal	A-471772	Seal		
A-204020	Seal	A-471827	Seal		
A-204027	Seal	A-471829	Seal		
A-204029	Seal	A-471835	Seal		
A-204035	Seal	A-471883	Seal		
A-291099	Seal	A-472015	Seal		
A-29404	Seal, Old Style	A-472258	Seal		
A-32453	Seal	A-472409	Seal		
A-410059	Seal	A-472492	Seal		
A-410708	Seal	A-473214	Seal		
A-413247	Seal	A-473227	Seal		
A-413469	Seal	A-473228	Seal		
A-41461S	Seal	A-473231	Seal		
A-416891	Seal	A-473236	Seal		
A-417172	Seal	A-473237	Seal		
A-417316	Seal	A-473238	Seal		
A-417344	Seal	A-473239	Seal		
A-43463D	Seal	A-473445	Seal		
A-44052	Seal	A-473446	Seal		
A-450009	Seal	A-473463	Seal		
A-450043	Seal	A-473517	Seal		
A-450059	Seal	A-480210	Seal		
A-450067	Seal	A-48704DA	Seal		
A-450083	Seal	A-487945	Seal		
A-450096	Seal	A-4R309	Seal		
A-450099	Seal	A-5919	Seal		
A-450135	Seal	A-6214	Seal		
A-450285	Seal	A-6312	Seal		
A-450394	Seal	A-6921070002	Seal		
A-450430	Seal	A-6921120003	Seal		
A-450492	Seal	A-7967BH	Seal		
A-455004	Seal	A-B13294	Seal		
A-455009	Seal	A-CR15190	Seal		
A-455280	Seal	A-CR16069	Seal		
A-455379	Seal	A-CR17617	Seal		
A-470009	Seal	A-CR18030	Seal		
A-470135	Seal	A-CR18562	Seal		
		A-CR18823	Seal		

Parts are not Original Equipment parts and are not sponsored, affiliated or otherwise connected with any major brand.